

MODEL: FE

Features:

1. Self-power transmitter, no need battery.
2. 32 sounds with 24 polyphonic.
3. LED indicator in the receiver.
4. Receiver with volume control.
5. 100M operating range in the open air.
6. Self-learning technology avoid interference.
7. Transmitter is with LED and waterproof.

Features of self-learning technology:

- 1) One self-power transmitter can control up to eight DC receivers.
 - 2) At most 4 self-power transmitters can control one DC receiver.
- Note: The transmitter for AC receiver is not allowed to use with DC receiver, and the transmitter for DC receiver is also not allowed to use with AC receiver.

Installation:

The transmitter can be mounted on door frame.
The chime can be put on table or mounted on wall.

Transmitter

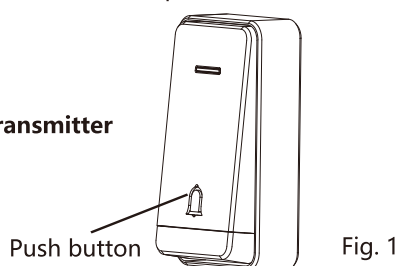

Self-power transmitter no need battery

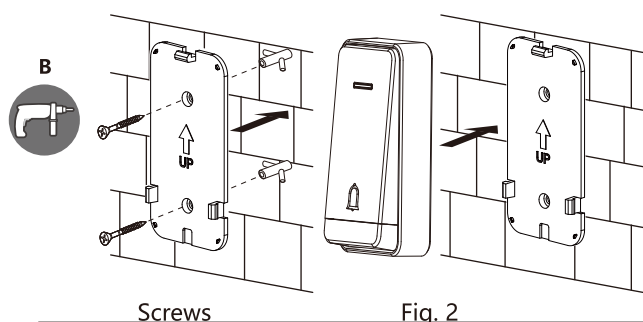
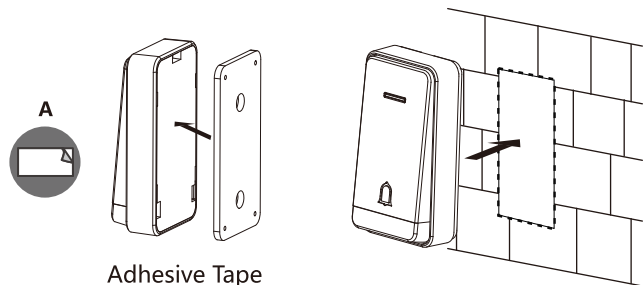
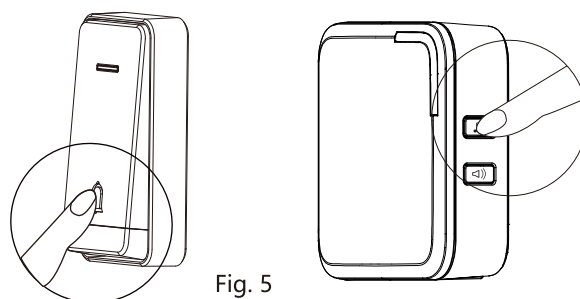
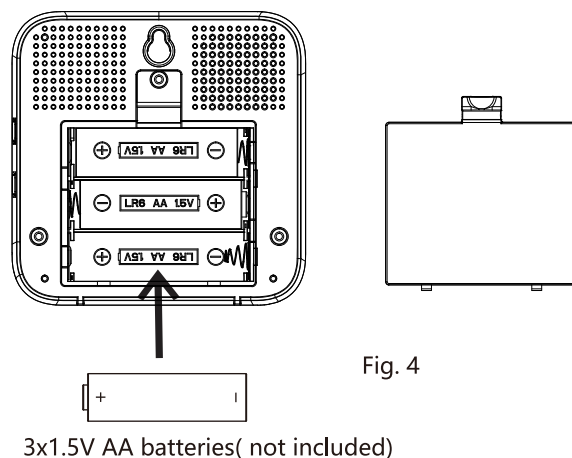
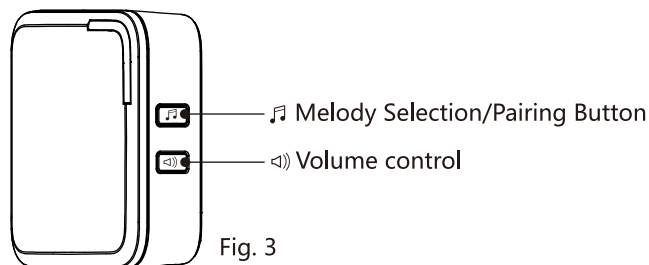

Fig. 2

Receiver:



How to Pairing:

The transmitter and receiver have been pairing during the packaging. If your doorbell is not working well. You can follow up below 3 steps to reset the product.

1. Clear the pairing codes inside the receiver. Firstly, press /hold the "melody selection button", then install the final battery into the battery compartment, hold to press the button for about 8 seconds, you will see the receiver's LED flashing, then release the button, the codes are all removed from the internal memory.
2. Pairing the transmitter and receiver again. Press/hold the "melody selection button" on the receiver about 4 seconds, and release the button until you hear "Ding-Ding" sound, then press the transmitter, now you will hear the receiver play "Ding" sound, you can wait for another "Ding-Ding" sound or press the "melody selection button" directly to exit the pairing mode. Like Fig.5
3. Press the transmitter and test if pairing is completed, then enjoy the use of our product again.

This device complies with part 15 of the FCC Rules.

Operation is subject to the following two conditions:

- (1) This device may not cause harmful interference, and
- (2) this device must accept any interference received, including interference that may cause undesired operation.

Warning: Changes or modifications to this unit not expressly approved by the party responsible for compliance could void the user's authority to operate the equipment.

NOTE: This equipment has been tested and found to comply with the limits for a Class B digital device, pursuant to part 15 of the FCC Rules. These limits are designed to provide reasonable protection against harmful interference in a residential installation. This equipment generates, uses and can radiate radio frequency energy and, if not installed and used in accordance with the instructions, may cause harmful interference to radio communications. However, there is no guarantee that interference will not occur in a particular installation. If this equipment does cause harmful interference to radio or television reception, which can be determined by turning the equipment off and on, the user is encouraged to try to correct the interference by one or more of the following measures:

- Reorient or relocate the receiving antenna.
- Increase the separation between the equipment and receiver.
- Connect the equipment into an outlet on a circuit different from that to which the receiver is connected.
- Consult the dealer or an experienced radio/ TV technician for help.