



Harborough Innovation Centre, Airfield Business Park,
Market Harborough, Leicestershire, LE16 7WB, UK.

www.commtelinnovate.com

www.smartbel.com

+44 (0)333 700 7000

REV5:11/07/12

Introduction

Congratulations on your purchase of Smartbel! The most advanced, feature packed global intercom available.

Smartbel allows convenient remote communication to your front door at all times.

The incorporation of specialist (GSM) technology into the design of Smartbel allows you to conveniently answer and communicate with your door caller, from your mobile phone, anywhere in the world!

Whether you are away on holiday, or out for the day, you can always answer your door whilst away.

Never miss another parcel or courier delivery!

In addition, Smartbel offers many unique security benefits, from acting as a burglar deterrent, to allowing you to speak safely to the person at your front door, without opening the door.

Please take care to follow the set up and installation instructions, so that you can enjoy all the benefits and innovation Smartbel has to offer.



Smartbel Parts / Kit Contents
P2 to 7



Quick Connect Signal Check
P8 to 12

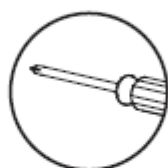

Smartbel Installation
P13 to 23



Smartbel User Guide
P24 to 25



Hint & Tips, FAQ's & Optional Accessories

Smartbel Parts Diagram

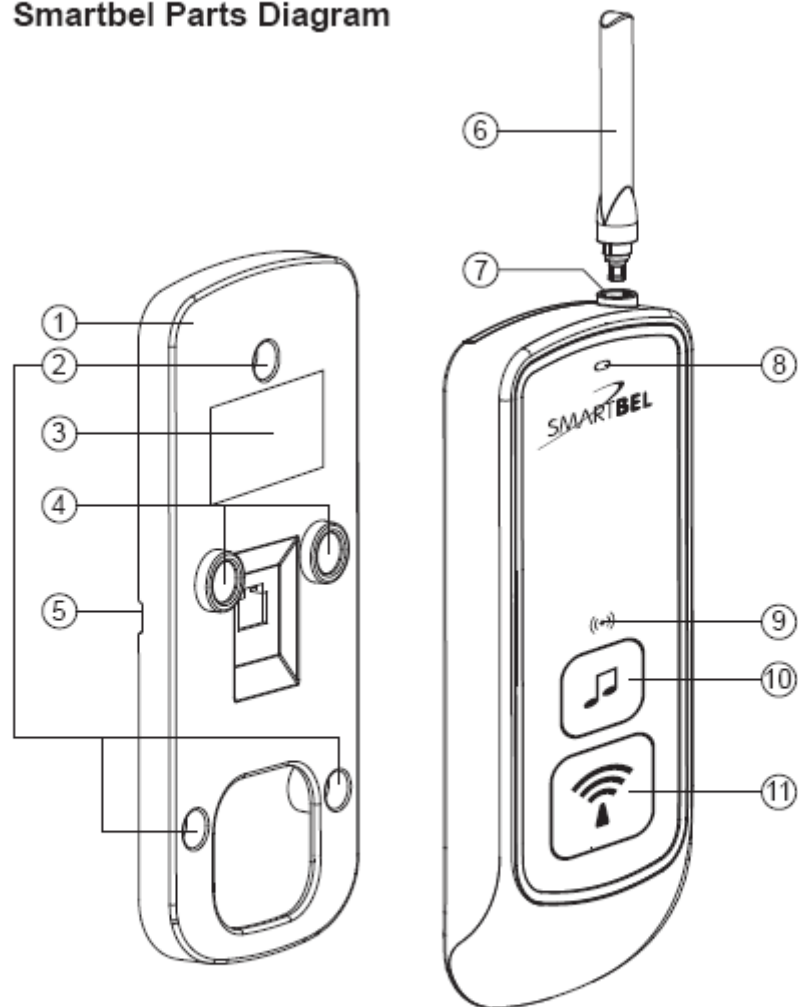

1. Smartbel Wall Bracket
2. Wall Bracket Screw Holes
3. IMEI, S/N, ICCID
4. Magnets
5. Cable Guide
6. GSM Aerial

7. GSM Aerial Socket
8. LED Status Indicator
9. MIC
10. Melody Select
11. Mode Select

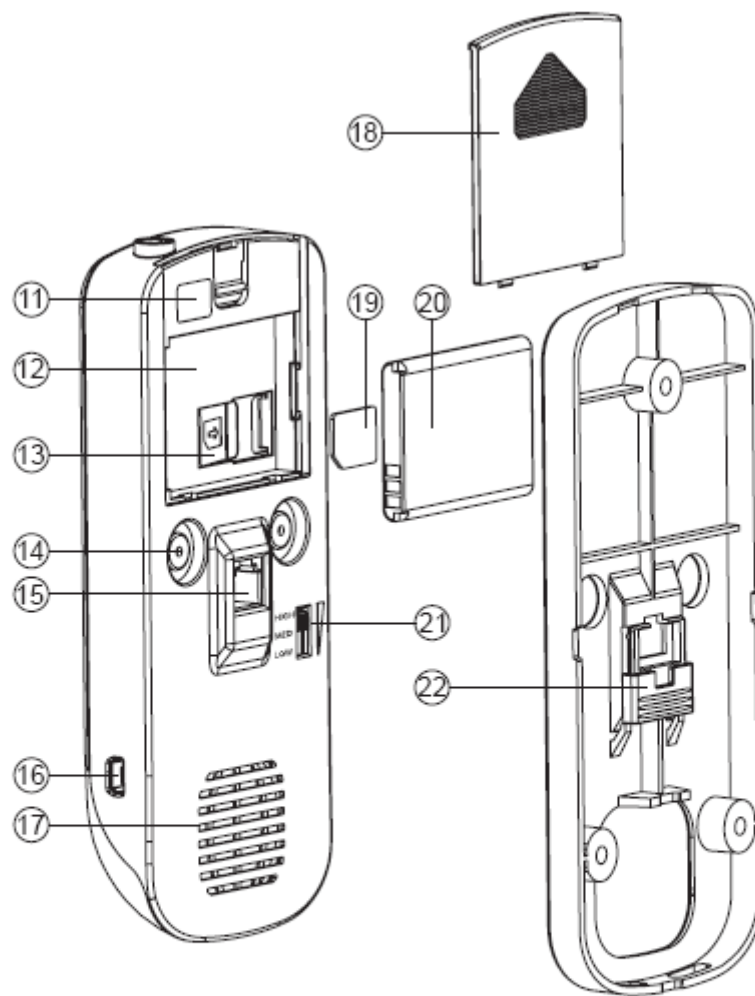

- | | |
|--------------------------------------|---------------------|
| 11. Tamper Sticker (Void if removed) | 17. Speaker Grill |
| 12. Battery Compartment | 18. Battery Cover |
| 13. Micro SIM Slot | 19. Micro SIM Card* |
| 14. Magnetic Contacts | 20. Battery |
| 15. RJ12 Socket | 21. Volume Select |
| 16. Mini USB Socket | 22. Fixing Cover |

**Pre-Installed*

Bell Push Parts Diagram

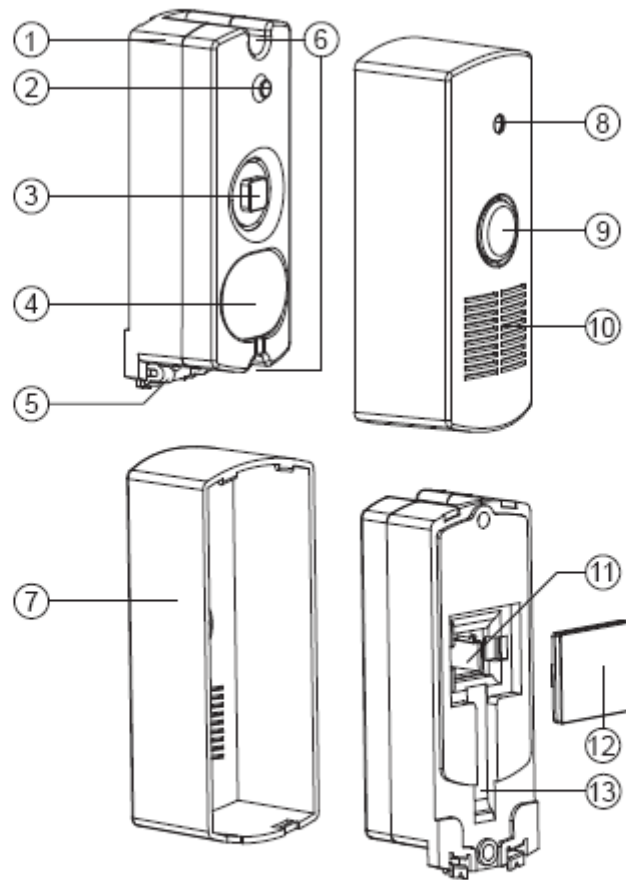

1. Inner Casing
2. MIC
3. Switch
4. Speaker
5. Outer Case Locking Tabs
6. Screw Holes
7. Outer Casing

8. MIC Locator
9. Push Button
10. Speaker Grill
11. RJ12 Socket
12. Waterproofing Cover
13. Cable Guide

Kit Contents

Prior to installation, please check that you have all the necessary parts

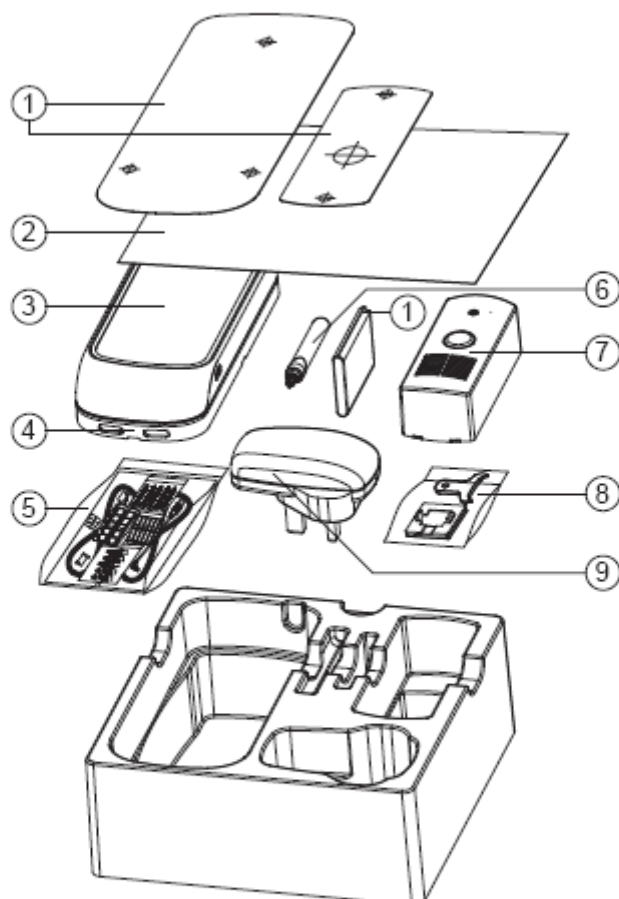

- | | |
|------------------------|-----------------------------------|
| 1. Fixing Templates | 6. GSM Aerial |
| 2. Instruction Booklet | 7. Bell Push (Inner / Outer Case) |
| 3. Smartbel | 8. Component Bag 2 |
| 4. Wall Bracket | 9. AC Adapter |
| 5. Component Bag 1 | |

Component Bags

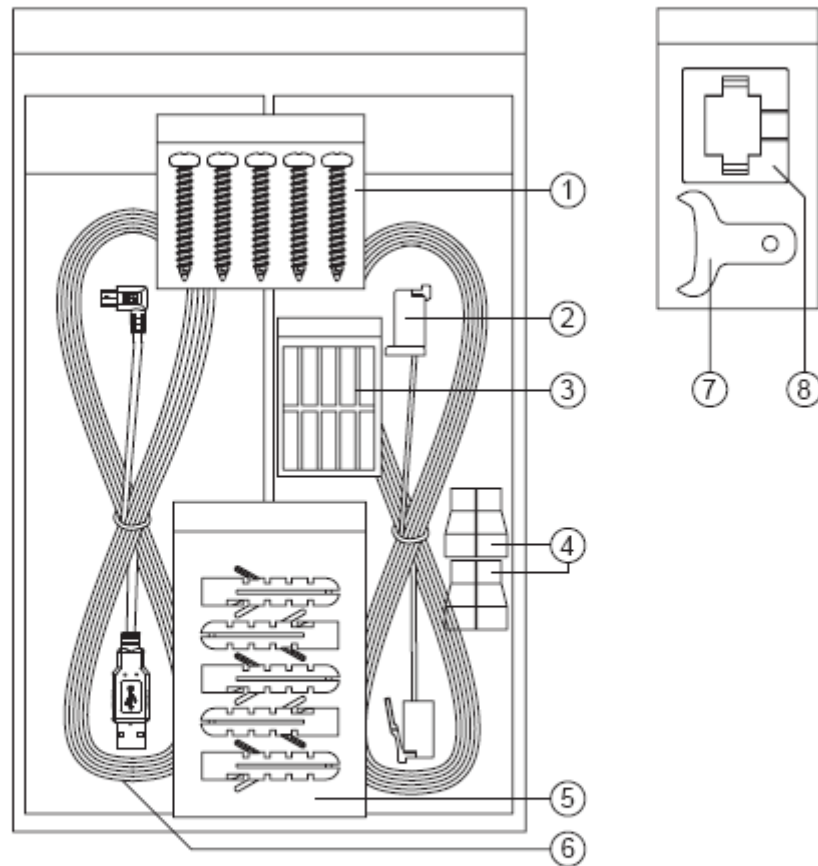

- | | |
|-----------------------------------|-------------------------------|
| 1. Screws (x5) | 5. Wall Plugs (x5) |
| 2. 5m Clear RJ12-RJ12 cable | 6. 1.8m USB to Mini USB Cable |
| 3. 10pcs Internal adhesive strips | 7. Bell Push Release Tool |
| 4. Rubber Wall Grommet (x2) | 8. Waterproofing Cover |

Quick Connect Signal Check

Please consider the following points to help you decide which installation option is best for you:

Signal strength

Can I receive a reliable signal at the installation site?

Mains Power

To avoid the use of extensions, is there a mains powered socket within reach of the unit?

Audible Sound

Will I be able to hear the doorbell (when in Doorbell mode) from the installation location?

Installation

Will I be able to create a suitable entry and exit point between indoors and outdoors for the connection cable?

1.0

Attach the GSM Aerial to the GSM Aerial Socket as shown.

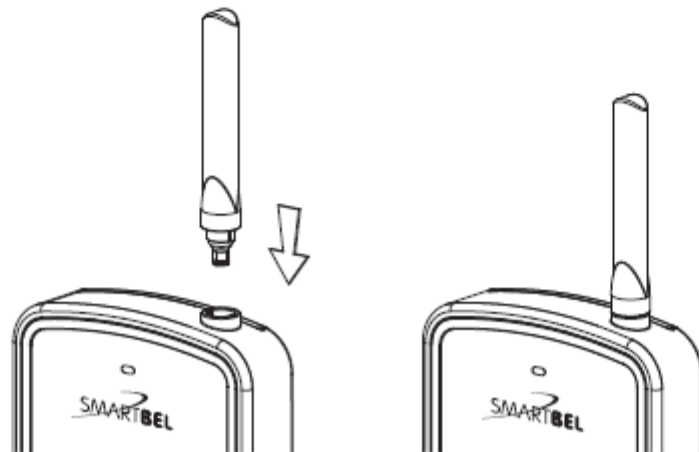

1.1

Insert the battery into the battery compartment and close the battery cover.

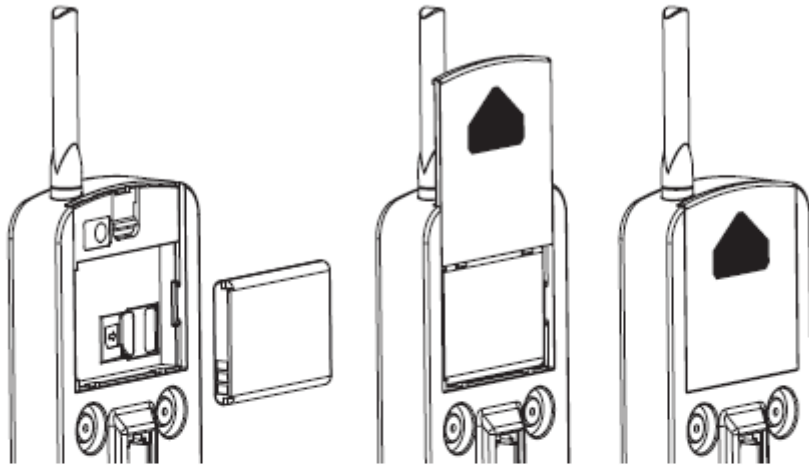

1.2

Connect the USB lead by inserting the mini USB connector into Smartbel.

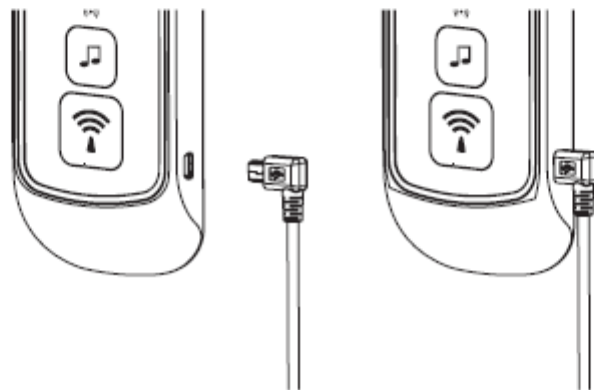

1.3

Connect the USB lead into the AC adapter, and plug into a mains socket.

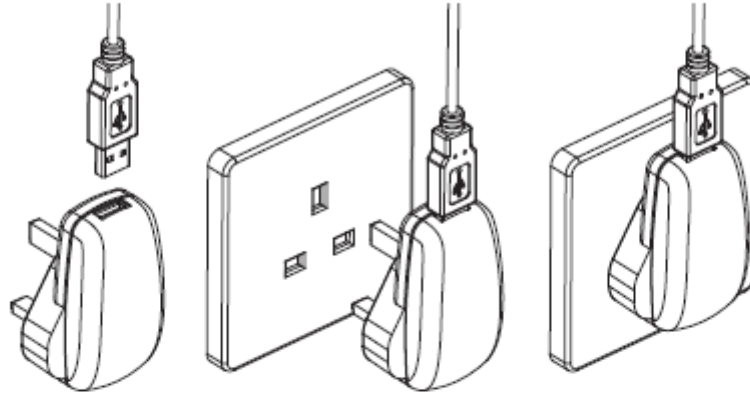

1.4

Charge the battery for a minimum of 2 hours.

1.5

Once charging is complete, position Smartbel in the preferred installation location. Smartbel will automatically search for a signal.

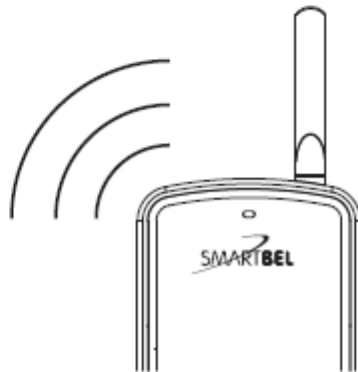

1.6

Searching for a signal can take up to 2 minutes, during which time you can monitor the LED status. The aim is for a green signal indicator, indicating that you are able to receive a good signal.

LED Status

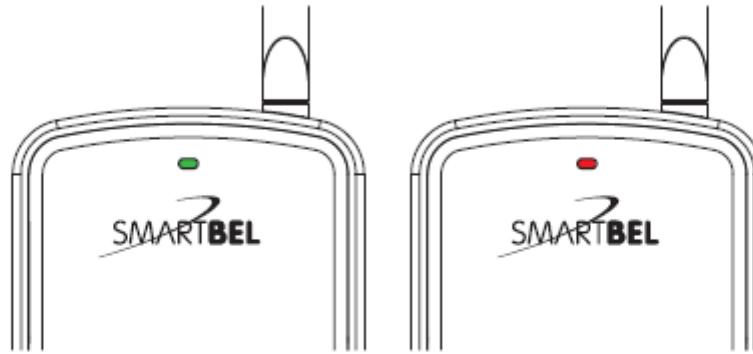

Green = Good Signal

Red = No Signal

1.7

A flashing green/red LED indicates an intermediate signal

If you do not receive a green indicator during this period, please re-position Smartbel to another location and repeat the process. Also see *Hints and Tips* for ways of improving signal and set-up options.

IMPORTANT

After re-positioning Smartbel, it can take up to two minutes to register a change of signal.

Please leave the unit in position for this period of time before changing the position of Smartbel. Ensure that you are happy with the signal reception prior to commencing installation.

If you are still experiencing difficulty in obtaining a signal after re-positioning Smartbel; it is likely that you are in a weak signal area. An optional external antenna may be required.

In exceptionally weak signal areas, Smartbel may not operate. An external GSM repeater or booster may be required.

External Bell Push Installation

WARNING

Prior to drilling any holes please check there is no electrical wiring, gas pipes or water pipes present. The use of a suitable British Standards approved electrical wiring and pipe detector is recommended.

If in doubt please consult a professional.

Tools Required for Installation

1. Drill
2. Posi-Head Screwdriver
3. 6mm and 15mm masonry/wood drill bits

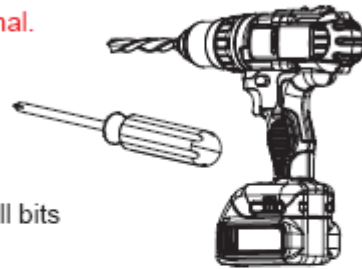

2.0

Choose a suitable outdoor location for the Bell Push installation, such as a door frame or wall, no more than 5m from the Smartbel unit.

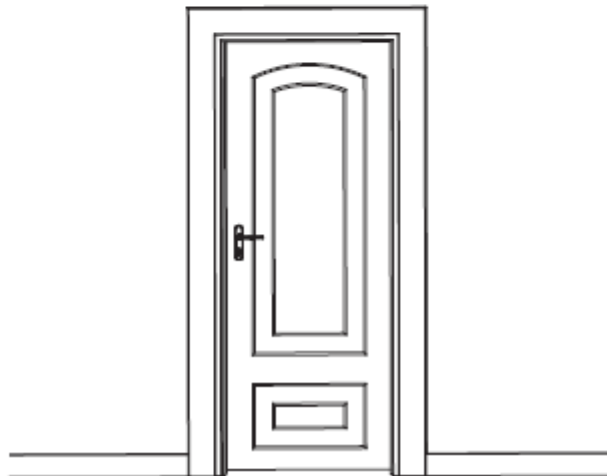

2.1

Remove the adhesive backing from the Bell Push template and affix at your chosen installation point.

2.2

With the Bell Push template in position, drill the three holes directly through the template, using either a wood drill bit (if drilling into wood), or a masonry drill bit (if drilling into brick or stone). The large 15mm centre hole should be drilled entirely through the wall with the 6mm holes drilled to a depth of 30mm.

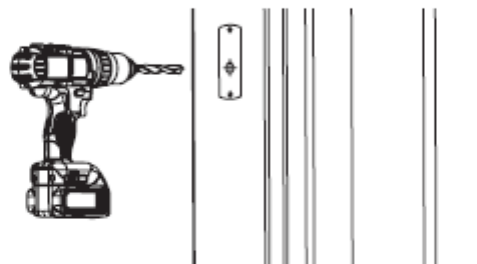

2.3

After drilling the holes discard the template.

2.4

Insert 2 wall plugs into both of the smaller 6mm drilled holes.

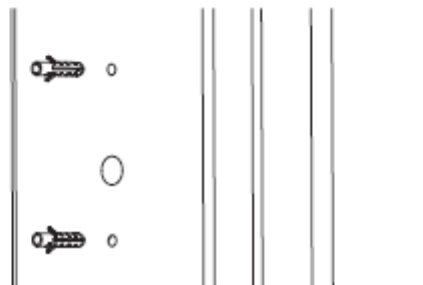

2.5

From the inside, thread the RJ12 cable (without backplate) through the largest drilled hole to the outside as shown.

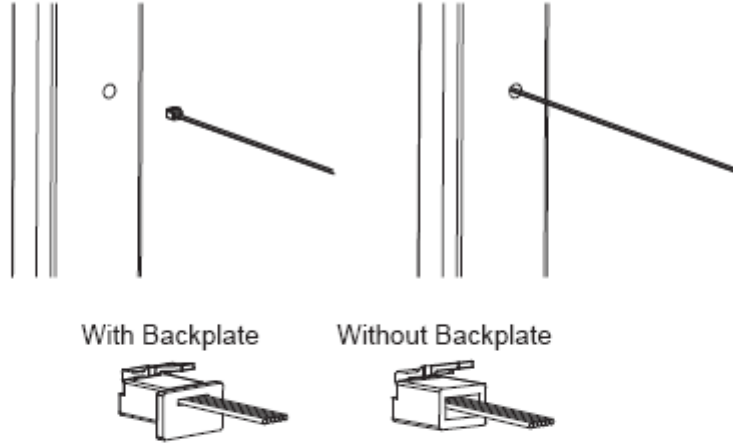

2.6

Plug the RJ12 cable into the Bell Push socket as shown.

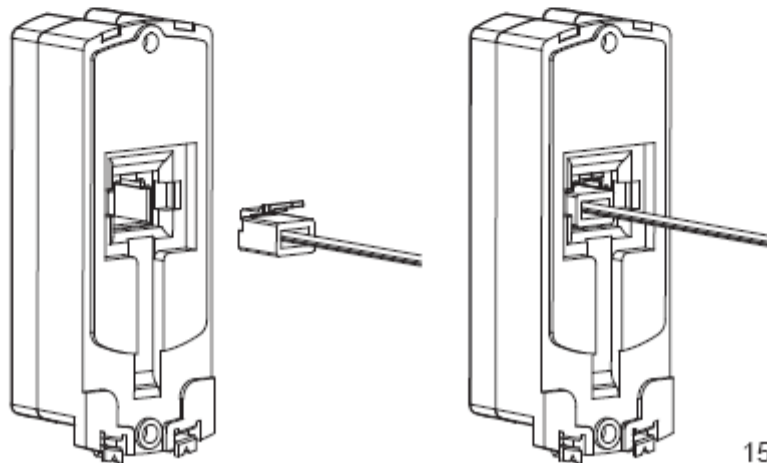

2.7

With the arrow facing upwards, place the rubber waterproofing cover over the cable entry, firmly clip into place and route the cable as shown.

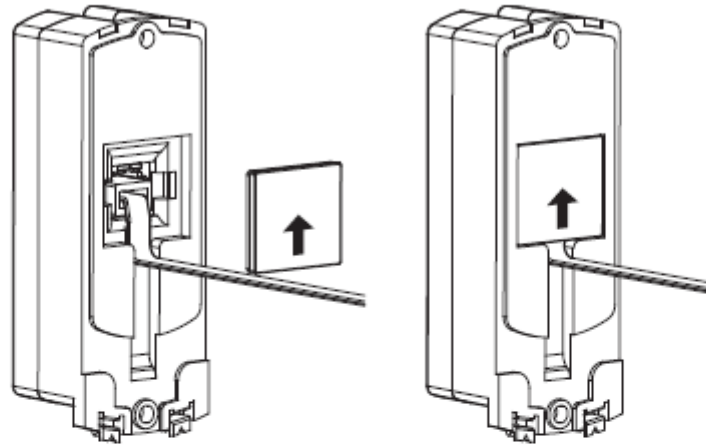

2.8

Position the rubber grommet over the RJ12 cable as shown, and secure the grommet into the pre-drilled hole from the outside whilst supporting the Bell Push.

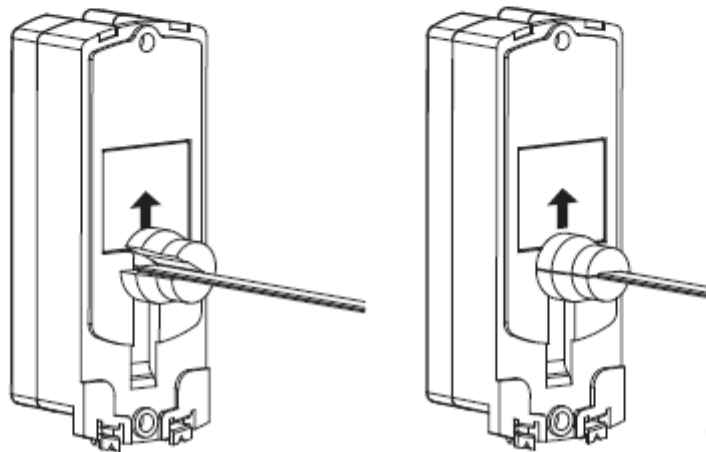

2.9

Gently pull the cable from the inside, taking up any slack. Ease the Bell Push and grommet assembly into the hole with a gentle twisting action until flush.

3.0

Align the Bell Push holes with the pre-drilled holes, and insert the screws through the holes, into the wall or door frame.

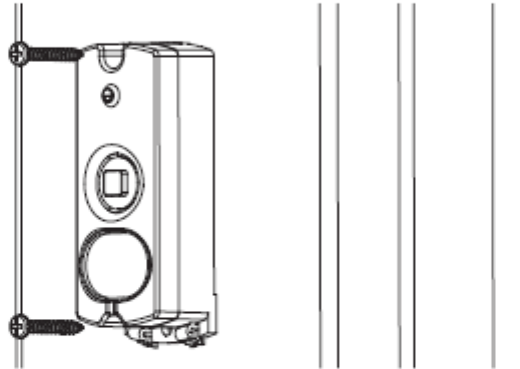

3.1

Secure the Bell Push unit into position by tightening the screws with a screwdriver.

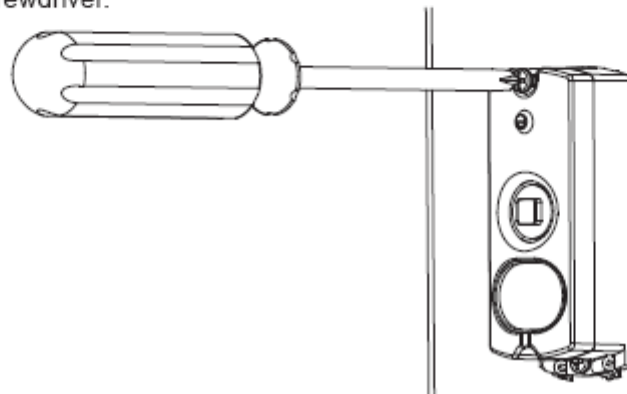

3.2

To complete installation, clip the Bell Push outer housing into place ensuring the microphone is positioned at the top of the bell push, as indicated below.

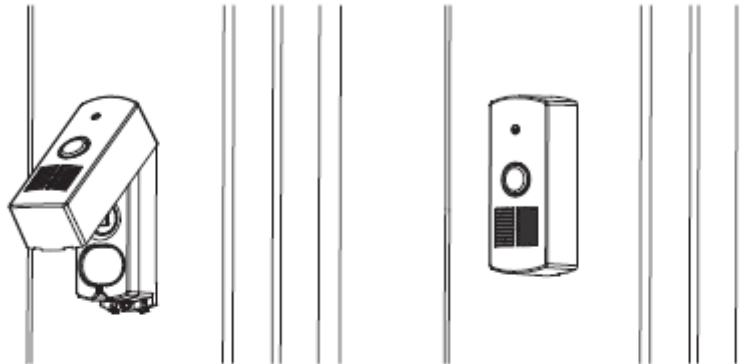

3.3

From the inside, whilst holding the RJ12 cable taut, place the second rubber grommet over the RJ12 cable and insert into the hole. The completed grommet installation is shown below.

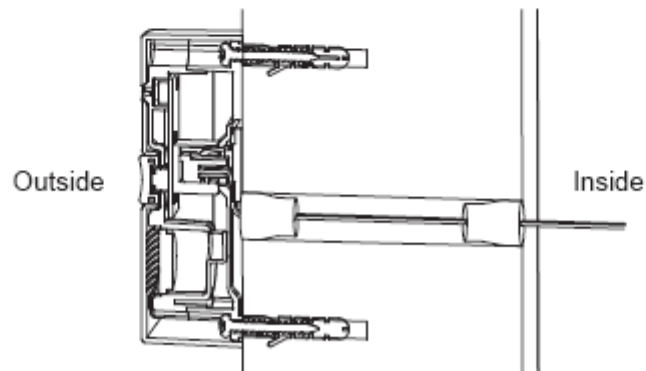

Congratulations! External installation is now complete.

Smartbel Installation (Internal)

4.0

With the Fixing Cover open, insert the RJ12 plug (with backplate) into the rear of the bracket and slide the Fixing Cover in a firm upwards action to secure the RJ12 plug into place. A positive click sound will indicate that the fixing cover has been correctly secured.

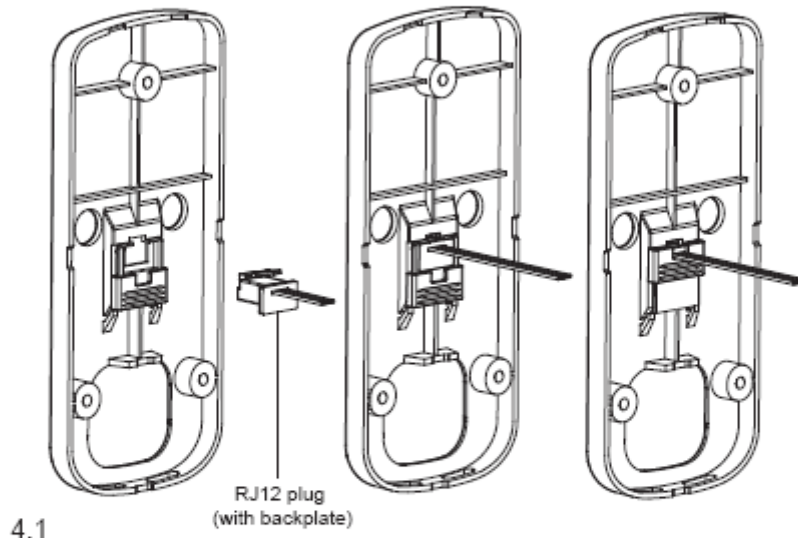

Choose a suitable indoor location for the Smartbel installation no more than 5m from the Bell Push unit and 1.8m from a power source.

N.B Installation distances further than 5m can be achieved by using optional power accessories.

4.2

Remove the adhesive backing from the Smartbel template, and affix at your chosen installation point.

4.3

With the Smartbel template in position, drill the three holes directly through the template, using either a wood drill bit (if drilling into wood), or a masonry drill bit (if drilling into brick or stone). The holes should be drilled to a depth of 30mm.

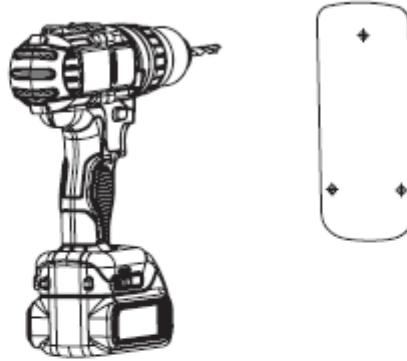

4.4

After drilling the holes, remove and discard the template.

4.5

Insert the three remaining wall plugs into the three pre-drilled holes.



Installing the Smartbel Wall Bracket

4.6

Align the Smartbel bracket with the pre-drilled holes.

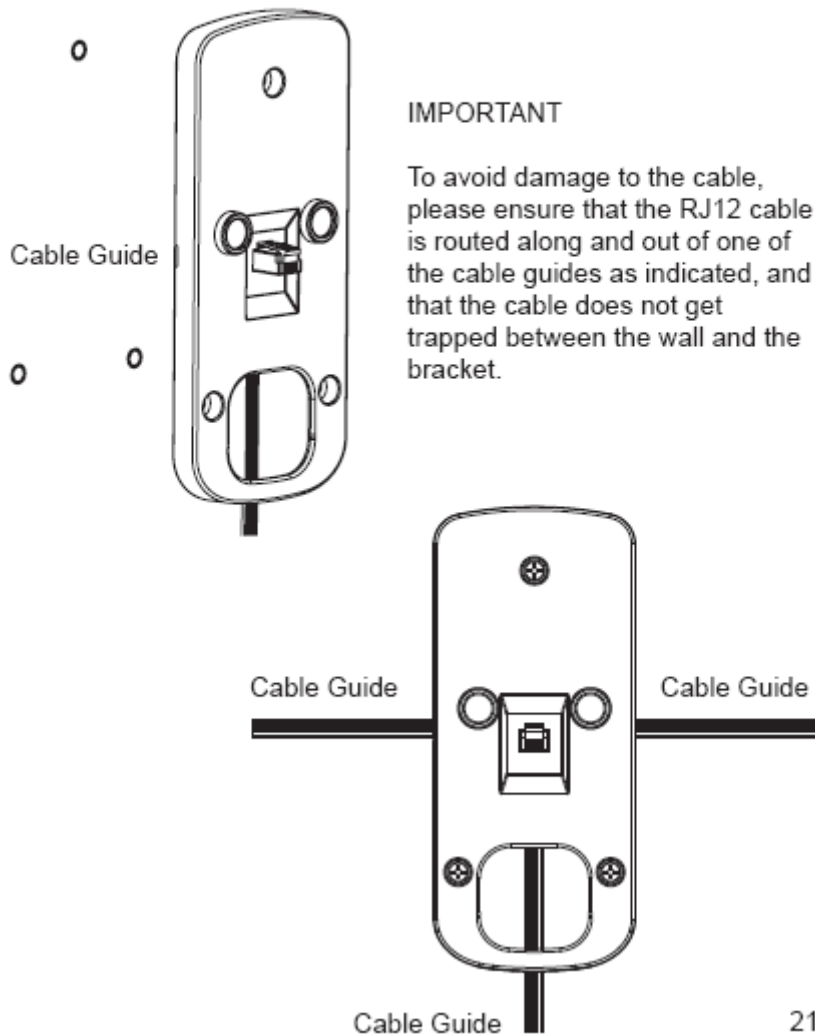

4.7

Insert and tighten screws to secure.

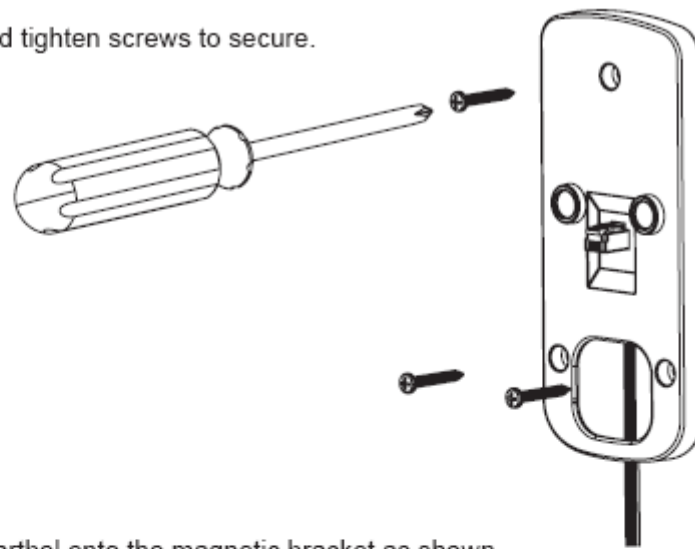

4.8

Affix Smartbel onto the magnetic bracket as shown.

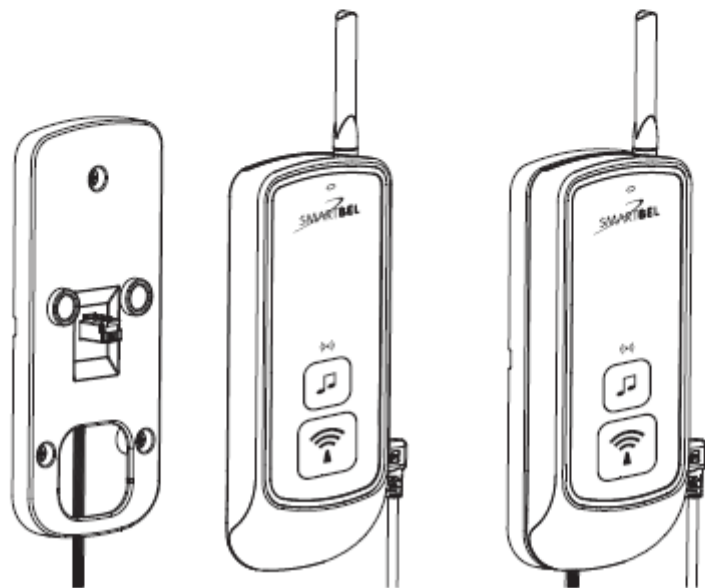

4.9

Secure the RJ12 cable at 25cm intervals using cable clips or the adhesive strips supplied.

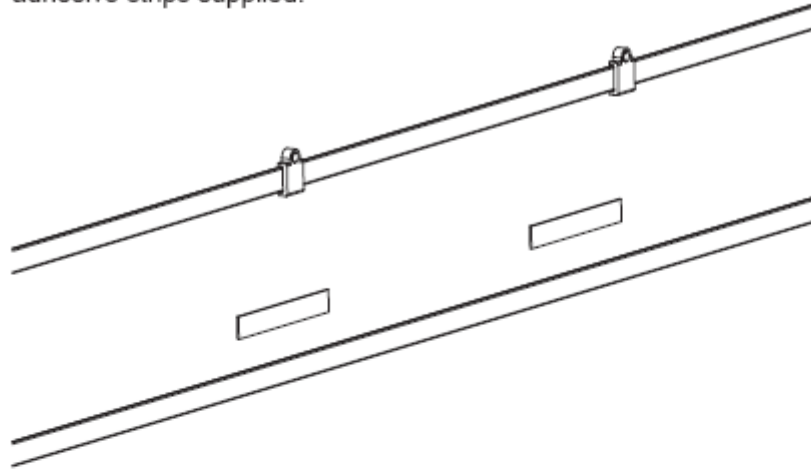

Congratulations! Internal installation is now complete.

Smartbel User Guide

Congratulations! You are ready to begin using Smartbel.

To allow convenient and safe communication with door caller, it is recommended that you leave the unit set to "Smartbel" mode at all times.

To cancel communication, the "Doorbell" mode can be used. Smartbel will act in the same manner as a standard doorbell without the intercom feature.

Please select one of the following settings:

Doorbell Mode

What happens when someone rings my doorbell?

The doorbell rings normally. GSM is inactive.

How do I set "Doorbell" mode?

Press the "Doorbell / Smartbel" button until the icon remains unlit.



Unlit / Doorbell Mode

Smartbel Mode

What happens when someone rings my doorbell?

The doorbell rings normally.

Smartbel will simultaneously call your pre-activated numbers you entered at the activation stage.

The first number to answer will create a direct audio link from the Bell Push (External) to one of your pre-activated numbers, allowing you to speak to the person at your door from a mobile phone or any other landline telephone. GSM is active.

How do I set “Smartbel” mode?

Press the “Doorbell / Smartbel” button until the icon remains lit.



Lit / Smartbel Mode

Changing the tones of Smartbel

To change the musical tones of Smartbel, press the musical note indicated below. Each press will advance Smartbel onto the next tone.



Changing the Volume of Smartbel

The volume select is located on the rear of the Smartbel. Select between Low, Medium and High.

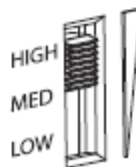

FAQ

Q: Will Smartbel work in the event of a Power cut?

A: Yes. Thanks to the in-built battery Smartbel will perform normally in the event of a power cut for up to 16 hours

Q: What happens if I am on my mobile phone, or in a poor signal area when Smartbel calls me?

A: Smartbel will simultaneously ring up to two other devices, and under normal circumstances one of these numbers will answer. In the event of the call not being answered by either of these two numbers, Smartbel will go through to the answer phone service for a maximum of four minutes if set.

Q: I cannot hear Smartbel ring when set to "Doorbell" mode

A: Switch volume switch to Loud mode or re-position Smartbel to another location.

Q: I am experiencing reception problems?

A1: You are most likely in a weak signal area. Please check coverage maps for your area. Coverage maps can be found at:

<http://consumers.ofcom.org.uk/2009/08/mobile-broadband-coverage-checker/>

A2: Please try re-positioning Smartbel in another location and re-run the quick connect signal check.

If you are still having reception issues an additional internal or external antenna may be required, please refer to optional accessories.

Q: I am concerned that the Bell push will get damaged being outside all year round

A: The bell push housing is made from an extremely tough impact resistant material and is waterproof to IP 64. It is unlikely to get damaged under normal use.

It is still however recommended that the bell push casing is checked and cleaned on a regular basis

Clean with a damp cloth only and avoid the use of detergents or chemical cleaners.

Optional Accessories

USB Power Lead Extensions	Item Code
3m USB power lead extension	42550180
5m USB power lead extension	42550181
10m USB power lead extension	42550182

MMCX Antenna

With 0.55m cable

Technical Specification

3.7v Lithium 850 mah/ 3.145Wh Ion Battery (CIBL-5B)
Quad Band GSM
Weight:125g (TBC)

IP64 Rated external housing

CE, FCC, ROHS, WEEE

Network Provider Helplines

Vodafone	08700 776655
Orange	07973 100450
T-Mobile	08454 125000
O2	08448 090222
3mobile	07782 333 333

FCC Warning

This device complies with Part 15 of the FCC Rules. Operation is subject to the following two conditions:

(1) this device may not cause harmful interference, and (2) this device must accept any interference received, including interference that may cause undesired operation.

NOTE 1: Any changes or modifications to this unit not expressly approved by the party responsible for compliance could void the user's authority to operate the equipment.

This device must be installed to provide a separation distance of at least 20 cm from all persons and must not be collocated or operating in conjunction with any other antenna or transmitter.