

User Manual

MAXELEGANT DEVELOP(H.K.) LIMITED IOS SERIES CONTROL CAR 35014/124805



Hereby, MAXELEGANT DEVELOP(H.K.)LIMITED,
declares that this IOS SERIES CONTROL CAR is
in compliance with the essential requirements and
other relevant provisions of Directive 1999/5/EC.



Parts



Racing car



Instruction manual



Signal booster



USB cable

Operation step

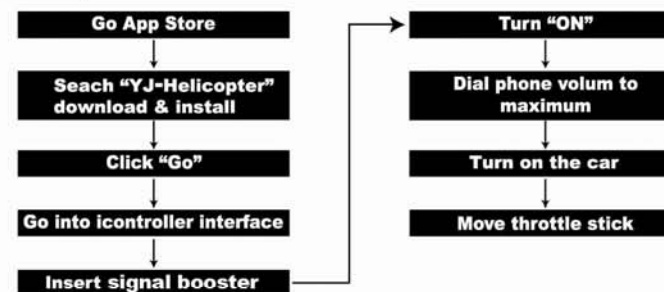

- 1 -

iController interface function name

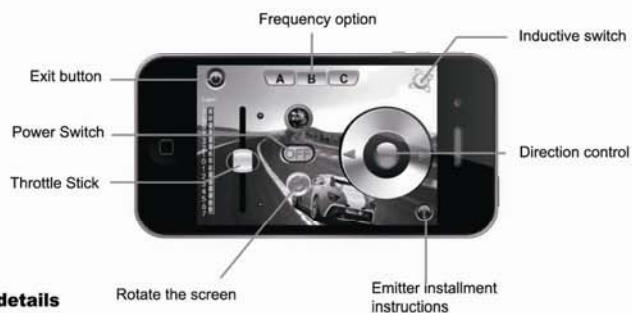

Function details

1.Bands Option

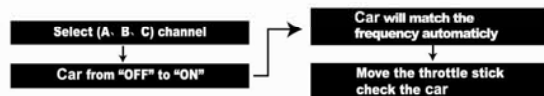

- 2 -

Function details

2. Inductive control switch

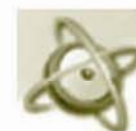

The state of lighted lamp is "ON"



The state of extinguished lamp is "OFF"

Install emitter

Bind and install the transmitter to your cell phone in the direction as shown in the arrows.

Caution:

Make sure the transmitter is correctly bound with your cell phone before installation. Otherwise, unexpected failure or wrong signals will come.



Plugin & Volume Maximum

- 3 -

Charge

1.Firstly, insert the USB cable into computer.



2.Car's charging:

Insert the USB cable's plug into car's charging port, then the lamp on the rechargeable line lights; the charging period is about 40-50 minutes, the charging finishes when the lamp extinguishes.



3.Transmitter's charging:

Insert the USB cable's plug into the signal booster's charging port, then the lamp on the rechargeable line lights; the charging period is about 50 minutes, and the charging finishes when the lamp extinguishes.

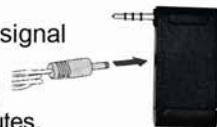

Cautions:
When the transmitter is flashing red light indicates no power. You should charge the batteries immediately.

-4-

Control methods

1.Turn left

When the direction stick waves left, the car turns left.

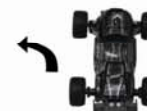

2.Turn right

When the direction stick waves right, the car turns right.



3.Fovward

When you push up the direction stick, the car moves forward.



4.Backward

When you push down the direction stick, the car moves backward.

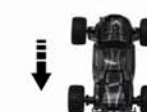

-5-

Inductive control

Switch to "Inductive" control, push up the throttle stick, swing your hands according to the following indication to control the direction of the car.

1.Tun left

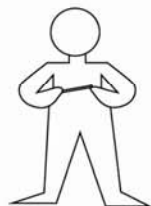

2.Tun right



-6-

Cautions

1. When the electric quantity of remote control is insufficient, the remote control range will be reduced slowly.
2. The remote control distance of car is about 10 meters, do not beyond the range, or it may affect handling.
3. If the electric quantity of the car is insufficient, it may affect the control distance and response speed.
4. If the car damages, please repair it in time and stop handling, or it may bring out more serious damage and hurt.

WARNING: Choking Hazard-Small parts.
Not for child under 3 year.

Trouble shooting

Symptom	Cause	Correction
Wheel can't move.	<ul style="list-style-type: none"> • ON/OFF switch is OFF. • Weak battery. 	<ul style="list-style-type: none"> • Set switch to ON. • Re-charge the battery pack.
Suddenly stop.	<ul style="list-style-type: none"> • Weak power. 	<ul style="list-style-type: none"> • Re-charge the battery pack.
The car no response. Lose the control.	<ul style="list-style-type: none"> • After put the transmitter to the headphone mini jack, the phone volume must be to maximum. • Check the light whether flashing on the 2.4G transmitter. • Transmitter's power is low, need to be charged. • Frequently need to be matched well. • Turn off all other 2.4G Transmitting devices. 	<ul style="list-style-type: none"> • Reset the correct channel. • Avoid these if possible, or choose another place to operate the car. • Change another environment to avoid direct lighting.

-7-

FCC station:

1. This device complies with Part 15 of the FCC Rules. Operation is subject to the following two conditions:

(1) This device may not cause harmful interference.

(2) This device must accept any interference received, including interference that may cause undesired operation.

2. Changes or modifications not expressly approved by the party responsible for compliance could void the user's authority to operate the equipment.

NOTE: This equipment has been tested and found to comply with the limits for a Class B digital device, pursuant to Part 15 of the FCC Rules. These limits are designed to provide reasonable protection against harmful interference in a residential installation.

This equipment generates uses and can radiate radio frequency energy and, if not installed and used in accordance with the instructions, may cause harmful interference to radio communications.

However, there is no guarantee that interference will not occur in a particular installation. If this equipment does cause harmful interference to radio or television reception, which can be determined by turning the equipment off and on, the user is encouraged to try to correct the interference by one or more of the following measures:

- Reorient or relocate the receiving antenna.

- Increase the separation between the equipment and receiver.

- Connect the equipment into an outlet on a circuit different from that to which the receiver is connected.

- Consult the dealer or an experienced radio/TV technician for help.