



Spin 3

SP314-53 / SP314-53N / SP314-53GN

SETUP GUIDE
SETUP GUIDE
SETUP GUIDE
SETUP GUIDE
SETUP GUIDE

Using the notebook for the first time

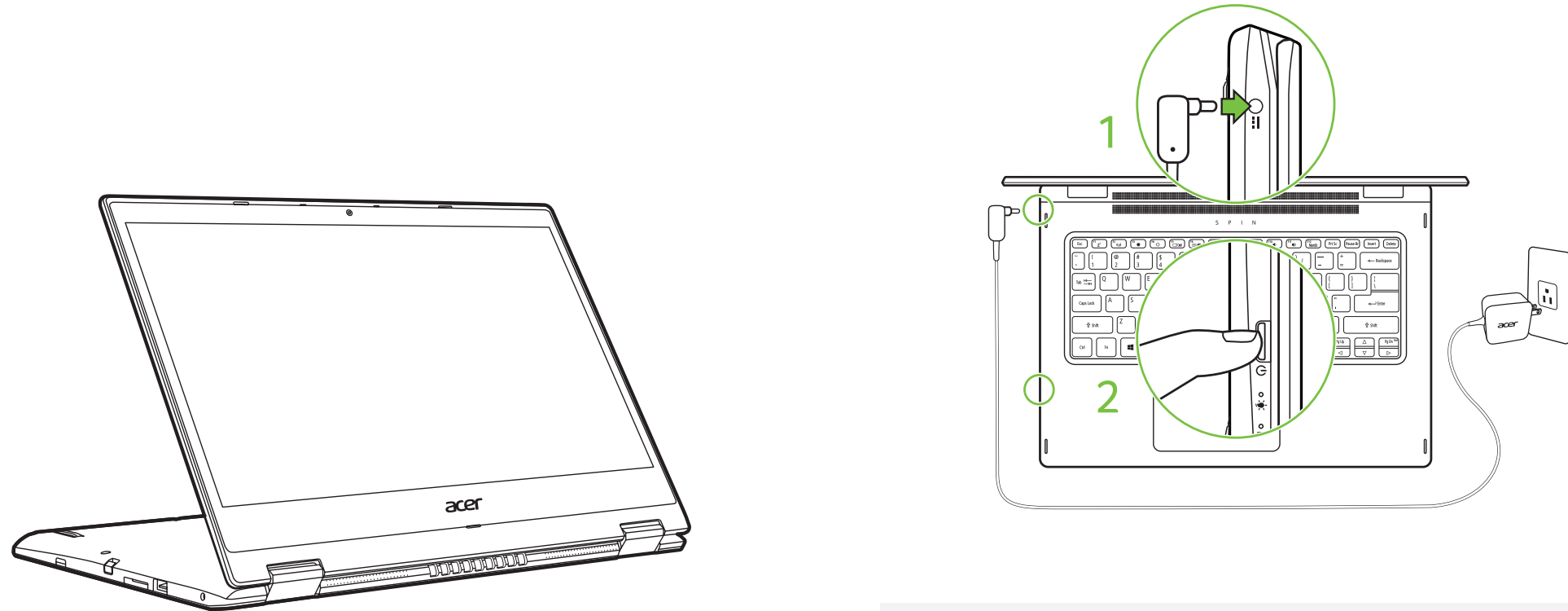

1 Plug in before turning on for the first time.

2 Press the power button.
Then follow the onscreen instructions to complete setup.

Note: Open the Start Menu and search for "Acer Documents" for help with setting up a network connection, using the touchpad, and other information which is important for your health and safety.

Flip between different modes

Desktop and Tablet mode in Windows 10

Notebook mode

When using the computer as a notebook, apps run in *Desktop* mode, which is optimized for use with a mouse and keyboard.

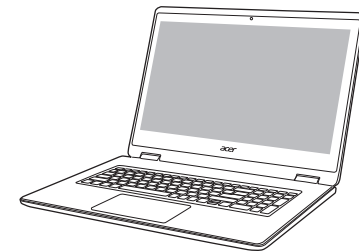

Pad mode

Flip the pad to use the computer as a pad. Apps expand to full screen if you enter *Tablet* mode, which is optimized for touch.

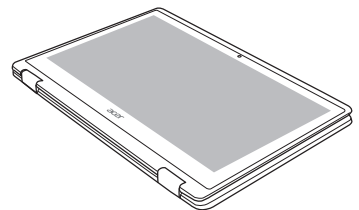

Display mode

Reverse the screen to function as a display, you can share the screen with others. In this mode, you can manually choose either *Tablet* or *Desktop* mode in *Action Center*.

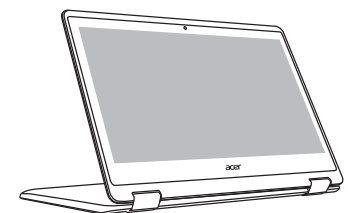

Note: You can choose how to switch between Tablet and Desktop mode. Open *Settings>System>Tablet mode* to see more options.

Getting started with Windows 10

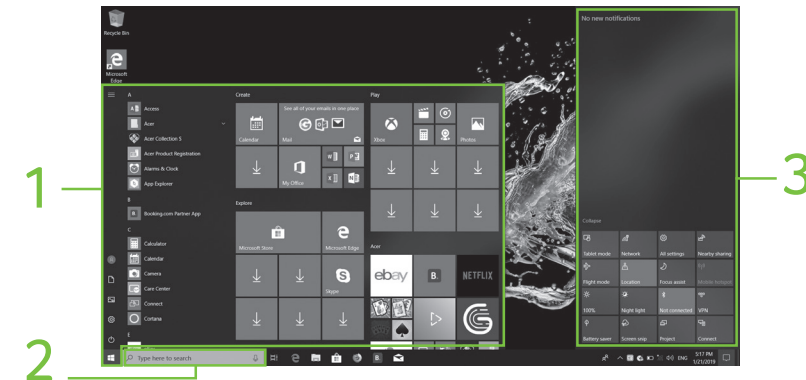

- 1. Start:** You can launch apps through Most used, all apps, or live tiles.
- 2. Cortana®:** Your personal assistant for finding apps, files, settings and information on the web.
- 3. Action Center:** You can view notifications and toggle quick actions to instantly adjust or open settings.

How do I use Cortana®?

Type anything you want to ask Cortana in the search box, or select the microphone icon and talk to Cortana.

Hey Cortana

To enable Cortana by saying 'Hey Cortana', click on the search box and then select the icon  in the lower-left side of the Cortana window. Then turn on the "Hey Cortana" switch.

* You must be signed in to your Microsoft account to use Cortana. The Cortana feature is being progressively rolled out globally. It will be replaced by Windows Search in countries where it is not available.

How do I switch between apps?

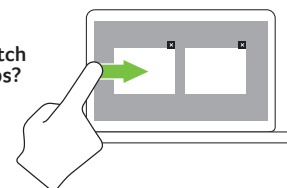

How do I access Action Center?

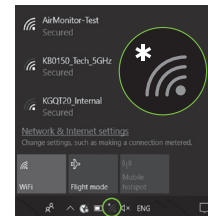
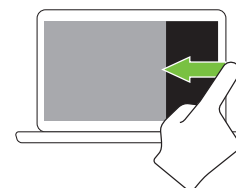

Connect to the internet

If using a wireless LAN:

Select the wireless icon at the lower-right corner of the screen and you will see the available wireless networks. Select a Wi-Fi network and enter the security key if required.

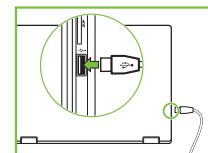

If using a LAN:

To connect to a wired network, please use a **USB-to-LAN converter cable** (optional). Please refer to your router's or ISP's user guide for additional assistance.



Improve your computer's performance with Acer Care Center

My System Information and User's Manual

My system gives you clear information on your computer's information such as CPU, memory, or device drivers, and allows you to download the User's Manual. The User's Manual can also be downloaded from the Acer support website by going to <http://go.acer.com/?id=17883>

System and Driver Updates

Update provides you the latest drivers and updates for your computer, without requiring you to go to a website and enter your serial number.

Recovery Management

Recovery Management allows you to quickly and easily back up or restore your computer.

Customer Support

Support is your one-stop place to find answers for questions you may have.

Illustrations are for reference only. Actual product specifications may vary. Information contained in this poster is for Windows platforms only. Other operating systems may not support all the features listed.





Spin 3

SP314-53 / SP314-53N / SP314-53GN

SETUP GUIDE
SETUP GUIDE
SETUP GUIDE
SETUP GUIDE
SETUP GUIDE

Using the notebook for the first time

Using the notebook for the first time

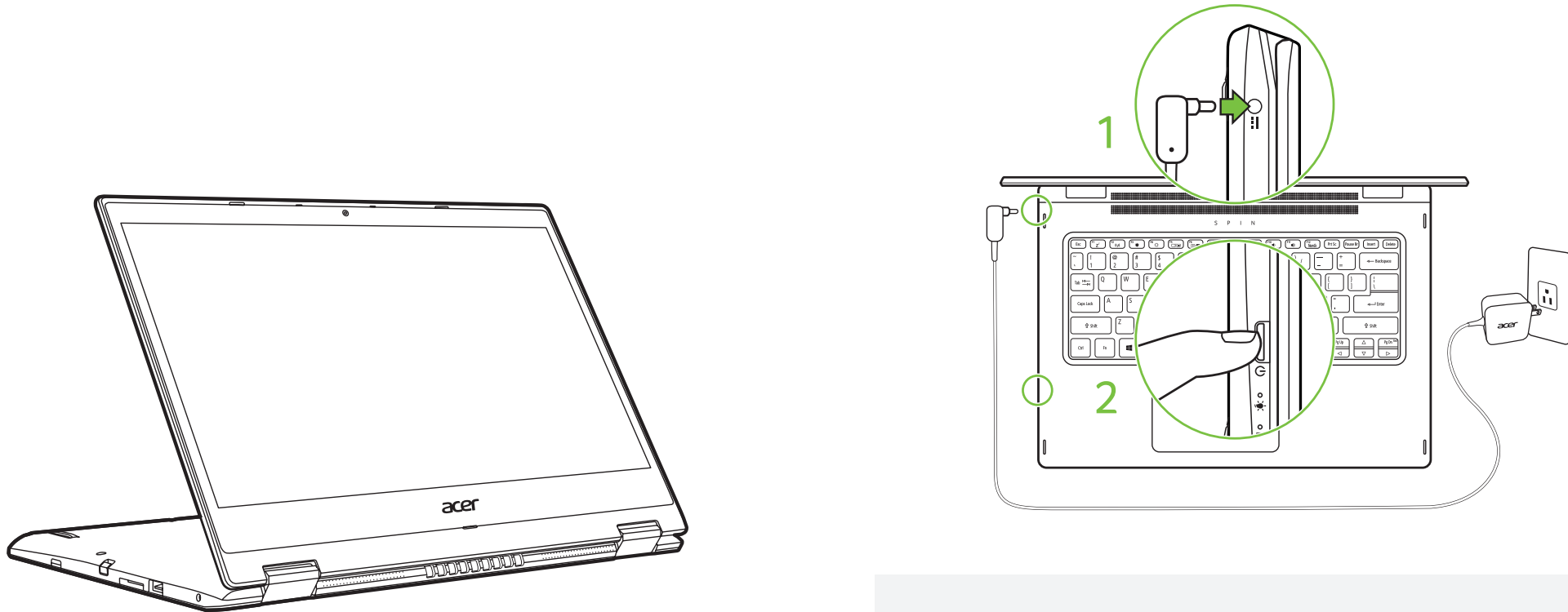

1 Plug in before turning on for the first time.
Plug in before turning on for the first time.

2 Press the power button.
Then follow the onscreen instructions to complete setup.
Press the power button.
Then follow the onscreen instructions to complete setup.

Note: Open the Start Menu and search for **'Acer Documents'** for help with setting up a network connection, using the touchpad, and other information which is important for your health and safety.
Note: Open the Start Menu and search for **'Acer Documents'** for help with setting up a network connection, using the touchpad, and other information which is important for your health and safety.

Flip between different modes

Flip between different modes

Desktop and Tablet mode in Windows 10

Desktop and Tablet mode in Windows 10

Notebook mode / Notebook mode

When using the computer as a notebook, apps run in *Desktop* mode, which is optimized for use with a mouse and keyboard.

When using the computer as a notebook, apps run in *Desktop* mode, which is optimized for use with a mouse and keyboard.

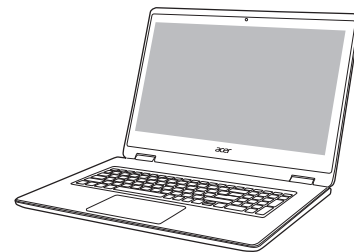

Pad mode / Pad mode

Flip the pad to use the computer as a pad. Apps expand to full screen if you enter *Tablet* mode, which is optimized for touch.

Flip the pad to use the computer as a pad. Apps expand to full screen if you enter *Tablet* mode, which is optimized for touch.

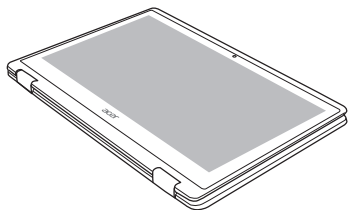

Display mode / Display mode

Reverse the screen to function as a display, you can share the screen with others. In this mode, you can manually choose either *Tablet* or *Desktop* mode in *Action Center*.

Reverse the screen to function as a display, you can share the screen with others. In this mode, you can manually choose either *Tablet* or *Desktop* mode in *Action Center*.

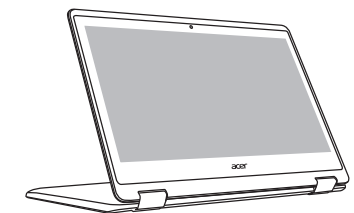

Note: You can choose how to switch between Tablet and Desktop mode. Open *Settings>System>Tablet mode* to see more options.
Note: You can choose how to switch between Tablet and Desktop mode. Open *Settings>System>Tablet mode* to see more options.

Getting started with Windows 10

Getting started with Windows 10

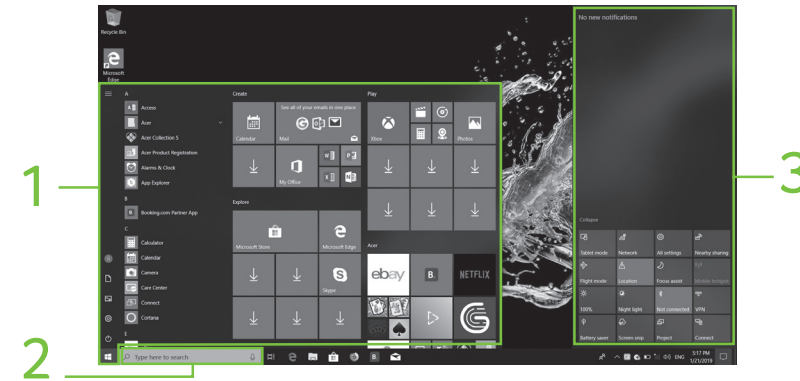

1. **Start:** You can launch apps through Most used, all apps, or live tiles.
2. **Cortana®:** Your personal assistant for finding apps, files, settings and information on the web.
3. **Action Center:** You can view notifications and toggle quick actions to instantly adjust or open settings.

How do I use Cortana®?

Type anything you want to ask Cortana in the search box, or select the microphone icon and talk to Cortana.

Hey Cortana

To enable Cortana by saying 'Hey Cortana', click on the search box and then select the icon  in the lower-left side of the Cortana window. Then turn on the "Hey Cortana" switch.

* You must be signed in to your Microsoft account to use Cortana. The Cortana feature is being progressively rolled out globally. It will be replaced by Windows Search in countries where it is not available.

How do I switch between apps?

How do I switch between apps?

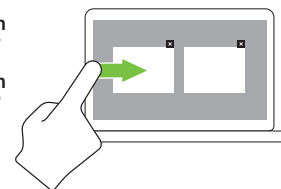

1. **Start:** You can launch apps through Most used, all apps, or live tiles.
2. **Cortana®:** Your personal assistant for finding apps, files, settings and information on the web.
3. **Action Center:** You can view notifications and toggle quick actions to instantly adjust or open settings.

How do I use Cortana®?

Type anything you want to ask Cortana in the search box, or select the microphone icon and talk to Cortana.

Hey Cortana

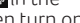
To enable Cortana by saying 'Hey Cortana', click on the search box and then select the icon  in the lower-left side of the Cortana window. Then turn on the "Hey Cortana" switch.

* You must be signed in to your Microsoft account to use Cortana. The Cortana feature is being progressively rolled out globally. It will be replaced by Windows Search in countries where it is not available.

How do I access Action Center?

How do I access Action Center?

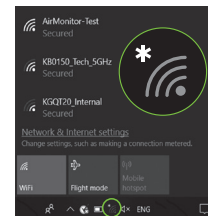
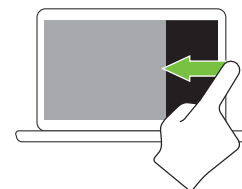

Connect to the internet

If using a wireless LAN:

Select the wireless icon at the lower-right corner of the screen and you will see the available wireless networks. Select a Wi-Fi network and enter the security key if required.

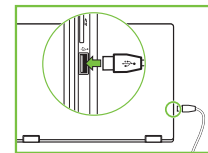

If using a LAN:

To connect to a wired network, please use a **USB-to-LAN converter cable** (optional). Please refer to your router's or ISP's user guide for additional assistance.

Connect to the internet

If using a wireless LAN:

Select the wireless icon at the lower-right corner of the screen and you will see the available wireless networks. Select a Wi-Fi network and enter the security key if required.

If using a LAN:

To connect to a wired network, please use a **USB-to-LAN converter cable** (optional). Please refer to your router's or ISP's user guide for additional assistance.



Improve your computer's performance with Acer Care Center

My System Information and User's Manual

My system gives you clear information on your computer's information such as CPU, memory, or device drivers, and allows you to download the User's Manual. The User's Manual can also be downloaded from the Acer support website by going to <http://go.acer.com/?id=17883>

System and Driver Updates

Update provides you the latest drivers and updates for your computer, without requiring you to go to a website and enter your serial number.

Recovery Management

Recovery Management allows you to quickly and easily back up or restore your computer.

Customer Support

Support is your one-stop place to find answers for questions you may have.

Illustrations are for reference only. Actual product specifications may vary. Information contained in this poster is for Windows platforms only. Other operating systems may not support all the features listed.



Improve your computer's performance with Acer Care Center

My System Information and User's Manual

My system gives you clear information on your computer's information such as CPU, memory, or device drivers, and allows you to download the User's Manual. The User's Manual can also be downloaded from the Acer support website by going to <http://go.acer.com/?id=17883>

System and Driver Updates

Update provides you the latest drivers and updates for your computer, without requiring you to go to a website and enter your serial number.

Recovery Management

Recovery Management allows you to quickly and easily back up or restore your computer.

Customer Support

Support is your one-stop place to find answers for questions you may have.

Illustrations are for reference only. Actual product specifications may vary. Information contained in this poster is for Windows platforms only. Other operating systems may not support all the features listed.





Spin 3

SP314-53 / SP314-53N / SP314-53GN

SETUP GUIDE
SETUP GUIDE
SETUP GUIDE
SETUP GUIDE
SETUP GUIDE

Using the notebook for the first time

Using the notebook for the first time / Using the notebook for the first time

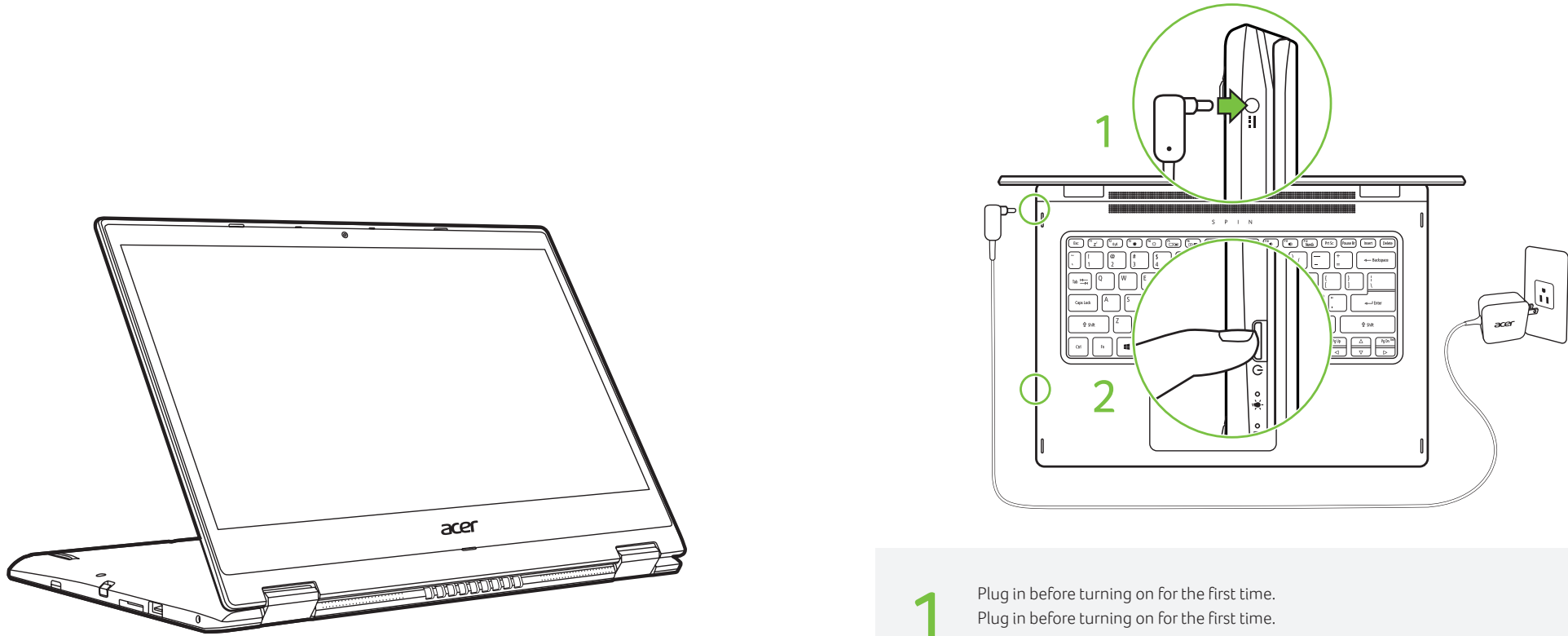

- 1 Plug in before turning on for the first time.
Plug in before turning on for the first time.
Plug in before turning on for the first time.

- 2 Press the power button.
Then follow the onscreen instructions to complete setup.
Press the power button.
Then follow the onscreen instructions to complete setup.
Press the power button.
Then follow the onscreen instructions to complete setup.

Note: Open the Start Menu and search for 'Acer Documents' for help with setting up a network connection, using the touchpad, and other information which is important for your health and safety.
Note: Open the Start Menu and search for 'Acer Documents' for help with setting up a network connection, using the touchpad, and other information which is important for your health and safety.
Note: Open the Start Menu and search for 'Acer Documents' for help with setting up a network connection, using the touchpad, and other information which is important for your health and safety.

Flip between different modes

Flip between different modes / Flip between different modes

Desktop and Tablet mode in Windows 10

Desktop and Tablet mode in Windows 10

Desktop and Tablet mode in Windows 10

Notebook mode / Notebook mode / Notebook mode

When using the computer as a notebook, apps run in *Desktop* mode, which is optimized for use with a mouse and keyboard.

When using the computer as a notebook, apps run in *Desktop* mode, which is optimized for use with a mouse and keyboard.

When using the computer as a notebook, apps run in *Desktop* mode, which is optimized for use with a mouse and keyboard.



Pad mode / Pad mode / Pad mode

Flip the pad to use the computer as a pad. Apps expand to full screen if you enter *Tablet* mode, which is optimized for touch.

Flip the pad to use the computer as a pad. Apps expand to full screen if you enter *Tablet* mode, which is optimized for touch.

Flip the pad to use the computer as a pad. Apps expand to full screen if you enter *Tablet* mode, which is optimized for touch.

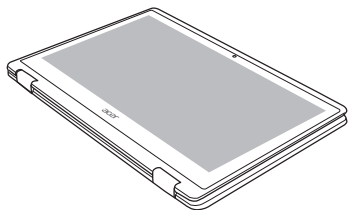

Display mode / Display mode / Display mode

Reverse the screen to function as a display, you can share the screen with others. In this mode, you can manually choose either *Tablet* or *Desktop* mode in *Action Center*.

Reverse the screen to function as a display, you can share the screen with others. In this mode, you can manually choose either *Tablet* or *Desktop* mode in *Action Center*.

Reverse the screen to function as a display, you can share the screen with others. In this mode, you can manually choose either *Tablet* or *Desktop* mode in *Action Center*.

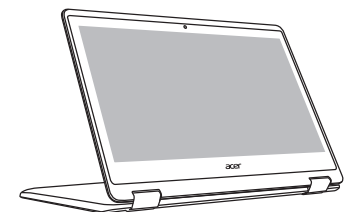

Note: You can choose how to switch between Tablet and Desktop mode. Open *Settings>System>Tablet mode* to see more options.
Note: You can choose how to switch between Tablet and Desktop mode. Open *Settings>System>Tablet mode* to see more options.
Note: You can choose how to switch between Tablet and Desktop mode. Open *Settings>System>Tablet mode* to see more options.

Getting started with Windows 10

Getting started with Windows 10 / Getting started with Windows 10



1. **Start:** You can launch apps through Most used, all apps, or live tiles.
2. **Cortana®:** Your personal assistant for finding apps, files, settings and information on the web.
3. **Action Center:** You can view notifications and toggle quick actions to instantly adjust or open settings.

How do I use Cortana®?

Type anything you want to ask Cortana in the search box, or select the microphone icon and talk to Cortana.

Hey Cortana

To enable Cortana by saying 'Hey Cortana', click on the search box and then select the icon  in the lower-left side of the Cortana window. Then turn on the "Hey Cortana" switch.

* You must be signed in to your Microsoft account to use Cortana. The Cortana feature is being progressively rolled out globally. It will be replaced by Windows Search in countries where it is not available.

How do I switch between apps?

How do I switch between apps?

How do I switch between apps?

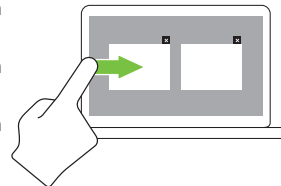

How do I use Cortana®?

Type anything you want to ask Cortana in the search box, or select the microphone icon and talk to Cortana.

Hey Cortana

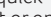
To enable Cortana by saying 'Hey Cortana', click on the search box and then select the icon  in the lower-left side of the Cortana window. Then turn on the "Hey Cortana" switch.

How do I use Cortana®?

Type anything you want to ask Cortana in the search box, or select the microphone icon and talk to Cortana.

Hey Cortana

To enable Cortana by saying 'Hey Cortana', click on the search box and then select the icon  in the lower-left side of the Cortana window. Then turn on the "Hey Cortana" switch.

* You must be signed in to your Microsoft account to use Cortana. The Cortana feature is being progressively rolled out globally. It will be replaced by Windows Search in countries where it is not available.

How do I switch between apps?

How do I switch between apps?

How do I switch between apps?

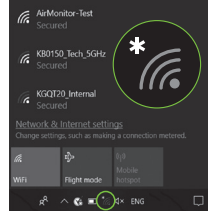
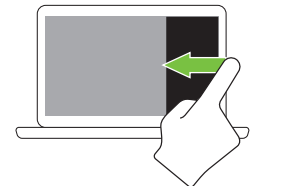

Connect to the internet

If using a wireless LAN:

Select the wireless icon at the lower-right corner of the screen and you will see the available wireless networks. Select a Wi-Fi network and enter the security key if required.

Connect to the internet

If using a wireless LAN:

Select the wireless icon at the lower-right corner of the screen and you will see the available wireless networks. Select a Wi-Fi network and enter the security key if required.

Connect to the internet

If using a wireless LAN:

Select the wireless icon at the lower-right corner of the screen and you will see the available wireless networks. Select a Wi-Fi network and enter the security key if required.

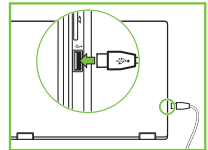

Connect to the internet

To connect to a wired network, please use a **USB-to-LAN converter cable** (optional). Please refer to your router's or ISP's user guide for additional assistance.

Connect to the internet

To connect to a wired network, please use a **USB-to-LAN converter cable** (optional). Please refer to your router's or ISP's user guide for additional assistance.

Connect to the internet

To connect to a wired network, please use a **USB-to-LAN converter cable** (optional). Please refer to your router's or ISP's user guide for additional assistance.



Improve your computer's performance with Acer Care Center

My System Information and User's Manual

My system gives you clear information on your computer's information such as CPU, memory, or device drivers, and allows you to download the User's Manual. The User's Manual can also be downloaded from the Acer support website by going to <http://go.acer.com/?id=17883>

System and Driver Updates

Update provides you the latest drivers and updates for your computer, without requiring you to go to a website and enter your serial number.

Recovery Management

Recovery Management allows you to quickly and easily back up or restore your computer.

Customer Support

Support is your one-stop place to find answers for questions you may have.

Illustrations are for reference only. Actual product specifications may vary. Information contained in this poster is for Windows platforms only. Other operating systems may not support all the features listed.



Improve your computer's performance with Acer Care Center

My System Information and User's Manual

My system gives you clear information on your computer's information such as CPU, memory, or device drivers, and allows you to download the User's Manual. The User's Manual can also be downloaded from the Acer support website by going to <http://go.acer.com/?id=17883>

System and Driver Updates

Update provides you the latest drivers and updates for your computer, without requiring you to go to a website and enter your serial number.

Recovery Management

Recovery Management allows you to quickly and easily back up or restore your computer.

Customer Support

Support is your one-stop place to find answers for questions you may have.

Illustrations are for reference only. Actual product specifications may vary. Information contained in this poster is for Windows platforms only. Other operating systems may not support all the features listed.



Improve your computer's performance with Acer Care Center

My System Information and User's Manual

My system gives you clear information on your computer's information such as CPU, memory, or device drivers, and allows you to download the User's Manual. The User's Manual can also be downloaded from the Acer support website by going to <http://go.acer.com/?id=17883>

System and Driver Updates

Update provides you the latest drivers and updates for your computer, without requiring you to go to a website and enter your serial number.

Recovery Management

Recovery Management allows you to quickly and easily back up or restore your computer.

Customer Support

Support is your one-stop place to find answers for questions you may have.

Illustrations are for reference only. Actual product specifications may vary. Information contained in this poster is for Windows platforms only. Other operating systems may not support all the features listed.

