

SC-1511M

**LCD Color Display
COLOR MONITOR
USER'S GUIDE**

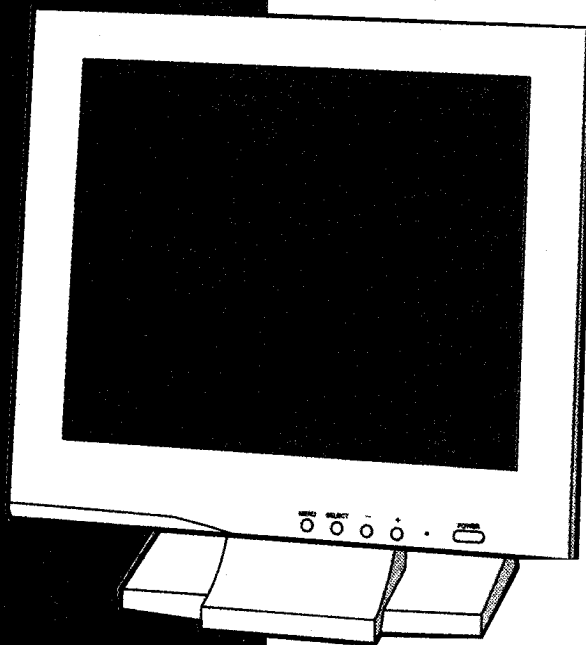

SYSCOM

Precautions

- Read all of these instructions and save them for later use.
- Follow all warnings and instructions on the product.
- Product
 - Do not cover or block the vent holes in the case.
 - Do not insert sharp objects or spill liquid into the LCD monitor through cabinet slots. They may cause accident fire, electric shock or failure.
 - Disconnect the power plug from the AC outlet if you will not use it for an indefinite period of time.
 - Do not attempt to service this product yourself, as opening or removing covers may expose you to dangerous voltage points or other risks.
 - Do not touch the screen directly with your fingers. You may damage the screen, and oil from your skin is difficult to move.
 - Do not apply pressure to the screen. The LCD is very delicate.
- Power
 - Use the type of power indicated on the marking label.
- Plugs
 - Do not remove any of the prongs of the monitor's three-pronged power plug.
 - Disconnect the power plug from the AC outlet under following conditions:
 - ▶ If you will not use it for an indefinite period time.
 - ▶ When the power cord or plug is damaged or frayed.
 - ▶ If the product does not operate normally when the operating instructions are followed. Adjust only those controls that are covered by the operating instructions. Improper adjustment of other controls may result in damage and will often require extensive work by a qualified technician to restore the product to normal operation.

- 
- ▶ If the product has been dropped or the cabinet has been damaged.
 - ▶ If the product exhibits a distinct change in performance, indicating a need for service.

- Plugs

- Do not allow anything to rest on the power cord.
- Do not locate this product where persons will walk on the cord.
- Use the proper power cord with correct attachment plug type. If the power source is 120V AC, use a power cord that has UL and C-UL approvals. If the power source is a 240V AC supply, use the tandem (T blade) type attachment plug with ground conductor power cord that meets the respective European country's safety regulations, such as VDE for Germany.
- Do not overload wall outlets or power cords. Ensure that the total of all units plugged into the wall outlet does not exceed 10 amperes.
- Ensure that the total ampere ratings on all units plugged into the extension cord is not above the cord's rating.
- If the power supply cord, which came with your monitor, is to be connected to the PC instead of the wall outlet, this equipment is to be used with UL/TUV approved computers with receptacle rated 240V AC, 2.0A (minimum).

- Environment

- Place the monitor on a flat and leveled surface.
- Place the monitor in a well-ventilated place.
- Keep the monitor away from:
overly hot, cold or humid places, places directly under sunlight, dusty surroundings, equipment that generate strong magnetic fields.



Federal Communication Commission Radio Frequency International Statement

This equipment has been tested and found to comply with the limits for a Class B digital device, pursuant to Part 15 of the FCC Rules. These limits are designed to provide reasonable protection against harmful interference in a residential installation. This equipment generates, uses and can radiate radio frequency energy and, if not installed and used in accordance with the instructions, may cause harmful interference to radio communications. However, there is no guarantee that interference will not occur in a particular installation. If this equipment does cause harmful interference to radio or television reception, which can be determined by turning the equipment off and on, the user is encouraged to try to correct the interference by one or more of the following measures:

- Reorient / Relocate the receiving antenna.
- Increase the separation between the equipment and receiver.
- Connect the equipment into an outlet on a circuit different from that to which the receiver is connected.
- Consult the dealer or an experienced radio/TV technician for help.

This device complies with Part 15 of the FCC Rules. Operation is subject to the following two conditions: (1) This device may cause harmful interference, and (2) this device must accept any interference received, including interference that may cause undesired operation.

Notice:

The use of non-shielded interface with this equipment is prohibited.

If necessary, the user should consult the dealer or an experienced radio / television technician for additional suggestions. The user may find the following booklet prepared by the Federal Communications Commission helpful. This booklet is available from the U.S. Government Printing Office Washington DC, 20402, Stock No. 004-000-00345-4.





The manufacture is not responsible for any radio or TV interference caused by unauthorized modification of this equipment. It is the responsibility of the user to correct such interference.

Caution: To meet FCC limits for a Class B computing device, a shielded signal cable should be used.

1. If you find some parts of the monitor display discolored due to magnetic fields generated by electrical facilities or appliances, turn off the monitor for at least 15 minutes. The degaussing circuit of the monitor will eliminate the discoloration.
2. Do not remove the monitor on its swivel base while the power is on, or it may cause discoloration. If discoloration occurs, follow the above mentioned procedure for adjustment.

Canadian Department Of Communications Compliance Statement

This equipment does not exceed Class B limits per radio noise emissions for a digital apparatus, set out in the Radio Interference Regulation of the Canadian Department of Communications. Operation in a residential area may cause unacceptable interference to radio and TV reception requiring the owner or operator to take whatever steps necessary to correct the interference.

Contents

• <i>Product Description</i>	•1
• <i>Package Contents</i>	•1
• <i>Product Features</i>	•2
• <i>Cleaning</i>	•2
• <i>Taking a Look</i>	•3
• <i>OSD Control Options</i>	•4 ~ 10
• <i>Power LED Display & Power Saving</i>	•11
<i>General Power Saving Mode</i>	
• <i>Troubleshooting</i>	•12
• <i>Display Modes</i>	•13

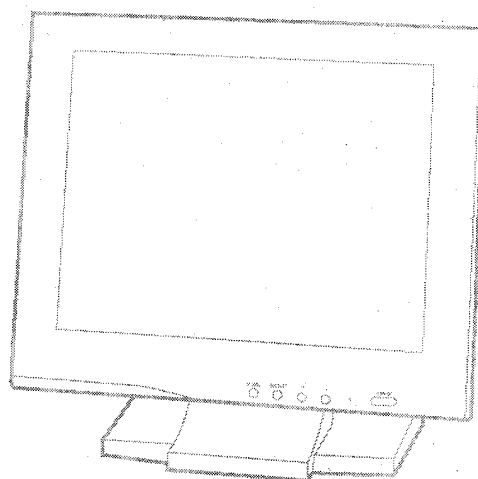

Product Description

Congratulations on your purchasing this new generation of monitor. Your LCD monitor incorporates high quality display into a small light weighted module. It has power-saving capabilities and emits no X-ray radiation. You will certainly benefit from this monitor in lots of ways; to name some of them, comfort, safety, health, and environmental protection.

This LCD monitor incorporates 15" color active matrix thin-film-transistor (TFT) liquid crystal display to provide superior display performance. A maximum resolution of XGA 1024x768 is ideal for displaying complex graphics and high definition images. Other outstanding designs that enhance this LCD monitor's performance are Plug & Play compatibility, audio system and OSD (On Screen Display) controls.

Package Contents

Included with your LCD monitor are following items:

- 15" TFT liquid crystal monitor
- D-sub 15 pin signal cable
- AC power cable
- AC/DC adaptor
- User's manual
- Installation diskette
- Audio cable (optional)
- RS232 cable for touch screen function (optional)
- DFP signal cable for digital input (optional)
- RCA signal cable for video-in function (optional)

Product Features

- High contrast color TFT LCD display support resolution up to XGA 1024x768. Compatible with IBM VGA, VESA, and Macintosh standards.
- Power management system conforms to VESA DPMS standard.
- Embedded universal power system.
- Support DDC1/2B for Plug & Play compatibility.
- Advanced OSD control for picture quality adjustment.
- Detachable stand for wall-mounting application.
- Optional imbedded audio system provides sound performance.
- Optional digital input function
- Optional video-in function
- Optional touch screen function
- Equipped with TCO selection.

Cleaning

- Gently wipe the screen with a clean camel hair lens brush, or a soft, clean, lint-free cloth. This removes dust and other particles that can scratch the screen.
- Do not apply pressure to the screen surface when wiping it clean.
- Do not pour or spray any liquid directly onto the screen or case of the LCD monitor. Chemical cleaners have been reported to damage the screen or case of the LCD monitor.

Taking a Look

Front View

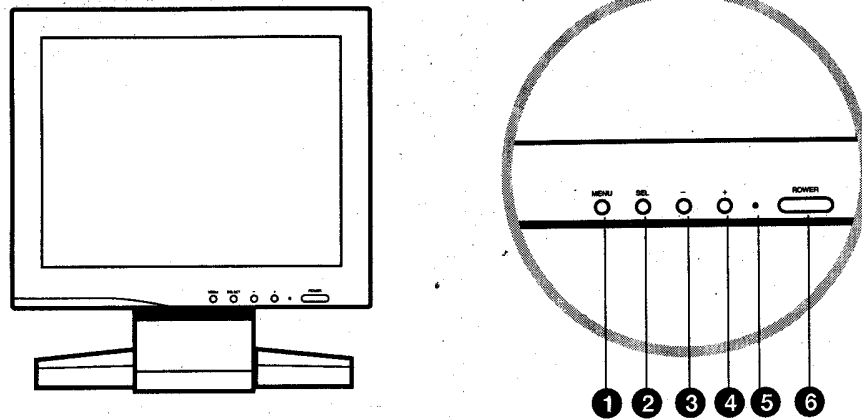

- The monitor front vessel may have different appearance by Model No.

1. Menu button

Pressing this button pops up and down the OSD menus on the screen.

2. Sel. button

Pressing this button pops up the Sub-OSD menus on the screen,

*Hot Key : Select button also can operate as "Auto configuration" function key without press menu button.

3. - button

This button is used to adjust the decreasing value of the selected OSD control option. Or move down the menu items

4. + button

This button is used to adjust the increasing value of the selected OSD control option. Or move up the menu item

*Hot Key : +, - button can directly adjust brightness control without press menu button

5. Power LED

This LED indicates different status when this unit operates in different modes.

6. Power Switch

Pressing this button turns the display system power on or off

Rear View

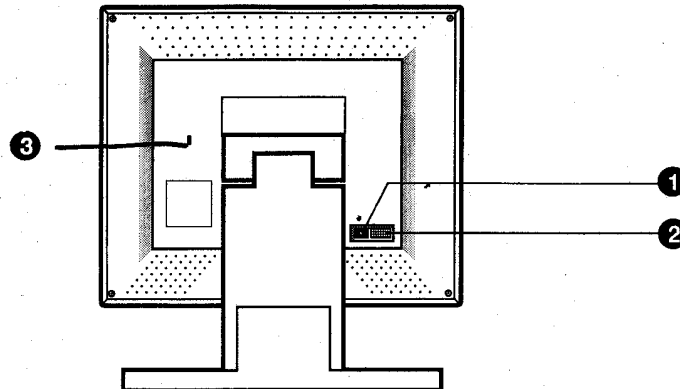

1. Power Connector

This is for connecting the power cable.

2. Signal Connector

This can be connected with the D-sub 15 pin signal connector.

3. Kensington Lock

Hardware Installation

1. Please make sure power off both LCD Monitor and PC
2. Connect VGA cable to LCD Monitor and PC VGA card
3. Connect power adaptor cord to power point and adaptor jack to LCD Monitor

Software Driver Installation

MS-widows 95/98/2000

1. Please refer to Driver diskette installguide.
2. Please refer to display mode to best resolution setting.

OSD Control Options

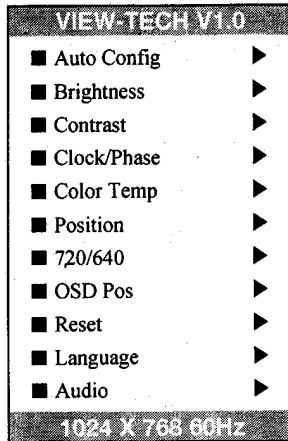

Auto Config

Press YES or No buttons to make LCD monitor adjust the related parameters automatically for optimal display status.

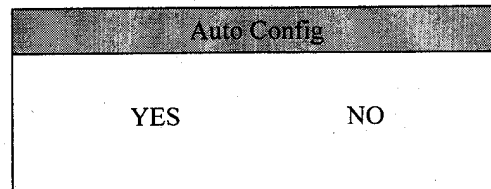

Brightness

Adjust the brightness using + and - buttons.

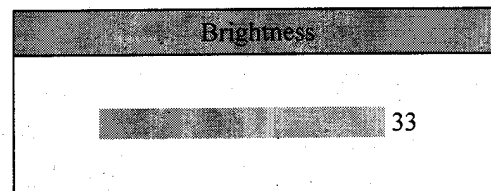
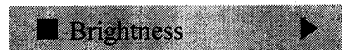

Contrast

Adjust the contrast using + or – buttons.

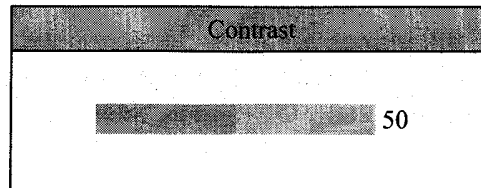

Clock/Phase

■ Clock

This item is used to decrease the vertical interference.

1. Select one display pattern from your computer.
2. Use + and – buttons on the LCD monitor to decrease the vertical interference to get the optimal display.

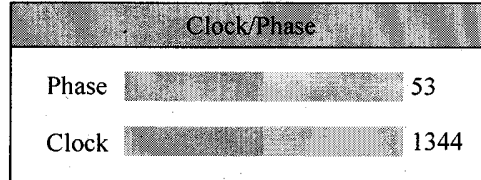

■ Phase

This item is used to decrease the horizontal interference.

2. Use + and – buttons on the LCD monitor to decrease the horizontal interference to get the optimal display.

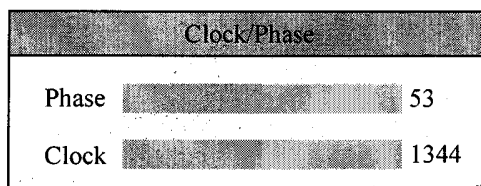

OSD Control Options

Color Temp

Select Color temperature function

This mointon has 3 color temperature, Color Temp 1(9300°K), Color Temp 2 (6500°K), and User Color. You can select desired color temperature to press select key after you can adjust value to pressing + or – button.

■ Color Temp ►

Color Temp	
Color Temp 1	
Color Temp 2	
User Color	►

User Color ►

User Color	
Red	49
Green	49
Blue	49

Position

■ H-Position

Pressing + moves the display images to the right; pressing – moves the display image to the left.



POSITION	
H - Position	67
V - Position	37

■ V-Position

Pressing + moves the display images upward; pressing – moves the display image downward.



POSITION	
H - Position	67
V - Position	37

720/640

This function can select Text mode(640X400)or Graphic mode(720X400)in DOS environment.



720 / 640
640 X 400

720 / 640
720 X 400

OSD Control Options

OSD Pos

■ OSD H-Pos

Adjust the OSD icon horizontal position using + and – buttons.



OSD Pos	
H - Position	50
V - Position	50

■ OSD V-Pos

Adjust the OSD icon vertical position using + and – buttons.



OSD Pos	
H - Position	50
V - Position	50

■ Reset

Press + or – button to recall previous values.



Reset	
YES	NO

Language

This item is used to select OSD language. There are 5 languages for OSD control: English, French, German, Spanish, and Italian.



Language				
Eng	Fra	Deu	Ita	Esp

Audio

It Controls Audio Volume
(*This is Optional Function)



Audio	
Volume	<div><div></div></div> 35

Power LED Display & Power Saving General Power Saving Mode

This monitor is equipped with a function for saving of energy, which supports the VESA Display Power Management Signal (DPMS) standard. This means that the monitor must be connected to a computer, which supports VESA DPMS to fulfill the requirements in the NUTEK specification 80329994/96. Time settings are adjusted from the system unit by software. From indicated inactivity to Power Saving Position "Off" the total time must not be set to more than 70 minutes.

SC-1511M

Mode	Power LED Color	Power Consumption
On	Green	21.4W max.
Off	Orange	<0.6W

Troubleshooting

The monitor does not respond after you turn on the system.

- Check if the Power Switch of monitor is turned on.
- Turn off the power and check the monitor's power cord and signal cable for proper connection.

The characters on the screen are dim.

- Refer to the Controls and Adjustments section to adjust the brightness.

The screen is blank.

- During operation, the monitor screen may automatically turn off as a result of Power Saving feature. Press any key to see if the screen comes back.
- Refer to the Controls and Adjustments section to adjust the brightness.

The screen flashes when it's initialized.

- Turn off the monitor and turn it on again.

Display Mode

Standard	Support Mode	Resolution	H.Scan	V.ScanM	Pixel
IBM	EGA	640 × 350	31.5KHz	70.0Hz	25.17MHz
	CGA	640 × 400	31.5KHz	70.0Hz	25.17MHz
	DOS	720 × 400	31.5KHz	70.0Hz	28.30MHz
VESA IBM Compotible	VGA	640 × 480	31.5KHz	60.0Hz	25.17MHz
		640 × 480	37.9KHz	72.0Hz	31.5MHz
		640 × 480	37.5KHz	75.0Hz	31.5MHz
	SVGA	800 × 600	35.1KHz	56.0Hz	36.0MHz
		800 × 600	37.9KHz	60.0Hz	40.0MHz
		800 × 600	48.1KHz	72.0Hz	50.0MHz
		800 × 600	46.9KHz	75.0Hz	49.5MHz
	XGA	1024 × 768	48.4KHz	60.0Hz	65.0MHz
		1024 × 768	56.5KHz	70.0Hz	75.0MHz
		1024 × 768	60.0KHz	75.0Hz	78.0MHz
Macintosh	VGA	640 × 480	35.0KHz	66.7Hz	30.2MHz
	SVGA	832 × 624	49.7KHz	74.6Hz	57.3MHz
	XGA	1024 × 768	60.2KHz	75.0Hz	80.0MHz