

ANTENNA INFORMATION

OEM	Lenovo
ODM	LCFC
Platform model name	ThinkBook Plus G5 Station
Intel platform (ex: Yes, No or NA)	Yes
Platform type (ex: regular NB, convertible PC, AIO...etc)	regular NB
SAR minimum separation (mm)	3.33

Antenna manufacturer	Company name	HongBo
	Address	NO.8,Liuzhou Road, Yushan Industrial Park,High&New Technology Development Area,Changshu City,Jiangsu Province
Test location	Company name	HB
	Address	NO.8,Liuzhou Road, Yushan Industrial Park,High&New Technology Development Area,Changshu City,Jiangsu Province
Test Personnel	Name(Full name)	Jay.Sheng
	E-mail	shengguangjie@hb-cv.com
	Tel/Mobile	15995693789
Testing date		2024/02/23

Antenna Part number	Main	DC330023E00
	Aux	DC330023E10
Antenna type (ex: PIFA, Dipole...etc)		PIFA

Antenna Peak gain w/ cable loss (dBi)*										
	2.4GHz 2400-2483.5 MHz	5.2GHz 5150-5250MHz	5.3GHz 5250-5350MHz	5.6GHz 5470-5725MHz	5.8GHz 5725-5850MHz	5.9GHz 5850-5895MHz	6.2GHz 5925-6425MHz	6.5GHz 6425-6525MHz	6.7GHz 6525-6875MHz	7.0 GHz 6875-7125MHz
Main	0.36	1.48	2.66	3.61	3.61	2.60	3.27	3.41	3.41	2.18
Aux	0.96	0.89	1.68	1.70	1.88	0.43	2.54	2.04	2.13	1.27

Cable Assembly Part Number and Information					
	Cable PN	Cable length(mm)	Cable diameter(mm)	Impedance(ohm)	Connector type
Main	SY113L/50-048	197	1.13	50	I-pex
Aux	SY113L/50-050	418	1.13	50	I-pex

* 3D Antenna Peak Gain required being test in system basis.

Annex A. Photographs

A.1 Setup Photo

<insert test diagram here for test site utilized>



A.2 Test sample

Main Antenna

Antenna Drawing

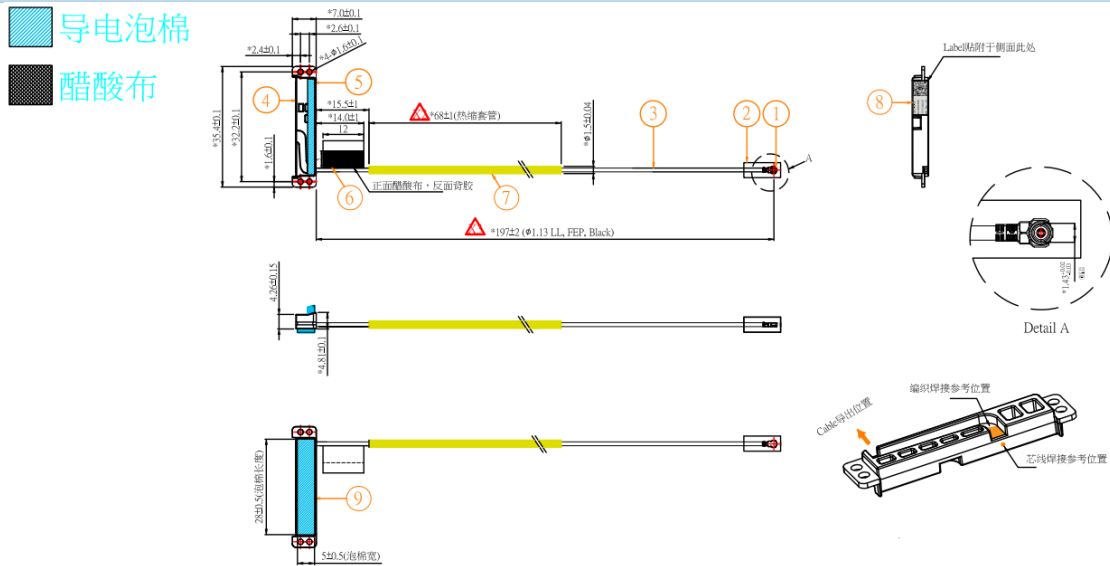

Antenna Photo

Front

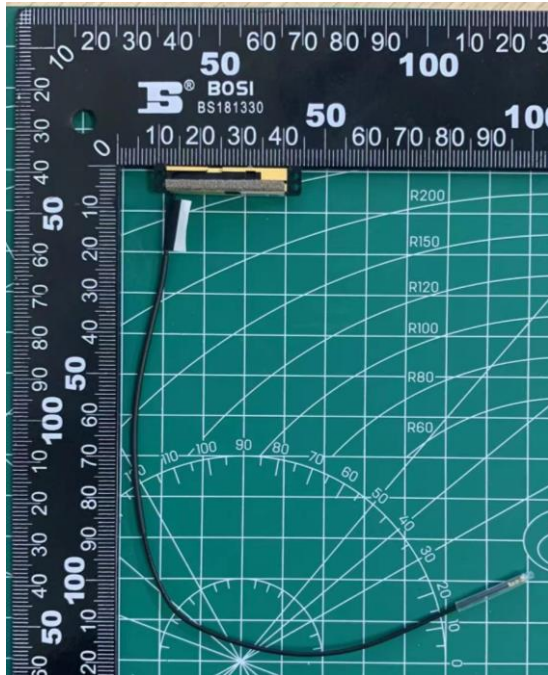

[Back](#)

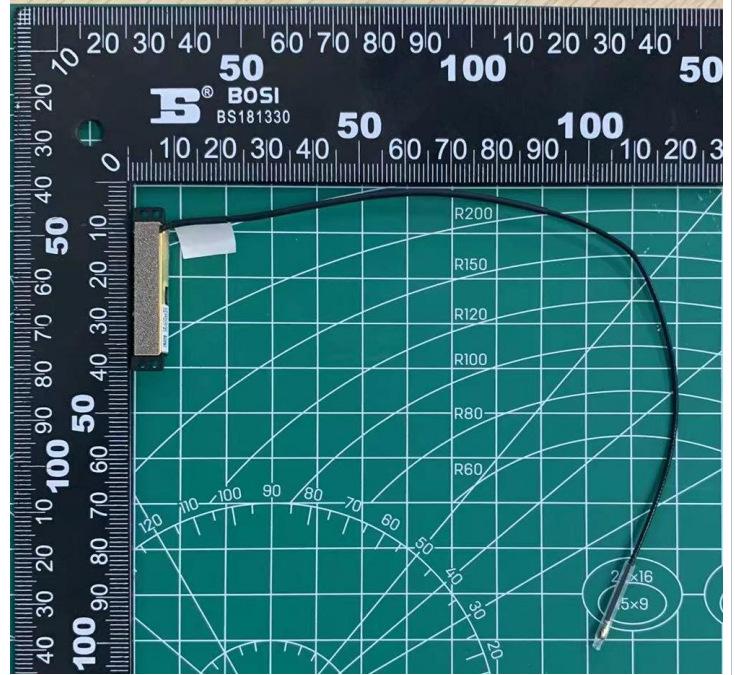

Note: antenna photo should include L type ruler

Aux Antenna

Antenna Drawing

导电泡棉

醋酸布

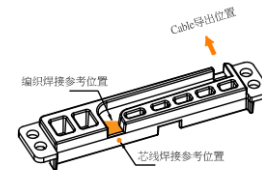
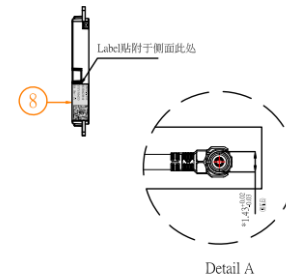
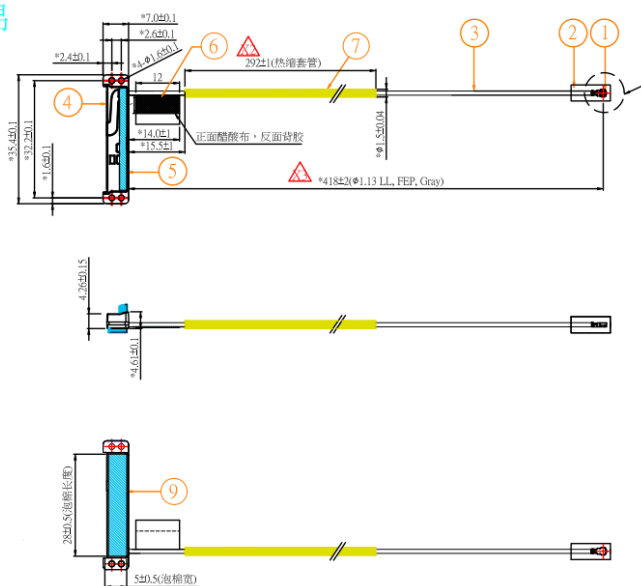

Antenna Photo

Front



Back

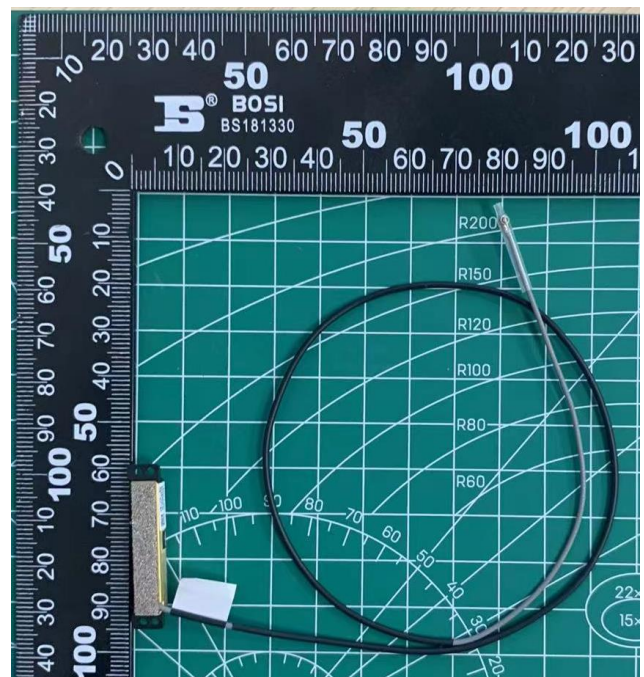

Note: antenna photo should include L type ruler

Annex B. Antenna Location

B.1 Antenna Host Platform Location Information

Include a dimensioned photo(s) or dimensioned drawing(s) of Main and Aux antenna placements (measurements are not required for receive-only antenna).

Any antenna that transmits must show dimensions to bottom of laptop. Provide a description of the materials that are used for supporting or surrounding transmit antennas; for example, non-conductive plastics vs. conductive coated plastic or metallic materials.

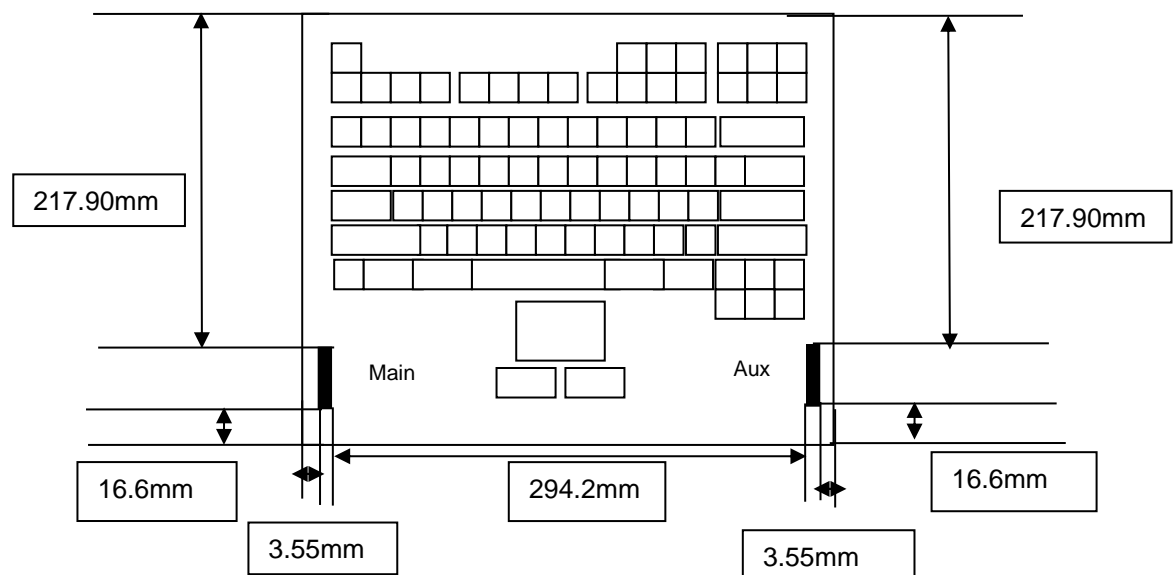

B.2 Antenna dimensional information for SAR evaluation

Include a dimensioned photo(s) or dimensioned drawing(s) showing the distance (mm) between the transmit antennas and the user. For notebook/laptop hosts show lapheld position (example below). For tablet hosts show all orientations including lapheld, primary & secondary portrait, primary & secondary landscape positions. Include a description of any proximity sensors or power throttling implementations that limit or exclude use of any host orientation.

