

EN	User manual	4
FR	Mode d'emploi	X
ES	Instrucciones de manejo	X



PHILIPS

Important safety instructions

This baby monitor is intended as an aid. It is not a substitute for responsible and proper adult supervision and should not be used as such.

Some of the following information may not apply to your particular product; however, when using baby monitor equipment, basic safety precautions should always be followed to reduce the risk of fire, electric shock and injury to persons, including the following:

- 1 Read this user manual carefully before using the product and keep it for future reference.
- 2 Follow all warnings and instructions marked on the product.
- 3 Unplug this product from the wall outlet before cleaning. Do not use liquid cleaners or aerosol cleaners. Use a damp cloth for cleaning.
- 4 Products should not be used while you are in a bathtub, shower or pool. Immersion of the product in water could cause an electrical shock.
- 5 Slots and openings in the cabinet back or bottom are provided for ventilation, to protect it from overheating. These openings should not be blocked or covered. The openings should never be blocked by placing the product on the bed, sofa, rug, or other similar surface. This product should not be placed in a built-in installation unless proper ventilation is provided.
- 6 This product should be operated only from the type of power source indicated on the type plate of the adapters (A-14, B14). If you are not sure of the type of power supply to your home, consult your dealer or local power company.
- 7 Do not allow anything to rest on the power cord. Do not locate this product where the cord will be abused by persons walking on it.
- 8 Do not overload wall outlets and extension cords as this can result in the risk of fire or electric shock.
- 9 Never push objects of any kind into this product through cabinet slots as they may touch dangerous voltage points or short out parts that could result in a risk of fire or electric shock. Never spill liquid of any kind on the product.
- 10 To reduce the risk of electric shock, do not disassemble this product, but take it to a qualified service personnel when service or repair work is required. Opening or removing covers (except battery compartment covers) may expose you to dangerous voltage or other risks. Incorrect reassembly can cause electric shock when the appliance is subsequently used.
- 11 Do not expose the product to extreme temperatures such as areas near a hot radiator or stove or in a hot car.
- 12 Do not place lighted candles, cigarettes, cigars, etc., on the product.

- 13** Unplug this product from the wall outlet and refer servicing to qualified service personnel under the following conditions:
 - A. When the power supply cord or plug is damaged or frayed.
 - B. If the product has been exposed to rain or water.
 - C. If the product does not operate normally by following the operating instructions.
 - D. If the product's cabinet has been damaged.
 - E. If the product exhibits a distinct change in performance.
- 14** Do not place this product on an unstable cart, stand or table. The product may fall, causing serious damage to the product.
- 15** Make sure the baby unit and adapter cable are always out of reach of the baby (at least 1 meter / 3 feet away).
- 16** Never place the baby unit inside the baby's bed or playpen.
- 17** Never cover the baby monitor (with a towel, blanket, etc.).

If your product utilizes batteries, the following additional precautions should be observed:

- 1** Use only the type and size of the battery(ies) specified in the user manual.
- 2** Do not dispose of the battery(ies) in fire. They may explode. Check with local regulations for possible special disposal instructions.
- 3** Do not open or mutilate the battery(ies). Released electrolyte is corrosive and may cause damage to the eyes or skin. It may be toxic if swallowed.
- 4** Exercise care in handling battery(ies) in order not to short out the battery(ies) with conducting materials such as rings, bracelets and keys. The batter(ies) or conductor may overheat and cause burns.
- 5** Do not attempt to recharge the battery(ies) provided with or identified for use with this product that are not intended to be charged. The battery(ies) may leak corrosive electrolyte or explode.
- 6** Do not attempt to rejuvenate the battery(ies) provided with or identified for use with this product by heating them. Sudden release of the battery(ies) electrolyte may occur causing burns or irritation to eyes or skin.
- 7** When replacing battery(ies), all batteries should be replaced at the same time. Missing fresh and discharged batteries could increase internal cell pressure and rupture the discharged battery(ies). (Applies to products employing more than one separately replaceable primary battery.)
- 8** When inserting battery(ies) into this product, the proper polarity or direction must be observed. Reverse insertion of battery(ies) can cause charging, and that may result in leakage or explosion.
- 9** Remove battery(ies) from this product if storing over 30 days because the battery(ies) could leak and damage the product.
- 10** Discard 'dead' battery(ies) as soon as possible since 'dead' batteries are more likely to leak in a product.
- 11** Do not store this product, or the battery(ies) provided with or identified for use with this product, in high-temperature areas. Batteries that are stored in a freezer or refrigerator for the purpose of extending shelf life should be protected from condensation during storage and defrosting. Batteries should be stabilized at room temperature prior to use after cold storage.

- I2** If your product use rechargeable battery(ies), charge the battery(ies) only in accordance with the instructions and limitation specified in the user manual.
- I3** Risk of explosion if batteries are replaced by an incorrect type. For the **parent unit**, always use **rechargeable** batteries.

SAFE THESE INSTRUCTIONS



CAUTION: Unplug power cord before replacing batteries.



Use only the mains adapters supplied with this baby monitor. Incorrect adapter polarity or voltage can seriously damage the baby monitor.

Adapters for baby unit and charger:

Input: 120 VAC 60 Hz

Output: 9 VDC 300 mA



THERE IS A RISK OF EXPLOSION IF THE BATTERIES ARE REPLACED BY AN INCORRECT TYPE.

Use 1.5V AA size alkaline batteries only for baby unit (batteries not supplied).

Use 1.2V AAA size NiMH rechargeable batteries only for parent unit (batteries supplied).

A. Baby unit

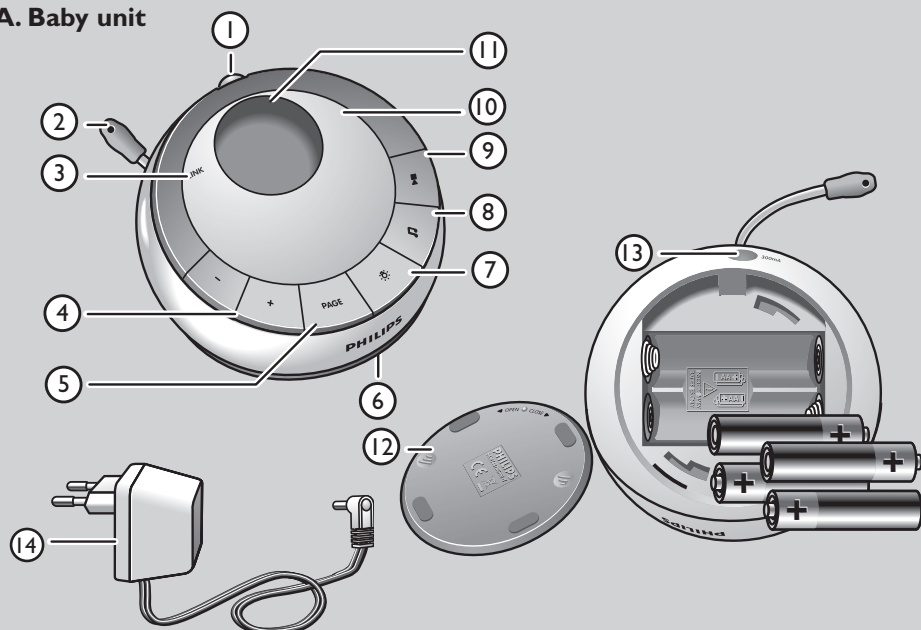

B. Parent unit

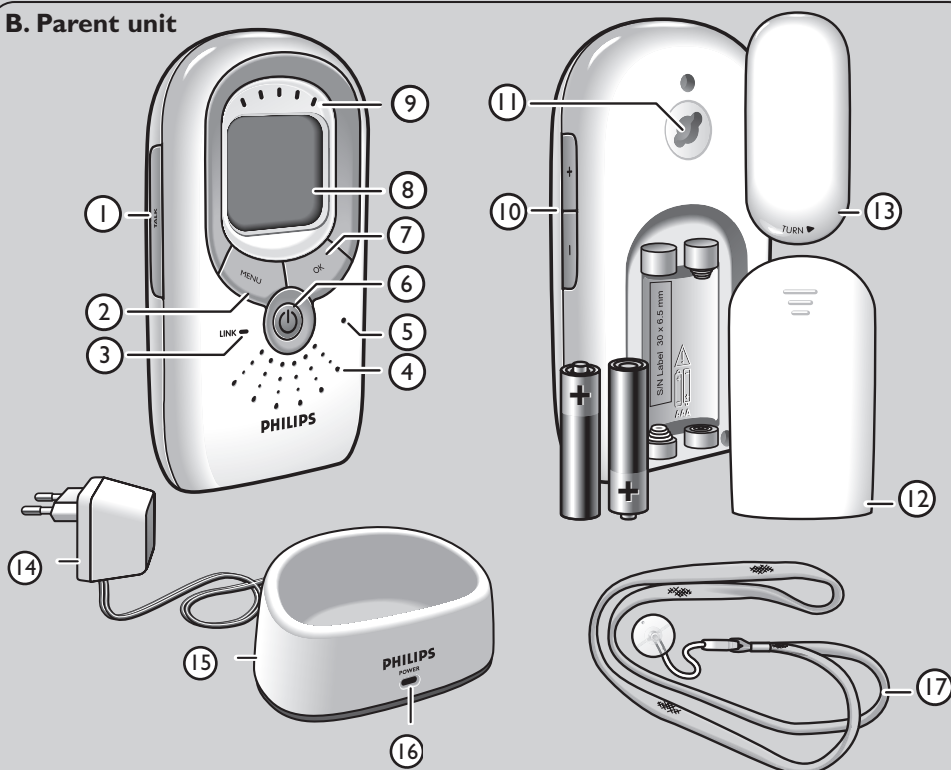

Legend of functions

A. Baby unit

- A-1 On/Off button (⏻)
- A-2 Temperature sensor
- A-3 LINK light
- A-4 Volume – / + buttons
- A-5 PAGE button
- A-6 Microphone
- A-7 Night light button (🌙)
- A-8 Lullaby button (🎵)
- A-9 Play/stop button (▶■)
- A-10 Night light
- A-11 Display
- A-12 Battery compartment cover
- A-13 DC 9V / 300mA power supply jack
- A-14 AC power adapter

B. Parent Unit

- B-1 TALK button
- B-2 MENU button
- B-3 LINK light
- B-4 Loudspeaker
- B-5 Microphone
- B-6 On/Off button (⏻)
- B-7 OK button
- B-8 Display
- B-9 Sound level lights
- B-10 Volume – / + buttons
- B-11 Recess for the belt clip or neck strap
- B-12 Battery compartment cover
- B-13 Belt clip
- B-14 AC power adapter
- B-15 Charging base
- B-16 POWER light
- B-17 Neck strap
- B-18 Travel bag



C. What else you need

Both units can be battery operated.

For battery-operated use you'll need:

- 4 x 1.5V AA non-rechargeable batteries for baby unit.
Not supplied.
- 2 x 1.2V AAA rechargeable batteries for parent unit. Supplied.

D. Display

88° Room temperature indicator

 Battery indicator

 Volume indicators

 Night light indicator

 Lullaby indicator

 Microphone sensitivity indicator

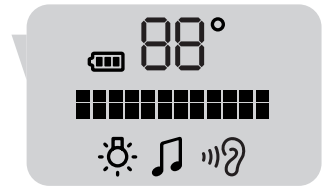

H i g h - Room temperature above temperature set in menu

L o w - Room temperature below temperature set in menu

N o t L i n k e d - No connection between units

V o l u m e ■ ■ ■ - Volume indication

P a u s e d - Playback of lullaby interrupted

Contents

2	Important Safety Instructions	22	Important information
3	Illustrations	22	Technical specifications
4	Legend of functions	22	Maintenance
4	Baby unit	23	Environmental information
4	Parent unit	23	Factory initialization mode
5	What else you need	24	Compliance information
5	Display	24	Radio Interference
6	Contents	25	FCC RF Radiation Exposure Statement
7	Welcome	18	Need help?
9	Getting your baby monitor ready for use	25	Guarantee and service
9	Baby unit	25	Service centers
10	Parent unit		
11	Using your baby monitor		
12	Other features		
12	Adjusting loudspeaker volume		
13	Talking to your baby		
13	Monitoring baby silently		
14	Switching nightlight on / off		
14	Paging the parent unit		
14	Playing lullabies		
15	Connecting / disconnecting belt clip and neck strap		
16	Menu options		
16	Menu operation - General explanation		
17	Switching nightlight on / off		
17	Playing lullabies		
17	Adjusting microphone sensitivity		
18	Switching sound alert on / off		
18	Setting room temperature range		
18	Setting temperature alert		
19	Troubleshooting		
21	Frequently asked questions		

Philips is dedicated to producing caring, reliable products to give parents the reassurance they need. You can trust this Philips baby monitor to provide round-the-clock support by ensuring you can always hear your baby clearly without any disturbing noise. Your SCD589 uses DECT technology which guarantees zero interference from other wireless appliances and a clear signal between the parent unit and baby unit.

Philips Baby Care, taking care together

Getting your baby monitor ready for use

Baby unit

The baby unit can be mains or battery operated.

When batteries are inserted, you'll have an automatic back-up in case of mains failure.

Mains operated use

- 1 Connect the power adapter cord (A-14) to the power supply jack (DC 9V / 300mA - A-13) of the baby unit.
- 2 Connect the AC power adapter (A-14) to a wall outlet.

→ **The baby unit is now ready for mains operated use!**

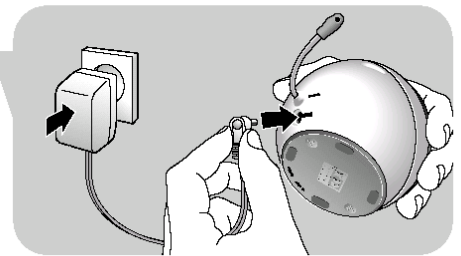

Getting your baby monitor ready for use

Battery operated use

- 1 Open the battery compartment by turning the cover (A-12) to the left (◀ OPEN), using the palm of your hand. Take off the cover.

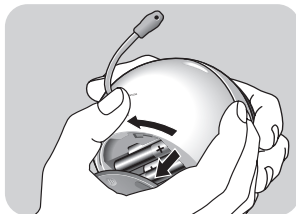

- 2 Insert four 1.5V AA batteries, noting the + and – configuration inside the battery compartment (batteries are not supplied; we recommend Philips Alkaline batteries).

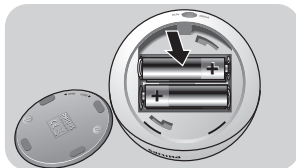

- 3 Put the battery compartment cover (A-12) back in place. Close the compartment by turning the cover (A-12) to the right (CLOSE ▶), using the palm of your hand.

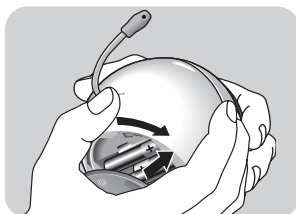

Note: When the units are switched off, in case of battery operated use, the batteries still discharge slowly.

→ The baby unit is now ready for battery operated use!

Parent unit

- 1 Open the battery compartment by sliding the cover (B-12) downwards.

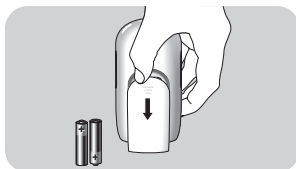

- 2 Insert the two 1.2V AAA size NiMH rechargeable batteries (supplied), noting the + and – configuration inside the battery compartment.



- 3 Put the battery compartment cover (B-12) back in place. Close the compartment by sliding the cover (B-12) upward until it clicks in position.



- 4 Connect the AC power adapter (B-14) of the charging base (B-15) to a wall outlet.

Getting your baby monitor ready for use

EN

- 5 Place the parent unit in the charging base (B-15).
 - > The POWER light (B-16) lights up red.
- 6 Leave the parent unit in the charging base until the batteries are fully charged (at least 16 hours).
 - > The POWER light (B-16) will stay red, even when batteries are fully charged.
 - > **When the batteries are fully charged, the parent unit can be taken out of the charging base and used cordlessly for at least 8 hours.**
 - > When the battery indicator () in the display (B-8) is empty and the parent unit beeps, battery power is low. Place the parent unit in the charging base (B-16) to recharge the batteries.

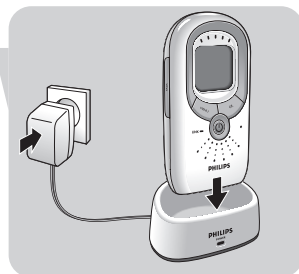

Notes:

- Operation time will be 8 hours only when the baby unit is transmitting 25% of the time and is in standby mode for the rest of the time (baby does not make sound).
- When the parent unit batteries are charged for the first time, operating time will be less than 8 hours. The batteries will use their maximum capacity after at least four times charging and discharging.

→ **The parent unit is now ready for use!**

Using your baby monitor

- 1 Position both units in the same room to test the connection. Make sure the baby unit is at least 1 meter / 3 feet away from the parent unit.
- 2 Press and hold the On/Off () button (A-1) on the baby unit for 2 seconds.
 - > The nightlight (A-10) lights up briefly.
 - > The display light (A-11) lights up indicating the current room temperature.
 - > **Not Linked** lights up on the display and the LINK light (A-3) starts blinking red, searching connection with the parent unit.

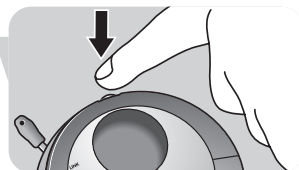
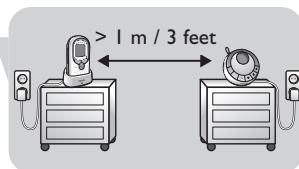

Using your baby monitor

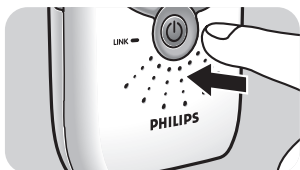

- 3 Press and hold the On/Off button (B-6) on the parent unit for 2 seconds.
 - > The sound level lights (B-9) briefly light up orange.
 - > The display (B-8) lights up. The battery indicator () and the room temperature light up in the display.
 - > The LINK light (B-3) lights up red briefly then starts blinking green, searching connection with the parent unit.
 - > The LINK light (B-3) on the parent unit blinks green and the LINK light (A-3) on the baby unit blinks red until connection has been established. This will take up to 30 seconds. Both LINK lights (A-3, B-3) then light continuously green and the message *Not Linked* will disappear from the baby unit the display (A-11).

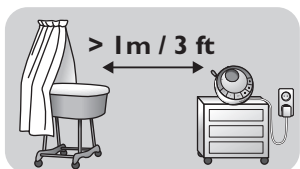
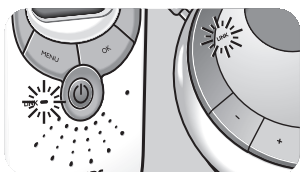

- 4 Position the baby unit at least 1 meter / 3 feet away from your baby.

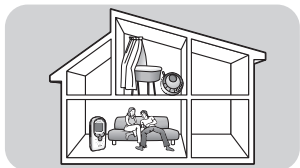

- 5 Position the parent unit at the desired place within the operating range of the baby unit but at least 1 meter / 3 feet away from the baby unit.
For more information on the operating range see 'Technical specifications'.

→ You can now monitor your baby!

Other features

Adjusting loudspeaker volume

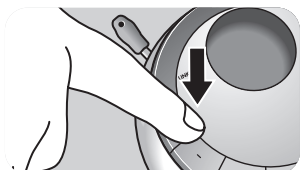

- Briefly press the volume + and – buttons (A-4) on the baby unit repeatedly until the desired loudspeaker volume for the baby unit has been reached.

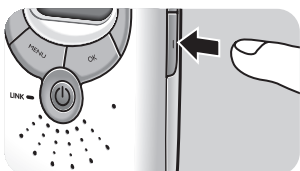

- Briefly press the volume + and – buttons (B-10) on the parent unit repeatedly until the desired loudspeaker volume for the parent unit has been reached.

> The displays (A-11, B-8) give visual feedback on the volume settings of the units:

- **VOLUME OFF**: parent unit volume switched off / monitoring baby silently;
- **VOLUME ■**: minimum volume (parent unit and baby unit);
- **VOLUME ■ ■ ■ ■ ■**: maximum volume (parent unit and baby unit).

Notes:

- If you press the Volume + and – buttons (A-4, B-10) too long, the volume will not be adjusted.
- You only need to adjust the baby unit volume when using the talk function (see below).
- **When the volume is set to a high level, the units consume more power.**

Talking to your baby (Talk function)

While using the TALK button (B-1) on the parent unit you can talk to your baby (e.g. to comfort your baby).

- Press and hold the TALK button (B-1) and talk clearly into the microphone (B-5).
- Release the TALK button (B-1) when finished talking.

Note: When the TALK button (B-1) is pressed, you can no longer hear your baby.

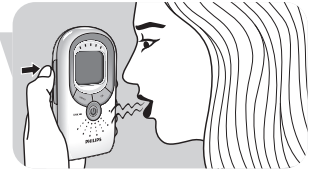
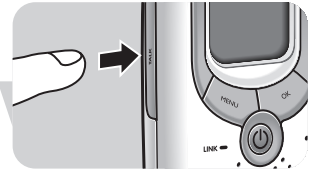

Monitoring baby silently

- Briefly press the Volume – button (B-10) on the parent unit repeatedly until the volume is switched off completely.

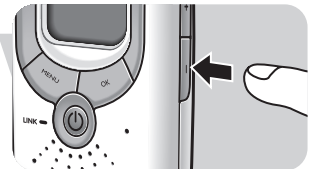

> When no sound is detected, all sound-level lights (B-9) will be off.



Other features



> When sound is detected the sound-level lights (B-9) light up orange.

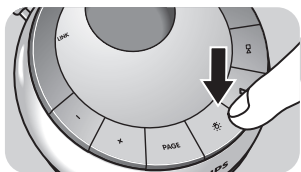

Switching night light on/off

- 1 Briefly press the night light button (☾), A-7) on the baby unit to switch on the night light (A-10).
> ☾ lights up on both displays.
- 2 Press the night light button (☾), A-7) again briefly to switch off the night light (A-10).
> The night light dims and gradually switches off.
> ☾ goes out on both displays.

- Switch off the night light when operating the baby unit on batteries. This saves power!

Note: If you press the night light button (☾), A-7) too long, the night light (A-10) will not switch on/off.

Paging the parent unit

When the parent unit is misplaced and the volume is switched off, you can use the PAGE button (A-5) on the baby unit to locate the parent unit.



- 1 Briefly press the PAGE button (A-5) on the baby unit
> P29 in9 appears on both displays (A-11, B-8).
> The parent unit will automatically reset to medium volume level and a paging alert will sound.
- 2 To stop the paging alert, press the page button (A-5) again briefly or any button on the parent unit

Note: If you press the PAGE button (A-5) too long, the paging alert will not sound.

Playing lullabies

- 1 Briefly press the lullaby button (🎵, A-8) on the baby unit repeatedly to select one out of five available lullabies

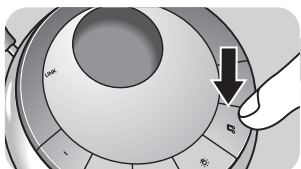

2 Briefly press the play/stop button (▶■, A-9) to play the selected lullaby.

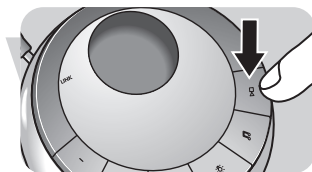

- Briefly press the OK button (B-7) on the parent unit to interrupt playback of the lullaby. Press the play/stop button (▶■, A-9) on the baby unit or the OK button (B-7) on the parent unit again to restart playback of the lullaby.
> If the lullaby is not restarted within 60 seconds, the lullaby function will switch off automatically.



- Briefly press the play/stop button (▶■, A-9) on the baby unit again to stop playback of the lullaby

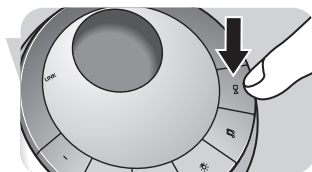

Note: If you press the lullaby button (♪, A-8) too long, no lullaby will be selected.

Connecting / disconnecting belt clip and neck strap

If the parent unit is operating on batteries, you can carry it in and around your house, giving you freedom of movement while still monitoring your baby.

Connecting the belt clip

- Insert the little spindle on the rear of the belt clip into the recess (B-11) on the rear of the parent unit.
Turn the belt clip to the left until it clicks in position.

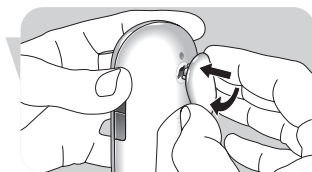

Disconnecting the belt clip

- Turn the belt clip to the right (TURN ▶) and take it off.

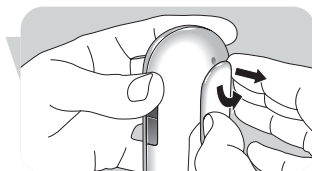

Other features

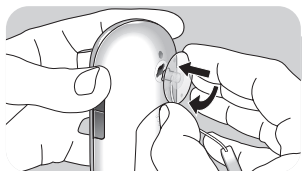

Connecting the neck strap

- Insert the little spindle at the end of the neck strap into the recess (B-11) on the rear of the parent unit.
Turn the spindle to the left until it clicks in position.

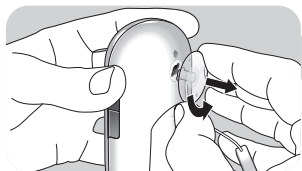

Disconnecting the neck strap

- Turn the spindle to the right (TURN ►) and take it off.

Menu options

Most functions of your baby monitor can be operated via the local buttons on the units. The functions described hereafter can only be operated remotely via the parent unit menu. The nightlight and lullaby functions can be operated via both menu and local keys.

Note: All buttons mentioned are located on the parent unit.

Menu operation - General explanation

- 1 Press the MENU button (B-2) to open the menu.
> The first menu option appears on the display.



- 2 Use the – and + buttons (B-10) to select the desired menu option.

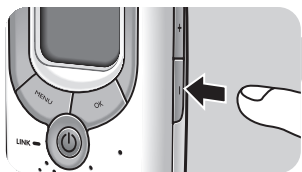

- 3 Press the OK button (B-7) to confirm your selection.
> *Saved* appears on the display.



4 Press the MENU button (B-2) again to exit the menu.

Note: Always press the buttons MENU (B-2), – and + (B-10) and OK (B-7) shortly.

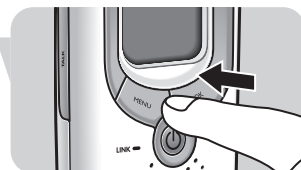

Switching night light on/off

- Select **LIGHT ON?** or **LIGHT OFF?**, using – and + (B-10). Confirm with OK (B-7).

Playing lullabies

To play or stop a lullaby:

- Select **Lullaby** 🎵, using – and + (B-10). Confirm with OK (B-7).
- Select **PLAY?** to replay the last played lullaby or **STOP Lullaby?** to stop playback. Confirm with OK (B-7).

To select a different lullaby:

- Select **Lullaby** 🎵, using – and + (B-10). Confirm with OK (B-7).
- Select **SELECT NEW**, using – and + (B-10). Confirm with OK (B-7).
- Select the desired lullaby, using – and + (B-10). Confirm with OK (B-7).

Adjusting microphone sensitivity

You can set the sound sensitivity of the baby unit to the desired level. When set to the maximum sensitivity level all sounds (including your baby's breathing, when loud enough) can be heard on the parent unit. You can only change the microphone sensitivity if the connection between the baby unit and the parent unit is established (when LINK lights (A-3, B-3) light continuously green).

- Select **SENSITIVITY** 🎵, using – and + (B-10). Confirm with OK (B-7).
- Select the desired sensitivity level for the baby unit microphone, using – and + (B-10). Confirm with OK (B-7).
 > Sensitivity ■ = minimum level / lowest sensitivity;
 Sensitivity ■ ■ ■ ■ ■ =
 maximum level / highest sensitivity

Note: When the sensitivity level of the baby unit is set to a high level, the unit will consume power because it is in continuous transmission mode.

Switching sound alert on and off

If sound alert is switched on, the parent unit beeps as soon as the second sound level light (B-9) lights orange while the volume is switched off.

- Select *Sound Al Ert*, using – and + (B-10).
Confirm with OK (B-7).
- Select *Al Ert on? or Al Ert off?*.
Confirm with OK (B-7).

Setting room temperature range

You can set the temperature range (minimum and maximum temperature) for your baby's room.

- Select *TEMPERATURE -- °*, using – and + (B-10).
Confirm with OK (B-7).
> *RANGE* appears on the display. Confirm with OK (B-7).
- Set the desired minimum temperature, using – and + (B-10).
Confirm with OK (B-7).
- Set the desired maximum temperature, using – and + (B-10).
Confirm with OK (B-7).

Note: When the set maximum temperature is lower than the room temperature, the unit consumes more power because the display is continuously lit. This is also the case when the set minimum temperature is higher than the room temperature.

Setting temperature alert

Temperature alert will sound from the parent unit if the actual room temperature exceeds the set minimum or maximum temperature or if the room temperature drops below 7°C or rises above 33°C.

- Select *TEMPERATURE -- °*, using – and + (B-10).
Confirm with OK (B-7).
- Select *Al Ert On/OFF*, using – and + (B-10).
Confirm with OK (B-7).
- Select *Al Ert On? or Al Ert Off?*.
Confirm with OK (B-7).

Problem	Possible cause	Solution
LINK light (A-3, B-3) does not light at all.	Parent unit: Power adapter (B-14) not plugged in.	Connect power adapter (B-14) to wall outlet.
	Unit not turned on.	Press and hold On/Off button (⏻) (B-6) for two seconds.
	Batteries are low.	Recharge batteries (B-12).
	Batteries are empty.	Replace batteries (B-12).
	Baby unit: Power adapter (A-14) not plugged in.	Connect power adapter (A-14) to baby unit. Connect power adapter (A-14) to wall outlet.
	Unit not turned on.	Press and hold On/Off button (⏻) (A-1) for two seconds.
LINK light (A3, B-3) flashing red/alarm beeping on parent unit.	Batteries are low.	Replace batteries (A-12).
	Units out of range.	Decrease distance between units (see 'Technical specifications').
	Baby unit batteries are low.	Replace batteries (A-12).
	Parent unit batteries are low.	Recharge batteries (B-12).
	Parent unit batteries are empty.	Replace batteries (B-12).
	Units cannot establish connection, even when close to each other.	Try solving the problem by using the factory initialization mode. See chapter 'Factory initialization mode'
Charging time of parent unit batteries exceeds 16 hours.	No power on one of the units.	Press On/Off button (A-1, B-6) for two seconds.
	Parent unit switched on during charging.	Switched off parent unit (B-6).

Troubleshooting

Problem	Possible cause	Solution
High pitched noise.	Units are too close to each other.	Move parent unit away from baby unit (at least 1 meter / 3 feet).
	Volume on parent unit set too high.	Decrease volume (B-10) on parent unit.
No sound/ baby's crying cannot be heard.	Volume on parent unit is set too low or switched off.	Increase volume on parent unit (B-10).
	Microphone sensitivity level set too low on parent unit.	Increase microphone sensitivity level in parent unit menu.
	Units are out of range	Move parent unit closer to baby unit.
Parent unit reacts too fast to other ambient sounds.	Ambient sounds trigger transmission.	Move baby unit closer to baby (keep minimal distance of 1 meter / 3 feet).
	Microphone sensitivity level set too high.	Decrease microphone sensitivity level in parent unit menu.
Battery check light () lights up on the display (A-11, B8).	Batteries are low or empty.	Replace / recharge batteries (A-12, B-12).
Parent unit reacts slow/late to baby's crying.	Microphone sensitivity is set too low.	Increase microphone sensitivity level in parent unit menu and/or move baby unit closer to baby (keep minimal distance of 1 meter/ 3 feet).
Baby unit battery power diminishes rapidly.	Microphone sensitivity setting too high.	Set microphone sensitivity to a lower level.
	Set minimum/maximum temperature higher/lower than room temperature.	Select lower/higher minimum/maximum temperature.
	Volume setting too high.	Set volume to a lower level (A-4).

Question

Answer

The technical specifications show an operating range of 300 meters / 900 feet outdoors. How come my baby monitor manages much less than that?

The specified range is only valid outdoors in open air. Inside your house the workable range is limited by the amount and type of walls and/or ceilings in between. Inside the house the operating range will be up to 50 meters / 150 feet.

The link is lost every now and then, sound interruptions etc.

You are probably approaching the outer limits of the practical range. Try a different location or decrease the distance between the units slightly. Please note that it takes about 30 seconds each time before a new link between the units is established.

What happens during a mains failure?

When batteries are installed in the both units, the units will automatically switch over to battery use in case of mains failure.

Is my DECT baby monitor secure from eavesdropping and interference?

The 60 channels guarantee no interference from other equipment.

Some buttons do not seem to work when I press them. What do I do wrong?

Except for the On/Off buttons (A-1, B-6), only press the buttons shortly.

I place the parent unit in the charging base (B-15) but the unit doesn't function.

When the batteries of the parent unit are low, you have to wait for up to 20 minutes after placing the unit in the charger before the unit starts functioning.

Operating time of the parent unit batteries is supposed to be at least 8 hours. How come the battery operating time of my parent unit is less?

Maybe the baby unit is transmitting too much. Operation time will be 8 hours only when the baby unit is transmitting 25% of the time and is in standby mode for the rest of the time (baby does not make sound).

When the parent unit batteries are charged for the first time, operating time will be less than 8 hours. The batteries will use their maximum capacity after at least four times charging and discharging.

Maybe the volume setting too high. When the volume is set to a high level, the units consumes more power. Set the volume to a lower level (B-10).

Important information

Power supply

Technical specifications

- 1 x AC power adapter DC 9V / 300mA for baby unit (supplied).
- 1 x charging base DC 9V / 300mA for parent unit (supplied).
- 4 x AA 1.5V Alkaline batteries for baby unit. (not supplied).
- 2 x AAA **NiMH** 1.2V rechargeable batteries for parent unit (supplied).

Operating range

Up to 300 meters / 900 feet in ideal condition. Walls, doors, etc will affect range. Indoors the range is up to 50 meters (150 feet).

Dry materials	Material thickness	Loss of range
Wood, plaster, plaster cardboard, glass (without metal or wires, no lead)	< 30cm / 12"	0 - 10%
Brick, plywood	< 30cm / 12"	5 - 35%
Reinforced concrete	< 30cm / 12"	30 - 100%
Metal grids, bars	< 1cm / 0.4"	90 - 100%
Metal, aluminium sheets	< 1cm / 0.4"	100%

Operating temperature

+ 0°C – + 40°C

Standard

Digital Enhanced Cordless Telecommunication (DECT)

The DECT standard makes use of advanced digital radio techniques to achieve efficient use of the radio spectrum. It delivers high speech quality and security and low power technology. It makes it possible to hear your baby at a range of up to 300 meters / 900 feet in open air.

Maintenance

- Clean the baby monitor with a damp cloth
- Dispose of used batteries in an environmentally friendly manner.
- If the batteries are left in the unit when it is powered from the mains, check them for leakage every six months.

Environmental information

Disposal of your old product

Your product is designed and manufactured with high quality materials and components, which can be recycled and reused.

When this crossed-out wheeled bin symbol is attached to a product it means the product is covered by the European Directive 2002/96/EC.

Please inform yourself about the local separate collection system for electrical and electronic products.

Please act according to your local rules and do not dispose of your old products with your normal household waste. The correct disposal of your old product will help prevent potential negative consequences for the environment and human health.



Factory initialization mode

In this mode both units can be reset to the default factory settings. Factory initialization can be used if problems occur which can not be solved by following the suggestions in chapter 'Troubleshooting'. Resetting must be done separately for each unit.

- 1 Press and hold the On/Off (⏻) button (A-1, B-6) for 2 seconds to switch on the unit.

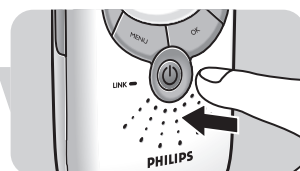
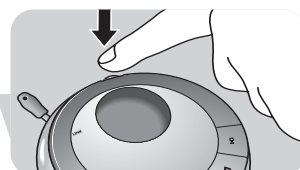

- 2 When the LINK light (A-3, B-3) on the unit lights up, immediately press and hold the volume – button (A-4, B-10).
> The unit has now been reset to the default factory settings.

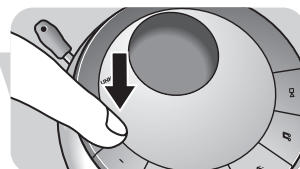

Important information

Default factory settings

Parent unit

- Loudspeaker volume: 1
- Microphone sensitivity: 5 (maximum)
- Sound alert: on
- Temperature alert: off

Baby unit

- Loudspeaker volume: 3
- Nightlight: off
- Lullaby: 1
- Temperature alert low: 14°C
- Temperature alert high: 23°C

The FCC ID number is located on the cabinet bottom of Parent Unit and in battery compartment of Baby Unit.

The term 'IC:' before the certification number signifies that Industry Canada technical specifications were met. This certification means that the equipment meets certain radio communications and operational requirements.

Compliance information

This device complies with Part 15 of the FCC Rules and ICES-003 of Industry Canada. Operation is subject to the following two conditions: (1) this device may not cause harmful interference, and (2) this device must accept any interference received, including interference that may cause undesired operation. This device complies also with RSS-213 of Industry Canada.

Radio Interference

This equipment has been tested and found to comply with the limits for a Class B digital device, pursuant to Part 15 of the FCC Rules and applicable Industry Canada specifications. These limits are designed to provide reasonable protection against harmful interference in a residential installation. This equipment generates, uses and can radiate radio frequency energy and, if not installed and used in accordance with the instructions, may cause harmful interference to radio communications. However, there is no guarantee that interference will not occur in a particular installation. If this equipment does cause harmful interference to radio or television reception, which can be determined by turning the equipment off and on, the user is encouraged to try to correct the interference by one or more of the following measures:

- Reorient or relocate the receiving antenna.
- Increase the separation between the equipment and receiver.
- Connect the equipment into an outlet on a circuit different from that to which the receiver is connected.

RF Radiation Exposure Statement

This equipment complies with FCC RF radiation exposure limits set forth for an uncontrolled environment. This equipment should be installed and operated with a minimum distance of 20 centimeters between the radiator and your body. For hand held operation, this equipment has been tested and meets the FCC RF exposure guidelines. Use of other accessories may not ensure compliance with FCC RF exposure guidelines. For body worn operation, this product has been tested and meets the FCC RF exposure guideline when used with the belt clip or neck strap supplied with this product. User must maintain a separation distance of 3mm between the back of the unit and the body to ensure compliance. Use of other accessories may not ensure compliance with the FCC RF exposure guidelines. This transmitter must not be co-located or operating in conjunction with any other antenna or transmitter. This equipment complies also with Industry Canada RSS-102 with respect to Canada's Health Code 6 for Exposure of Humans to RF Fields.

Do not attempt to repair or modify this equipment

Any repairs or alterations made by the user to the equipment may cause the equipment void in product warranty and compliance. Refer servicing to authorized or designated service centers.

Guarantee & service

If you need information or if you have a problem, please visit the Philips website at www.philips.com or contact the Philips Customer Care Centre in your country (you will find its phone number in the worldwide guarantee leaflet). If there is no Customer Care Centre in your country, turn to your local Philips dealer or contact the Service Department of Philips Domestic Appliances and Personal Care BV.

Service Centers

Service Center in USA

1010 Washington Boulevard
Stamford, CT 06912-0015
Tel.: 1-800-243-7884

Service Center in Canada

Personal Edge, Exchange Tower
130 King Street West, #CU15
Toronto, ON M5X 1A9
Tel.: (416) 361-1335