

Manufacturing Notes

- 101 This is a Rose enclosure Rose p/n03081206
- 102 Tolerance on all dimensions is +/- 0.010"
- 103 Grommet for bottom is Mc Master P/N 9600k38
- 104 Drawing is NOT to scale
- 105 Ground plane should be cut as follows

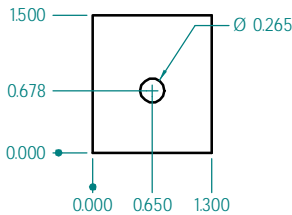

FCC ID: XXXXXXXXXXXX (To be assigned)
CANADA: YYYYYYYYYYYY (To be assigned)
This device complies with FCC Part 15 and
Canada Rules and regulations. Operation
is subject to the following two conditions:
(1) This device may not cause harmful
interference and (2) this device must
accept interference that may cause
undesired operation.
General Sensors, Inc.
Wireless Freezing Pipe Sensor (example)
Model WIAS3 (example)
Made in the USA

Antenna End

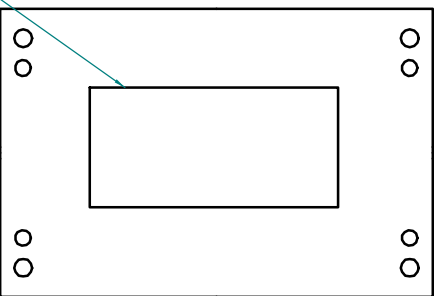
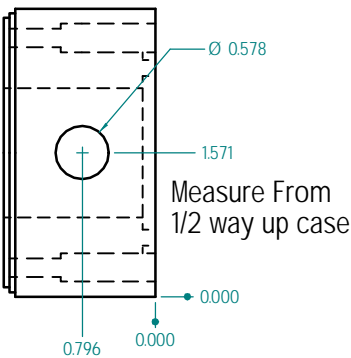

Grommet End

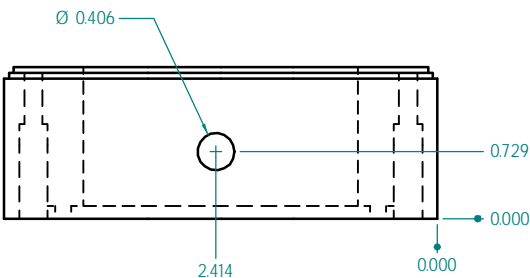
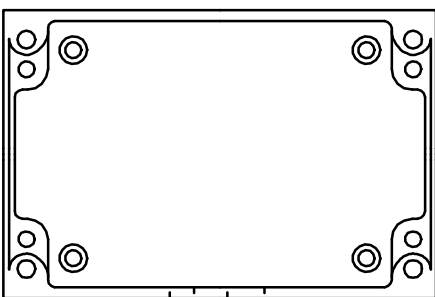
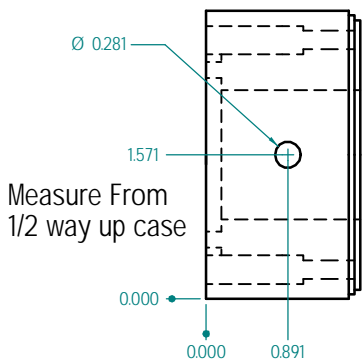

Iss.#3

2/11/02

Drilling Of Pipe Sensor Enclosure

Respond Systems, Inc. 20 Baldwin Dr. Branford, CT 06405

Senior Tech: David F. Britton

PipeSensorCase

File: c:\drawingfiles\singleeccase.dft

12/21/01

Page 1 Of 1