

DESK-FREE™
DSF-248I

 **Bluetooth®**
Headset for telephone
a new concept in making phone calls
At work or home

User's Guide



Audex® <http://www.audex.cn>

Made in China

Audex®
We Create New Lifestyles...

Welcome

1

Thank you for your purchase of our DSF-2481 Bluetooth® DESK-FREE™.

This User's Guide will help you to learn the basic features. Please read it carefully before using.



Introduction

2

The Audex Bluetooth® DESK-FREE™ (hereafter called the DSF-2481) is a new concept in wireless handsfree devices for your existing desk phone. It is designed and manufactured in accordance with the Bluetooth® Core Specification v1.2. It can also work as a wireless headset for your Bluetooth® mobile phone or other Bluetooth® devices.

You can connect the DSF-2481 to the handset so as to free your hands for other valuable tasks at work or home. It works in full-duplex mode digitally adopts advanced frequency hopping and spread spectrum technologies so the speech quality and security are ensured.

Introduction

3

What is Bluetooth®?

Bluetooth® wireless technology is a worldwide specification for a small-form factor, low-cost and short-range radio solution that provides links between mobile computers, mobile phones, other portable handheld devices, and connectivity to the Internet. The specification is developed, published and promoted by the Bluetooth® Special Interest Group (SIG).

Contents

4

This package contains the following:

- 1. Main unit
- 2. Headset
- 3. Ear Hook
- 4. AC power adapter
- 5. Connection cord
- 6. User's Guide
- 7. Quick Guide

The accessories may be subject to change for the sake of product improvement. Changes may be made without prior notice.

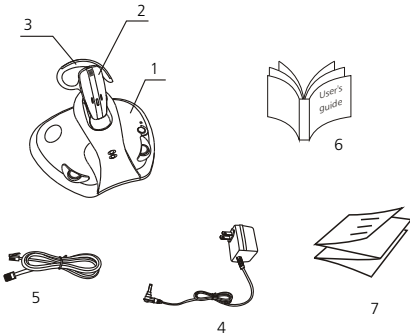

Functional Parts

5

- (1) Main Unit
- (2) Headset/Handset Switch
- (3) Headset Working Indicator
- (4) MIC Volume Control
- (5) Headset Master Volume Control
- (6) Power Indicator
- (7) Headset Charging Station
- (8) Headset
- (9) Ear Hook
- (10) Connection Indicator
- (11) Headset Charging Indicator
- (12) Microphone (MIC)
- (13) Speaker
- (14) Headset Secondary Volume Control (+)
- (15) Headset Secondary Volume Control (-)
- (16) ON/OFF
- (17) AC Adapter Jack
- (18) Telephone port
- (19) Headset port
- (20) Configuration Switch
- (21) Pairing Key
- (22) Connection Cord
(with big and small connectors)
- (23) AC Power Adapter

Functional Parts

6

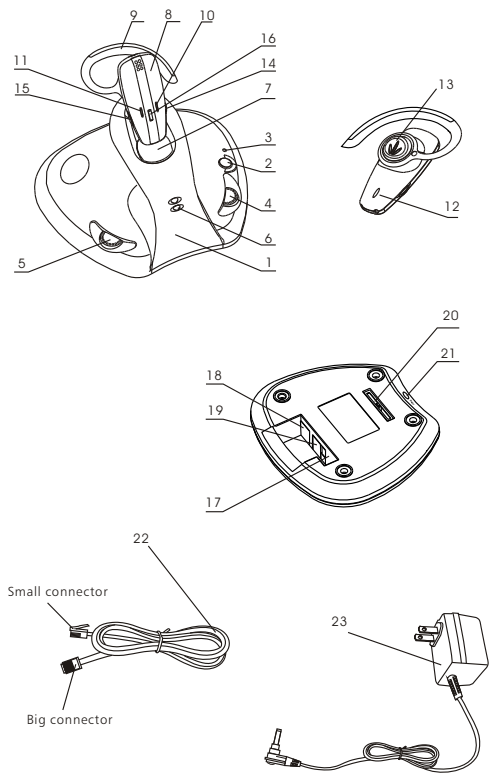

Operating Instructions

7

Installation & How to Use:

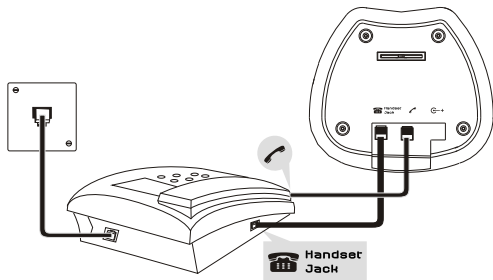

Operating Instructions

8

Connect the Main Unit (1) to the handset according to the figure attached.

1. Telephone port (18) Insert supplied connection cord to the telephone's handset port and to the bottom of base.
2. Headset port (19) Unplug coiled handset cord from the telephone's handset port and insert it to the bottom of the base.
3. Connect the AC Power Adaptor (23) to the AC Adaptor Jack (17) and a power outlet. The Power Indicator (6) will light up.
4. When the Headset (8) is seated in the Headset Charging Station (7), the Headset Charging Indicator (11) is on. When the Headset (8) is picked up, the light goes out.
5. Press the Headset/Handset Switch (2). Then the Headset Working Indicator (3) is lit.
6. Pick up the handset and put it aside. Slide the Configuration Switch (20) between the positions "1" and "6" until you hear a clear dial tone through the Headset (8). Then put back the handset.
7. Pair the Headset (8) with the Main Unit (1), then turn on the Headset (8) according to the instructions. The DSF-2481 is now ready to use.

Operating Instructions

9

How to use:

- 1. When you have an incoming call, pick up the handset and put it aside. Now you can pick up the Headset (8) to make a conversation.
- 2. The volume of the incoming call can be adjusted with the Headset Master Volume Control (5) on the Main Unit (1) or pressing the Headset Secondary Volume Control +/- (14, 15) on the Headset (8).
- 3. Adjust how loud you sound to the other party by tuning the MIC Volume Control (4).
- 4. When the conversation is over, put the handset on the hook and the Headset (8) on the Headset Charging Station (7). Now the call has been canceled.
- 5. If you want to make a conversation with the handset, press the Headset/Handset Switch (2). Then the Headset Working Indicator (3) is off. The call is now transferred to the handset.

Operating Instructions

10

Pairing:

Before the first use, you must pair the Headset (8) with the Main Unit (1). Pairing is the process of linking two Bluetooth® devices so that they can communicate. The pairing only needs to be done once. Afterwards, every time you switch on the Headset (8), it will automatically connect to the Main Unit (1). To initiate the pairing, put both the Headset (8) and the Main Unit (1) within 30 cm of each other. Make sure there is no Wi-Fi equipment in the vicinity.

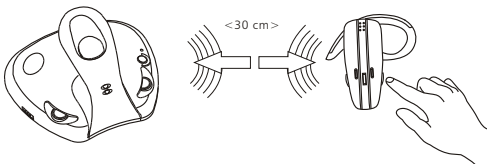

- 1. When the Headset (8) is OFF, press and hold (do not release) the Volume Control (+) button (14) for about 6 seconds until the Connection Indicator (10) and the Charging Indicator (11) flashes blue and red alternately. Then release the button. The Headset (8) will attempt to pair for 2 minutes. If it fails to pair during this period, it will be switched off automatically.

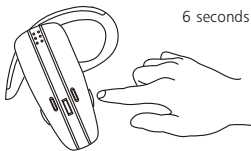

Operating Instructions

11

- 2. When the Headset (8) is attempting to pair, press and hold (do not release) the Pairing Key (21) for about 6 seconds until the Power Indicator (6) flashes. Release the button. If the Main Unit (1) fails to pair during this period, it will return to the standby mode automatically.
- 3. When the pairing is completed, the Connection Indicator (10) on the headset will flash blue slowly and the Charging Indicator (11) will be OFF; the Power Indicator (6) on the main unit will stay lit but stop flashing.

Switching On the Headset:

Press and hold the ON/OFF button (16) for about 3 seconds until the Connection Indicator (10) flashes blue. A beep (2 short tones) can be heard at the same time. Release the ON/OFF button (16). The Headset is now in standby mode.

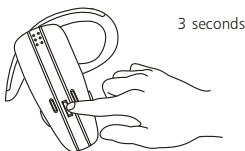

Note: If the battery is low, the Headset Charging Indicator (11) will flash red.

Operating Instructions

12

Switching Off the Headset:

Press and hold the ON/OFF button (16) for about 3 seconds until the Connection Indicator (10) goes off. A beep (2 short tones) can be heard at the same time. Release the ON/OFF button (16). The Headset is now switched off.

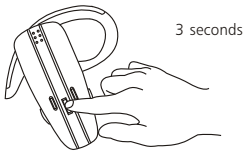

Resetting:

To reset the DSF-2481, press the ON/OFF button (16) and Headset Secondary Volume Control (-) (15) simultaneously. Then release.

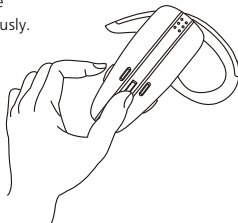

Operating Instructions

13

When the DSF-2481 is expected to work with your Bluetooth mobile phone or other Bluetooth devices:

Pairing

Before connecting to a Bluetooth® device successfully, the Headset must be paired with the device. There is a pairing mode for doing the pairing procedure.

To initiate the pairing, put the Headset (8) and your mobile phone within 30 cm of each other, but you must be at least 15 meters (50 feet) away from the Main Unit (1). Make sure there is no Wi-Fi equipment in the vicinity.

Remarks: If the Headset has been paired with the mobile phone but now you want to use the Main Unit again, please DISABLE the Bluetooth function of the mobile phone, and make sure the Headset is within 15 meters (50 feet) from the Main Unit now. The Headset can connect with the Main Unit automatically.

14

Operating Instructions

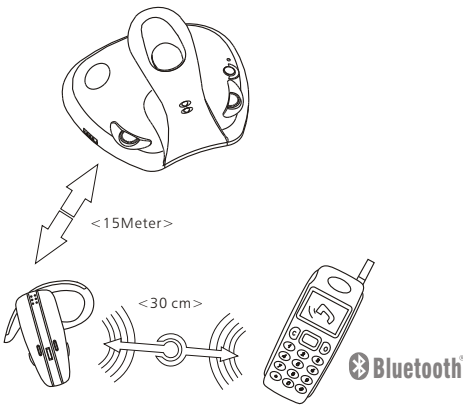

Operating Instructions

15

Enter pairing mode:

When the Headset is OFF, press and hold the Volume Control (+) button (14) for about 6 seconds until the Connection Indicator (10) and the Charging Indicator (11) flash blue and red alternately. Then release the button. The Headset (8) will now attempt to pair for 2 minutes. If it fails to pair during this period, it will be switched off automatically.

When the Headset is attempting to pair, you can then use a mobile phone to search for it. Select the name "Audex-2481" and enter the default password "0000" to complete a pairing procedure. When pairing succeeds, the Headset exits pairing mode and is ready to use. The Connection Indicator (10) on the headset will flash blue slowly and the Charging Indicator (11) will be OFF.

To cancel and exit pairing mode, press and hold Volume Control (+) (14) or Volume Control (-) (15) for 2 seconds until the indicator stops flashing. Then the Headset becomes non-discoverable.

Multiple pairing:

The Headset (8) supports multiple-pairing. It stores the pairing information for up to 4 devices. That means previously paired devices do not need to enter their password again when making connection with the Headset.

A list of information for the paired devices is stored in the Headset. When the list is full and a new device is being added onto the list due to successful pairing, the least recently used device will be removed from the list.

16

Operating Instructions

The paired devices list in the Headset can be reset. After resetting, all information for the paired devices will be erased. To reset the list, press the ON/OFF button (16) and Headset Secondary Volume Control (-) (15) simultaneously, then release.

Auto-connection:

When the Headset has just been switched on, or when the user presses the keys to make a connection to a paired device, it will try to connect to the last paired or last used device for about 3 seconds. Due to the multiple-pairing feature, if the connection fails, it will try to connect to the next frequently used device from the paired list and so on.

If connection succeeds, the indicators will light, and the Headset is ready for use with the device. If no device is available, it will wait for connection.

Profiles auto-select:

The Headset supports both Handsfree and Headset profiles. By default, the Headset will automatically select a profile to use when connecting to your paired device. It will first select Headset profile if it is peer supported.

On the other hand, a mobile phone will automatically select a profile to use when connecting to the Headset. Usually, both profiles supporting mobile phones will select Headset profile.

Operating Instructions

17

Battery Level Indication

When the battery is low, the Connection Indicator (10) will stop flashing and the Charging Indicator (11) will flash red to indicate low battery.

The user can explicitly check the battery level in standby or connection state, by pressing the Volume Control (+) (14) and Volume Control (-) (15) buttons simultaneously once. The Charging Indicator (11) will flash red as follows.

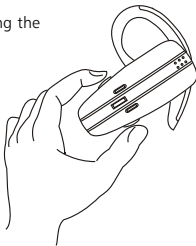

Battery level	Red Indicator Flashing times
High	3
Mid	2
Low	1

Operating Instructions

18

Keys Usage:

When the Headset is idle:
Voice dial: Press ON/OFF button (16) once (depending on the support of mobile phone)
Call transfer (from phone): Press ON/OFF button (16) once
Last number redial: Double-click ON/OFF button (16)
Volume up: Press Volume Control (+) (14)
Volume down: Press Volume Control (-) (15)

When the mobile phone is dialing
Cancel a call: Press ON/OFF button (16) once

When the Headset is ringing
Accept a call: Press ON/OFF button (16) once
Reject a call: Press and hold ON/OFF button (16)

When you are talking with the Headset
End a call: Press ON/OFF button (16) once
Call transfer (to phone): Press and hold ON/OFF button (16)
Call waiting: Double-click ON/OFF button (16)
Call hold: Double-click ON/OFF button (16)
Volume up: Press Volume Control (+) (14)
Volume down: Press Volume Control (-) (15)

Operating Instructions

19

How to use the headset

Adjusting the Ear Hook for Right-ear Use

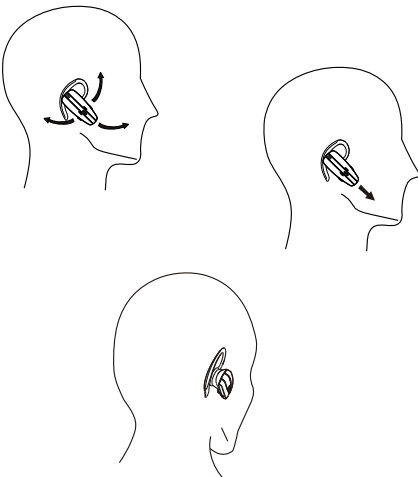

The headset is designed to fit both left and right ears.

- To put the headset on your right ear:
1. Put on the headset by placing the hook behind your ear.
 2. Rotate the headset so that the microphone is pointing towards your mouth for better reception.

Operating Instructions

20

Using the headset

Adjusting the Ear Hook for left-ear Use

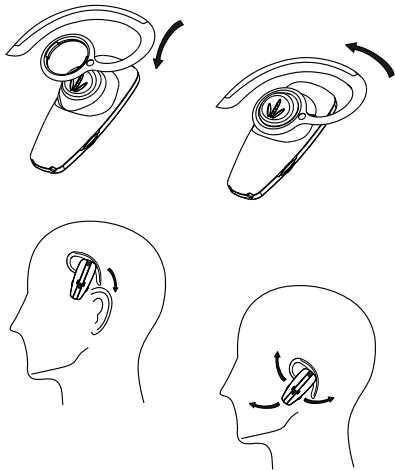

- To wear the headset on your left ear:
1. Rotate the hook until the curved section is on the top as shown above.
 2. Slide the headset behind the left ear and adjust until it is securely placed.
 3. Rotate the headset so that the microphone is pointing towards your mouth for better reception.

Operating Instructions

21

Charging the Headset

Charging the headset correctly:

1. This headset must be seated on the main unit and charged for at least 2.5 hours before the first use.
2. The charging indicator is on during charging. It goes off when the headset is fully charged.
3. Charging time: around 2.5 hours

CAUTIONS:

1. Always use the Audex-specified AC power adapter.
2. The voltage used should comply with the voltage range marked on the adapter. Using the incorrect adapter or incorrect current may cause damage to the device or injury to the user such as catching fire or getting an electric shock.
3. The adapter should be used in a well-ventilated place. Keep away from inflammable or explosive articles.
4. When using the adapter, please plug it into the socket safely.
5. During use, don't cover the adapter or the device with anything.
6. Don't pull the wire sharply when removing the adapter from the socket. Please hold the housing of the adapter instead and remove it carefully.
7. In case of a peculiar smell or smoke, please remove the adapter immediately and carefully.

Guide for Safe & Effective Use

22

Guide for Safe Use

Please read the following information before using the DSF-2481.

Safety instructions:

- *Make sure the volume is suitable before using the headset. If the volume is too high, it may damage your hearing.
- *Always put the device in a clean place. Don't store it in a dusty area.
- *Don't put the device into water when cleaning.
- *Don't expose it to chemicals such as benzene and thinners, or any other liquids.
- *Don't expose it to extreme temperatures (above 35°C or below 5°C). Don't expose it to moisture.
- *Don't apply excessive pressure to the device.
- *Don't let any foreign matter spill into the device.
- *Don't place any heavy objects on top of the device.
- *Don't expose it to direct sunlight or heat sources.
- *Don't throw, cast or try to flex this device.
- *Don't use the device near medical equipment without permission.
- *Don't use the device in places where radio equipment or wireless devices are prohibited, e.g. in an airplane.
- *Don't use the device in such a place where the danger of explosion exists.
- *Don't try to disassemble or repair this device by yourself. Only Audex-authorized personnel can disassemble it.

Guide for Safe & Effective Use

23

Children:

In order to avoid injury to themselves or others, and to avoid damaging the device, do not allow children to play with this equipment or its accessories. The device or its accessories may include detachable small parts which could cause suffocation.

Disposal:

Don't dispose of this device as municipal waste. Please consult the local regulations regarding worn-out electronic products.

Power source:

The AC power adapter can only be connected to the specified power source. Make sure the lead is fixed in the right place to avoid damage or pressure. Before cleaning, please remember to switch off the power of all parts to avoid electric shock. Don't use the AC power adapter outside or in a damp place. Never change the lead or plug. If the plug doesn't match the socket, please ask a qualified electrician to fix the suitable socket.

Limited Warranty

24

Audex provides a limited warranty for the DSF-2481 and its original accessories (hereafter called "the Product").

If the Product needs warranty service, please send this letter of warranty back to the distributor. You can consult your local distributor

Warranty Liability:

During the warranty period, if this Product doesn't work properly under normal use and maintenance conditions and if this is caused by a design, material or workmanship defect, an Audex-authorized distributor in the country or area where the Product was bought will decide to repair or replace the product, at their discretion, according to the clauses prescribed in this book.

According to the following Conditions, if the returned Product is found not within the range of warranty, Audex and its distributors retain the right to charge a handling fee.

Conditions:

1. The warranty is effective only when the original proof of purchase is provided to the Audex authorized distributor. This must show the purchase date and product serial number. If the above document has been smeared or modified after the Product is bought, Audex retains the right to refuse to provide the warranty service.

Limited Warranty

25

2. If Audex repairs or replaces the Product, the repaired or replaced Product continues to enjoy the warranty service for the balance of the original warranty period or within thirty (30) days after the service date (whichever is longer). Repair or replacement can include the use of the original parts for repairing the same function. The parts or components being replaced belong to Audex.

3. According to the Operating Instructions and Guide for Safe & Effective Use in this book, this warranty doesn't apply to product failure caused by normal wear or misuse (including but not limited to abnormal and irregular use). Also, function failure caused by accident, software or hardware modification or regulation, or immersion is not within the range of warranty.

4. The Bluetooth® system incorporated in this Product was provided by other companies. Audex will bear no responsibility for the operation, usability, coverage, service or range of this system.

5. The malfunction of the Product is not within the range of warranty if the Product has been altered, repaired or opened by non-Audex-authorized personnel.

Limited Warranty

26

6. A malfunction caused by the use of accessories of brands other than Audex or the use of other peripherals is not within the range of warranty.

7. The warranty will become invalid if the seal of the Product is damaged.

8. **No special warranty is available, written or oral, except the limited warranty printed here. All implicit warranties, including but not limited to the commercial or applicable implicit warranties for special purposes, should be subject to the period/duration stipulated by this warranty. In the greatest degree that the law permits, Audex or its distributor will bear no responsibility for occasional or consecutive losses of any nature, including but not limited to the profit loss or commercial loss.**

Some countries/regions/provinces don't permit the exclusion or limitation of occasional or consecutive damages, or the limitation of the implicit warranty period. Therefore, the above restrictive or exemptive clause may not apply to you.

The warranty provided doesn't affect the consumer's lawful rights according to the current applicable laws. Nor does it affect the rights prescribed in the purchase and sales contract signed between the consumer and the distributor.

* Extra information will be needed for some countries/regions. This will be clearly stated on the relevant purchase evidence when necessary.

Specifications

27

Main Unit & Headset

Working frequency	2.4 GHz~2.4835 GHz	
Working mode	full-duplex	
Effective distance	10 M (may vary in different environment)	
Battery	Li-Ion, 80 mAh	
Charging time	About 2.5 hours	
Continuous talking time	About 1.5 hours	
Standby time	3 days	
Dimensions (L×W×H)	123X113X109mm	
Weight of Main unit	197.1g	
Weight of Headset	14.1g	

AC power adapter

Input voltage	220VAC 50Hz	120VAC 60Hz
Output voltage	12VDC 200mA	12VDC 200mA

* Specifications and features are subject to change without prior notice

Warning

28

Changes or modifications to this unit not expressly approved by the party responsible for compliance will void the user's authority to operate the equipment. Any change to the equipment will void FCC grant.

This equipment has been tested and found to comply with the limits for a Class C digital device, pursuant to part 15 of the FCC Rules. These limits are designed to provide reasonable protection against harmful interference in a residential installation. This equipment generates, uses and can radiate radio frequency energy and, if not installed and used in accordance with the instructions, may cause harmful interference to radio communications. However, there is no guarantee that interference will not occur in a particular installation. If this equipment does cause harmful interference to radio or television reception, which can be determined by turning the equipment off and on, the user is encouraged to try to correct the interference by one or more of the following measures:
-- Reorient or relocate the receiving antenna.
-- Increase the separation between the equipment and receiver.
-- Connect the equipment into an outlet on a circuit different from that to which the receiver is connected.
-- Consult the dealer or an experienced radio/TV technician for help.

The user's manual or instruction manual for an intentional or unintentional radiator shall caution the user that changes or modifications not expressly approved by the party responsible for compliance could void the user's authority to operate the equipment. In cases where the manual is provided only in a form other than paper, such as on a computer disk or over the Internet, the information required by this section may be included in the manual in that alternative form, provided the user can reasonably be expected to have the capability to access information in that form.

This equipment complies with FCC radiation exposure limits set forth for an uncontrolled environment.

Warning

This equipment complies with FCC REGULATIONS 15 and 68 of the Federal Communications commission (FCC) rules for the United States. A label is located on the underside of the base unit containing the FCC registration number and Ringer Equivalence Number (REN). You must, upon request, provide this information to your local telephone company. This equipment is compatible with inductively coupled hearing aids.

FCC Part 15

Changes or modifications to this unit not expressly approved by the party responsible for compliance will void the user's authority to operate the equipment. Any change to the equipment will void FCC grant.

This equipment has been tested and found to comply with the limits for a Class C digital device, pursuant to part 15 of the FCC Rules. These limits are designed to provide reasonable protection against harmful interference in a residential installation. This equipment generates, uses and can radiate radio frequency energy and, if not installed and used in accordance with the instructions, may cause harmful interference to radio communications. However, there is no guarantee that interference will not occur in a particular installation. If this equipment does cause harmful interference to radio or television reception, which can be determined by turning the equipment off and on, the user is encouraged to try to correct the interference by one or more of the following measures:

- Reorient or relocate the receiving antenna.
- Increase the separation between the equipment and receiver.
- Connect the equipment into an outlet on a circuit different from that to which the receiver is connected.
- Consult the dealer or an experienced radio/TV technician for help.

Warning

The user's manual or instruction manual for an intentional or unintentional radiator shall caution the user that changes or modifications not expressly approved by the party responsible for compliance could void the user's authority to operate the equipment. In cases where the manual is provided only in a form other than paper, such as on a computer disk or over the Internet, the information required by this section may be included in the manual in that alternative form, provided the user can reasonably be expected to have the capability to access information in that form. This equipment complies with FCC radiation exposure limits set forth for an uncontrolled environment.

FCC Part 68

The FCC requires that you connect you cordless telephone to the nationwide telephone network through a modular telephone jack (USOCRJ11C or RJ11W).

You telephone company may discontinue you service if your equipment causes harm to the telephone network. They will notify you in advance of disconnection, if possible. During notification, you will be informed of your right to file a complaint with the FCC.

If it is determined that your telephone equipment is malfunctioning, the FCC requires that it not be used and that it be unplugged from the modular jack until the problem has been corrected. Repairs to this telephone equipment can only be made by the manufacturer or its authorized agents or by others who may be authorized by the FCC. For repair procedures, follow the instructions outlined under [\(Audex Telecom Industrial Co., Ltd.\)](#) Warranty.