



Bluetooth®  
**Headset**  
ADB-2383

## User's Guide



**Audex®** [Http://www.audextelecom.com](http://www.audextelecom.com)

Made in China.

**Audex®**  
*We Create New Lifestyles...*

## Introduction

1

Audex Bluetooth headset ADB-2383 portable hand-free device with advanced Bluetooth wireless communication technology. Bluetooth V1.2 compliant. Supply faster connection speed and much more better tone. ADB—2383 power supplied by a single high capability Li-ion battery, and can supply longer talking and standby time. Recharged via PC.

ADB—2383 can connect all Bluetooth headset profile or the hand-free profile device. For example: cell phone, PC etc. And your hands are free. You can receive and reject call, or adjust volume by the headset.

2

## Specifications:

### Specifications:

Compliance: Bluetooth v 1.2

Power class: class 2 (—2dB )

Frequency range: 2.4 — 2.48 GHz

Sensitivity of microphone: < 95dB

Talk time: max 6 hours

Standby time: 150 hours

Compatibility: Bluetooth headset and hands-free profiles.

\* Specifications and features are subject to change without prior notice.

## Features

3

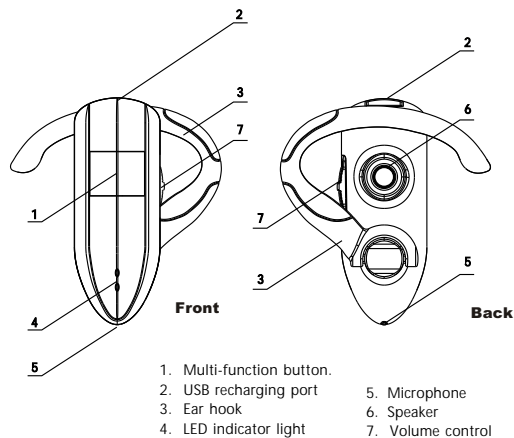

4

## Recharging

The headset will begin charging when connected to the USB port via the cable. The red LED will remain lit when charging; it will flash when fully recharged.

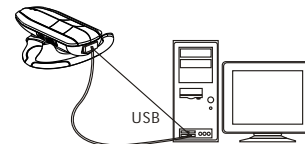

**Note:** The headset must be charged for about 2.5 hours before the first use.

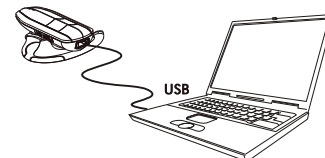

## Wearing the Headset

5

### To wear the headset on your right ear:

- 1) Open the ear hook 45° from the headset..
- 2) Place the hook over your ear.
- 3) Close the ear hook against the headset.
- 4) Point the microphone towards your mouth for best reception.

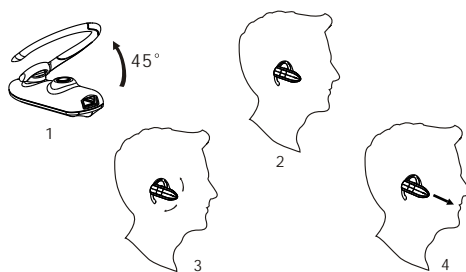

## Wearing the Headset

6

### To wear the headset on your left ear:

- 1) Open the hook 90° from the headset.
- 2) Rotate the hook 180°
- 3) Slide the hook towards the microphone
- 4) Place the hook over your left ear as with the right ear.

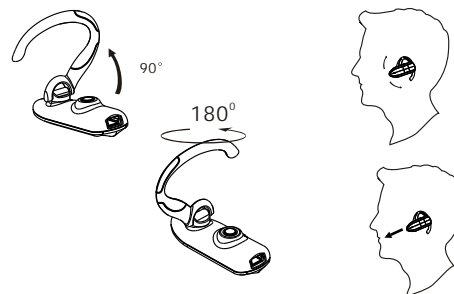

## Switching the Headset on/off

7

### 1. Switching on

Press and hold the multi-function button for about 6 seconds. The green LED will flash and there will be a short tone from the speaker. The headset is now in standby mode.

Note: The red LED will flash when the battery power is low

6 seconds



### 2. Switching off

Press and hold the multi-function button for about 2 seconds. The red LED will flash and there will be a short tone from the speaker. The headset is now off.

2 seconds



## Pairing

8

### Bluetooth® passkey

The Bluetooth® passkey (or PIN) is used to validate two Bluetooth® devices to each other and create a trusted relationship between them. It prevents the unauthorized use of a Bluetooth® device. The process of creating a trusted relationship between two Bluetooth® devices is called "pairing".

Each Audex Bluetooth® headset has a default passkey [1234], which is stored in its internal memory. Whether you need to input the passkey or not during pairing depends on the kind of Bluetooth® device that the headset will be connected to.

If you want to use the headset with a Bluetooth® mobile phone or other devices with built-in Bluetooth® capability, you are usually required to enter the passkey on that device during pairing.

**Pairing the headset**

To use the headset with a Bluetooth® enabled device for the first time, you must pair the headset with that device, for example , a mobile phone. Different devices may require different pairing procedures. The pairing procedure for the headset is described in this User's Guide. Please refer to the user's manual of the other device(s) for specific pairing method.

To complete pairing , you need to enter the correct passkey when required by the other device during pairing.

To pair the headset with the device:

1. Activate the Bluetooth® function in the other device if necessary. Please refer to the user's manual of the device.
2. Turn the headset off first. Press and hold the multi-function button of the headset for 8 seconds until the indicator lights on the headset alternately flash green and red. The headset is now ready for pairing. Make sure the headset and the other device are not too far apart (i.e. 30cm or less).

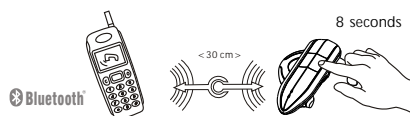
**Pairing the headset (cont.)**

3. Initiate Bluetooth® pairing in the other device to pair it with the headset . Please refer to the user's manual of the respective device for specific operation procedures. Once the headset is detected, a message will be displayed with the following information: "Audex-2383".
4. When asked by the device, enter the headset passkey and then confirm if necessary. If pairing is successful , the headset indicator light flashes green and the headset is now ready to use.
5. If no pairing is possible for a period of time (approx. two minutes), the headset will automatically turn off. Previous pairing (if any) remains. You may need to repeat steps 2 thru 4 until pairing is successful (Note: for Bluetooth® enabled mobile phones, it is recommended to reset the phone by turning it off first).
6. You can abort pairing any time by pressing and holding the multi-function button for about 2 seconds until the red and green lights go off and the headset is now turned off. Previous pairing (if any) remains.

**Adjusting the volume**

During a call, the volume can be increased with the volume button, which will be accompanied by a short tone. When the volume is at maximum, you will be alerted with two short tones.



When reducing the volume with the volume button, there will be a short accompanying tone. There will be two brief tones when the volume is at its lowest level.

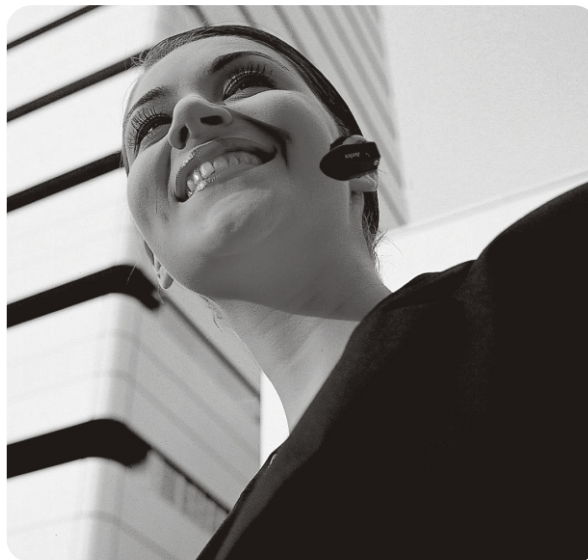

Button function list when using with cell phones

Status	Multi-function button		Volume+		Volume—	
	Press briefly	Press and hold	Press briefly	Press and hold	Press briefly	Press and hold
Switch on/off	N/A	Switch on (about 6 second)	N/A	N/A	N/A	N/A
		Enter pairing statuses (about 8 seconds)				
Standby	Enter voice dial	Switch off (about 2 seconds)	Volume increase	N/A	Volume decrease	N/A
Pairing status	Cancel pairing	Switch off	N/A	N/A	N/A	N/A
Voice dial	Cancel voice dial	Switch off	N/A	N/A	N/A	N/A
Incoming call	Accept	Reject	N/A	N/A	N/A	N/A
		Switch off (for Sony Ericsson)		Accept (for Sony Ericsson)		Accept (for Sony Ericsson)
While talking	Hang up	Switch off	Volume increase	N/A	Volume decrease	N/A

\* Voice dial function must be supported by enable cell phone. Please reference cell phone user guide. One or two function may little different according to different cell phone.

Low battery prompt

When the battery power gets low, the red LED will flash and there will be a short tone from the speaker. If the battery power continues to decrease, the headset will switch off automatically.

Safety & Precautions

Battery Safety:

Used batteries must be disposed of properly and may need to be recycled. Contact your local recycling center or the manufacturer of the battery for proper disposal methods.



**Warning:** Never dispose of batteries in a fire because they may explode.

**Note:** Please review the warnings and instructions provided by the manufacturer of your battery. Instructions may include: (1) Keep batteries from children and seek immediate medical assistance if a battery is swallowed. (2) Do not open batteries, install them backwards, charge them, or expose batteries to water, fire or high temperatures. These activities may cause a battery to explode or leak, resulting in personal injury or property damage.

Electromagnetic Interference/Compatibility:

**Note:** Nearly every electronic device is susceptible to electromagnetic interference (EMI) if inadequately shielded, designed, or otherwise configured for electromagnetic compatibility.

To avoid electromagnetic interference and/or compatibility conflicts, turn off your device in any facility where posted notices instruct you to do so. Hospitals or health care facilities may be using equipment that is sensitive to external RF energy.

This section lists some problems that you might encounter while using the headset.

**1. No sound contact between the headset and another device:**  
The headset and the receiving device have to be paired to recognize each other.  
They also have to be within range of each other. Make sure the headset and the receiving device are no more than 10m./30ft. apart with no solid objects in between.

**2. The headset indicator light flashes red.**  
This indicates that the headset has only limited speech and standby time left. Plug the headset to a USB port and charge it for approximately 1.5 to 2 hours.

**3. No indication of charge is shown.**  
If your headset battery is empty, or has not been used for a long time, it may take several minutes for the light to indicate charging (a steady red light appears).

**4. Pairing is unsuccessful**  
If pairing has not succeeded after a few tries, you may have to reset the headset first before pairing.  
To reset the headset:  
With the headset turned off, press and hold the multi-function button for about 8 seconds until the indicator light flashes red and green, and then press and hold the multi-function button until the indicator light goes off. The headset is now reset.

**5. Some headset functions do not work**  
If you notice that you cannot make use of all the features in the headset, please check if your mobile phone has the right software version.

**(Note:** Please read all this information before using the ADB-2383)

1. Check for any exceptions or rules, due to national/local requirements or limitations, in usage of this Bluetooth® headset or any other Bluetooth® devices.
2. Check also the laws and regulations on the use of mobile phones and hands free equipment in the areas where you drive.
3. Please note that only authorized Audex dealers or service partners should remove and/or replace any internal components of this device.
4. Please use Audex original accessories only. Use of non-Audex original accessories may result in damage, loss of performance to the headset, injury, electric shock or even fire.
5. Please do not expose the headset to extreme high or low temperatures, moisture or fluid.
6. Please do not drop, throw or bend the headset as rough treatment will damage it.
7. If the headset will not be used for a while, please store it in a place where it is dry, free from dust, and not prone to extreme temperature fluctuations.

## Important information

19

8. RF frequency and energy may affect some electronic systems in a motor vehicle. Please check with the manufacturer to ensure that the headset will not affect the electronic systems in the motor vehicle.
9. Some medical electronic equipment may not be shielded from RF energy. Therefore, please do not use the headset near medical equipment without permission.
10. Please turn off the headset before boarding any aircraft. To prevent any interference with communication systems, please do not use the headset while the plane is in the air.
11. Please turn off the headset in any area with a potentially explosive atmosphere.
12. Please do not allow children to play with the headset since it contains small parts.

**Note:** The headset is connected to a mobile phone or other electronic devices using radio frequency signals which cannot guarantee connection under all conditions or circumstances. Therefore, please never rely solely upon the headset for essential or emergency communications.

20

## Warning

Changes or modifications to this unit not expressly approved by the party responsible for compliance will void the user's authority to operate the equipment. Any change to the equipment will void FCC grant.

This equipment has been tested and found to comply with the limits for a Class C digital device, pursuant to part 15 of the FCC Rules. These limits are designed to provide reasonable protection against harmful interference in a residential installation. This equipment generates, uses and can radiate radio frequency energy and, if not installed and used in accordance with the instructions, may cause harmful interference to radio communications. However, there is no guarantee that interference will not occur in a particular installation. If this equipment does cause harmful interference to radio or television reception, which can be determined by turning the equipment off and on, the user is encouraged to try to correct the interference by one or more of the following measures:

21

## Warning

- Reorient or relocate the receiving antenna.
- Increase the separation between the equipment and receiver.
- Connect the equipment into an outlet on a circuit different from that to which the receiver is connected.
- Consult the dealer or an experienced radio/TV technician for help.

The user's manual or instruction manual for an intentional or unintentional radiator shall caution the user that changes or modifications not expressly approved by the party responsible for compliance could void the user's authority to operate the equipment. In cases where the manual is provided only in a form other than paper, such as on a computer disk or over the Internet, the information required by this section may be included in the manual in that alternative form, provided the user can reasonably be expected to have the capability to access information in that form.

This equipment complies with FCC radiation exposure limits set forth for an uncontrolled environment.