

# Guest Pager User manual

GP-100R  
GP-1000T

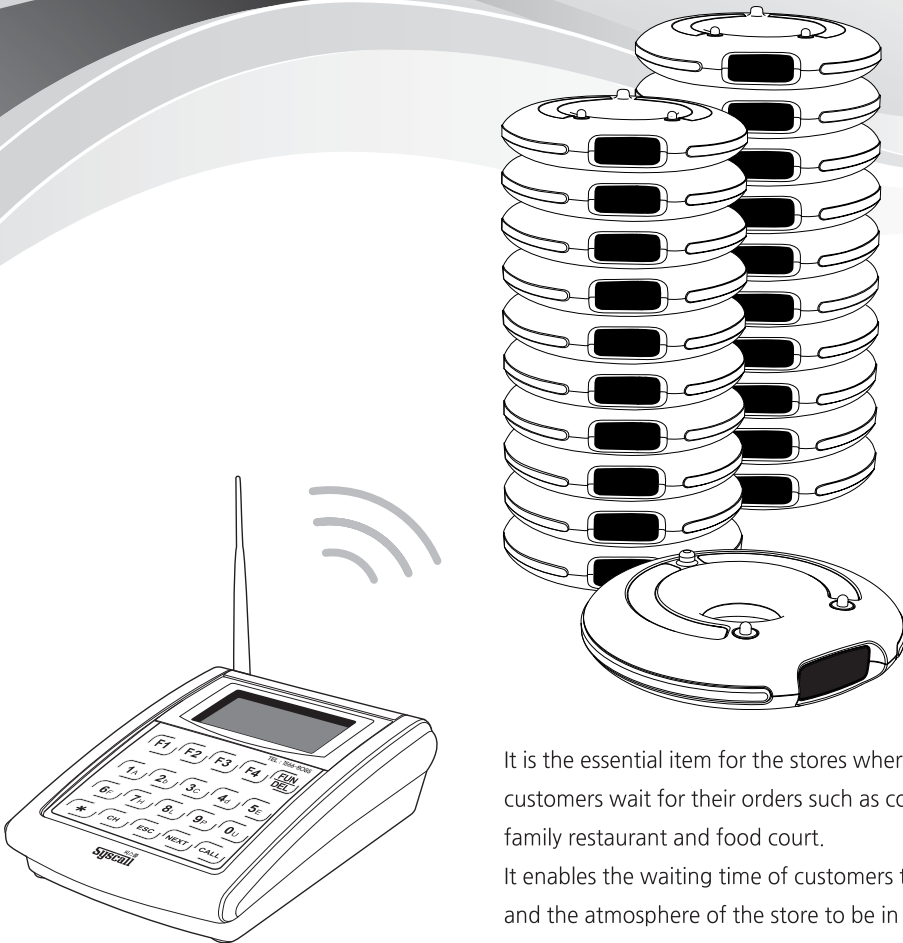

It is the essential item for the stores where the customers wait for their orders such as coffee shop, family restaurant and food court.

It enables the waiting time of customers to be freer and the atmosphere of the store to be in order.

To the user manual before using the product, please read it.

## Contents

1. Composition & specifications of product.....	2
2. Installation.....	2
3. Explanation of buttons of transmitter.....	3
4. Explanation of functions of transmitter & initial setting.....	3
4-1. Explanation of general functions.....	3
4-1-1. How to enter to general functions <b>Picture</b> .....	3
4-1-2. Setting vibrator <b>Picture</b> .....	3
4-1-3. Setting buzzer <b>Picture</b> .....	4
4-2. Explanation of extended functions.....	4
4-2-1. How to enter to extended functions <b>Picture</b> .....	4
4-2-2. Setting Group number & Channel number <b>Picture</b> .....	4
5. Explanation & setting of display of transmitter.....	5
5-1. Explanation of displays.....	5
5-2. Setting a random number.....	5
5-2-1. Enter to general functions <b>Picture</b> .....	5
5-2-2. Input a random number <b>Picture</b> .....	5
★ 5-3. Setting the fixed number.....	6
★ 5-3-1. Input the fixed number <b>Picture</b> .....	6
6. How to use guest pager.....	7
6-1. Make a call.....	7
6-1-1. How to call a random number <b>Picture</b> .....	7
★ 6-1-2. Hot to call the fixed number <b>Picture</b> .....	7
6-2. Cancel a call.....	8
7. Initialization.....	8

## 1. Composition & specifications of product

### < Transmitter GP-1000T SET >

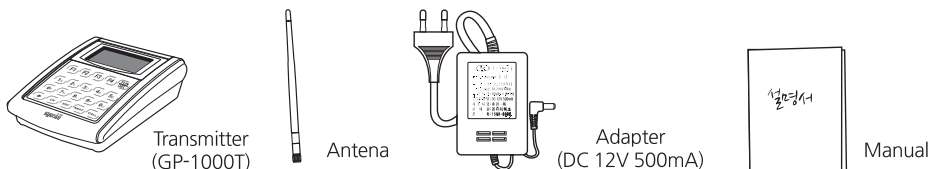

### < Receiver GP-100R SET >

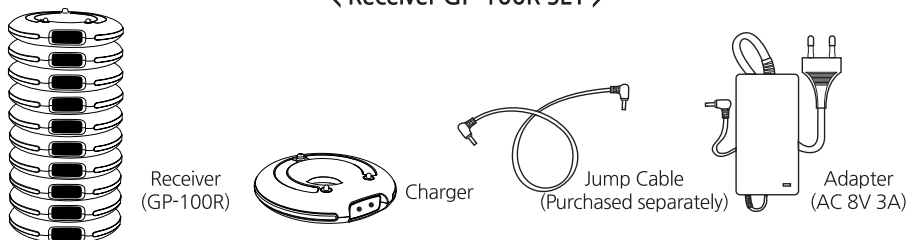

#### Receiver(GP-100R)

Frequency	FM / 447MHz
Power	AC 8V 3A
Charger	Lithium-polymer battery
Size	Ø 95 × H17mm
Weight	86g
Color	Red, Green

#### Transmitter(GP-1000T)

Frequency	FM / 447MHz
Antenna / distance	Whip / 300m
Power	DC 12V / 500mA
Size	W130 × L170 × H32mm
Weight	410g
Display	Graphic lcd

## 2. Installation

### GP-100R SET

- 1) Place the receiver on the convex part of the charger well.
- 2) Put the plug of adapter into the front socket. (Both can be used.)
- 3) Check if all receivers are powered on.

### GP-1000T SET

- 4) Connect the antenna to the transmitter.
- 5) Connect the transmitter with the adapter.
- 6) Check if it is powered on.
- 7) Use GP-100R if it is fully charged after setting group numbers & Channel numbers.

The charging starts if it is placed on the convex part of the charger and it is connected to power supply.

- \* Charging time : About 6 hours
- \* Standby time : About 20 hours
- \* Capacity of adapter : 8V 3A - Capable of charging max. 35 receivers simultaneously

### 3. Explanation of buttons of transmitter

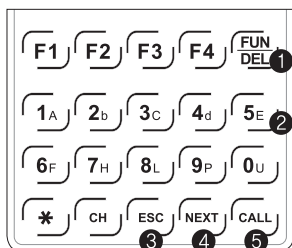

- ① Enter/cancel of functional mode
- ② Convert number to English and English to number if it is pressed long
- ③ Cancel/Exit
- ④ Next
- ⑤ Enter/Call

### 4. Explanation of functions of transmitter & initial setting

#### 4-1 Explanation of general functions

Menu	Initial	Range	Display	Explanation
RC (Range Check)	0 (off)	0-off, 1-on	rcon, rcof	Function that checks if the receiver is within the communication range of the transmitter
Bt (Back Light Time)	10s	0 ~ 99s (0:Duration)	-	Lighting time of backlight of the transmitter
Fn (Fix Number)	0	0 ~ 9999 (0:Use a random number)	0~9999	Setting the fixed number of the receiver
Ct (Call Time)	30s	0 ~ 99s (0:Duration)	ct00~ct99	Operating time of the receiver for calling
Mt (Motor On/Off)	1 (on)	0-off, 1-on	Hton, Htof	Motor on/off
Bu (Buzzer On/Off)	1 (on)	0-off, 1-on	buon, buof	Buzzer on/off
LE (LED On/Off)	1 (on)	0-off, 1-on	LEon, LEof	LED on/off

##### 4-1-1. How to enter to general functions



##### 4-1-2. Setting vibrator

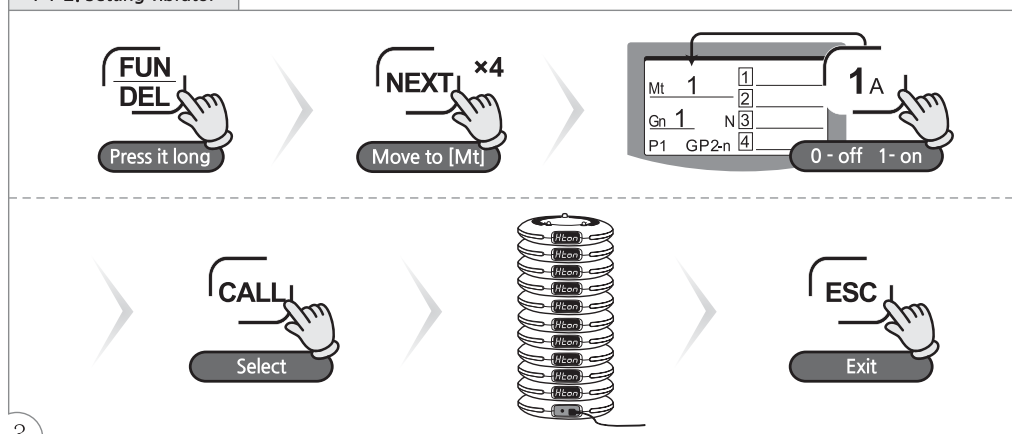

#### 4-1-3. Setting buzzer

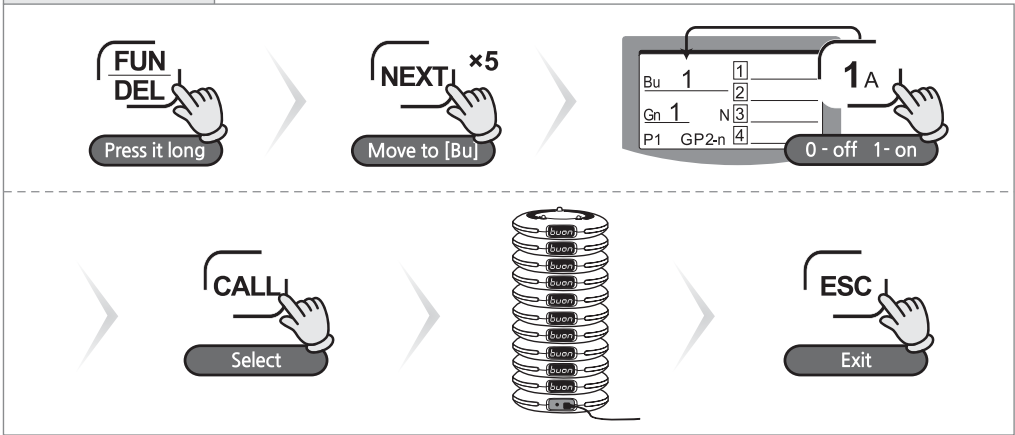

#### 4-2 Explanation of extended functions ( \* Menu that is activated when inputting password )

Menu	Initial	Range	Display	Explanation
Gn (Group number)	1	1 ~ 99	gn01 ~ gn99	Identification number to avoid the interference with the products of surrounding users
Pn (Channel number)	1	1 ~ 99	Pn01 ~ Pn99	

##### 4-2-1. How to enter to extended functions

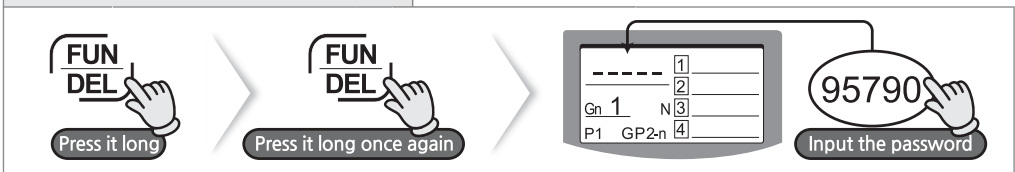

##### 4-2-2. Setting Group number & Channel number

※ Group & Channel numbers can be set first one time only at a time. Initialization is required when needs to change them.

ex) Gn : 44, Pn : 33

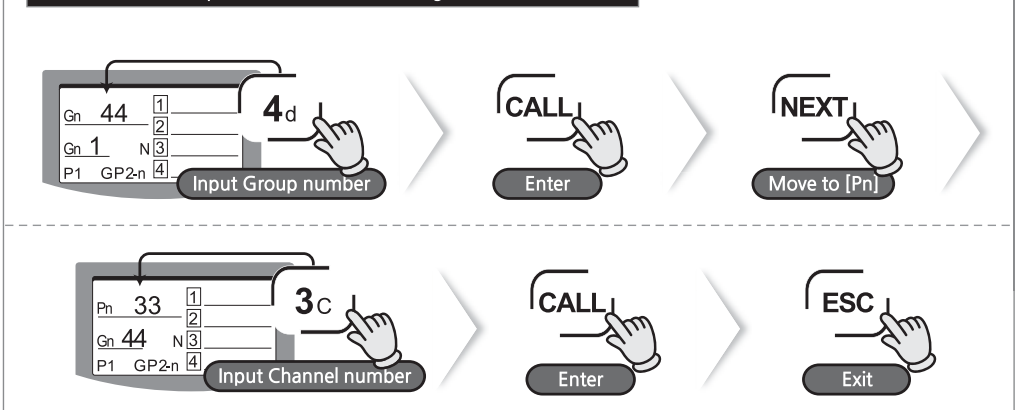

## 5. Explanation & setting of display of transmitter

### 5-1 Explanation of displays

Display	Explanation
CALL	Displayed in the called receiver, It rings together with the display 'CALL' when vibrator/buzzer are activated.
Lo (Low battery)	It displays the characters 'Lo' when it is low battery, and it disappears after charging.
rFEr	It displays the characters 'rFEr' when it is poor RF, and it does not receive the signal. After-sales service is required.
P	Display battery remainder (Unit : %)
U_	Display version of donut vibration bell (ex) U_20
r_+ 번호	It blinks "r_+ number" in turn when it is RF off. It disappears when it is amounted on the charger.
outr	It displays together with buzzer when it goes beyond the communication range. It disappears if it goes nearby the transmitter and works normally.

### 5-2 Setting a random number

**Calling a random number** is the method that uses it by inputting the number which the user wants to the receiver.

**Merit :** It can be used along the situation by input. (Max. 4 digits)

**Caution!** Please check the Group & Channel number are identical between the transmitter and receiver. Please set them after mounting all receivers on the charger.

#### 5-2-1. Enter to general functions



#### 5-2-2. Input a random number ▶ [7P] 6-1-1. How to call a random number

**Caution)** Though number '0' or different number is displayed in the initial display, proceed with the input of number first in sequential order.



# ★ 5-3 Setting the fixed number

**Call the fixed number** is the method that calls by transmitting the pre-fixed number of the receiver that the transmitter sets after setting the number into the receiver.

**Merit :** It can be used simply and conveniently because it is called with one press of CALL button after inputting the pre-fixed number to the receiver.

**Caution!** Please check the Group & Channel number are identical between the transmitter and receiver. Please set them after mounting all receivers on the charger.

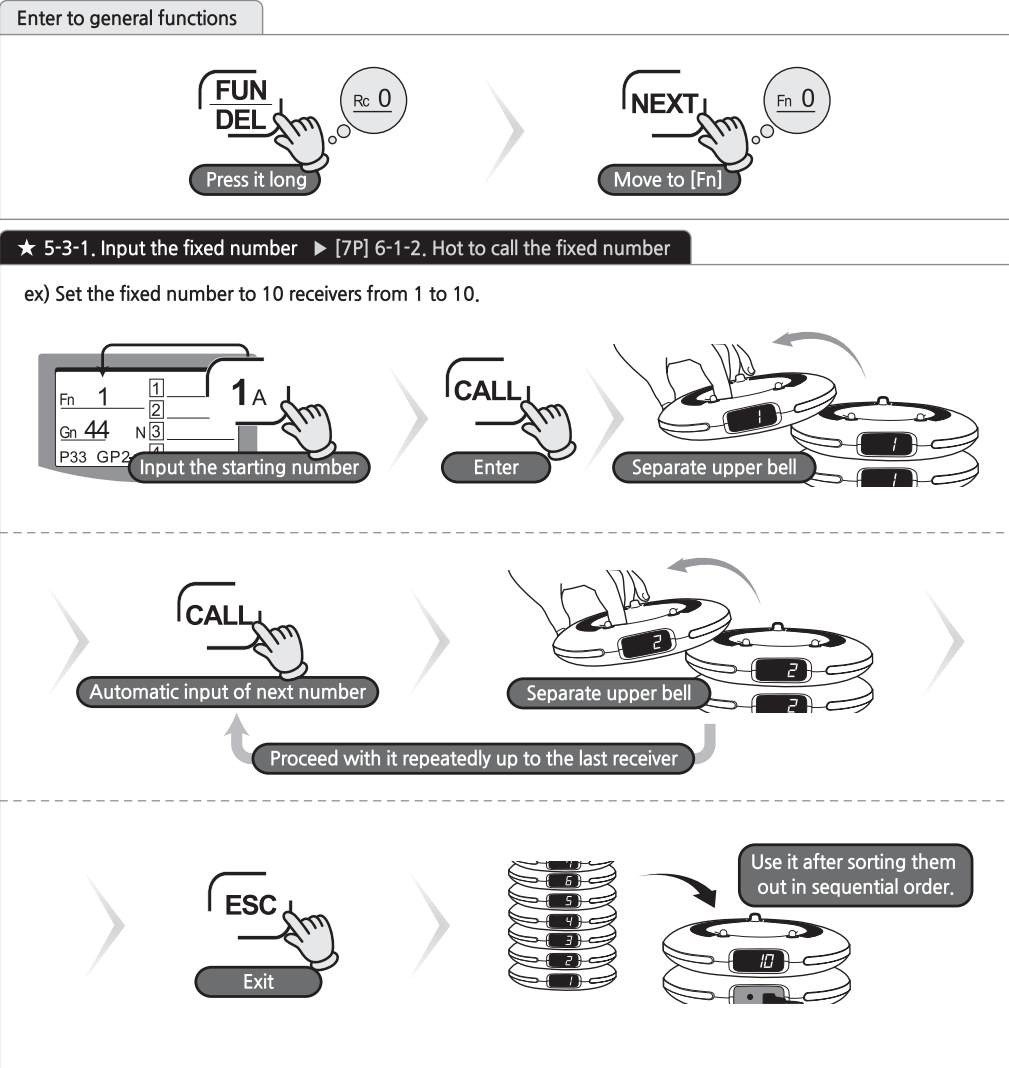

## 6. How to use guest pager

### 6-1 Make a call

**Caution !** Number can be input only on the charger.

Maximum 4 digits can be input.

#### 6-1-1. How to call a random number

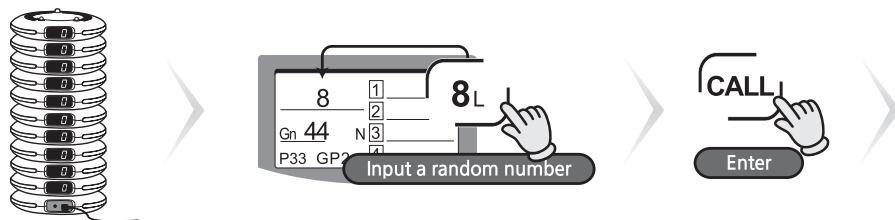

#### ★ 6-1-2. Hot to call the fixed number

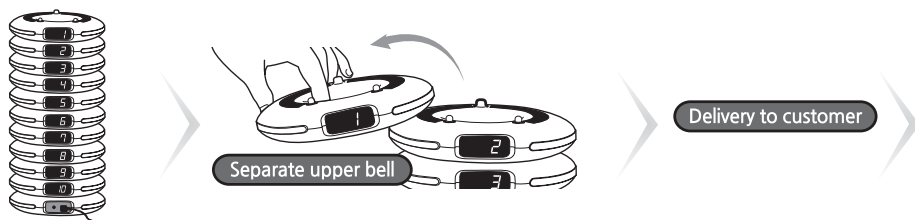



## 6-2 Cancel a call

How 1

Withdraw guest pager

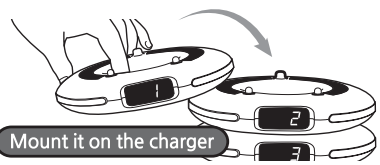

Mount it on the charger

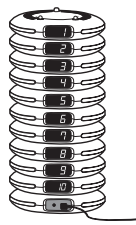

How 2

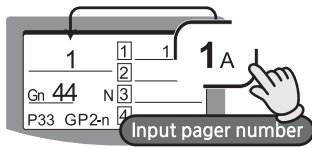

Input pager number



Del

## 7. Initialization

Group & Channel numbers can be set **first one time only** at a time.

Initialization is required when needs to set them again.

The initialization can be proceeded when **Group & Channel numbers are identical only**.



Convert number to English  
and English to number  
if it is pressed long

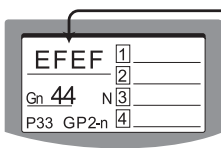

Input code



Proceed with  
the initialization



Display version & battery remainder

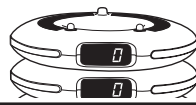

Completes the initialization



Exit

### **FCC Compliance Information**

This equipment has been tested and found to comply with the limits for a Class A digital device, pursuant to part 15 of the FCC Rules.

These limits are designed to provide reasonable protection against harmful interference when the equipment is operated in a commercial environment. This equipment generates, uses, and can radiate radio frequency energy and, if not installed and used in accordance with the instruction manual, may cause harmful interference to radio communications. Operation of this equipment in a residential area is likely to cause harmful interference in which case the user will be required to correct the interference at his own expense.

### **FCC Compliance Information :**

This device complies with Part 15 of FCC Rules. Operation is subject to the following two conditions:

- (1) the device may not cause interference, and
- (2) the device must accept any interference, including interference that may cause undesired operation of this device.

### **FCC Rule Part 15.21:**

The user manual for an intentional or unintentional radiator shall caution the user that changes or modifications not expressly approved by the party responsible for compliance could void the user's authority to operate the equipment.



- NTTWORKS CO., LTD
- 413-9 NTTWORKS Bldg, Galhyun-Dong, Eunpyong-Gu, Seoul, Korea
- Tel. 82-2-387-3190~5 Fax. 82-2-352-8672
- <http://www.nttworks.com>