

WPANT10155-S1C

915 MHz ISM antenna

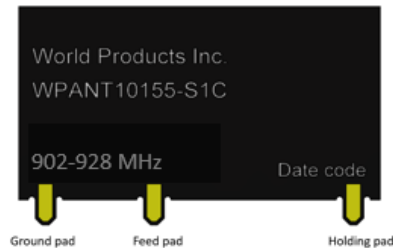

Note: Different cable and connector style requests can be accommodated.

Application

Custom designed PCB 915 MHz ISM antenna.

We can assist your engineers to optimize mounting positions for these antennas in your specific application and can further assist to troubleshoot system integration issues such as TRP/TIS and FCC requirements. We specialize in developing customized Antenna solutions. Please contact sales@worldproducts.com with your specific application requirements.

Electrical Properties

Operating Frequency	902 – 928 MHz
Approximate Antenna Impedance [Ω]	50 Ω
VSWR (Typical)	< 2.5 :1
Peak Gain [dBi] (Typical)	+1 dBi
Efficiency [%] (Typical)	70%
Polarization	Linear
Pattern	Omni-directional

Mechanical / Environmental Properties

Antenna Dimensions	1.38" x 0.736" x 0.062" (35 mm x 18.7 mm x 1.57 mm)
Material	62 mils FR406
Antenna Color	Black
Packaging	Tape and Reel (180 pcs/reel)
Operating / Storage Temperature	-40°C to +90°C
Environmental	Meets standards for UL 94V-0
Hazardous Materials	RoHS Compliant

Mounting footprint

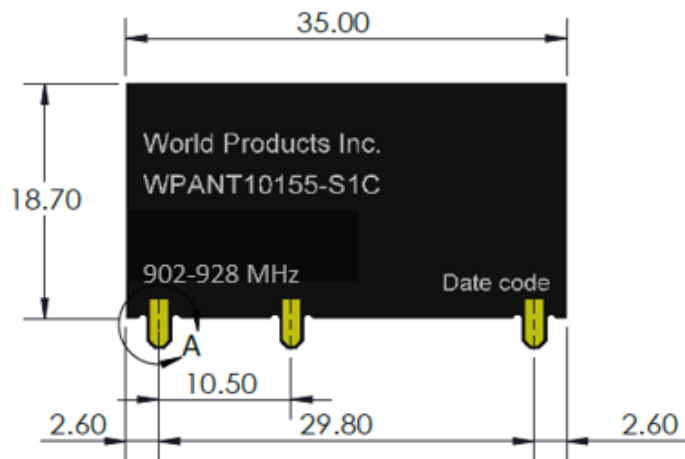

FRONT VIEW SCALE 2:1

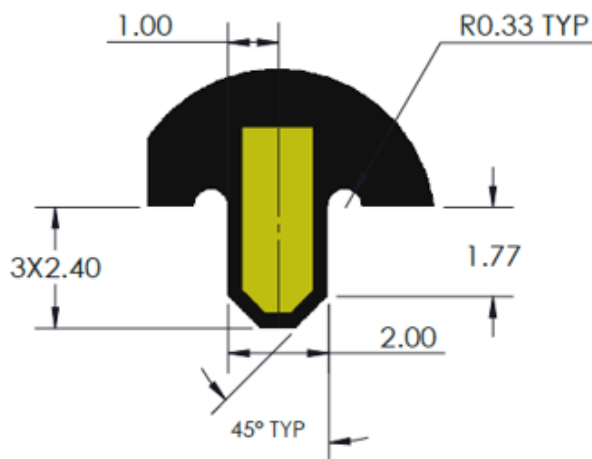

DETAIL A
SCALE 8:1

Note:

1. All dimensions are in mm.
2. All legs are identical
3. Do no scale drawings.
4. Linear tolerances: (.X +/- 0.10; .XX +/- 0.08), Angular tolerance: (+/- 1°)