

### Statement

Please read this guide carefully before using the device to ensure your safety and correct use of the device. For information about the device configuration, please refer to the contract or information related to the device and the seller of the device to you.

The pictures in this guide are for reference only. If some pictures do not match the actual products, please refer to the actual products. Many network functions described in this document are special services provided by network service providers (ISPs). The availability of these network functions depends on the ISPs that provide the services to you.

No part of this Manual shall be reproduced, excerpted, backed up, modified, transmitted, translated into other languages, or used in whole or in part for commercial purposes in any form or by any means without the permission of the Company.

### Package Content

Components Name	Quantity
V77 Countertop POS Terminal	1
Power adapter	1
Quick operation guide (Certificate of qualification and Warranty card)	1

-1-

### Product Description

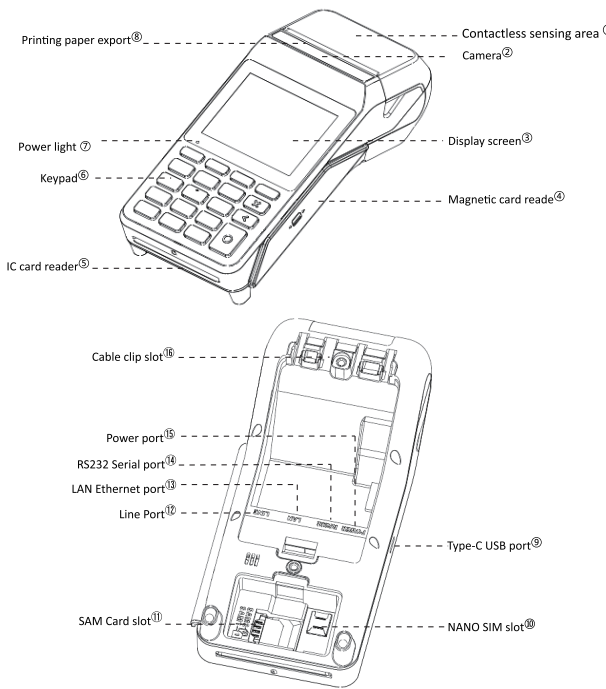

-2-

#### Name Function introduction

Contactless sensing area	Induction area for contactless IC card reading and writing
*Camera	Used for bar and QR code scanning etc.
Display screen	Optional Touch screen, display transaction and operation prompt information, etc.
Magnetic card reader	Magnetic stripe card reader, support bi-direction swiping.
IC card reader	Contact IC card inserting position.
Keypad	Power on and off, input amount and code, confirm and cancel transaction etc.
Power indicator light	Indicate whether the device is connected to power.
Printing paper export	Printed receipts and bills export.
Type-C USB port	Used for connecting external PC or other terminals, allows to do data transmission
*NANO SIM slots	NANO SIM card slot.
SAM card slot	SAM card slot.
*Line port	Provides data communication over telephone lines.
LAN Ethernet port	Provides data communication via Ethernet.
RS232 Serial port	Used to connect external devices such as PC, Scanner and other devices.
Power port	Provide port for adapter power plugging in.
Cable clip slot	Used to secure extended cables

Note: Those marked with "\*" in front of the module name in the above table are optional parts, which shall be subject to the specific order requirements.

-3-

### Quick installation

Take out the POS terminal, the power adapter, and other necessary parts from the packing box, then follow the steps below for a quick installation.

#### 1 Install the printing paper:

- Pull up the printing paper container cover to open the container.
- Strip off the printing paper. Hold one side of the paper and put it into the container. Leave a bit of the paper on the top of the scudding knife.
- Close the cover when hearing the "tick" sound.

#### 【Cautions】

Please be careful with the direction when installing the thermal printing paper, and please do so by following the figures below, otherwise it will cause a failure of printing.

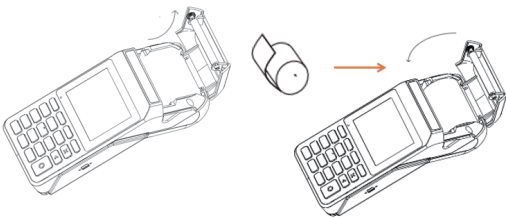

-4-

#### 2 Install the SIM/ SAM(PSAM) card:

- Open the battery cover.
- Follow the silkscreen indication and place each of the needed SIM/SAM card separately into the right slot following the direction as the picture showed.

#### 【Cautions】

- When installing or removing the SIM/ SAM card, please confirm that the device is power-offed, otherwise the cards may be damaged.
- When installing the SIM/ SAM card, the chip faces toward the internal side of the device.
- SIM/ SAM card cannot paste stickers, tags, or other materials that may change the thickness of the card in order to prevent non-smooth installation or disassembly.

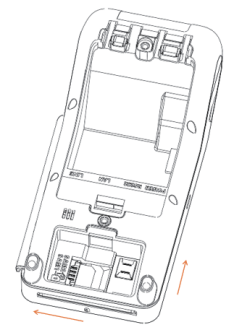

-5-

#### 3 Power connection:

- Insert one end of the power adapter into the power port on the back of the POS terminal.
- Plug the other end into a power outlet.
- Confirm that the power indicator light is on, indicating that the device is receiving power.

#### 【Cautions】

Ensure you use the specified power adapter to avoid damaging the device.

#### Usage and Operation

Power on / Power off / Restart:

• Power on: After connecting the power adapter, Short press the power key for 3 seconds under power off status, the screen lights up means power on.

• Power off / Restart: Press the power key for 3 seconds, then the screen displays "1- standby"; "2- power off"; "3- reset". At this moment, Press number "2" can shut down the machine; Press number "1" will quickly switch the machine to sleep state, which can be awakened by power key; Press number "3" can reset the machine.

#### 【Cautions】

When operating a transaction, the user interface is in the communication status, Please do not turn off your device.

-6-

### After-sale service

If you have any questions, please contact your local dealer.

#### Warranty card

Product Name: \_\_\_\_\_

Product Model: \_\_\_\_\_

#### Warranty terms:

- Our company will provide you with high quality after-sales service.
- If the user causes product damage due to human factors, the company will charge maintenance fee when repairing.
- Please take good care of this card, which will be the warranty basis of our company.

#### Certificate

This product has passed inspection and is authorized for factory release.

Please cut along this line

### Aisino Vanstone Electronic (Beijing) Co., Ltd.

Address: 3F, No.2 Building, Aisino Corporation Park 18A,

Xingshikou Road, Haidian District, Beijing, China 100195.

Email: info@vanstone.com.cn

Factory Name: Huizhou Vanstone Electronic Co., Ltd.

Factory Address: 4F, No.12 Building, Aerospace Science and

Technology Industrial Park, No.51, Zhongkai Road, Huizhou City,

Guangdong Province, China 516006.

Website: https://www.vanstone.com.cn/en

### Troubles and Troubleshooting

Troubles	Troubleshooting
Failing to turn on the device	1.Ensure the adapter is correctly plugged into both the POS and the power socket. 2.Try using a different adapter and restart the POS machine.
Device freezes	1.Disconnect the power adapter, wait a few seconds, then reconnect it and try powering on the device. 2.If the issue persists, Please contact the after-sales service..
Printer not working or unclear printing	1.Check the paper roll, install it correctly, or replace it if empty. 2.Inspect the roller for any debris or foreign objects.
Touchscreen unresponsive or keys not working	1.Wipe the screen with a soft, clean cloth to ensure it is dry. 2.Restart the device to restore normal operation.
Transaction failed or unable to connect to the network	1.Check the network connection and ensure the Ethernet interface and cable are securely connected. 2.Ensure the WIFI or mobile network settings are configured correctly. 3.Restart the device or contact your service provider.

If the problem remains the same, please contact customer service.

-7-

### Matters need attention

#### Cautions for use

- Unauthorized disassembly of this device will cause the built-in security key to be destroyed resulting in unusable.
- If the power adapter plug or power cord is damaged, please do not use them in case of electric shock or fire.
- Please do not touch power cord with wet hand or pull out the power adapter like pulling power cable.
- Please do not touch the device and power adapter with wet hand in case of short circuit, malfunction, or electric shock.
- Please stop using the power adapter and contact sales representatives for exchanging if the power adapter is caught in the rain, getting wet, or affected with damp seriously.
- If the device has to connect USB ports, please ensure that the USB ports has USB-IF identification, and its performance is qualified with the USB-IF requirements.

#### Operating environment

- Do not use the device during thunderstorms. Otherwise, the device may fail or you could get an electric shock.
- Keep the device away from rain, moisture and acid liquids that corrode circuit boards.
- Do not store or use the device in dusty or dirty places.

-8-

- Do not store the device at high temperature, High temperature shortens the life of electronic devices.
- Do not place the device in a too cold environment. When the temperature of the device rises, moisture may form inside the device, which may damage the circuit board.
- Please do not disassemble the device without permission. Non-professional operation may damage the device.
- Do not touch the screen with pens, pencils or other sharp objects.
- Do not strike, throw, step on, or subject batteries to severe physical shock.

#### Accessories requirements

- Please use manufacturer-authorized power adapters and other accessories. Use of unauthorized or incompatible accessories may result in fire, explosion or other hazard.
- The usage of unauthorized accessories will result in the violation of the warranty provisions or local relevant provisions, and may cause safety accidents. To obtain authorized accessories, contact the sales agent or distributor who sold the devices to you.

-9-

#### FCC compliance statement

This device complies with Part 15 of the FCC Rules. Operation is subject to the following two conditions: (1) this device may not cause harmful interference, and (2) this device must accept any interference received, including interference that may cause undesired operation.

Changes or modifications not expressly approved by the party responsible for compliance could void the user's authority to operate the equipment.

This equipment has been tested and found to comply with the limits for a Class B digital device, pursuant to Part 15 of the FCC Rules. These limits are designed to provide reasonable protection against harmful interference in a residential installation. This equipment generates, uses and can radiate radio frequency energy and, if not installed and used in accordance with the instructions, may cause harmful interference to radio communications. However, there is no guarantee that interference will not occur in a particular installation. If this equipment does cause harmful interference to radio or television reception, which can be determined by turning the equipment off and on, the user is encouraged to try to correct the interference by one or more of the following measures:  
— Reorient or relocate the receiving antenna.

-10-

— Increase the separation between the equipment and receiver.  
— Connect the equipment into an outlet on a circuit different from that to which the receiver is connected.  
— Consult the dealer or an experienced radio/TV technician for help.

#### FCC Radiation Exposure statement

This equipment complies with FCC radiation exposure limits set forth for an uncontrolled environment. This equipment should be installed and operated with minimum distance 20cm between the radiator and your body. This transmitter must not be co-located or operating in conjunction with any other antenna or transmitter.

-11-

### Aisino Vanstone Electronic (Beijing) Co., Ltd.

#### Quick Operation Guide

#### V77 Countertop POS Terminal



The pictures and descriptions in this guide are for reference only, please prevail in kind.