

## 2. User's manual (**provisionally**)

### MODULE, REMOTE TRANSMITTER

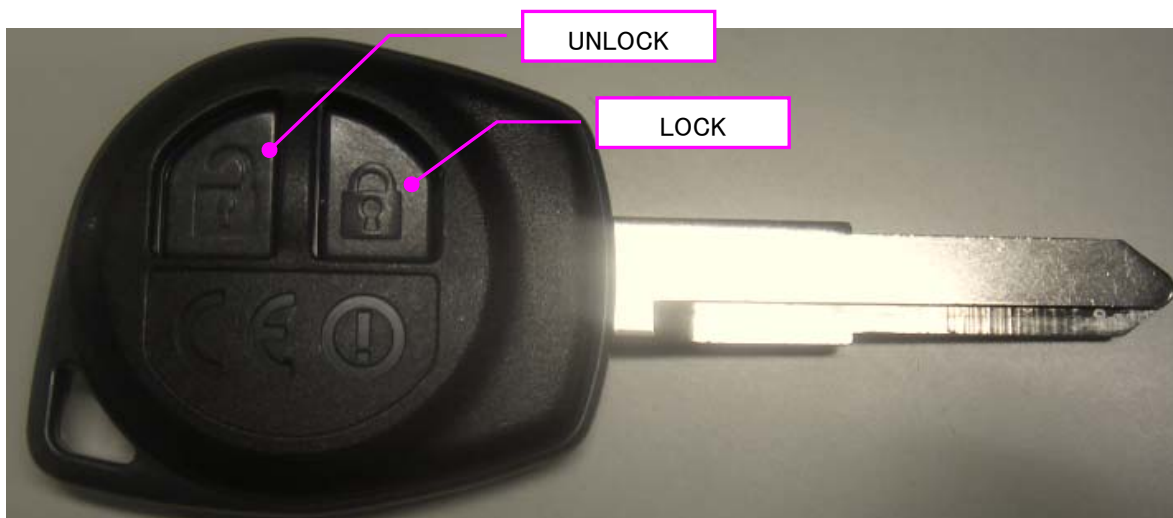

You can lock and unlock your vehicle with the module, remote transmitter.

### **LOCK**

When you push the LOCK button, all the doors will lock.

You cannot lock any of the doors with the module, remote transmitter if any door is open or the key is in the Key cylinder.

### **UNLOCK**

When you push the UNLOCK button once, only the driver's door unlocks. The remaining door unlock when you push the button a second time. If you unlock the doors with the module, remote transmitter, but do not open any of the doors within 30 seconds, the doors will automatically relocked.

You cannot unlock any of the doors with the module, remote transmitter if the key is in the key cylinder.



User Manual (FCC ID: OUCT85UE)

### Notation content only for countries subject to FCC regulations

Changes or modifications not expressly approved by the party responsible for compliance could void the user's authority to operate the equipment.

### Common notation content for FCC

This device complies with part 15 of the FCC Rules. Operation is subject to the following two conditions: (1) This device may not cause harmful interference, and (2) this device must accept any interference received, including interference that may cause undesired operation.

- The Federal Communications Commission (FCC) ID number is indicated in the illustrated position.

