



WIRELESS DOORBELL SIGNALER MODEL DB100

SONIC ALERT'S LIMITED WARRANTY

The Wireless Doorbell Signaler Model DB100 is warranted against manufacturing defects in materials and workmanship for two (2) year from the date of purchase. Within this period Sonic Alert will repair or replace at our option the DB100 without charge for parts and labor. Simply send the DB100 (postpaid) and a copy of your sales slip as proof of purchase to:

Sonic Alert Inc., 1050 E. Maple road, Troy MI 48063

OPERATION

The state-of-the-art, Doorbell Signaler will alert you when someone comes to visit. The Doorbell Signaler, Model DB100 is the only doorbell and intercom signaler that requires no wires and can be installed in seconds. DB100 will alert you that someone is at your door by flashing one or more lights around your home. The DB100 is designed to work with homes with or without an existing doorbell or chime and all existing buzzer/intercom systems.

Other features include selectable number of flashes (5 or 10), different flash code for front door, rear door, or intercom (requires additional sensor, sold separately), and a built-in chime for hearing members of the family (can be turned off by using the switch on the right side of the DB100). The DB100 receives a RF signal from the DB100 sensor, and flashes the light plugged into the built-in outlet. Use 300 watt incandescent lamp only. The DB100 can send a signal to all Sonic Alert remote receivers.

This device complies with Part 15 of the FCC Rules and with RSS-210 of Industry Canada. Operation is subject to the following two conditions:
(1) This device may not cause harmful interference, and
(2) this device must accept any interference received, including interference that may cause undesired operation.

WARNING: Changes or modifications not expressly approved by the party responsible for compliance could void user's authority to operate the equipment.

DB100

DB SENSOR

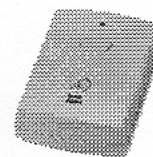
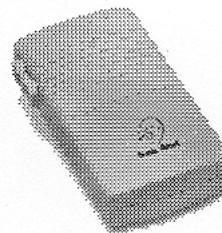

INSTALLATION

To install the DB100, follow the diagrams and instructions below that match the type of application you need for your home.

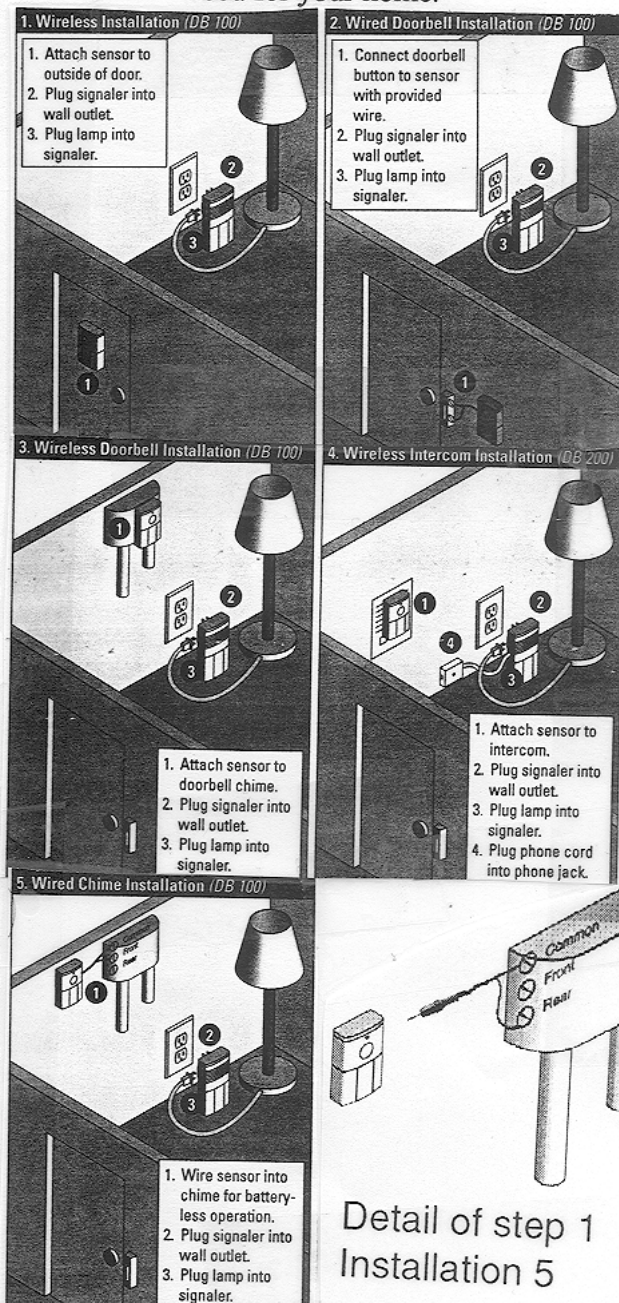

Note:

- 1) The switches (1-6) on the back of the DB100 should match the set up on the switches on the DB sensor.
- 2) The On/Off switch on the DB100 turns the built-in bell on or off.