

**APPENDIX H**  
**: USER'S MANUAL**

## FCC Compliance Statement

### NOTE:

This equipment has been tested and found to comply with the limits for a Class B digital device, pursuant to Part 15 of FCC Rules. These limits are designed to provide reasonable protection against harmful interference in a residential installation. This equipment generates, uses, and can radiate radio frequency energy and, if not installed and used in accordance with the instructions, may cause harmful interference to radio communications. However, there is no guarantee that interference will not occur in a particular installation. If this equipment does cause harmful interference to radio or television reception, which can be determined by turning the equipment off and on, the user is encouraged to try to correct the interference by one or more of the following measures:

- Reorient or relocate the receiving antenna.
- Increase the separation between the equipment and receiver.
- Connect the equipment into an outlet on a circuit different from that to which the receiver is connected.
- Consult the dealer or an experienced radio/television technician for help.

### Notice 1 :

The changes or modifications not expressly approved by the party responsible for compliance could void the user's authority to operate the equipment.

### Notice 2 :

Shielded interface cables, if any, must be used in order to comply with the emission limits.

### DOC CLASS B NOTICE

This digital apparatus does not exceed Class limits for radio noise emission for a digital apparatus as set out in the Radio Interference Regulations of the Canadian Department of Communications.

## MAIN FEATURES

Thank you for purchasing our high resolution TFT LCD monitor.

We recommend that you thoroughly read through this user's guide before using the product. It is also recommended to safely store the guide in times of immediate need in the course of using the product.

## FRONT OF MONITOR

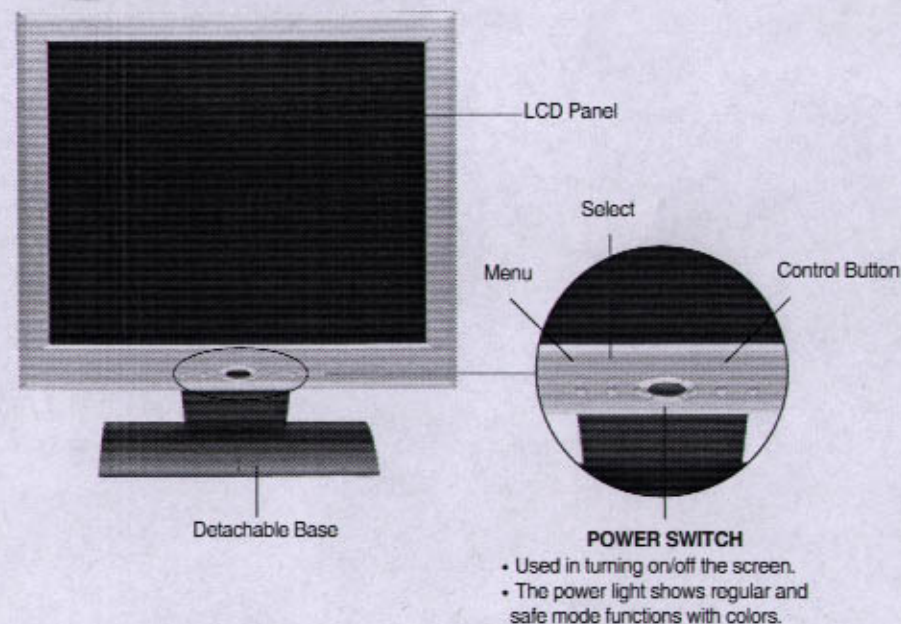



## ● TROUBLE SHOOTING

When failure or problems occur, refer to the following, for further assistance, contact our customer support centers.

The power does not turn on	• Check whether the plug is in place and try to reconnect it.
The "CHECK CABLE" sign does not appear	• Check if the signal cable is properly connected to the computer or video card and try to reconnect it.
"NOT SUPPORTED" appears on the screen	• Set the resolution and frequency compatible to the monitor. (refer to pg 11)
The screen looks like it is melting	• Check the connection of the monitor and the signal cable of the computer.
The screen trembles	• Check if the resolution and frequency of the computer or the video card is set to accommodate the monitor and then reset the screen according to the present mode of the monitor menu and the standard signal timing chart.
A shadow appears on the screen	
The screen is too bright	• Try to control the brightness or contrast of the screen. (refer to pg 7)
The color of the screen appears as if there is a shadow.	• Go to the OSD color control menu, the user mode and control the color. (refer to pg 7)
The power light is orange or flickers	• Check if the computer is on safe mode. Press on the PC keyboard or move the mouse. The screen will appear.
The screen is blurry	• Control the screen's frequency and danty.

## ● SPECIFICATIONS

Category		19.0"
LCD(PANEL)	Screen Size	19.0
	Visible ScreenSize	376.32(H) X 301.056(V)
	Pixel Range	0.098(H) X 0.294(V)
	Type	a-si TFTLCD(liquid crystal display)
Frequency	Visual Angle	U / D / L / R 85°
	Horizontal Frequency	30~80 kHz(Auto Set)
	Vertical Frequency	56~75 Hz(Auto Set)
	Optimize Resolution	1280 x 1024 / 60Hz
Color Display	DisplayableColor	16.7M Color
Input Signal	VIDEO Signal	Analog 0.7Vp-p POSITIVE (75 Ω)
Power/Voltage	Voltage Use	Flow 100~240V,60Hz/50Hz DC 12V/3.5A
Energy	Regular Energy	Maximum 40W
Consumption	Safe Mode	Under5W
Movement	Temperature	-20°C ~ 40°C
Conditions	Humidity	10% ~ 95%
Weight	Net	7.5 kg
	Gross	9.5 kg

The above specifications can be changed without prior notice for quality improvement.



## STANDARD SIGNAL TIMING CHART

If the signals conveyed from the computer match the following standard signals, the screen automatically controls the signals. Conversely, if the signals do not match, the screen will not appear or only the power light would activate. Therefore it is important that you first set as the following, with reference to the Video Card Guide.

	Resolution	Frequency			Polarity	
		Horizontal(kHz)	Vertical(Hz)	Clock Frequency(MHz)	HOR	VER
1	640×350	31.5	70	25.175	+	-
2	640×480	31.5	60	25.175	-	-
3	640×480	37.861	72.809	31.5	-	-
4	640×480	37.5	75	31.5	-	-
5	720×400	31.469	70.087	28.322	-	+
6	800×600	35.156	56.3	36	+	+
7	800×600	37.9	60.3	40	+	+
8	800×600	48.1	72.2	50	+	+
9	800×600	46.9	*75	49.5	+	+
10	1152×864	67.5	75	108	+	+
11	1152×900	71.713	76.047	105.561	-	-
12	1024×768	48.4	60	65	-	-
13	1024×768	56.5	70.1	75	-	-
14	1024×768	60	75	78.75	+	+
15	1280×1024	63.981	60	108	+	+
16	1280×1024	74.405	70	125	-	-
17	1280×1024	79.976	75	135	+	+
18	640×480(MAC)	31.469	60	25.175	-	-
19	640×480(MAC)	35	66.667	30	-	-
20	832×624(MAC)	49.726	74.551	57.284	-	-
21	1024×768(MAC)	48.78	60	64	-	-
22	1024×768(MAC)	60.241	74.927	80	-	-
23	1152×870(MAC)	68.681	75.0	100	-	-

## PRECAUTIONS

The below precautions should be carefully followed for the effective function of the product and safety of users.



Do not use damaged plugs or worn out outlets. (danger of electrocution)



Do not expose the product to severe impacts. (This could occur damage)



Do not try to disassemble, repair, renovate the product without expert assistance. (Contact the service center for parts needing repair)



In weather conditions of thunder and/or lightening, or when you will not be using the product for a long period of time, leave the plug out of the outlet. (Danger of electrocution)



Do not try to bend the cord or put it under heavy objects. (Danger of electrocution, fire)



Do not leave the product in damp or wet places as there is danger when the product is exposed to water or metal. (danger of electrocution)

### Other Precautions

In cleaning the product take out the plug from the outlet, wipe with a soft and clean cloth then with water. Never use benzene, alcohol or other cleaners. (Contact the service center or a store near you for static controllers and cleaners. The LCD polarizing plate may peel off or the product may decolorize, dissolve, or crack.



## ● CONTROLLING OTHER FUNCTIONS



### • VIEWING THE MENU LANGUAGE IN DIFFERENT LANGUAGES

MENU → SELECT LANGUAGE  → SET → CONTROL WITH(+,-)

- You can select language  
(English, Spanish, German, French, Italian)

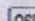
### • CONTROLLING OSD

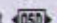
MENU → SELECT OSD  → SET → CONTROL WITH (+,-) → SET

- ① Select  in controlling OSD Time
- ② Select  in controlling OSD H-Position
- ③ Select  in controlling OSD V-Position

### • EXIT →

MENU → SELECT EXIT →  → SET

- You can leave the OSD menu.

### • INITIALIZING SCREEN CONTROL

- Press the "DOWN" button and "POWER" button in the same time a "Power-off" state.
- Use this in retrieving the initial state.

## ● POWER SAVING MODE(S)

If your computer system features a display power management function, the Monitors enter into the power saving modes as follows.

When it is used with a computer system equipped with DPMS(VESA) this Monitor provides an EnergyStar compliant function. If your computer does not feature display power management, please source an optional DPMS software program.

Power saving modes greatly reduce power consumption when the computer is temporarily not in use. Simply press any key or mouse button to return the Monitor display to normal operation.

	Normal Operation	Power Saving function EPA		
		stand-by	suspend	Off
H-Sync	Active	Inactive	Active	Inactive
V-Sync	Active	Active	Inactive	Inactive
Video	Green	Blanked	Blanked	Blanked
LED Color	Green	Orange/Green Blinking(1sec)	Orange/Green Blinking(0.5sec)	Orange
Power Consumption	40 Watts	5 Watts	5 Watts	5 Watts



## BASIC SCREEN CONTROL



### • TO BRIGHTEN THE SCREEN ☀

MENU → BRIGHT ☀ → SET → CONTROL WITH (+, -) → SET

- You can control the brightness of the screen.

### • TO CLARIFY THE SCREEN ①

MENU → CONTRAST ① → SET → CONTROL WITH (+, -) → SET

- You can control the contrast of the images or letters on the screen.

### • CONTROLLING SCREEN COLOR [RGB]

MENU → SELECT [RGB] → SET  
→ SELECT COLOR TEMPERATURE WITH (+, -) → SET

- You can select screen color temperature (6500K-9300K) and control color in selecting USER mode.
- User Color control select user mode USER Control With (+, -)
- ① Select in Controlling Red Gain
- ② Select in Controlling Green Gain
- ③ Select in Controlling Blue Gain

## SCREEN CONTROL

### • AUTO ADJUST [AUTO]

MENU → SELECT AUTO ADJUST [AUTO] → SET

- You can automatically control the monitor to the best compatible state.

### • VIEWING MONITOR INFO ⓘ

MENU → INFORMATION ⓘ → CONTROL WHIT(+, -)

- You can view vertical/horizontal frequency info and resolution.

### • CONTROLLING CLOCK ⌚

MENU → SELECT CLOCK ⌚ → SET → CONTROL WHIT(+, -) → SET

1. Select [CLK] in Controlling Clock.
2. Select [PH] in Controlling Phase.

### • POSITION 🖥

MENU → SELECT POSITION 🖥 → SET → CONTROL WHIT(+, -) → SET

1. Select 🖥 in Controlling H - Position.
2. Select 🖥 in Controlling V - Position.



## INSTALLING MONITOR DRIVER

Once the monitor driver is installed, resolution and frequency is set to accommodate the monitor, therefore providing a clear screen.

In order to purchase a separate driver, refer to our homepage.

- Internet <http://www.imri.co.kr>

### <Windows Monitor Installing Program>

This file explains how to install the monitor driver on Windows. Follow the following procedures.

**Caution** Check the type of the monitor before you install the driver. (if the driver is improperly installed, the frequency may be increased or decreased, possibly deactivating resolution)

## 1. WINDOWS

### 1) Auto Install

Put in the install diskette.  
Run 'install.exe' (using Search programs)

Select the model name of your monitor. Select "OK."

Monitor is installed successfully. Select "OK."

Now, ready to start Monitor optimization.  
If you don't want to keep the new settings,  
Press 'ESC' or wait 12 seconds. Select "Yes"

Monitor optimization is completed!!  
Return to previous window in 12 seconds.  
Do you want to keep this setting?  
Select "Yes"

## 2) Manually installing

- With the mouse pointer on the Windows desktop, select registration info by right clicking.

- Select the "set" button and select the "Advanced Registration Info" button.
- Select "monitor" and press the "Change" button.
- Press "next" in the update master window.
- After making a driver list, select the desired driver and press 'next.'
- After inserting the diskette, set the directory and press the ok button.  
(If you are not sure of the route location of the driver, press 'find')
- When the 'select model' window appears, select your monitor model and press 'next.'
- When the window 'completed installation of selected driver' press 'finish,' 'close', 'ok', and exit the display setting menu.



## ● COMPONENTS

- After discarding the package and wrapping of the LCD monitor, check for the following components in the box.

### ◆ MAIN COMPONENTS

- 19" LCD Monitor
- Installing Driver Diskette
- Signal Cable
- Power Adapter
- User's Guide (Warranty Card)
- Power Cable

## ● PRECAUTIONS IN INSTALLING

- Install on safe ground. :There's possibility of damage of the product or harming people.
- Always cover the product or keep in a well ventilated place. :There is danger of fire and also for safe maintenance.
- Do not put anything containing water, medicine, small metal material, or heavy objects on the product. :Danger of fire, electrocution, and damage to the product.
- Do not expose the product to direct sun light. :The screen will not maintain clarity and may cause damage to the eye.
- Do not install in damp, dusty, or wet places. :Danger of fire and electrocution.
- Do not put candles, cigarettes, or other objects with excessive heat. :Danger of fire.
- Do not install any external connections, only connecting cords and adapter included in the box. :Damage and fire may occur.

## ● CONNECTING TO YOUR PC

- Connect to AC100V-240V capacity outlets.

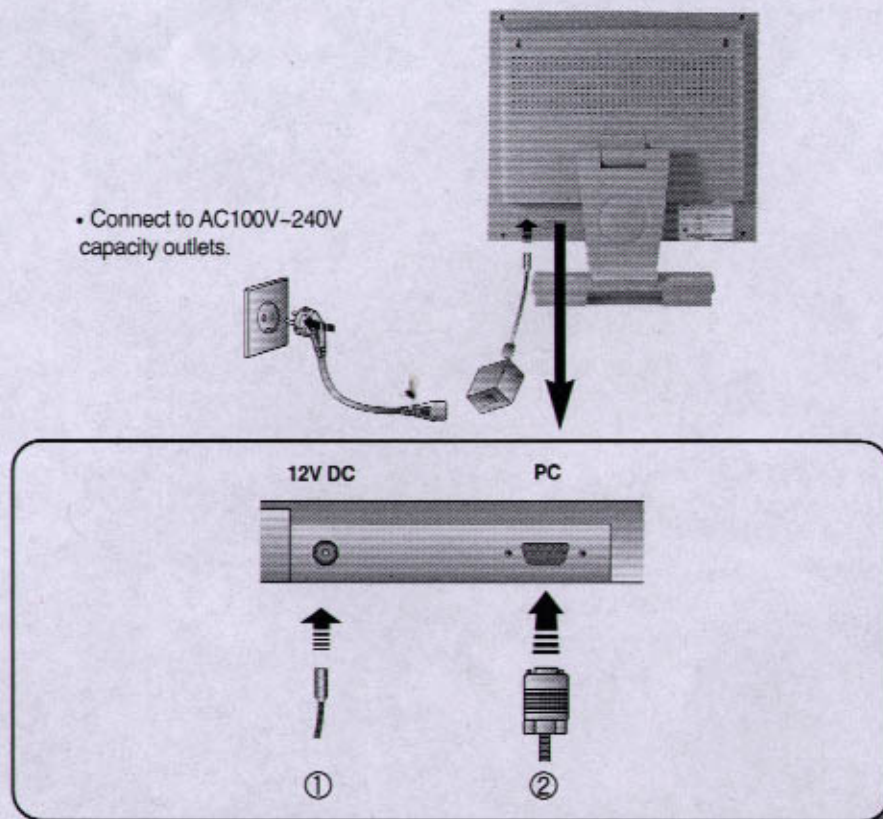

- ① Connect to 12V DC with the adapter included in the box to AC100V-240V outlet.
- ② Connect signal cable to PC. ("CHECK CABLE" will appear on the monitor if improperly connected. In case of using Macintosh, use the exclusive adapter. (except for G3 or higher)



## ● BACK OF MONITOR

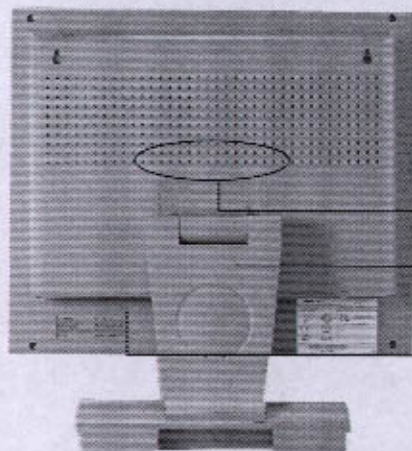

Ventilator

(Caution!) Do not block the ventilator  
Detachable Base  
Detachable for other equipments  
(VESA ARM) and wall hanging use.

Connector to External Functions  
Connects signals with external  
equipments and PCs.

## ● FUNCTIONS

Although regular monitors for PCs use CDT as a medium for display, the TFT LCD monitor is a Flat Panel Display based on digital technology, and was originally used only for laptops PCs. Now it is used for desktops and laptops alike, opening a world of conveniences and quality to those ardent PC users.

The following functions are provided in our products.

1. Convenient and easy to handle Control Button.
2. A slim and space reducing monitor.
3. Monitor transferable for wall hanging.
4. Industrial robot and VESA installable.
5. Liberal angle control.(+30°C ~ -5°C)
6. Low energy consumption.(refer to pg 10)
7. Scarcely influences surrounding objects, with no harmful electronic waves, noise, heat or magnetic activities.

## ● CONTENTS

### INTRODUCTION

MAIN FEATURES .....	1
FRONT/BACK OF MONITOR .....	1,2
FUNCTIONS .....	2

### INSTALLING

COMPONENTS .....	3
PRECAUTIONS IN INSTALLING .....	3
CONNECTING TO YOUR PC .....	4
INSTALLING MONITOR DRIVER .....	5

### SCREEN CONTROL

BASIC SCREEN CONTROL	
TO BRIGHTNESS THE SCREEN .....	7
TO CLARIFY THE SCREEN .....	7
CONTROLLING SCREEN COLOR .....	7
SCREEN CONTROL	
AUTO ADJUST .....	8
VIEWING MONITOR INFO .....	8
CONTROLLING CLOCK .....	8
POSITION .....	8
CONTROLLING OTHER FUNTION	
VIEWING THE MENU LANGUAGE .....	9
CONTROLLING OSD .....	9
EXIT .....	9
INITIALIZING SCREEN CONTROL .....	9
POWER SAVING MODE(S) .....	10

### OTHERS

STANDARD SIGNAL TIME CHART .....	11
PRECAUTIONS .....	12
TROUBLE SHOOTING .....	13
SPECIFICATIONS .....	14