

## FUNCTIONS

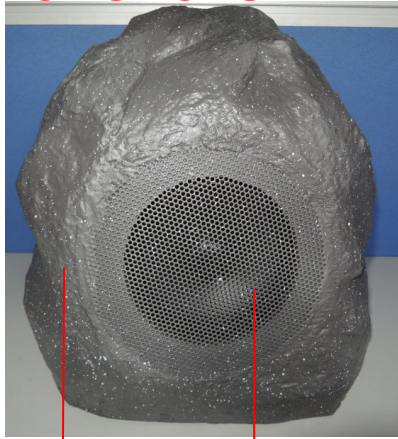

Front view

Metal mesh over driver unit



Back view



Right side view

LED indicator

Silicon cover (will be gray in mass production)

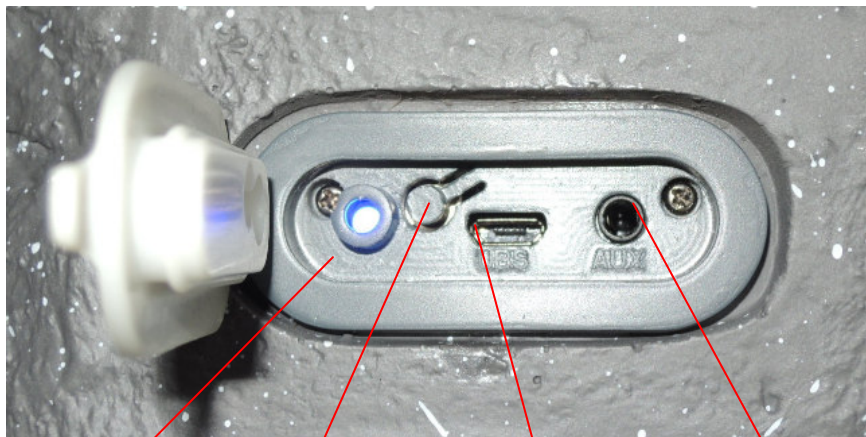

LED indicator

Power ON & OFF

USB charging port

AUX port

## INSTALLATION

1. Open the silicon cover, then press and hold Power ON & OFF for seconds to turn on the speaker. Till LED indicator lights in blue quickly and a single tone sounds, the speaker is in bluetooth pairing mode.
2. Turn on Bluetooth function of the cell phone and search available devices. When 'SBT625' found, select it from the list to pair with the speaker. Then a series tone sound and LED indicator lights in blue without shining, the speaker is connected successfully with the cell phone.
3. Play the music in the player and LED indicator lights in blue slowly.
4. Disconnect the speaker with the cell phone, and a single tone sounds.
5. Connect one end of 3.5mm audio cable to the AUX port and another end to the cell phone, Then a series tone sound and LED indicator lights in blue without shining, it' s switched to AUX mode.
6. Play the music in the player and LED indicator lights in blue slowly.
7. Press and hold Power ON & OFF for seconds till a single tone sound, and the speaker is turned off.
8. If the speaker can' t be connected with cell phone, turn off the speaker and Bluetooth function of the

cell phone, and then repeat step 1-6.

9. Connect small end of Micro USB charging cable to the speaker and big end to USB port of the computer, and LED indicator lights in red, and the speaker is in charging mode. When the speaker is charged fully, LED indicator will shut off.
10. Be sure to close the silicon cover after use.

## **WARNING**

1. Be sure to close the silicon cover on the right side of the speaker.
2. After the speaker used under splash, make sure you will clean the water over the speaker, especially the silicon cover, then you can open the silicon cover and charge the speaker.

## **IPX4 splashproof feature**

### **FCC Caution:**

Any Changes or modifications not expressly approved by the party responsible for compliance could void the user's authority to operate the equipment.

This device complies with part 15 of the FCC Rules. Operation is subject to the following two conditions: (1) This device may not cause harmful interference, and (2) this device must accept any interference received, including interference that may cause undesired operation.

Note: This equipment has been tested and found to comply with the limits for a Class B digital device, pursuant to part 15 of the FCC Rules. These limits are designed to provide reasonable protection against harmful interference in a residential installation. This equipment generates, uses and can radiate radio frequency energy and, if not installed and used in accordance with the instructions, may cause harmful interference to radio communications. However, there is no guarantee that interference will not occur in a particular installation. If this equipment does cause harmful interference to radio or television reception, which can be determined by turning the equipment off and on, the user is encouraged to try to correct the interference by one or more of the following measures:

—Reorient or relocate the receiving antenna.

—Increase the separation between the equipment and receiver.

—Connect the equipment into an outlet on a circuit different from that to which the receiver is connected.

## FCC radiation exposure statement

This radio is intended for use in general/uncontrolled applications where users have been made aware of the potential for exposure and can exercise control over their exposure.

This radio device is not authorized for general population, consumer or similar use.

The antenna should be installed and operated with a minimum distance of 0.2m to any person.

This transmitter must not be co-located or operating in conjunction with any other antenna or transmitter.