



RD-RFK858BT Bluetooth Keyboard User's Manual

Thanks for purchasing this Bluetooth Keyboard. It's with standard 78 keys. This creative and easy-to-use Bluetooth 3.0 keyboard will bring you a whole new wireless life experience.

1.0 System Requirement

iPad, Mac OS

Windows OS (Windows XP, Windows Vista, Windows 7)

2.0 Installation Guide

Before use the keyboard, please make sure the battery is installed well in the keyboard. Open the cover of the battery slot and install two pieces of 1.5V AAA battery. Then cover the battery slot. Make sure that the batteries' polarities are in accordance with the polarity marks in the battery slot.



Photo (1)

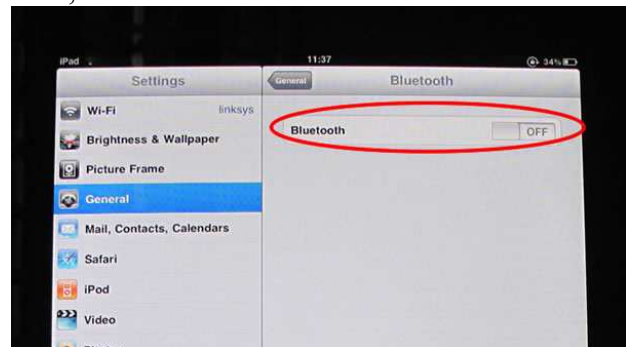
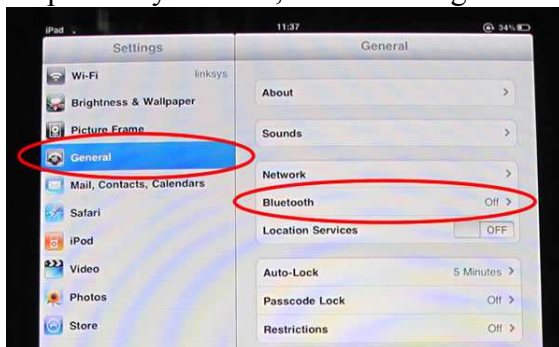

Photo (2)

2.0.1 Connecto to iPad

Step 1: Put the power switch on keyboard to "ON", and press pairing key on the keyboard, the Bluetooth Synch LED will wink, now the keyboard is in pairing mode.

Step 2: On your iPad, enter "Setting"---"General", turn on "Bluetooth".



Step 3: After turning on "Bluetooth", it will search bluetooth devices automatically.

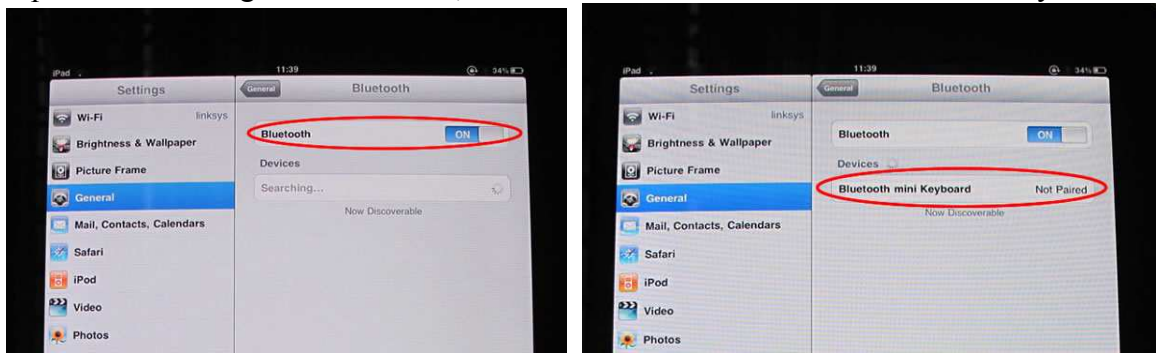

Step 4: After finding "Bluetooth Keyboard", press the device, it will start connecting, and there will be a password displayed.

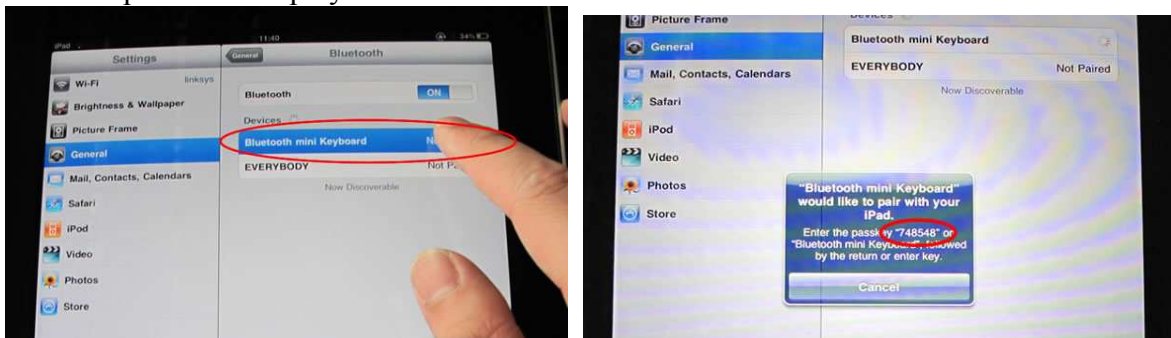

Step 5: Press the password in your Bluetooth Keyboard, and "Enter", then it will connect with your iPad. Now you can use your Bluetooth Keyboard.



2.0.2 Connect to Computer

Step 1: Push the Power Switch to "ON" and then press the PAIR button. The Bluetooth Synch LED will wink.



Step 2: Make sure the Bluetooth function has been activated in your computer (if not, you need to buy a separate Bluetooth USB receiver to connect to the computer). Double click the Bluetooth Icon

on the Task Bar or in the Control Panel, open the "Bluetooth management" window, click "add", tick off "facility is ready for searching", click "Next".



Step 3: The Bluetooth keyboard will automatically search for Bluetooth paired device after the PAIR button was pressed. A corresponding dialog box will pop up on the screen of the PC or Notebook. Input the security code which displays on the dialog box by the Bluetooth keyboard and press Enter. When the Bluetooth Synch LED stop winking, it means the Bluetooth connection was established successfully between the keyboard and the computer.

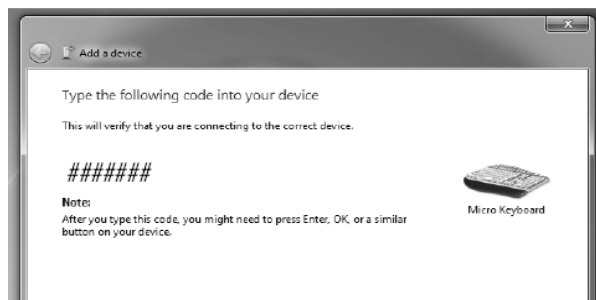

Step 4: It will take a few seconds for the computer to automatically install some drivers once the Bluetooth connection has been established. Upon installation of the drivers, the Bluetooth keyboard is ready to work.

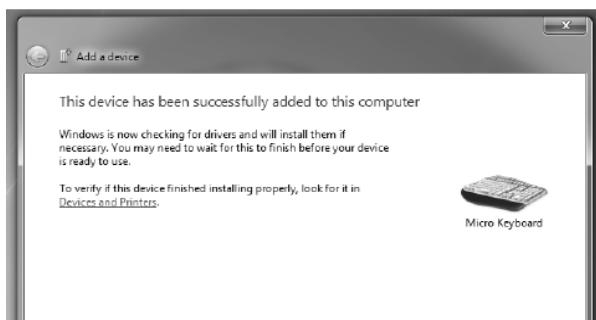

As long as the PAIR button was not pressed again or the Paired device was not removed, users no need to make pairing any more after the pairing process was accomplished, even the batteries were took out from battery slot.

3.0 FAQ:

If unable to connect the Bluetooth Keyboard to the computer, or the keyboard works

unconventionally, please try the steps below:

1. Make sure that the computer is connected to the Bluetooth keyboard. If they are matched to each other before, then under the standby state, just click the “Enter” key of the keyboard;
2. Make sure that the keyboard is within the effective range – 10M;
3. Make sure that there’s no change of the Bluetooth facility. If anything changed, please kindly rematch;
4. If your Bluetooth facility is connected to other Bluetooth products, please kindly confirm that the speed of the bluetooth facility is enough;
5. Please kindly check the batteries. If they’re short of power, replace them for new ones.

4.0 FCC statement

Changes or modifications not expressly approved by the party responsible for compliance could void the user’s authority to operate the equipment.

This equipment has been tested and found to comply with the limits for a Class B digital device, pursuant to Part 15 of the FCC Rules. These limits are designed to provide reasonable protection against harmful interference in a residential installation. This equipment generates, uses and can radiate radio frequency energy and, if not installed and used in accordance with the instructions, may cause harmful interference to radio communications. However, there is no guarantee that interference will not occur in a particular installation.

If this equipment does cause harmful interference to radio or television reception, which can be determined by turning the equipment off and on, the user is encouraged to try to correct the interference by one or more of the following measures:

- Reorient or relocate the receiving antenna.
- Increase the separation between the equipment and receiver.
- Connect the equipment into an outlet on a circuit different from that to which the receiver is connected.
- Consult the dealer or an experienced radio/TV technician for help.

**CAUTION: RISK OF EXPLOSION IF BATTERY IS REPLACED BY AN INCORRECT TYPE.
DISPOSE OF USED BATTERIES ACCORDING TO THE INSTRUCTIONS.**