

客户名称 CUSTOMER NAME:	TECHNICALPRO	产品型号 MODE NO.:	S-4152	客户型号 CUSTOMER MODE NO.:	BLUET50
设计师 DESIGNER:	LI HAI JUN	材质 MATERIAL:	250G 铜版纸	日期 DATE:	Dec.-5-2012
确认 CONFIRM:	LU DE HUA	尺寸 SIZE:	W105×145MM		



User Manual

Technical Pro Bluetooth® Speaker System

MODEL: BLUET40



BLUET40

WARNING!

CAUTION: TO REDUCE THE RISK OF ELECTRIC SHOCK, DO NOT REMOVE THE COVER ON USER SERVICEABLE PARTS INSIDE. REFER ALL SERVICING TO A QUALIFIED TECHNICIAN

- ⚠** The lightning flash with arrowhead symbol within an equilateral triangle is intended to alert the user to the presence of "dangerous" voltage within the product's enclosure that may be of sufficient magnitude to constitute a risk of electric shock to humans. Users should exhibit extra safety when this symbol appears in this instruction manual and follow all precautions as they are stated.
- ⚠** The exclamation point within an equilateral triangle is intended to alert the user to the presence of important operating and maintenance (servicing) instructions in this manual.
- 1- Read these instructions thoroughly before using this item.
 - 2- Keep these instructions for future reference.
 - 3- Heed all warnings.
 - 4- Follow all instructions.
 - 5- WARNING: To prevent fire or electric shock, do not expose this equipment to rain or moisture. Do not store or operate this product near any liquids.
 - 6- Clean only with a dry cloth.
 - 7- Do not store or operate this product near any heat sources such as radiators, heat registers, stoves, or other apparatuses (including amplifiers) that produce heat.
 - 8- Do not defeat the safety purpose of the polarized or grounding-type plug. A polarized plug has two blades with one wider than the other. A grounding plug has two blades and a round grounding prong. The wide blade or third prong is provided for your safety. If the provided plug does not fit your outlet, consult an electrician for the replacement of the obsolete outlet.
 - 9- Protect the all wires connected to this unit from being walked on or pinched, particularly plugs and the point where they exit from the unit. When removing the cord from the power outlet, remove it by holding the plug not by pulling the cord.
 - 10- Unplug the unit during lightning storms or when unused for long periods of time.
 - 11- When wiring this unit and all other equipment used in connection to this unit make sure that all of your equipment is turned OFF.
 - 12- Once installation and wiring is complete power on all your equipment with the volume and level controls turned DOWN. Once all the equipment is ON slowly raise the volume or level controls to their proper positions.
 - 13- When grounding this unit, be sure to do so correctly, so as not to defeat the built-in grounding in this unit.
 - 14- When you have finished using this unit, be sure that both tray doors are closed using the open/ close button before powering off the unit.
 - 15- Before placing, installing, rigging, or suspending any product, inspect all hardware, suspension, cabinets, transducers, brackets and associated equipment for damage. Any missing, corroded, or non-load rated component could significantly reduce the strength of the installation, placement or array. Any such condition severely reduces the safety of the installation and should be immediately corrected. Use only hardware which is rated for rated for the loading conditions of the installation and any possible short-term, unexpected overloading. Never exceed the rating of the hardware or equipment.
 - 16- Consult a licensed, Professional Engineer regarding physical equipment installation. Ensure that all local, state and national regulations regarding the safety and operation of equipment are understood and adhered to.
 - 17- Refer all servicing to qualified service personnel. Servicing is required when the apparatus has been damaged in any way, such as power supply cord or plug is damaged, liquid has been spilled or objects have fallen into the apparatus, the apparatus has been exposed to rain or moisture, does not operate normally, or has been dropped.



BLUET40

Introduction

Congratulations and thank you for your purchase of this Technical Pro Powered Bluetooth Speaker System, The BLUET40 to get the most from your BLUET40, it is recommended that you review all of the information provide in this instruction manual before operating this equipment.

If you've spent any time at all in professional audio, you know the name Technical Pro and what it stands for - incredible performance & sound, and the ultimate in reliability under harsh conditions. And now, Technical Pro offers the same technology in a series of power loudspeakers bringing more of what sets Technical Pro apart from all others.

BLUET40 Rear Panel

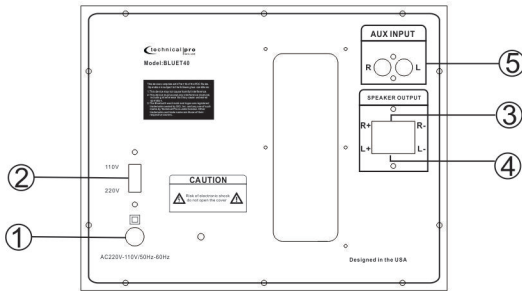

1. Power Supply: Connect the power cord here. The power switch (blue key on the front panel) should be set off position before the power supply is connected.
2. Power Select: Before connecting the power supply please insure your power is 110V or 220V depending on the voltage you are using (USA is 110V).
3. Right Satellite Speaker Connector: Connect one of the satellite speakers to this output.
4. Left Satellite Speaker connector: Connect one of the satellite speakers to this output.
5. AUX Line Input (RCA): Connect your sound source to this RCA input. The line volume will be controlled be the volume knob located on the front panel of the unit. Only passive signals should be connected to this input. To play from the source connected to the AUX Input, the Bluetooth/AUX input select (9) should be set to AUX.



BLUET40

BLUET40 Front Panel

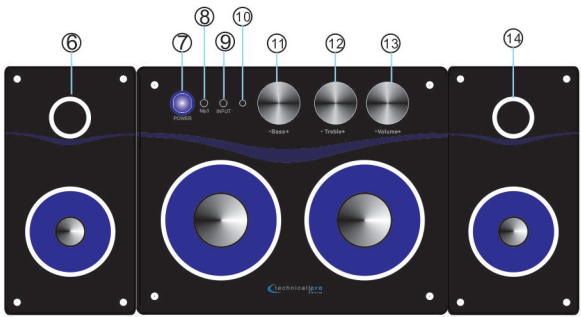

6. Left Satellite Speaker: Connect this speaker to the left speaker output on the rear of the base unit.
7. Power Switch: Before the unit is powered on, all of the level controls should be turned down all the way. Once powered on, slowly begin to raise the levels of the inputs. This will prevent damaging both the speakers and the amplifier.
8. AUX Line Input (3.5MM Jack): Connect your mp3 player to this input. The line volume will be controlled by the volume knob located on the (13). Only passive signals should be connected to this input. To play from the source connected to the AUX Input, the Bluetooth /AUX input select (9) should be set to AUX.
9. Input key: Press this button to select the proper input, AUX/ Bluetooth.
10. LED Indicator: When the LED indicator is set to flashing Bluetooth, the BLUET40 is ready to be connected to from a Bluetooth enabled device. When the LED indicator is solid Blue the BLUET40 has successfully connected to a Bluetooth enabled device. When the LED indicator is set to Red color, the BLUET40 is ready to play AUX.
11. Bass volume: Turn this knob to select increase or decrease the Bass volume.
12. Treble volume: Turn this knob to select increase or decrease the treble volume.
13. Master Volume: Turn this knob to increase or decrease the master volume.
14. Right Satellite Speaker: Connect this speaker to the right speaker output on the rear of the base unit.



BLUET40

BLUET40 Operation

Using The AUX (RCA or 3.5 Jack) Input: Power off the BLUET40 and lower the volume. Connect the output from the AUX source (CD, DVD, Mixer, Mp3 player) to the AUX (RCA or 3.5 Jack) input on the rear or top of the BLUET40 base unit. Connect the BLUET50 satellite speakers to the speaker outputs on the rear of the BLUET40 base unit. Power on the BLUET40 and the AUX signal sources. Set the Input key to AUX. Slowly raise the volume to the desired levels.

Using the Bluetooth Input: Power on the BLUET50 and lower the volume. Press Input button to set the unit to the Bluetooth input. The LED indicator should be flashing Blue. Open the Bluetooth enabled device's Bluetooth connections and search for Bluetooth enabled devices. The Bluetooth device should be able to locate a device named "BLUET40". Select this device and connect to it. In order to connect to the device enter the password which is "0000". Once successfully paired you will be able to play audio directly on the BLUET40 from your Bluetooth enabled device. When the input is switched to AUX and then back to Bluetooth there is no need to pair the enterthe password in order to connect a Bluetooth enabled device that was previously paired with the BLUET40.

THIS DEVICE COMPLIES WITH PART 15 OF THE FCC RULES. OPERATION IS SUBJECT TO THE FOLLOWING TWO CONDITIONS: (1) THIS DEVICE MAY NOT CAUSE HARMFUL INTERFERENCE AND (2) THIS DEVICE MUST ACCEPT ANY INTERFERENCE RECEIVED, INCLUDING INTERFERENCE THAT MAY CAUSE UNDESIRED OPERATION.

Federal Communications Commission Requirements:

The equipment has been tested and found to comply with the limits for Class B Digital Device, pursuant to part 15 of FCC Rules. These limits are designed to provide reasonable protection against harmful interference in a residential installation. This equipment generates uses and can radiate radio frequency energy and, if not installed and used in accordance with the instruction, may cause harmful interference to radio communication. However, there is no guarantee that interference will not occur in a particular installation.

If this equipment does cause harmful interference to radio or television reception, which can be determined by turning the equipment off and on, the user is encouraged to try to correct the interference by one or more of the following measures:

- Increase the separation between the equipment and receiver.
- Connect the equipment into an outlet on a circuit different from that to which the receiver is connected.

- Consult the dealer or an experienced radio/TV technician for help.

THE CHANGES OR MODIFICATIONS NOT EXPRESSLY APPROVED BY THE PARTY RESPONSIBLE FOR COMPLIANCE COULD VOID THE USER'S AUTHORITY TO OPERATE THE EQUIPMENT.

FCC Radiation Exposure Statement

The equipment complies with FCC radiation exposure limits set forth for uncontrolled equipment and meets the FCC radio frequency (RF) Exposure Guidelines in Supplement C to OET65. The equipment has very low levels of RF energy that it is deemed to comply without testing of specific ratio (SRA)