

AFFINITY

Bluetooth
BLUETOOTH SPEAKER SYSTEM

Specifications

Power Output : 15 W+ 15 W= 30W
Drivers Unit : 2.5" x 6 Ohm x 2
Distortion : ≤ 0.5% @ 1W
Separation : ≥ 40dB(1KHz)
S/N : ≥ 70dB
Frequency : 80 Hz -20K Hz
Dimension(WxHxD) : 280 x95 x100 mm

Limited North American Warranty
Affinity
SBX400

For peace of mind and valuable services, please take a moment to register your product at www.kcpi.us
Kith Consumer Product Inc. (KCPI) expresses the following limited warranty on AFFINITY products. This warranty extends to a new product purchased from an authorized reseller/retailer within the U.S. by the original purchaser or consumer who received the product as a gift. Retain and provide the original bill of sale (or photocopy) as proof of purchase. It is also recommended that you retain original box and foam packaging.

Limited One (1) Year Warranty on Parts and Ninety (90) Days Labor
KCPI warrants the parts in this product against defects in material or workmanship for a period of one (1) year from the date of original purchase from authorized retailers.

Your Responsibility
Warranty service shall be provided when a return authorization number (RMA#) is provided to you. Warranty extends to defects in materials or workmanship and does not cover cosmetic imperfections, damages incurred during shipment to KCPI, misuse, natural disasters or accidents.

How to Obtain Warranty Service
If after following the user manual, quick start and troubleshooting guide, should you find it necessary to contact Customer Service directly, call 888-777-0450 from 7am-11pm Mon-Fri (Central Time) and 7am-6pm Sat-Sun (Central Time). Have your date of purchase, serial number, and a full understanding of the issue ready for your call center representative.

This device complies with Part 15 of the FCC Rules. Operation is subject to the following two conditions: (1) this device may not cause harmful interference, and (2) this device must accept any interference received, including interference that may cause undesired operation.

AFFINITY

BLUETOOTH SPEAKER SYSTEM

WIRELESS
SPEAKERS



SBX400
USER MANUAL
Bluetooth

AFFINITY

Bluetooth
BLUETOOTH SPEAKER SYSTEM

Welcome

Dear user:

Thank you for using our products, no matter to your computer multimedia , family entertainment or family cinema, our products will provide you with excellent quality in the music sea. We believe that we will be better with your wise choice. Before use this product Please read the instruction carefully , with you correct use of this product . A good performance will be make for the products, and can avoid unnecessary loss.

Product Overview

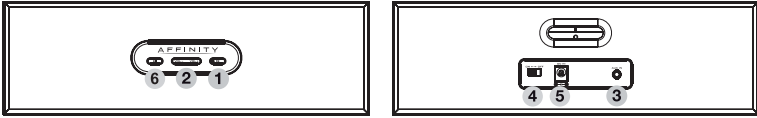

1 CONNECT Button / LED status indicator

LED Status	Speaker Status
Lit steady	Idle (Powered ON, not connected to <i>Bluetooth</i> device)
LED rapid blinking	Pairing mode
LED blinks every 2 second	Connected to <i>Bluetooth</i> device

2 Volume Down / Up
3 AUX IN
4 Power ON / OFF switch
5 DC IN
6 Pause(short press is pause, long press is play)

1

AFFINITY

Bluetooth
BLUETOOTH SPEAKER SYSTEM

FAQ (Frequently Asked Questions)

Perform the following trouble-shooting steps before sending it for servicing. For more information, please refer to www.kcpi.us.

The SBX400 cannot be powered on. What should I do?

Make sure that the DC cord is firmly connected to the unit and that the power outlet is turned on. Ensure that the Power ON / OFF Switch is in the ON position. When the speaker is powered ON, the LED StatusIndicator will be lighted up.

There's no *Bluetooth* link between my device and the SBX400. What should I do?

Ensure that your *Bluetooth* enabled device supports A2DP profile. Refer to its user's manual on how to enable (turn on) the *Bluetooth* functions and capabilities.

You may also try the following:

- Delete the SBX400 name entry from your *Bluetooth* device paired memory list and perform the steps in Section 2 (Enjoying audio from *Bluetooth* devices) to re-pair your device with SBX400.

- Ensure that both your *Bluetooth* device and SBX400 are not connected to any other devices
- On some *Bluetooth* device, you may need to select SBX400 as your default output device after pairing is complete**

***Bluetooth* link is established and paired between the devices but there's no music.**

What should I do?

** With some built-in *Bluetooth* enabled computers, 3rd party USB *Bluetooth* dongles or other devices, you may be required to manually specify/set-up the audio output as _SBX400_ (eg, under sound and audio devices section on your computer's settings) Please consult your manufacturer's documentation for further information .

6

AFFINITY

Bluetooth
BLUETOOTH SPEAKER SYSTEM

Safety Instructions

Please read the following before using the SBX400:

To be completely disconnected from the power input, the mains plug has to be disconnected /detached from the mains.

Disconnect the mains plug when the device is expected to be unused for several days.

Additional guidelines for *Bluetooth* devices

The short wave radio frequency signals of a *Bluetooth* device may impair the operation of other electronic and medical devices.

Switch off the device where it is prohibited. Do not use the device in medical facilities, aircraft, refueling points, close to automatic doors, automatic fire alarms or other automatically controlled devices.

Keep this device at least 20 cm from pacemakers and other medical devices. Radio waves may impair the operation of pacemakers and other medical devices.

Technical Specifications

Bluetooth Version:
Bluetooth 2.1+ EDR (Enhanced Data Rate)
Supported Frequency: 2402 ~ 2480 MHz
Supported Bluetooth profiles*:
A2DP (Wireless Stereo Bluetooth)
AVRCP (Bluetooth Remote Control)

Supported Codec:
SBC
Operating Range:
Up to 10 meters, measured in open space.
Walls and structures may affect range of device.

* Refer to your *Bluetooth* device (notebook¹, PC¹, or mobile device²) manufacturer's documentation /website for supported profiles.

¹ Compatible with PC (Windows XP/Vista/7), Apple Macintoshes equipped with *Bluetooth* wireless stereo
² Compatible with most major brands of *Bluetooth* A2DP enabled mobile phones

Compatibility Disclaimer
Wireless performance is dependent on your device's *Bluetooth* wireless technology. Refer to your device manufacturer's manual. Affinity will not be liable for any lost of data or leakages resulting from the use of these devices.

Note: Rating information and other markings are located on the bottom of this product.

5

AFFINITY

Bluetooth
BLUETOOTH SPEAKER SYSTEM

Product Overview

2. Enjoy audio from *Bluetooth* devices

a. Powering Up the speaker

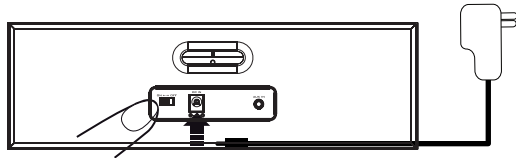

Attach the DC cord to the DC IN and flick the Power switch to ON position

b. Establish *Bluetooth* Connection

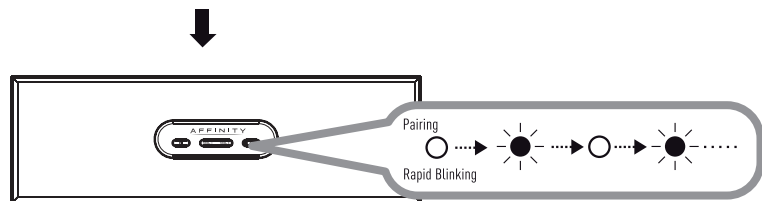
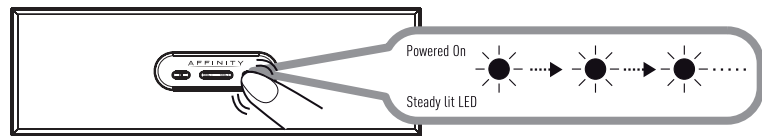

The LED status indicator will lit steady indicating the speaker is currently ON. To allow pairing to other *Bluetooth* devices, **Press and Hold the CONNECT button for 3 seconds**.Release when 2 beep tones are heard with the LED status indicator blinking rapidly.

2

AFFINITY

Bluetooth
BLUETOOTH SPEAKER SYSTEM

Product Overview

c. On *Bluetooth* device

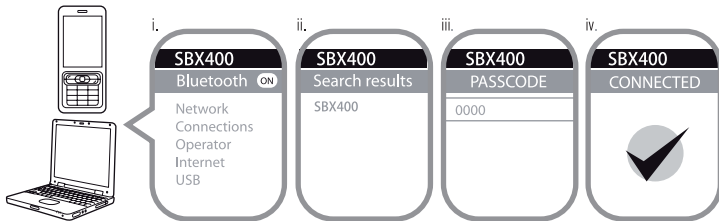

i. Turn ON the *Bluetooth* feature on your device. ii. Search for SBX400
iii. Pair and connect to SBX400. If prompted for passcode, enter 0000.

Note: The above are generic steps to pair to a *Bluetooth* device, for more specific instructions on *Bluetooth* connectivity for your device, please consult your manufacturer's manual.

d. Ready to stream music via *Bluetooth*

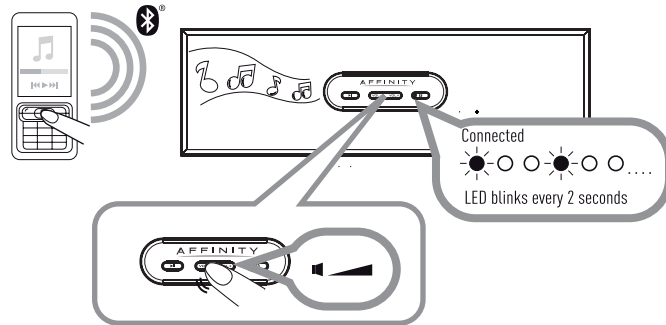

Press the Volume DOWN / UP buttons to adjust volume. Beep tones will be heard when Volume Maximum or Minimum is reached.

3

AFFINITY

Bluetooth
BLUETOOTH SPEAKER SYSTEM

Product Overview

3. Reconnections between *Bluetooth* device and SBX400

You can reconnect your paired *Bluetooth* device to your speaker easily.

Select 'SBX400' entry on the *Bluetooth* device to reconnect
Any of the 8 previously connected *Bluetooth* devices would be able to re-connect to SBX400 when the SBX400 is powered ON and not connected to any device.

Note : The SBX400 is able to remember up to 8 paired devices in its memory bank, eliminating the need to re-pair again should any of these devices connect to the SBX400. Should a 9th device be paired to the SBX400, the 1st device will be erased from the SBX400's memory banks. At any one time a maximum memory of 8 devices are being retained.

4. Toggle between last two connected *Bluetooth* devices

You can toggle between devices to enjoy your favorite music from another paired *Bluetooth* device by following these steps to establish connection.

Actions Press CONNECT button once
Indicators LED status indicator goes off and blinks at every 2 second interval
Status Ready to stream music

Note: Ensure your next paired device's *Bluetooth* feature is ON and ready to accept connections.

5. Return to default setting

You can return the SBX400 to default settings and erase its memory of paired devices by following these steps.

Actions Press and hold the CONNECT button for 8 seconds while the speaker is ON
Indicators A long beep tone is heard, LED Status Indicator blinks rapidly
Status Memory cleared. Speaker is in pairing mode, Ready to accept connection from other *Bluetooth* devices

6. Playback with other audio devices via AUX IN

Note: The AUX-IN has a fixed volume. To increase the volume on the AUX-IN, adjust the volume control from the source device.

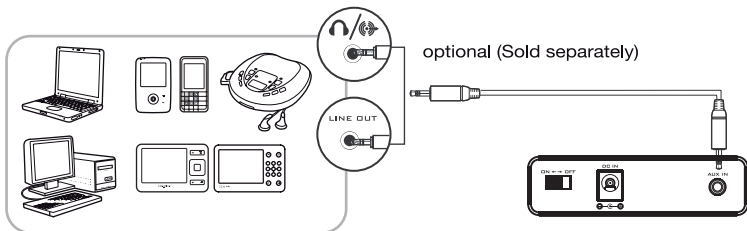

4