

D

C

B

A

4

3

8300-575-BLE rev A - Approved Jul 30, 2024 2:20:10 PM

2

1

8300-575-BLE rev A Rev# A ECO# 93977 - Approved Aug 05, 2024 12:57:36 PM

REV	ECO ECR	REVISION	APRVD. BY	DATE
A	93977	INITIAL RELEASE	MRD	05-09-2024
APPROVAL SIGNATURES ON FILE				

ITEM	PART NO.	REV.	DESCRIPTION	QTY.
1	6200-090	B	BATTERY "AA"	4
2	8300-059-920	A	FCC LABEL: ES10	1
3	8300-570-910	A	PCBA: ES10 MODULE	1
4	8300-574-XXX	B	MODULE SUB-ASSY: ES10	1

ASSEMBLY NAME	ITEM #4: SUB-ASSEMBLY
8300-575-BLE	8300-574-BLK

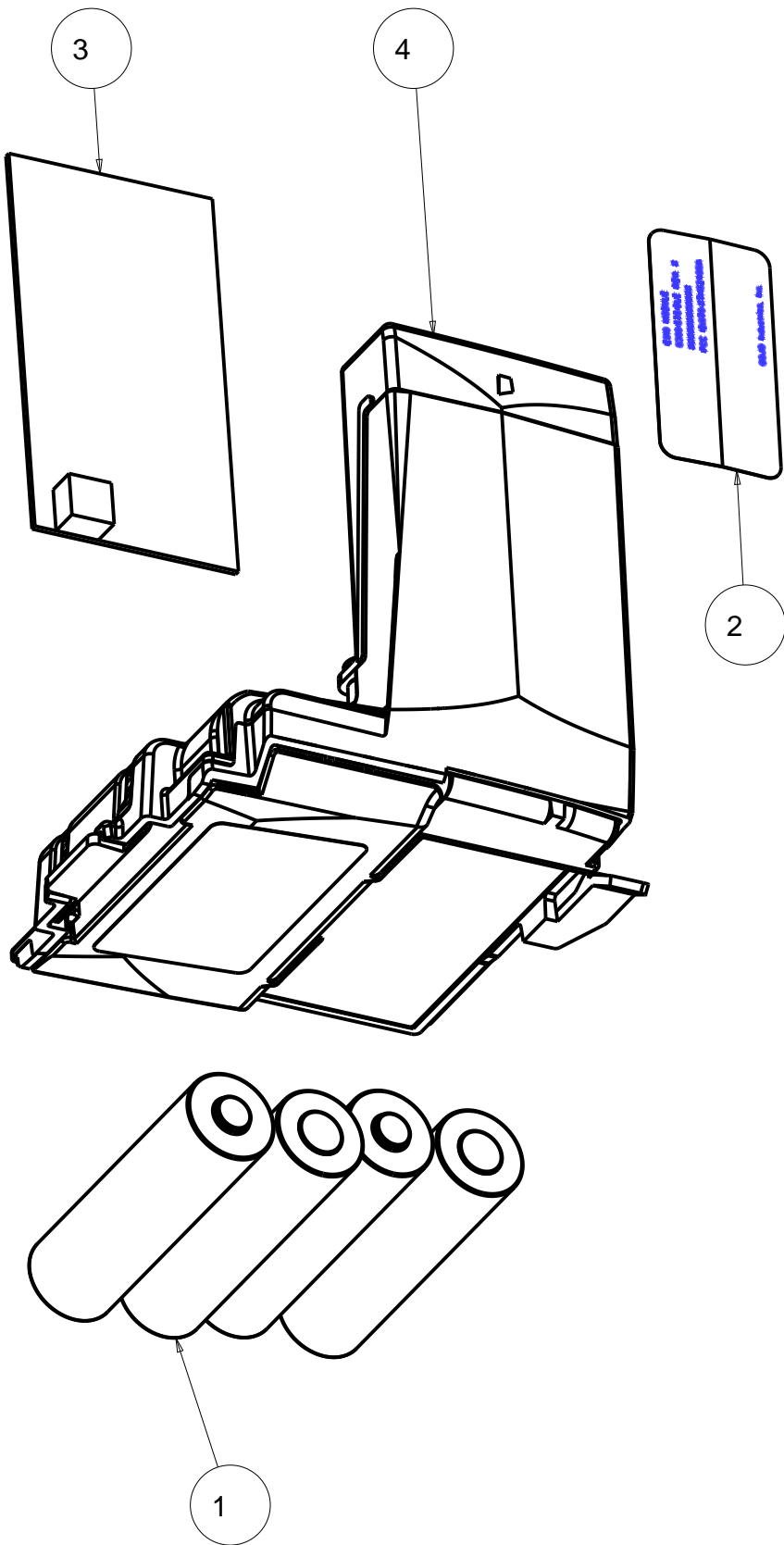

SCALE 1:1

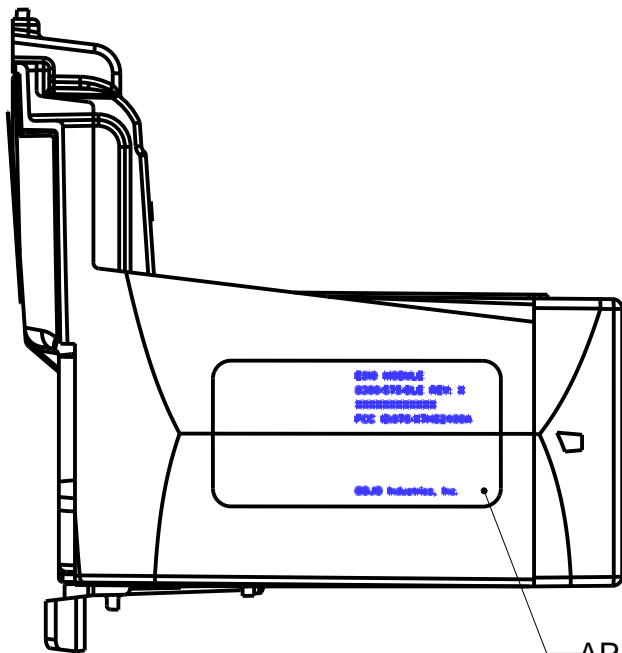
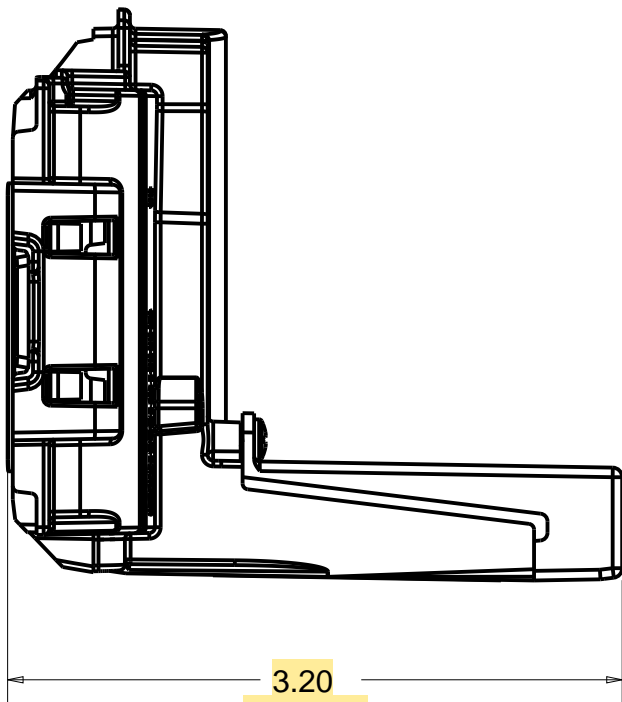

APPROXIMATE  
LOCATION OF  
LABEL

SCALE 1:1

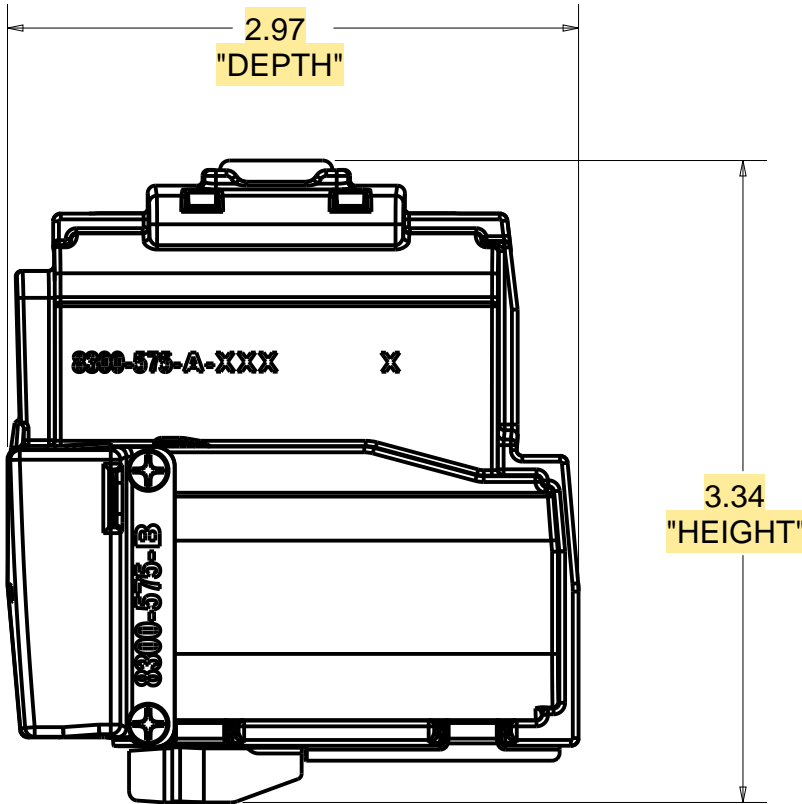

- NOTES:
- PART TO BE FREE OF DIRT, GREASE, OIL OR ANY FOREIGN MATERIAL.
  - CRITICAL TO QUALITY CHECK:
  - ELECTRICAL ASSEMBLY MUST CONFORM WITH IPC-A-610 CLASS 2
  - FOLLOW ESD ASSOCIATION STANDARD ANSI/ESD S6.1 FOR GROUNDING DURING ALL ASSEMBLY STEPS.
  - ALL ESD SENSITIVE COMPONENTS AND PRINTED CIRCUIT BOARDS MUST BE STORED AND TRANSPORTED IN ESD SAFE PACKAGING.
  - WEIGHT: 143 GRAMS

Component Specification - MISC. ASSEMBLY	
SPECIFICATION PROPERTIES	
Additional Information:	REFER TO SUB-COMPONENT/SPECIFICATIONS
TSQ Reviewer:	PWB 05-13-2024

INTERPRET DRAWING PER ASME Y14.100 UNLESS OTHERWISE SPECIFIED DIMENSIONS ARE IN INCHES	
THIRD ANGLE PROJECTION	

TITLE:		MODULE ASSY: BLE ES10			
STATE:		Released			
CONFIDENTIAL ©2024 GOJO Industries, Inc. All Rights Reserved.					
TOLERANCES:		THIS DRAWING IS THE PROPERTY OF GOJO INDUSTRIES, INC. ONE GOJO PLAZA, SUITE 500 AKRON, OH 44311 AND IS LOANED UPON CONDITION THAT IT IS NOT TO BE REPRODUCED OR COPIED IN WHOLE OR PART, OR USED FOR FURNISHING INFORMATION TO OTHERS OR FOR ANY OTHER PURPOSE DETRIMENTAL TO THE INTEREST OF GOJO INDUSTRIES, INC. AND WILL BE RETURNED UPON REQUEST			
DECIMALS: X.X ± 0.1 .X.XX ± 0.01 .X.XXX ± 0.005		DRAWN BY: M.DEGIDIO		SCALE 11:32	SHEET
FRACTIONS: X/XX ± 1/32		DATE: 05/06/24		DO NOT SCALE	1 of 2
ANGLES: X.X ± 0.5 X.XX ± 0.50		CHKD BY: M.BULLOCK	SIZE	DWG. NO.	REV.
		DATE: 05/09/24	C	8300-575-BLE	A

STEP 2.1

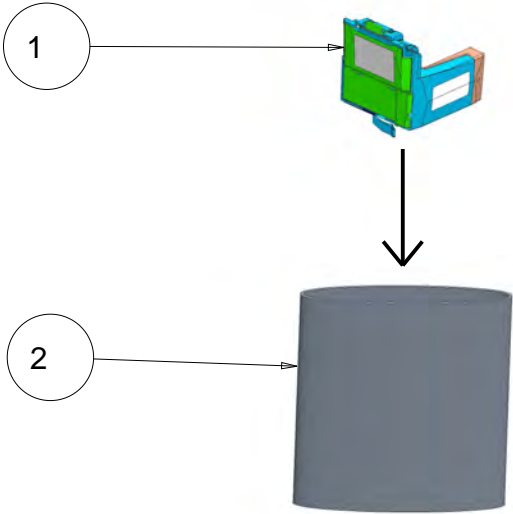

STEP 2.2 - 2.5

Polybags not shown for clarity

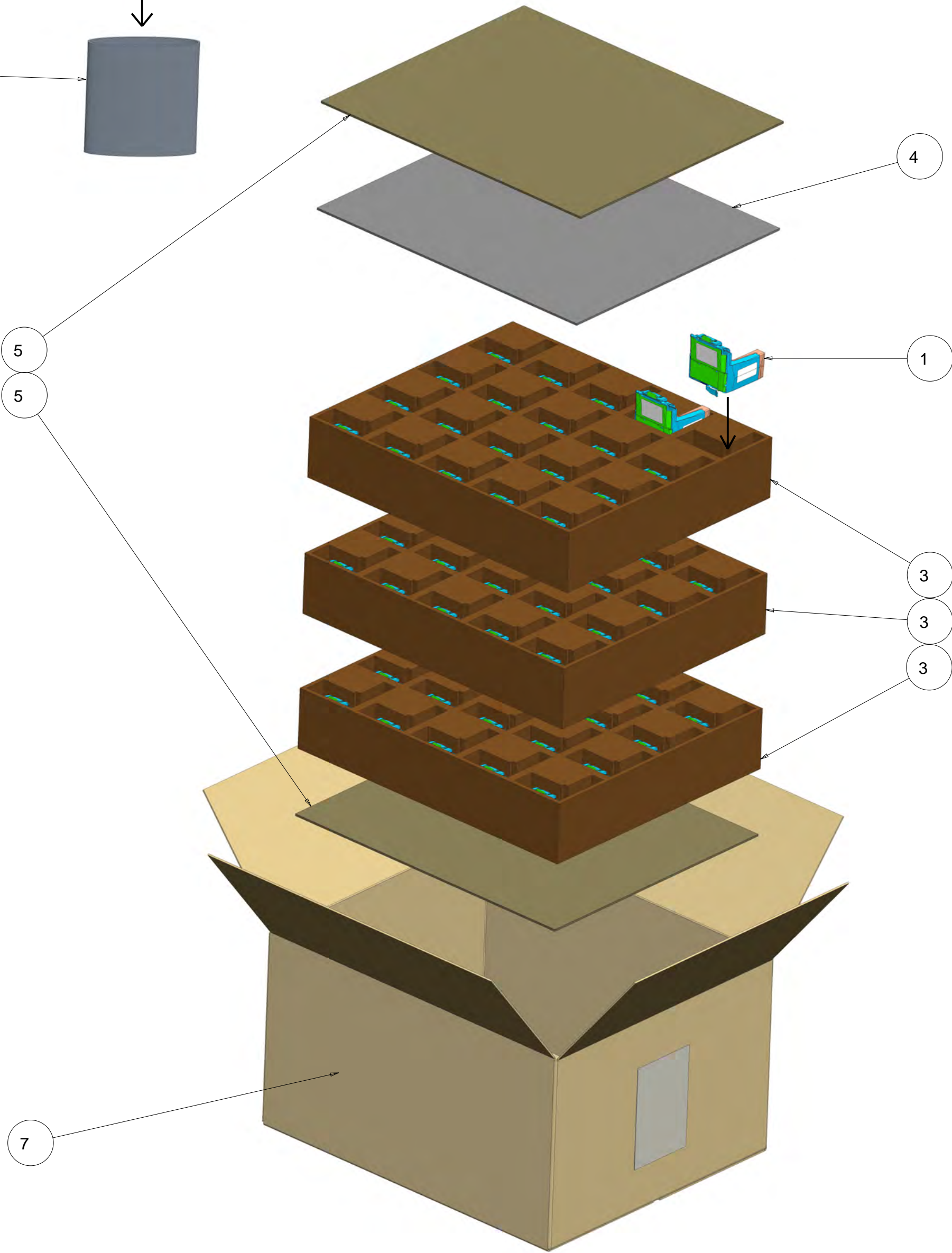

STEP 2.6 - 2.8

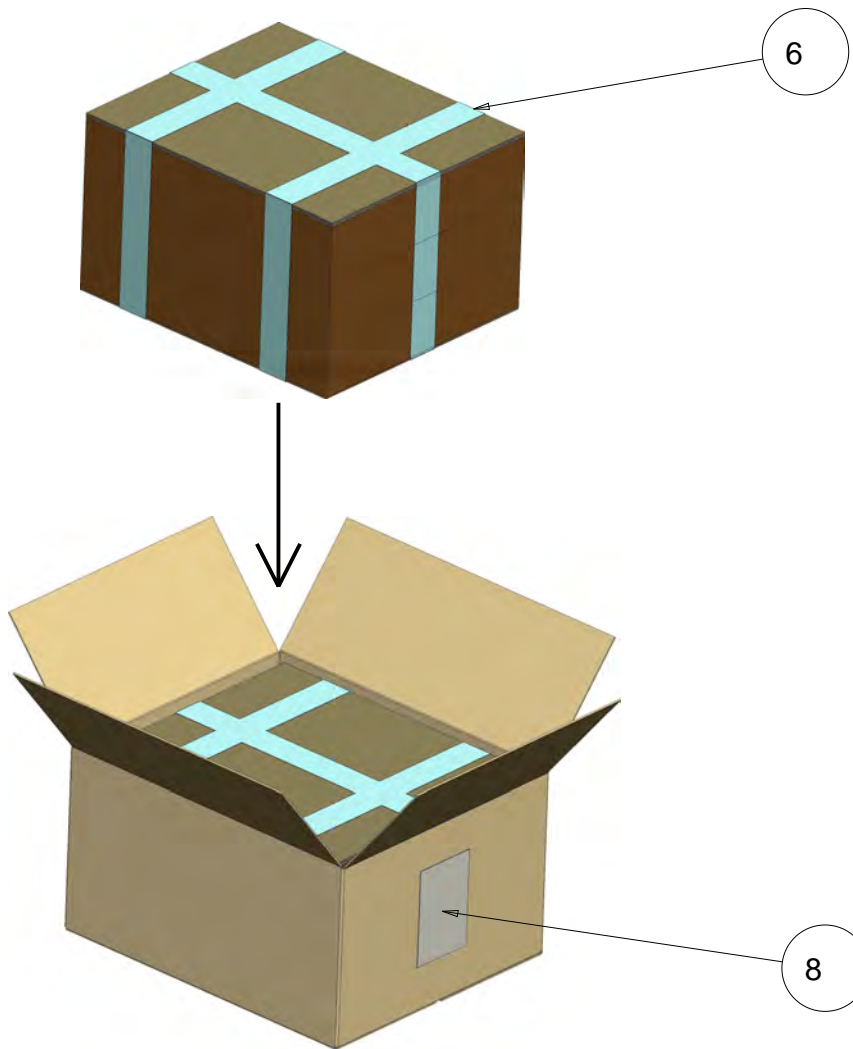

ITEM	DESCRIPTION	QTY.
1	8300-575-BLE (SEA0300)	60
2	(Vendor Supplied) PolyBag	60
3	(Vendor Supplied) EPE Insert	3
4	(Vendor Supplied) Flat EPE Pad	1
5	(Vendor Supplied) Cardboard Pad	2
6	(Vendor Supplied) Clear Tape (403-00061)	3m
7	(Vendor Supplied) Shipper 515x426x282mm	1
8	(Vendor Supplied) MH Shipping Label (840-00456)	2

1. BEFORE ASSEMBLY:
- 1.1. Production area must be clean of all foreign material and suspect components.  
All personnel must be trained to handle GOJO product.
2. ASSEMBLY INSTRUCTIONS:
- 2.1. Place 20 Module assemblies into 20 Polybags.  
2.2. Place the bagged assemblies into each cell of the EPE Insert.  
2.3. Repeat 2.1 to 2.2 two more times for a total of 3 Inserts.  
2.4. Place a EPE Pad on top of the upper EPE Insert.  
2.5. Place 1 Cardboard Pad on the bottom and 1 Cardboard Pad on the top as shown.  
2.6. Seal the Insert stack with clear tape as shown.  
2.7. Erect the shipper.  
2.8. Place the Taped Insert stack into the shipper.  
2.9. Close the shipper in compliance with National Motor Freight Classification.  
2.10. Label the Shipper as shown.  
2.11. Code the shipper on one side using the following format:

(L)SCXXXXXX YDDD

WHERE: SC = SUPPLIER CODE.  
XXXXXX = DIGITS AND/OR CHARACTERS MAY VARY AND ARE TO HAVE A UNIQUE IDENTIFIER THAT PROVIDES COMPLETE MANUFACTURING HISTORY.  
YDDD = LAST DIGIT OF YEAR AND JULIAN DATE OF MANUFACTURE (IF APPLICABLE).

3. PALLET ASSEMBLY (Only one lot of product may be placed on a pallet):
- 3.1. Palletize the cases on the pallet using a consistent pallet pattern.  
3.2. Apply stretch wrap and label to the pallet load.

# GOJO Industries

## eSignatures

The signatures certify that this document is adequate to fulfill its intended purpose or requirement.



UserName: Tory Thomas (gojo-net\thomast)

Title:

Date: Monday, 05 August 2024, 12:07 PM Eastern Daylight Time

Meaning: QA Reviewer's Approval

=====