

8

7

6

5

4

3

2

1

REVISIONS			
ZONE	REV	DESCRIPTION	DATE
			APPROVED

- NOTES:
1. THE BUILD NUMBER PRINTED ON ITEM 20 MUST MATCH THE NUMBER LISTED ON THE MO (MANUFACTURING ORDER) INSTRUCTIONS. THE LABEL PRODUCED FOR ITEM 20 CONTAINS SIX LABELS. CUT ONE LABEL OUT AND ADHERE TO THE ASSEMBLY THE LOCATION INDICATED.
 2. THE WASHER AND NUT ARE PROVIDED WITH THE RF CONNECTORS LOCATED ON THE PWA'S ITEMS 13 AND 14.
 3. FIRMWARE LISTED AS ITEM 19 ON THE PARTS LIST IS TO BE LOADED ONTO THE SYSTEM USING PROCEDURE 10P-0011 REV. C.
 4. THE WASHER AND NUT ARE PROVIDED WITH THE POWER CONNECTOR LOCATED ON THE DIGITAL PWA ITEM 14.
 5. THE FLAT WASHER AND LOCKWASHER ARE PROVIDED WITH THE JACK SCREW KIT ITEM 27.

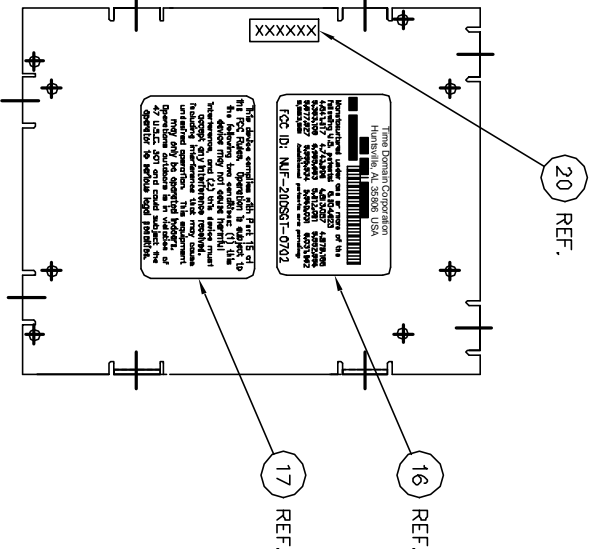
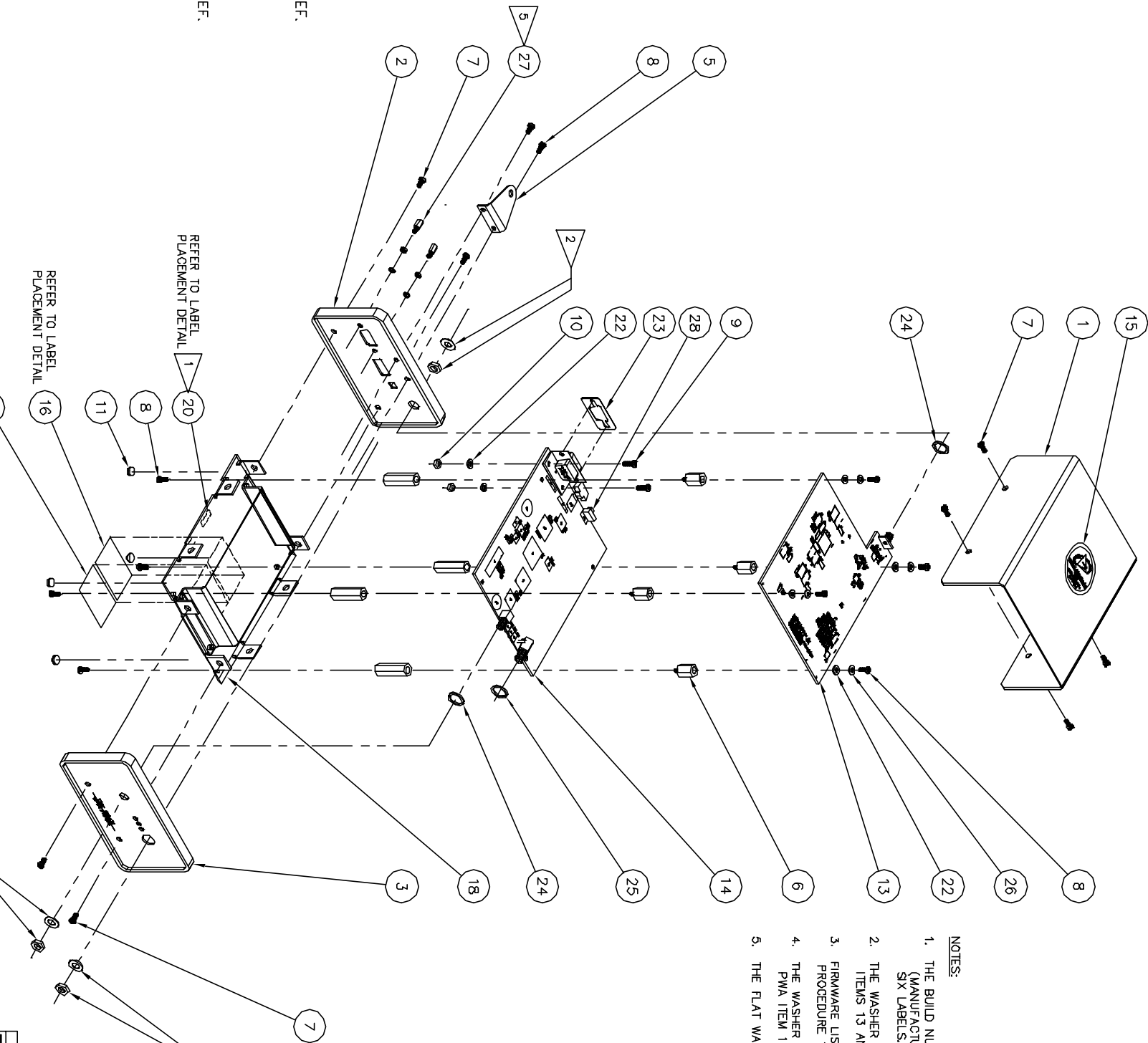

LABEL PLACEMENT DETAIL
PLACE PRODUCT ID LABEL (ITEM 16), THE
FCC NOTICE LABEL (ITEM 17), AND THE
BUILD ID LABEL (ITEM 20) IN THE
APPROXIMATE LOCATIONS SHOWN.

APPROVALS		DATE	TIME DOMAIN CORPORATION	
J.ROBINSON		02-01-02	UNIT ASSEMBLY, SIGNAL GENERATOR TAG	
DO NOT SCALE DRAWING			THE PULSE OF THE FUTURE [®]	
10A-0011C SIGNAL GEN. TAG DWG			Huntsville, AL	
D1			10A-0011	
COMPONENT PART NO.			100-0011	
SHEET 1			OF 1	
REV C				