

# ***Sovereign***<sup>®</sup>

Tracking Systems L.L.C.

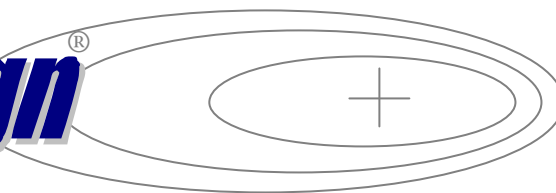

PalTrack

***ATS3-A/B***

Operational Manual

## **PalTrack**

### **ATS3-A/B**

# **Transmitter**

**ATS3-A/B unit Installation and Operational Instructions**

Activation

### **Asset Tracking System III (A/B)**

The ATS3 designed by Sovereign Tracking System LLC. provides a very affordable and accurate tracking system for locating and position asset and product within localized facilities. The attachment of the ATS3 unit to an asset or product is performed in the following steps:

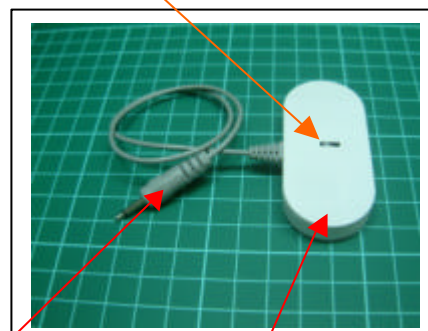

ATS3-B  
Shown

Adhesive

1. Open the packaging and remove the ATS3 transmitter.
2. Attach the ATS3 to an asset or product by orienting the transmitter assembly to the asset or product so that the adhesive side of the transmitter is facing towards object.
3. Remove the protective adhesive paper from the ATS3 transmitter.
4. Orient the ATS3 to the desired location on the asset or product, and press the ATS3 FIRMLY to the asset or product.
5. DO NOT TRY TO RELOCATE OR REMOVE THE ATS3 FROM THE ATTACHED ITEM.
6. IF THE ATS3 IS REMOVED FROM THE Asset, it will be set to alarm mode.
7. Once the ATS3 is secured to an asset or product, verify operation of the system by moving the ATS3 transmitter either up or down, or side to side, and verify the data on the computer. For details on computer operation, reference PalTrack installation manual.



### **ATS3-A Configuration:**

The ATS3-A is the base configuration transmitter with out data input capability. This configuration provides normal operation under motion and emergency transmit notification when the transmitter is removed form an asset or object once affixed and activated.

### **ATS3-B Configuration:**

The ATS3-B provides a configuration whereby external data input can be detected from an asset or object. This data input feature allows for a transistor to transistor (TTL) logic input e.g. "0" or "1". The logic input voltage is either zero "0" Vdc for logic "0" or a maximum of 5.5Vdc for a logic "1". The status of this logic is transmitter as a status bit during normal or emergence transmit modes.

The data input in accomplished through the use of a "Mini Phone" plug. The outer shell of the mini phone plug is ground with the center tip at a positive potential of no more than 5.5Vdc. For details on computer operation, reference PalTrack installation manual.

Notice: The changes or modifications not expressly by the party responsible for compliance could void the user's authority to operate the equipment.

Model: ATS3-(A/B)

FCC ID: N8TSOV333

THIS DEVICE COMPLIES WITH PART 15 OF THE FCC RULES.

OPERATION IS SUBJECT TO THE FOLLOWING TWO CONDITIONS:

(1) THIS DEVICE MAY NOT CAUSE HARMFUL INTERFERENCE AND (2)

THIS DEVICE MUST ACCEPT ANY INTERFERENCE RECEIVED, INCLUDING INTERFERENCE THAT MAY CAUSE UNDESIRE OPERATION.

MADE IN TAIWAN