

One (1) Year Limited Warranty

Dorel Juvenile Group, Inc. warrants to the original purchaser that this TrustView™ Handheld Digital Color Video Monitor, is free from material and workmanship defects when used under normal conditions for a period of one (1) year from the date of purchase. Should the product contain defects in material or workmanship Dorel Juvenile Group, Inc., will repair or replace the product, at our option, free of charge. Purchaser will be responsible for all costs associated with packaging and shipping the product to Dorel Juvenile Group Consumer Relations Department at the address noted below and all other freight or insurance costs associated with the return. Dorel Juvenile Group will bear the cost of shipping the repaired or replaced product to the purchaser. Product should be returned in its original package accompanied by a proof of purchase, either a sales receipt or other proof that the product is within the warranty period. This warranty is void if the owner repairs or modifies the product or the product has been damaged as a result of misuse.

This warranty excludes any liability other than that express stated previously, including but not limited to, and incidental or consequential damages.

SOME STATES OR PROVINCES DO NOT ALLOW THE EXCLUSION OR LIMITATION OF INCIDENTAL OR CONSEQUENTIAL DAMAGES, SO THE ABOVE LIMITATION OR EXCLUSION MAY NOT APPLY TO YOU.

THIS WARRANTY GIVES YOU SPECIFIC LEGAL RIGHTS, AND YOU MAY ALSO HAVE OTHER RIGHTS THAT MAY VARY FROM STATE TO STATE OR PROVINCE TO PROVINCE.

Thank you again for purchasing a Safety 1st product. We are not only about safety, we're also about your satisfaction. If you have any questions or comments, please call our Consumer Relations department at 1-800-544-1108 or e-mail us at consumer@safety1st.com.

TrustView™ Handheld Digital Color Video Monitor Birth & Up

model: MO072R/ MO080VR



Thank you for purchasing a Safety 1st product. We are not only about safety, we're also about your satisfaction. If you have any questions or comments, please call our Consumer Relations department at 1-800-544-1108 or e-mail us at consumer@safety1st.com

Please read the following instructions and warnings carefully.
Keep these instructions for future reference.
Tool needed: Flathead Screwdriver (not included)

©2012 Cosco Management, Inc. All Rights Reserved. Tous droits réservés.
www.djgusa.com (800) 544-1108 www.safety1st.com Fabriqué en CHINE.
Hecho en CHINA. Styles and colors may vary. Les styles et les couleurs peuvent varier.
Distributed by (distribué par) Dorel Juvenile Group, Inc., 2525 State St., Columbus,
IN 47201-7494 Dorel Distribution
Canada, 873 Hodge, St. Laurent,
QC H4N 2B1



Register for our eNewsletter and watch our experts on Safety 1st TV

4/10/12
4358-5930

WARNING!

Strangulation Hazard - Children have STRANGLED in cords. Keep cords out of reach of children more than 3 feet (0.9 m) away.



⚠ WARNING!

For indoor use only. To reduce the risk of fire or electrical shock, do not expose this product to water or moisture. NEVER attempt to disassemble the product. This is dangerous and will void the warranty.

⚠ CAUTION!

This monitor is not intended to be used as a medical monitor and its use should not replace proper adult supervision. You should check your child's activity at regular intervals as this monitor will not alert parents to the silent activities of a child.

Important!

- Please read all warnings and assembly instructions carefully before using the video monitor. Parent Unit is a Receiver. Baby Unit is a Transmitter.
- Do not place units in crib or mount on crib. Keep out of reach of children.
- Check your child's activity at regular intervals, as this monitor will not alert parents to the silent activities of a child.
- To prevent entanglement with the adapter cord, NEVER PLACE THE CORD IN OR NEAR A CRIB OR PLAYPEN. DO NOT place the Receiver anywhere its AC adapter cord is near children.
- ALWAYS KEEP TRANSMITTER, RECEIVER AND AC ADAPTERS OUT OF REACH OF CHILDREN
- This product is not a medical monitor and its use should not replace adult supervision.
- Check the reception regularly.
- NEVER use the Transmitter or Receiver near water. For example, do not use near a bath tub, bathroom sink, laundry tub, kitchen sink, in a wet basement, etc.
- Always unplug the AC adapters from wall outlets during long periods of non-use.
- Check to make sure outlet plates are not unusually hot to the touch. If they are, immediately unplug cords from these outlets. Check that all outlet connections are in good condition so that adapter is not loose or that no wiring is exposed. Have a qualified, licensed electrician check the wiring as soon as possible.
- Position the Transmitter, Receiver and AC adapters to allow adequate ventilation and prevent these components from overheating.
- To prevent overheating, keep the Transmitter, Receiver and AC adapters away from heat sources such as radiators, heat registers, stoves or other appliances (including amplifiers) that produce heat. Also keep these components out of direct sunlight.
- Certain electronic devices are sensitive to magnetic fields and may be damaged permanently or temporarily disabled if exposed to a magnetic field that is too strong. Video screen will become distorted and/or discolored if exposed to a strong magnetic field.
- Use only the AC adapters provided. Use of any other adapters may damage the Transmitter and/or Receiver. Plug AC adapters into standard household current only! (120V AC) To prevent entanglement and overheating, DO NOT use extension cords.
- The AC adapters may become slightly warm to the touch during operation. This is normal.
- Position the AC adapter cords so that they are not walked on or pinched by items placed upon or against them, paying particular attention to cords at AC adapter plugs, wall plugs and the point where the cords attach to the Transmitter and Receiver.
- To remove AC adapter from the outlet, firmly grasp the adapter "brick." DO NOT pull on the cord, as this could damage it.
- The LEDs emit IR (infra red) light that is not harmful.
- This product should be serviced only by qualified service personnel at Dorel Juvenile Group when:
 - An AC Adapter or its plug is damaged
 - The Transmitter or Receiver has fallen
 - Liquid has spilled into the Transmitter or Receiver, or
 - The Transmitter or Receiver do not appear to operate normally or exhibit a marked change in performance.
- DO NOT attempt to service this product beyond that described in the Troubleshooting section. All other servicing should be referred to qualified personnel at Dorel Juvenile Group.

Important Warnings 2
 Features & Components 4
 Installing & Charging Batteries 5
 Quick Start Guide 6 & 7

Using Your Monitor:

AC Adapter 8
 Parent Unit/Receiver
 • Volume Control 9
 • Sound Lights 9
 • Zoom Control 9
 • Brightness Control 9
 • Day/Night Auto Viewing 9
 • Video On/Off 10
 • Power Indicator 10
 • Link Indicator 10

Additional Parent Unit/Receiver - Audio Only

 • Volume Control 10
 • Sound Lights 10
 • Power Indicator 10
 • Link Indicator 10
 • Belt Clip & Carry Loop 11
 • Battery Charging 11
 • Low Battery 11

Baby Unit/Transmitter

 • Proper Positioning 11

Use & Care 12
 Safety Instructions 13
 Troubleshooting 14 & 15
 Warranty 16

Parent Unit/Receiver

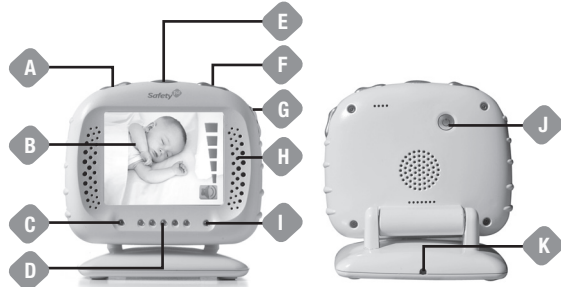

Parent Unit/Receiver (Audio Only)

Baby Unit/Transmitter

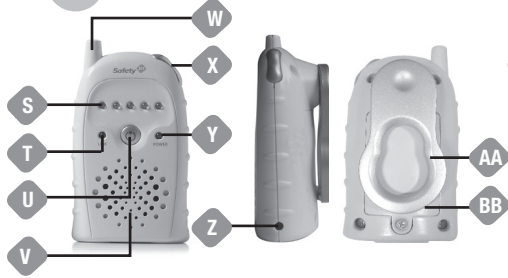
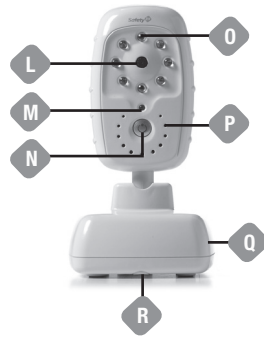

Parent Unit (Receiver)

- A Zoom Control Button
- B 3.5 inch Video Screen
- C Link Indicator
- D Sound Lights (5 LEDs)
- E Video On/Off Button
- F Brightness Control Button
- G Volume Control Button
- H Speaker
- I Power On Indicator
- J Power On/Off Button
- K AC Adapter Jack

Baby Unit (Transmitter)

- L Camera Lens
- M Power On Indicator
- N Power On/Off Button
- O Nighttime Viewing Lights
- P Microphone
- Q AC Adapter Jack (on back of unit)
- R Battery Compartment (4 AA batteries, not included)

Parent Unit (Audio only)

- S Sound Lights (5 LEDs)
- T Link Indicator
- U Power On/Off Button
- V Speaker
- W Antenna
- X Volume Control Button
- Y Power On/Low Battery Indicator
- Z AC Adapter Jack
- AA Belt Clip & Carry Loop
- BB Battery Compartment (for rechargeable battery)
- CC Rechargeable Battery Pack
- DD AC Adapter (3)

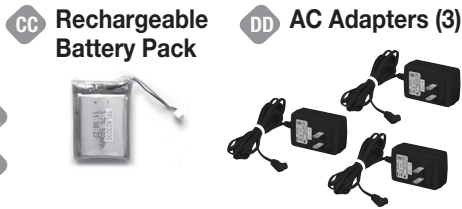

Battery Installation & Use:
(Rechargeable Battery for Parent Unit)

IMPORTANT:

Parent Unit will not operate unless rechargeable battery pack is installed first.

To maximize battery life, charge a new rechargeable battery pack in Parent Unit for 12+ hours before first use. You may operate Parent Unit with an AC adapter while charging batteries.



Tool Required:
Flathead Screwdriver

Component Required:
Rechargeable
Battery Pack

Figure 1



Figure 2



Figure 3



Figure 4

BATTERY INSTALLATION:

- Move belt clip out of way. Unscrew battery cover and remove from Parent Unit (Figure 1).
- Align connectors of the Parent Unit and rechargeable battery pack ((Figure 2).
- Plug together until you feel a click (Figure 3).
- Place rechargeable battery pack inside Parent Unit and tuck in the connected wires (Figure 4).
- Secure battery cover with its screw; ensure that no wires are pinched.

To order a new rechargeable battery pack, contact Consumer Relations at 1-800-544-1108. Use reference code number 08180.

CAUTION!



- **DO NOT** mix old and new batteries.
- **DO NOT** mix alkaline, standard (carbon zinc), or rechargeable (nickel-cadmium) batteries.
- Only batteries of the same or equivalent type as recommended are to be used.
- Exhausted batteries are to be removed from the unit.
- Keep batteries out of child's reach. Swallowing a battery could be fatal.
- Used batteries should be disposed of properly.
Do not dispose of batteries in fire - they may explode or leak and cause injury.
- Remove batteries when stored for long periods of non-use.
- **DO NOT** use monitor system in portable mode when batteries are low.
- Ensure that the battery compartment is completely secure after replacing batteries.



- Place Baby Unit at least 3 feet (0.9 m) away from your baby.
- To reduce audio feedback, position both Parent and Baby Unit far enough away from each other to avoid interference. Turning the volume down will help.
- This monitor has indoor/outdoor range. During use of the monitor, if the sound quality deteriorates, you may be reaching the limits of the monitor's range. If this happens, you will need to move Parent Unit closer to Baby Unit. You can verify by checking the Link Indicator icon displayed in the data display, (See page 10.)
- Adjust the volume to a comfortable level for your environment.
- Day/Night Auto Viewing lets you see the baby in a darkened room. The video display during this time is in black and white. For best view of your baby in a dark room, increase brightness control until desired brightness is achieved.
- Baby Unit can also be wall mounted. (See page 12.)

More Features, More Functions

Once you've set up your monitor and powered On, it's time to learn about the innovative parent convenience features your monitor has to offer. Keep reading to explore these many features:

- Zoom
- Video On/Off (to conserve battery life)
- Brightness Control
- Day/Night Auto Viewing

IMPORTANT:

Audio Parent Unit will not operate unless rechargeable battery pack is installed first.

To maximize battery life, charge a new rechargeable battery pack in Parent Unit for 12+ hours before first use. You may operate Parent Unit with an AC adapter while charging batteries.

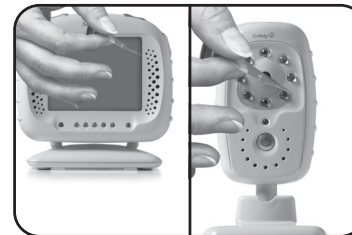

1 Remove protective clings from both Parent Unit and Baby Unit.

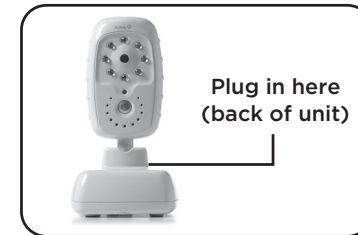

2 Connect AC adapter to the back of Baby Unit.

⚠ WARNING!
 Strangulation Hazard - Children have STRANGLED in cords. Keep cords out of reach of children more than 3 feet (0.9 m) away.

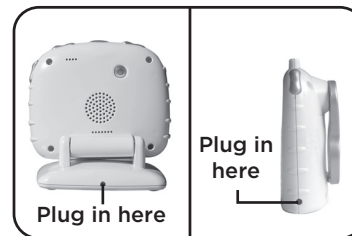

3 Connect AC adapter to the Parent Units (Video and Audio).



4 Plug Parent Unit and plug Baby Unit into wall to operate AC power.

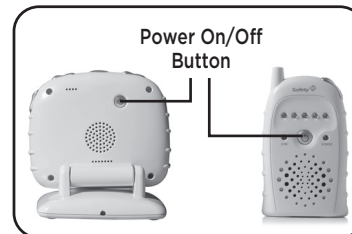

5 Hold down Power On/Off Button to turn Parent Units on (Video and Audio). To turn off Parent Units, hold down Power On/Off Button again.

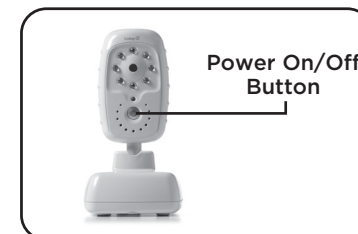

6 Hold down Power On/Off Button to turn Baby Unit on. To turn off Baby Unit, hold down Power On/Off Button again.

**DO NOT PLACE UNITS IN CRIB OR MOUNT ON CRIB.
KEEP OUT OF REACH OF CHILDREN.**

AC ADAPTER

The Parent Unit operates on household electricity with the AC Adapter and the Audio Parent Unit will operate on household electricity with the AC Adapter or with rechargeable battery pack (included). The Baby Unit operates on household electricity with the AC Adapter or with 4 AA batteries (not included). The Parent Unit will automatically convert to AC operation when used with the AC Adapter. It is not necessary to remove the battery during AC operation. The Audio Parent Unit will automatically switch back to battery power when plug is disconnected from the AC Adapter.

The AC Adapter should be used whenever possible on the Audio Parent Unit to save battery life. This is done by inserting the AC Adapter into the AC Adapter Jack. Then simply plug the AC Adapter into a nearby standard household outlet (120V AC outlet). The AC Adapters may become slightly warm to the touch during operation. This is normal.

This AC Adapter is a low voltage power source which allows you to use your household electricity to run the Baby and Parent Units when it connects to the AC Adapter Jack in the Parent Unit and in the Baby Unit, and plugs into any standard electrical outlet in your home.

To remove AC adapter from the outlet, firmly grasp the adapter "brick." DO NOT pull on the cord, as this could damage it.

CAUTION: This AC Adapter was made with a specific design for the Safety 1st Monitor. It cannot be used with any other appliance, and never use a different type of adapter with this Monitor.

Parent Unit (Video/Receiver):

VOLUME CONTROL BUTTON

Volume Control Button is on the right side of Parent Unit. To adjust volume, press up (+) or down (-). Volume bars will display on screen. No bars means Parent Unit is on mute.



SOUND LIGHTS (5 LEDs)

As baby's voice gets louder, the sound lights will illuminate from 1 light up to 5 lights. Low sound is one LED illuminated and rises incrementally as baby's noise level increases until all 5 LEDs are illuminated.

ZOOM CONTROL BUTTON (1x, 2x, 4x)

Zoom Control Button is the upper left button on the side of Parent Unit. There are 3 levels: Zoom 1x (normal view), 2x and 4x. To adjust zoom view, press up (+) or down (-). Zoom status will display on screen. If no zoom icon appears on screen, press once to check current zoom status and press twice to change zoom status.



BRIGHTNESS CONTROL BUTTON

Brightness Control Button is the upper right button on the side of Parent Unit. To adjust brightness level, press up (+) or down (-). Brightness level icons will display on screen. If no brightness icon appears on screen, press once to check current brightness status and press again to change brightness status.

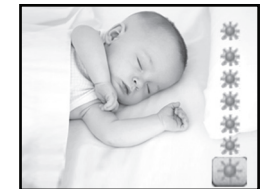

DAY/NIGHT AUTO VIEWING

Day/Night Auto Viewing lets you see your baby in a darkened room. The video display during this time is in black and white. For best view of your baby in a dark room, increase brightness control until desired brightness is achieved. For best visibility, Camera should be 3 feet away from your baby.

VIDEO ON/OFF BUTTON

Video ON/Off Button is on the top of Parent Unit. Press the Video On/Off Button to shut-off the video screen. The Video Off icon will appear. Press again to bring back full video.

POWER INDICATOR

The power indicator is a green LED that indicates that the unit is on and functioning.

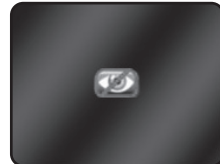
**LINK INDICATOR - OUT OF RANGE**

If the unit is working and goes out of range, the no-link icon will appear and the link indicator LED will illuminate red. If product is detected as close to losing link, where signal quality is losing over 50% of its information, monitor will keep giving image, but link indicator LED will flash red indicating that loss of link is possible.

**Additional Parent Unit - Audio Only (Receiver):****VOLUME CONTROL BUTTON**

Volume can be easily adjusted to any desired listening level by pressing the Volume Control Button, so you can be sure to hear your baby at all times. Volume Control Button is on the top right side of Parent Unit. To adjust volume, press up (+) or down (-). The sounds are transmitted through the wide range speaker. It is essential to check reception regularly. Refer to Use and Care section.

SOUND LIGHTS (5 LEDs)

As baby's voice gets louder, the sound lights will illuminate from 1 light up to 5 lights. Low sound is one LED illuminated and rises incrementally as baby's noise level increases until all 5 LEDs are illuminated.

POWER INDICATOR

The power indicator is a green LED that indicates that the unit is on and functioning. If LED turns red, this is a low battery indication.

LINK INDICATOR - OUT OF RANGE

If the unit is working and goes out of range, the link indicator red LED will illuminate.

BELT CLIP & CARRY LOOP

The Belt Clip is convenient for portability. You can clip the Parent Unit to your belt or waistband. The Belt Clip also easily converts to a carry loop.

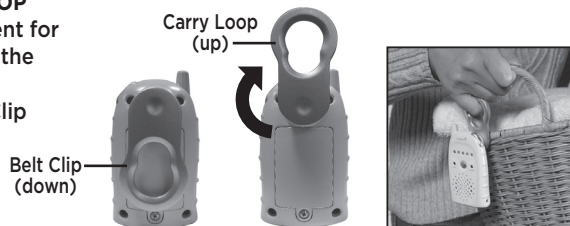
**Additional Parent Unit - Audio Only (Receiver):****BATTERY CHARGING**

IMPORTANT: Parent Unit will not operate unless rechargeable battery pack is installed first. To maximize battery life, charge a new rechargeable battery pack in Parent Unit for 12+ hours before first use. You may operate Parent Unit with an AC adapter while charging batteries.

LOW BATTERY

With power on and unit operating on battery power, a green LED will be lit. When the LED turns to red, it indicates that the battery is dying. You need to plug in the Audio Parent Unit within 5 to 10 minutes after red battery LED appears or battery power will fail.

WHAT TO EXPECT FROM BATTERY LIFE

A Fully charged battery being used with both video and audio typically lasts approximately 6 hours. During the last 5 minutes, the large flashing red battery will start flashing. You need to plug in the Parent Unit within 5 to 10 minutes after red battery starts to flash or battery power will fail.

Rechargeable batteries are prone to what is referred to as the "memory effect". What this means is that if a battery is repeatedly only partially discharged before recharging, the battery "forgets" that it has the capacity to further discharge all the way down. To illustrate: If on a regular basis you fully charge your battery and then use only 50% of its capacity before the next recharge, eventually the battery will become unaware of its extra 50% capacity which has remained unused. The battery will remain functional, but only at 50% of its original capacity.

The way to avoid the "memory effect" is to fully cycle (fully charge and then fully discharge) the battery at least once every two to three months. Simply leaving the device in the ON position and letting it run can discharge batteries completely. This will help insure your battery remains healthy. Once discharged, recharge the battery completely according to the manufacturer's instructions.

Baby Unit (Transmitter):**PROPER POSITIONING**

IMPORTANT: When choosing locations to set up the Baby Unit and Parent Unit, follow these guidelines:

- For best sound quality, place Baby Unit 3 feet (0.9 m) away from the baby.
- Adjust volume dial on Parent Unit to appropriate level to minimize feedback.
- During use of the monitor, sound quality deteriorates as you reach the limits of the monitor's range. If this happens, you will need to move the Parent Unit in closer proximity to the Baby Unit.

IMPORTANT - CHECK RECEPTION:

The first time you use your monitoring system, two adults should test it in the following way:

- Place Parent Unit at least 20' (6m) away from Baby Unit.
- Have an adult speak into Baby Unit at various levels (soft to loud) while another adult checks Parent Unit for the proper sound and picture reception. Try Parent Unit in every location that it will be used.

Wall Mounting the Camera

Mounting the Baby Unit on a wall is similar to mounting a picture.

1. Make 1 mark in your desired location on the wall. Make certain location is close to power source and any wiring is not accessible by children.
2. Install 1 screw (5/16" head) in the wall where you made the mark.
3. Carefully place base of Baby Unit on screw and gently slide to the left until Baby Unit is securely in place. Confirm attachment to wall before letting go of Baby Unit.
4. Plug in AC adapter. Ensure all wiring is properly positioned to avoid all contact and/or accessibility by children. Recommend battery power use if cable poses possible hazard.



Use for
Wall Mount

Care and Cleaning

Use a soft, dry cloth to keep your monitor free from dust.

DO NOT immerse product in water.

Cleaning Camera Lens:

1. With a soft brush, such as a clean makeup brush, carefully brush away any dust and dirt particles that may be on your Camera lens. Do not skip this step as a small bit of sand or dirt left behind could scratch your lens in the next steps.
2. Take a cotton swab and lightly moisten it with clean water. Carefully swab around the inside edges of your lens.
3. With a dry portion of a lens cloth or soft non-abrasive tissue, buff the lens in a circular motion to dry.

Helpful Hints

Use household electricity whenever possible. When the AC Adapter is used with your household electricity, you will find that the power is stronger and more consistent than when you rely solely on the battery. Range and sound quality also depends on the construction of your house. Steel reinforced wall, for example, reduces the effective range of the monitor. Conserve the battery so you will have power when you don't have easy access to AC outlets.

When not using the Unit, remove AC Adapter and be sure the power button is "OFF".

When you are not using the AC Adapter, remove it from the Unit and store it in a safe, dry place until you need it again. If the AC Adapter is plugged into the Parent Unit but not being used in an electrical outlet, the AC Adapter will prevent battery operation of the Unit.

When using the AC Adapter with household electricity, make sure the outlet is "ON".

Some electrical outlets are powered through a switch in the room. If the Baby Unit is plugged in and turned "ON", the power indicator light should be lit. If it is not, try turning the light switch in the room "ON".

It is essential to check reception regularly. Please see Using Your Monitor section.

VENTILATION: The Monitor should not be situated on a bed, sofa, rug, or similar surface that may block the ventilation openings, or placed in an enclosed installation, such as a book case or cabinet that may impede the flow of air through the ventilation openings.

- Position the Transmitter, Receiver and AC adapters to allow adequate ventilation and prevent these components from overheating.

HEAT: The Monitor should be situated away from heat sources such as radiators, heat registers, stoves, or other appliances that produce heat. Also keep these components out of direct sunlight.

POWER SOURCE: The Monitor should be connected to a power supply only of the type described in these operating instructions.

POWER CORD PROTECTION: The power supply cord should be routed so that it is not likely to be walked on or pinched by items placed upon or against it. Pay particular attention to the cord at the plug, convenience receptacle, and at the point it exits from the Monitor. **NOTE: Do not place adapter under a window where a child might use it to step on and reach something that might be dangerous.**

- Check to make sure outlet plates are not unusually hot to the touch. If they are, immediately unplug cords from these outlets. Check that all outlet connections are in good condition so that adapter is not loose or that no wiring is exposed. Have a qualified, licensed electrician check the wiring as soon as possible.

OBJECT AND LIQUID ENTRY: Care should be taken so that objects do not fall onto, and liquids are not spilled into the enclosure through the openings.

DAMAGE REQUIRING SERVICE: The Monitor should be serviced by qualified service personnel when:

- A. The power supply cord has been damaged; or
- B. Objects have fallen or liquid has been spilled into the product; or
- C. The Monitor has been exposed to rain; or
- D. The Monitor does not appear to operate normally or exhibits a marked change in its performance; or
- E. The Monitor has been dropped or the enclosure damaged.

THE USER SHOULD NOT ATTEMPT TO SERVICE OR REPAIR THE MONITOR. ALL SERVICING SHOULD BE REFERRED TO SAFETY 1ST CUSTOMER SERVICE DEPARTMENT: (800) 544-1108.

PROBLEM	POSSIBLE CAUSE	SOLUTION
Power LED does not illuminate	<ul style="list-style-type: none"> - Parent or Baby Unit is not turned On - Battery pack is dead 	<ul style="list-style-type: none"> - Turn Parent or Baby Unit on. Hold down Power On/Off Button until all LEDs come on - Charge or replace batteries
No power is getting to my Parent/ Baby Unit	<ul style="list-style-type: none"> - Adapter is not receiving electrical power - Electrical power is not getting to Parent/Baby Unit 	<ul style="list-style-type: none"> - Make certain any light switches that control power to the wall outlet are on when using AC adapter - Check AC adapter jack-to-socket and plug-to-outlet connections - Check for pinched wire
Parent Unit has no sound	<ul style="list-style-type: none"> - Volume is too low - Sound is Off - Out of range - Something is blocking microphone 	<ul style="list-style-type: none"> - Adjust the volume - Bring Parent Unit closer to Baby Unit - Remove obstruction from front of Camera
My Parent Unit shows a black screen/no video	<ul style="list-style-type: none"> - Video Time Out is activated - Baby Unit may be turned off - Something is blocking camera lens 	<ul style="list-style-type: none"> - Press Video On/Off Button to turn back ON - Turn Baby Unit ON - Video Monitor will time out after 2 minutes when not plugged into AC outlet - Remove obstruction from front of Camera
Video is not in color	<ul style="list-style-type: none"> - Room is too dark which has activated Day/Night Auto Viewing. This may happen during the twilight hours of the day or if room is darkened for example with shades down. - Baby is being monitored at night in a dark nursery 	<ul style="list-style-type: none"> - Add more light to the room - Day/Night Auto Viewing is activated in the dark allowing you to view baby in black & white only
Picture is not clear	<ul style="list-style-type: none"> - Picture is blurry or not centered 	<ul style="list-style-type: none"> - Make sure protective cling is removed from front of Baby Unit and Parent Unit - Move Camera location - Make sure video is not in Zoom mode

Parent Unit is continuously beeping	<ul style="list-style-type: none"> - Baby Unit is not turned On - Parent Unit is too far away from Baby Unit 	<ul style="list-style-type: none"> - Verify that Baby Unit is On - Verify that Parent Unit is within range of Baby Unit (See Link Indicator on page 10)
Audio feedback (squealing)	<ul style="list-style-type: none"> - Parent Unit is too close to Baby Unit 	<ul style="list-style-type: none"> - Move Parent Unit further away from Baby Unit - Turn down volume on Parent Unit to mute to get minimum feedback
Weak sound coming from Parent Unit	<ul style="list-style-type: none"> - Volume too low - Battery may be low - Protective cling is still on Parent Unit or Baby Unit - Speaker or microphone could be blocked 	<ul style="list-style-type: none"> - Adjust volume - Recharge batteries - Make certain nothing is blocking camera microphone - Remove protective cling
Low Battery LED turns on red	<ul style="list-style-type: none"> - Batteries are low 	<ul style="list-style-type: none"> - For Parent Unit, recharge battery using AC adapter - For Camera Baby Unit, change batteries or plug into AC adapter
There is a delay in my audio/video signal	<ul style="list-style-type: none"> - To properly protect the user from interference, you may perceive a slight delay in sound and video if you are next to the user while looking at the image. 	<ul style="list-style-type: none"> - This delay is normal as the monitor encodes and decode the information to protect your privacy - Normal operation
Product battery life seems shorter than expected	<ul style="list-style-type: none"> - Parent Unit was not charged properly - Parent Unit was not fully charged 	<ul style="list-style-type: none"> - Refer to battery charging instructions on pages 5 & 6 - Use Video On/Off Button feature (See page 10) to extend battery life - Fully charge battery
I'm hearing strange noises on my Parent Unit	<ul style="list-style-type: none"> - The microphone can pick up ambient noise in the room like air conditioning, heating systems and low volume electrical equipment. This could interfere with the quality of the sound output 	<ul style="list-style-type: none"> - Look for any noise source in the baby's room. Remove noise source or move Baby Unit away from the source

IC Statement

This Class B digital apparatus complies with Canadian ICES-003.

Cet appareil numérique de la classe B conforme à la norme NMB-003 du Canada

Apparatus

This device complies with Industry Canada license-exempt RSS standard(s). Operation is subject to the following two conditions: (1) this device may not cause interference, and (2) this device must accept any interference, including interference that may cause undesired operation of the device.

Le présent appareil est conforme aux CNR d'Industrie Canada applicables aux appareils radio exempts de licence. L'exploitation est autorisée aux deux conditions suivantes : (1) l'appareil ne doit pas produire de brouillage, et (2) l'utilisateur de l'appareil doit accepter tout brouillage radioélectrique subi, même si le brouillage est susceptible d'en compromettre le fonctionnement.

This device and its antenna(s) must not be co-located or operation in conjunction with any other antenna or transmitter.

Cet appareil et son antenne (s) ne doit pas être co-localisés ou fonctionnement en association avec une autre antenne ou transmetteur.

Under Industry Canada regulations, this radio transmitter may only operate using an antenna of a type and maximum (or lesser) gain approved for the transmitter by Industry Canada. To reduce potential radio interference to other users, the antenna type and its gain should be so chosen that the equivalent isotropically radiated power (e.i.r.p.) is not more than that necessary for successful communication.

Conformément à la réglementation d'Industrie Canada, le présent émetteur radio peut fonctionner avec une antenne d'un type et d'un gain maximal (ou inférieur) approuvé pour l'émetteur par Industrie Canada. Dans le but de réduire les risques de brouillage radioélectrique à l'intention des autres utilisateurs, il faut choisir le type d'antenne et son gain de sorte que la puissance isotrope rayonnée équivalente (p.i.r.e.) ne dépasse pas l'intensité nécessaire à l'établissement d'une communication satisfaisante.

FCC Statement

Radio and Television Interference

Note: This equipment has been tested and found to comply with the limits for a class B digital device, pursuant to part 15 of the FCC Rules and applicable Industry Canada specifications. These Limits are designed to provide reasonable protection against harmful interference in a residential installation.

This equipment generates, uses and can radiate radio frequency energy and, if not installed and used in accordance with the instructions, may cause harmful interference to radio communications. However, there is no guarantee that interference will not occur in a particular installation. If this equipment does not cause harmful interference to radio or television reception, which can be determined by turning this equipment off and on, the user is encouraged to try to correct the interference by one or more of the following measures:

- Reorient or relocate the receiving antenna
- Increase the separation between the equipment and the receiver
- Connect the equipment into an outlet on a circuit different from that to which the receiver is connected.
- Consult the dealer or an experienced radio/TV technician for help.

This device complies with part 15 of the FCC Rules. Operation is subject to the following two conditions: (1) this device may not cause harmful interference, and (2) this device must accept any interference received, including interference that may cause undesired operation.

FCC Caution: Any changes or modifications not expressly approved by the party responsible for compliance could void the user's authority to operate this equipment.

This device and its antenna(s) must not be co-located or operation in conjunction with any other antenna or transmitter.

WARNING: Changes or modifications not expressly approved by Dorel Juvenile Group can void your authority to operate this equipment under the Federal Communications Commission rules.