

# Poly CCX 500 Business Media Phone

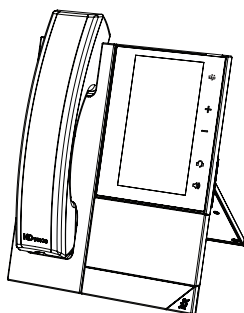

## Package Contents

With Handset Cradle

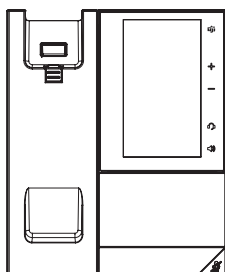

Stand

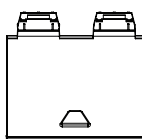

Handset



Handset  
Cord



Without  
Handset Cradle

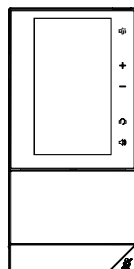

Stand

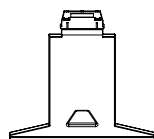

Setup Sheet



Network Cable

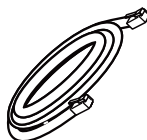

## Optional Accesories



AC Power Adapter  
(varies by region)

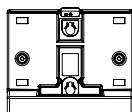

Wallmount

# Features

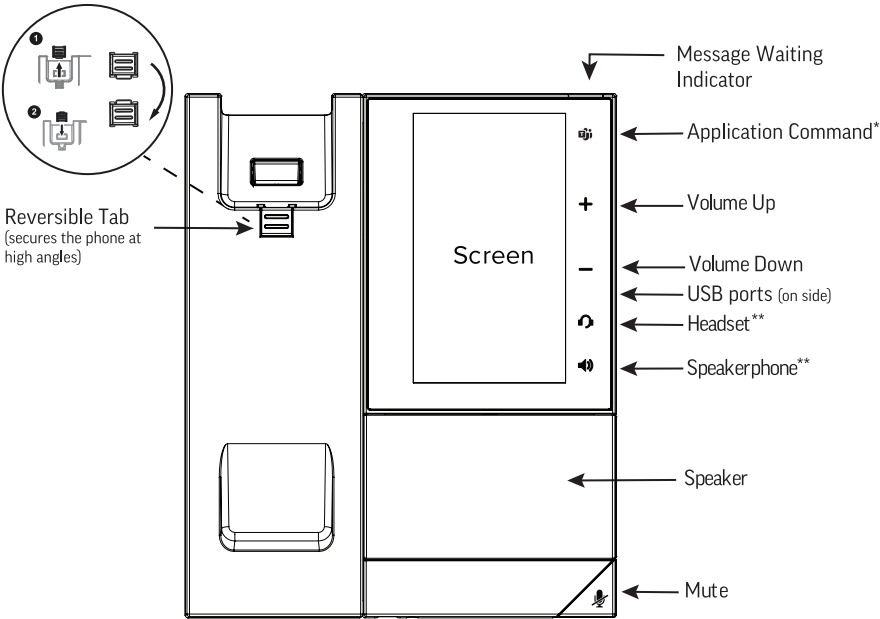

\*Icon displays only when the phone is powered on and the service is available. Icon may vary.  
\*\* Icon displays when the phone is powered on.

# Connect Desktop Stand

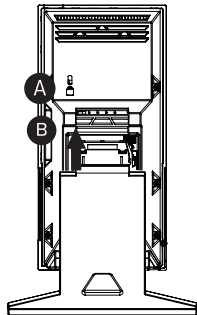

A

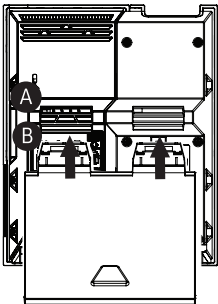
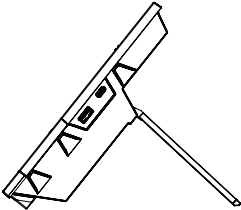

B

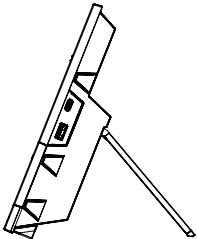

# Connect Cables

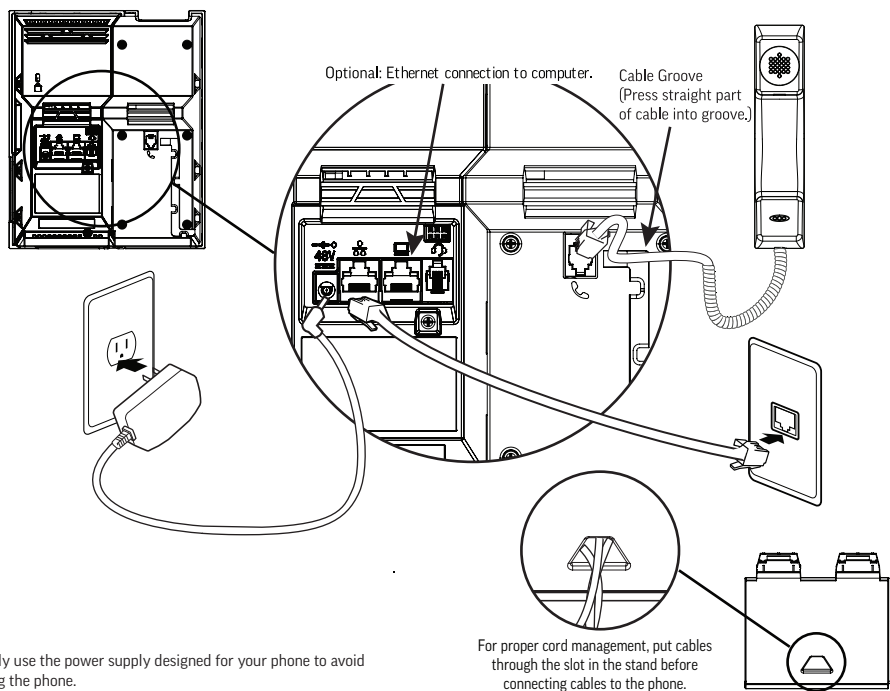

# Connect Optional Headset

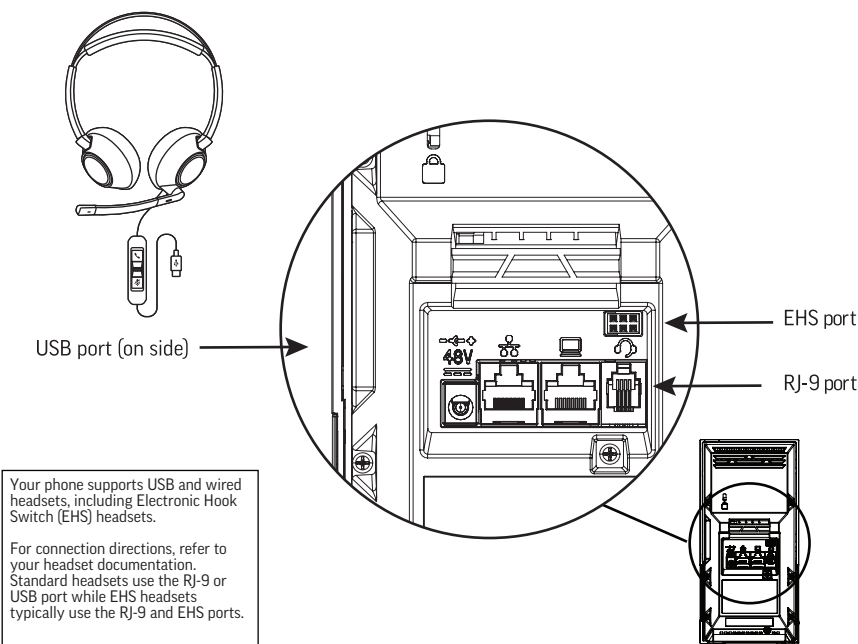



BY USING THIS PRODUCT, YOU ARE AGREEING TO THE TERMS OF THE END USER LICENSE AGREEMENT (EULA) AT:

<http://documents.polycom.com/indexes/licenses>. IF YOU DO NOT AGREE TO THE TERMS OF THE EULA, DO NOT USE THE PRODUCT, AND YOU MAY RETURN IT IN THE ORIGINAL PACKAGING TO THE SELLER FROM WHOM YOU PURCHASED THE PRODUCT.

Refer to the Limited Warranty section of the Product Warranty Guide found in Services at <http://support.polycom.com/>

Hereby, Poly declares that the radio equipment type CCX 500 is in compliance with Directive 2014/53/EU. The full text of the EU declaration of conformity is available at [typeapproval@polycom.com](mailto:typeapproval@polycom.com).

Frequency Range	Maximum Transmit Power
2402-2480MHz	9.26 dBm

## FCC

This device complies with part 15 of the FCC Rules. Operation is subject to the following two conditions: (1) This device may not cause harmful interference, and (2) this device must accept any interference received, including interference that may cause undesired operation.

Changes or modifications not expressly approved by the party responsible for compliance could void the user's authority to operate the equipment.

This equipment has been tested and found to comply with the limits for a Class B digital device, pursuant to part 15 of the FCC Rules. These limits are designed to provide reasonable protection against harmful interference in a residential installation. This equipment generates, uses and can radiate radio frequency energy and, if not installed and used in accordance with the instructions, may cause harmful interference to radio communications. However, there is no guarantee that interference will not occur in a particular installation. If this equipment does cause harmful interference to radio or television reception, which can be determined by turning the equipment off and on, the user is encouraged to try to correct the interference by one or more of the following measures:

- Reorient or relocate the receiving antenna.
- Increase the separation between the equipment and receiver.
- Connect the equipment into an outlet on a circuit different from that to which the receiver is connected.
- Consult the dealer or an experienced radio/TV technician for help.

## IC

This device contains licence-exempt transmitter(s)/receiver(s) that comply with Innovation, Science and Economic Development Canada's licence-exempt RSS(s). Operation is subject to the following two conditions:

1. This device may not cause interference.
2. This device must accept any interference, including interference that may cause undesired operation of the device.

Cet appareil contient des émetteurs / récepteurs exemptés de licence conformes aux RSS (RSS) d'Innovation, Sciences et Développement économique Canada. Le fonctionnement est soumis aux deux conditions suivantes:

1. Cet appareil ne doit pas causer d'interférences.
2. Cet appareil doit accepter toutes les interférences, y compris celles susceptibles de provoquer un fonctionnement indésirable.

CAN ICES-3(B)/NMB-3(B)

Polycom Documentation  
[www.polycom.com/support](http://www.polycom.com/support)



### ENERGY STAR®:



Backlight intensity and timeout can be adjusted in basic user settings menu. By default, after the phone is idle for 40 seconds, the backlight dims. The backlight automatically turns on with any phone activity.

© 2019 Plantronics, Inc. All rights reserved. Poly, the propeller design, and the Poly logo are trademarks of Plantronics, Inc. All other trademarks are the property of their respective owners.

### Contact Information:

Contact your Authorized Reseller for Assistance.

[www.poly.com](http://www.poly.com)

Plantronics, Inc. 345 Encinal Street Santa Cruz, California 95060

1725-49715-001A

