

1. Introduction

Thank you for your purchase of a SkylinkHome™ Dimmable Receiver Module, Model MD-318. This receiver allows you to wirelessly turn on or off, dim and brighten the lighting fixtures.

The Dimmable Receiver Module MD-318 can communicate with up to 8 transmitters so user has the option to add more transmitters to the system.

The following items are included in this package:



- One Dimmable Receiver Module
- Screws and Accessories
- User's Instructions

CAUTION

Installation is required and enclosed instructions must be followed carefully to all steps and notes. If you are uncertain or uncomfortable performing this installation, please consult a qualified electrician. This manual should also be retained for future reference.

2. Installation

1. Turn off power to the circuit at the circuit breaker of the lighting fixture that you plan on Plug-In Lighting Module.

WARNING:

Failure to turn off power at the circuit breaker can result in electrical shock causing severe or fatal injury.

The Dimmable Receiver Module is designed to operate maximum load of 300W at 120VAC, 60Hz.

2. Follow the diagrams below to install the Dimmable Receiver Module with the 3 wires: Neutral, Live and Load. Use the provided screws to secure the Dimmable Receiver Module.
3. After all the wires are connected, ensure that all of the wire connectors are attached securely and there should be no exposed copper wiring. Straighten the antenna.

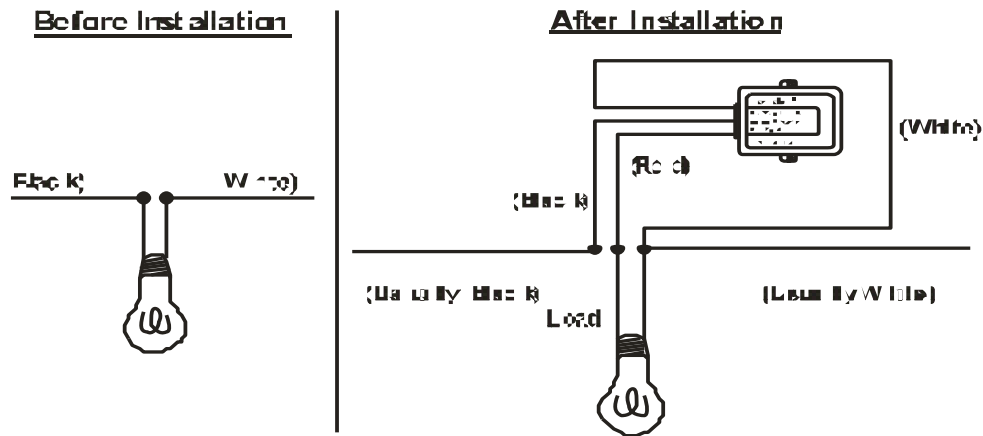

4. Secure the MD-318 inside the lighting fixture and install the lighting fixture back to the original configuration.
5. Turn the circuit breaker back on and turn on the wall switch that is used to operate this lighting fixture.
6. The light will be on and you should hear a single beep. The Dimmable Module is installed properly and you can begin programming transmitter(s) to it.

WARNING: Failure to turn off power at the circuit breaker can result in electrical shock causing severe or fatal injury.

The Dimmable Receiver Module is designed to operate maximum load of 300W at 120VAC, 60Hz.

3. Programming the Dimmable Receiver Module

- The Dimmable Receiver Module should be power off initially.
- Power on the Dimmable Receiver Module. You will hear beeping from the Dimmable Receiver Module and the connected light should be on. The beeping indicates the Dimmable Receiver Module is now in programming mode and it will stay in this mode for 20 seconds.
- Press the PROG button on the back of the transmitter with a sharp object.
- Press the button on the transmitter that you would like to program into the Dimmable Receiver Module.
- Once the transmitter is programmed, the light will be off. You have successfully program the transmitter.

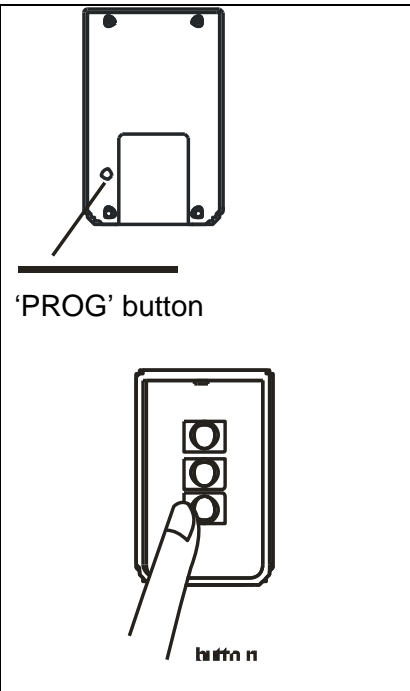

4. Operation

The MD-318 allows on / off operation, when the programmed transmitter is activated.

5. Technical Specification

- Input Voltage: 120V AC, 60Hz
- Maximum Rating: 300W
- Frequency: 318MHz
- Range: Up to 300 feet in open area.

WARRANTY

If, within one year from date of purchase, this product should become defective (except battery), due to faulty workmanship or materials, it will be repaired or replaced, without charge. Proof of purchase and a Return Authorization are required.

FCC

This device complies with Part 15 of the FCC Rules. Operation is subject to the following two conditions:

(1) This device may not cause harmful interference, and (2) This device must accept any interference received, including interference that may cause undesired operation.

Warning: Changes or modifications to this unit not expressly approved by the party responsible for compliance could void the user's authority to operate the equipment.

NOTE: This equipment has been tested and found to comply with the limits for a Class B digital device, pursuant to Part 15 of the FCC Rules. These limits are designed to provide reasonable protection against harmful interference in a residential installation. This equipment generates, uses and can radiate radio frequency energy and, if not installed and used in accordance with the instructions, may cause harmful interference to radio communications. However, there is no guarantee that interference will not occur in a particular installation. If this equipment does cause harmful interference to radio or television reception, which can be determined by turning the equipment off and on, the user is encouraged to try to correct the interference by one or more of the following measures:

- ☐ Reorient or relocate the receiving antenna.
- ☐ Increase the separation between the equipment and receiver.
- ☐ Connect the equipment into an outlet on a circuit different from that to which the receiver is connected.
- ☐ Consult the dealer or an experienced radio/TV technician for help.

WARNING:

Changes or modifications to this unit not expressly approved by the party responsible for compliance could void the user's authority to operate the equipment.

CUSTOMER SERVICE

If you would like to

- find out the up-to-date specifications
- know more about features and applications
- download documents, i.e. user's instructions
- order Skylink products

or if you have difficulty getting products to work, please:

1. visit our FAQ section at www.skylinkhome.com, or
2. email us at support@skylinkhome.com

CUSTOMER SERVICE

17 Shread Ave., Brampton, Ontario,
Canada L6Y 1J3
Email: support@skylinkhome.com
<http://www.skylinkhome.com>
©2014 SKYLINK GROUP