

		REVISIONS			
ECN #	REV.	DESCRIPTION		DATE	APPROVED
	A	PRODUCTION RELEASE		10/9/03	TM

SECTION C-C
SCALE 4 : 1

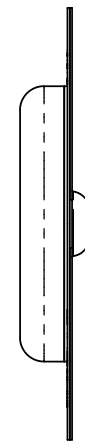
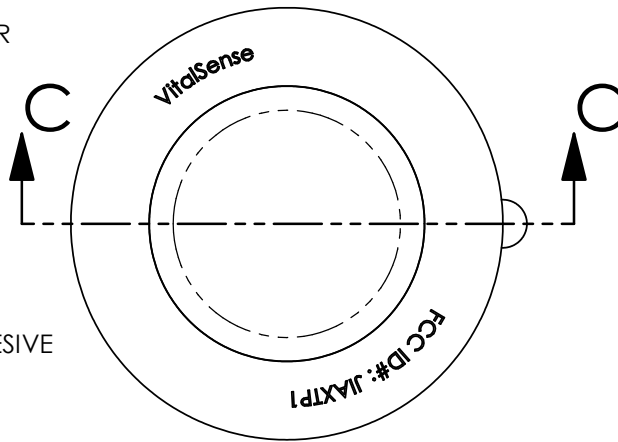
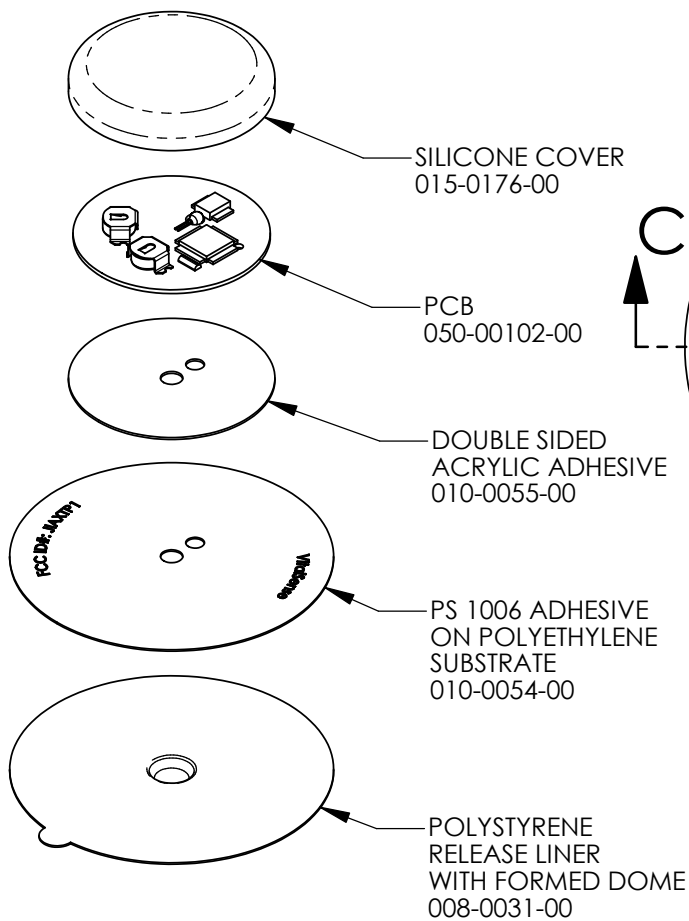

THE INFORMATION CONTAINED IN THIS DRAWING IS THE SOLE PROPERTY OF MINI MITTER CO., INC. AND REPRESENTS A PROPRIETARY ARTICLE IN WHICH MINI MITTER RETAINS ANY AND ALL PATENT AND OTHER RIGHTS, INCLUDING EXCLUSIVE RIGHTS OF USE AND/OR MANUFACTURE, AND/OR SALE. POSSESSION OF THIS PRINT DOES NOT CONVEY ANY PERMISSION TO REPRODUCE PRINT OR MANUFACTURE ARTICLE(S) SHOWN HEREIN. ANY REPRODUCTION IN PART OR AS A WHOLE WITHOUT THE WRITTEN PERMISSION OF MINI MITTER IS PROHIBITED. SPECIFICATION CANNOT BE CHANGED WITHOUT APPROVAL OF MINI MITTER.

UNLESS OTHERWISE SPECIFIED: DIMENSIONS ARE IN INCHES TOLERANCES: THREE PLACE DECIMAL $\pm 0.010"$ TWO PLACE DECIMAL $\pm 0.020"$ ANGULAR: \pm BEND: \pm	
MATERIAL	--
FINISH	--

		MINI MITTER CO., INC. 20300 Empire Avenue, Bldg. B-3 Bend, OR 97701	
		TITLE: SKIN PATCH ASSEMBLY	
		SIZE A	DWG. NO. 500-0200-00 REV. A
COMMENTS: DO NOT SCALE DRAWING		SCALE: 1:1	USED ON VitalSense
		SHEET 1 OF 1	

Figure 3: On the left is a photograph of the Dermal Patch Assembly with proposed FCC ID# label. On the right is the primary and secondary view of the Dermal Patch sensor subassembly.

