

Afimilk Wand

Afimilk Wand User Guide

INNOVA
RELIABLE
EXPERIENCE



afimilk®
Automating dairy farms

Contents

1. Assign Tags using the Afimilk Wand 3

2. Add or Replace Batteries 5

3. Regulatory Warnings 6

4. Revision History 7



1. Assign Tags using the Afimilk Wand

The Afi2Go Wand is a hand-held device for that is used to quickly identify the cow number and active tag ID and associate it to the correct animal.

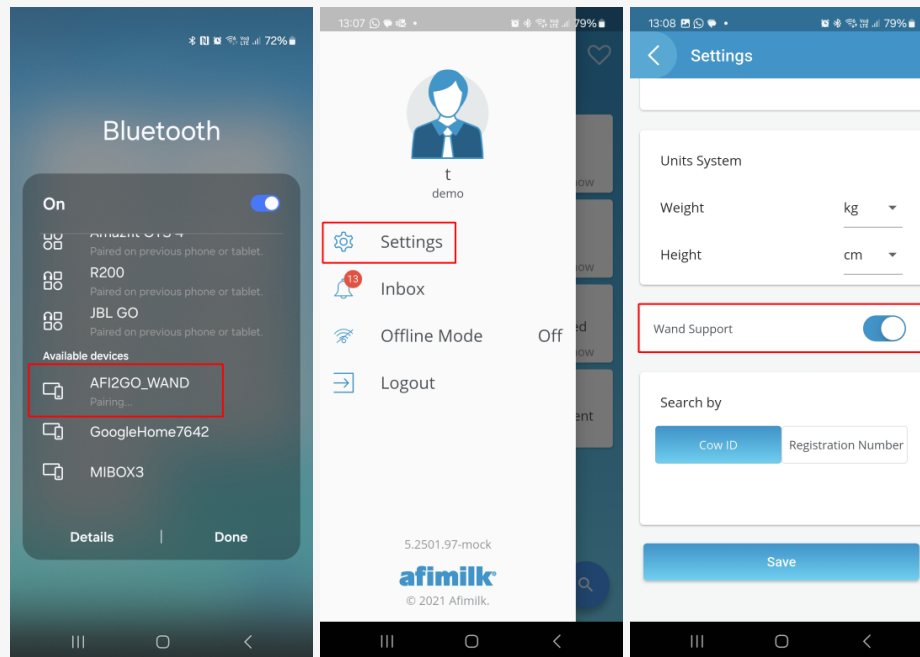
Note: In order to work with Afi2Go Wand, you must have your Bluetooth turned on, and you must have the latest version of Afi2Go Prime installed on your phone. Make sure the **Wand Support** is activated in the application Settings.



To assign a tag using the wand

1. Press , then wait for the battery light to turn ON.
2. Press  to pair the device with your mobile phone.
The blue light flashes, until its connected.
3. In Afi2Go Prime, open **Tag Assignment**.
4. On the Wand, press **RFID** .
5. Hold the tip of the wand near the ISO RFID ear tag.

The Wand reads the tag, the cow card opens, the RFID light turns green, and the RFID # is displayed in the app.

6. On the Wand, press **Afi** .

The AFI light flashes yellow.

7. Hold the blue line of the wand as close as possible to the AfiTag.

The AFI light turns green and the AfiTag ID Number displayed on Afi2Go Prime.

8. Press **Done**.



Note: If the wand cannot read the tag, it times out automatically after 10 seconds and the LED turns from yellow (flashing) to red, and produces three beeps. This is true for both the RFID and AFI scans.

2. Add or Replace Batteries

The Wand is delivered without batteries. Before first use, 4x AA batteries must be correctly inserted into the Wand.

Likewise, the batteries must be switched immediately if the battery power is too weak.

Caution: If the battery LED flashes red, this indicates the battery is too weak to work with and should be replaced immediately before continuing. The Wand will not work if the batteries are near empty.

To change the batteries

1. Unscrew the cap at the bottom of the Wand, then remove the battery pack.
2. After replacing the batteries, screw the cap back into place - make sure the markers line up.



3. Regulatory Warnings

This device complies with Part 15 of the FCC rules. Operation is subject to the following two conditions:

1. This device may not cause harmful interference, and
2. This device must accept any interference received, including such that may cause undesired operation.

FCC Class B Warnings

This equipment has been tested and found to comply with the limits for a Class B digital device, pursuant to Part 15 of the FCC rules. These limits are designed to provide reasonable protection against harmful interference in a residential installation. This equipment generates, uses and can radiate radio frequency energy and, if not installed and used in accordance with the instructions, may cause harmful interference to radio communications. However, there is no guarantee that interference will not occur in a particular installation. If this equipment does cause harmful interference to radio or television reception, which can be determined by turning the equipment off and on, the user is encouraged to try to correct the interference by one or more of the following measures:

1. Reorient or relocate the receiving antenna.
2. Increase the separation between the equipment and receiver.
3. Connect the equipment to an outlet on a circuit different from that to which the receiver is connected.
4. Consult the dealer or an experienced radio/TV technician.

FCC Warning (Modification statement)

Modifications not expressly approved by the manufacturer could void the user's authority to operate the equipment under FCC Rules.

Afimilk has not approved any changes or modifications to this device by the user. Any changes or modifications could void the user's authority to operate the equipment.

RF Exposure Warnings:

- **Portable Device RF Exposure Statement:**

This device has been tested for compliance with FCC RF exposure limits in a portable configuration. This device must not be used with any other antenna or transmitter that has not been approved to operate in conjunction with this device.

4. Revision History

Revision	Date	Performed By:	Description / Comments	Chapter / Page
1	6-2025	Dani Gal / Taryn Rubin	First version completed	
2				
3				

