

Covert Mode

To **toggle Covert Mode** on or off, press and hold the Bookmark button for 5 seconds**. Covert mode can be toggled during recording or standby, but not during sleep mode. When Covert mode is activated, all of the status LEDs will be off, and beeps will be suppressed. When Covert mode is deactivated, the status LEDs will illuminate and beeps will no longer be suppressed*.

Checking Status during Covert operation

A quick press of the Mute button while in Covert mode, allows you to view Record, Battery and Storage Status. Battery status will be shown for 1 second, then Storage Used for 1 second. This procedure may also be used when Vantage is not in Covert mode to view Storage Used.

*Note: Vantage's status is indicated using LEDs, beep, and vibrate, subject to your configuration. Note that regardless of the configuration, if Covert Mode is enabled, the LEDs and beep indications will be suppressed.

**Note: Mute and Bookmark are user functions that can be disabled by an administrator, making them unavailable to the user.

Vantage Default Configuration:

	Feature	Default	Options
1	Resolution	720P/30fps	1080P/720P60/720P30/480P
2	Pre-event recording	Off	Off/On:5/15/30sec
3	Mute Switch	Enabled – user controlled	Enable/Disable
4	Bookmark Switch	Enabled – user controlled	Enable/Disable
5	GPS	On	Off/On
6	Day/Night Mode	On – auto switches	Off/On/Auto
7	IR LEDs	Off	Off/Auto
8	Beep Tone Volume	3 (loudest)	Off/1/2/3
9	LED Illumination	1 (most dim)	Off/1/2/3
10	System Clock	Sync to GPS clock	GPS/PC/EyeHD
11	Time/Date Display	Not overlaid on video	No overlay/Overlay
12	Daylight Savings	On	On/Off
13	Officer Name	None	Officer Name
14	Officer Badge #	None	Officer Badge #
15	Sleep Mode	On	Off/On

For support on your Vantage camera, please contact Kustom Signals' Technical Support Services at 1-800-835-0156 or 1-620-431-2700.

KSI PN: 006-1221-00 – Rev 1.4



Vantage Quick-Reference Guide



Congratulations, and thank you for purchasing the Eyewitness Vantage Officer-Worn Camera from Kustom Signals. While Vantage offers a number of configurable features, actual operation is very simple. Once powered on, there are only three controls available, and just one, the prominent Record start/stop switch, that will be used frequently. This guide should provide everything you need to know to start using the camera.

Note that two options for configuring the cameras are available:

- 1) The camera has been shipped to you with the default configuration. (Defaults are listed on page 4). Check with your administrator for making changes to the configuration.
- 2) The second configuration option involves your agency pre-selecting the desired configuration. If this was done, your Vantage will have shipped pre-configured to your requirements.

Getting Started

- 1) Please charge your camera before the first use. A fully depleted standard battery requires 2 ½ hours to fully charge and will provide 4 ½-5 hours of record time. The extended battery option requires 4 hours to charge and provides up to 9 hours of record time.
- 2) Familiarize yourself with the controls and indicators detailed in this guide.
- 3) Please refer to your Agency's Administrator for the process you will use to download files into your database and for information on the configuration options.

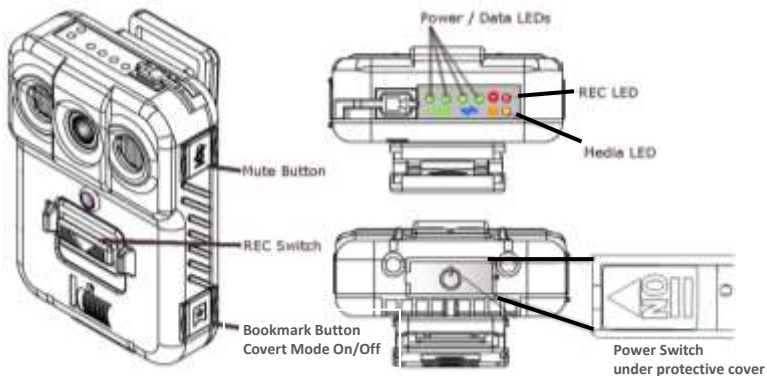

Vantage LED indicators

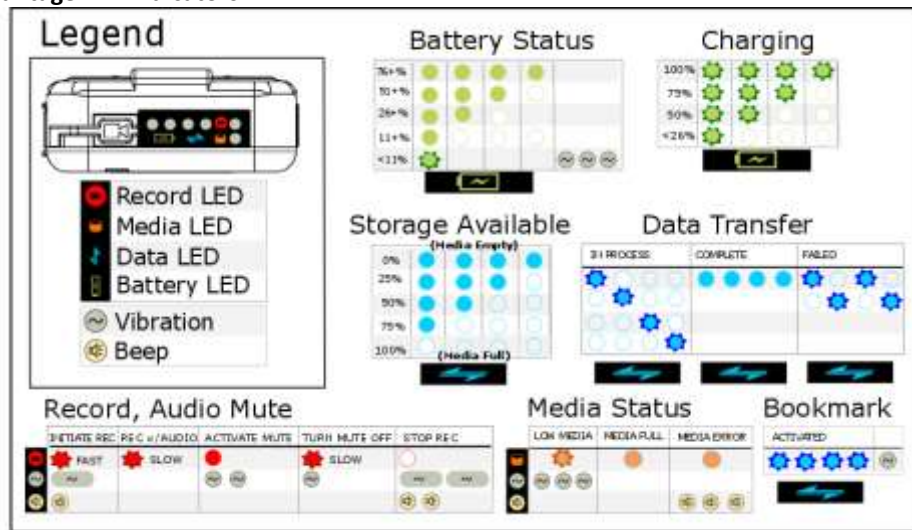

Charging

Place the Vantage in the dock to start charging. The Power LED will be RED while charging, and then change to GREEN when the battery is fully charged. It will also be green if power is connected and no camera is present.



The Vantage battery-LEDs will flash in sequence one at a time as the battery achieves 25%/50%/75%/100% capacity. All four LEDs will continue to flash when the battery is fully charged. A fully depleted battery will require 2 ½ hours to charge.

Recording

In order to start a recording, the unit must be powered on (power switch is on the bottom of the camera), with sufficient battery power and media space available. To **Start a recording**, slide the REC Switch down momentarily and release. Vantage will beep and vibrate once*, indicating recording has started. The REC LED will then continuously flash red*, indicating that video and audio are being recorded.

To **Stop a recording**, slide and hold the REC switch down for 2 seconds, then release. Vantage will beep and vibrate twice*, to indicate the recording has stopped. The REC LED will no longer be illuminated.

Sleep Mode

Vantage includes a **“Sleep” Mode** that conserves battery power. When sleeping, all LEDs are off. Pressing the record switch will wake the camera: in 2 seconds you will see the camera’s LEDs illuminate, then start recording within 3 more seconds. You can also wake the camera momentarily with a quick press of the Bookmark button, which will briefly display battery status, or with a quick press of the Mute button – which will cause the media LED to briefly flash blue. The camera will return to sleep mode after 30 seconds of inactivity (e.g. after a recording is stopped). While the camera is awake, (including when Sleep Mode is disabled) recordings will start in ½ second of pressing the record switch.

Battery Capacity

	Sleep Mode Off	Sleep Mode On
Standard Battery	4 ½ – 5 hours	Up to 48 hours

Mute

To **toggle the Mute** function on/off, press and hold the Mute button  for 2 seconds during a recording**. When Mute function is **toggled ON** (audio record disabled), Vantage will vibrate twice to indicate that Mute has been activated, and the REC LED will change from flashing to solid red.

Unless configured otherwise, Vantage will start each recording with Mute deactivated (audio record enabled).

When Mute function is **toggled OFF** (audio record enabled), Vantage will vibrate once to indicate that Mute has been deactivated, and the REC LED will change from solid to flashing red.

Bookmark

To **add a bookmark** to a recording, momentarily press the bookmark button  during the recording**. All 4 power/media LEDs will flash blue once, to indicate that a bookmark has been recorded.

Homologation

FCC Compliance Statement.

This device complies with part 15 of the FCC Rules. Operation is subject to the following two conditions :

- (1) This device may not cause harmful interference, and**
- (2) This device must accept any interference received, including interference that may cause undesired operation.**

Do Not



Any changes or modifications to the equipment not expressly approved by the party responsible for compliance could void user's authority to operate the equipment.

IC Compliance Statement.

This device complies with Industry Canada licence-exempt RSS standard(s). Operation is subject to the following two conditions:

- (1) this device may not cause interference, and**
- (2) this device must accept any interference, including interference that may cause undesired operation of the device.**

Le present appareil est conforme aux CNR d'Industrie Canada applicables aux appareils radio exempts de licence. L'exploitation est autorisée aux deux conditions suivantes :

- (1) l'appareil ne doit pas produire de brouillage, et**
- (2) l'utilisateur de l'appareil doit accepter tout brouillage radioélectrique subi, même si le brouillage est susceptible d'en compromettre le fonctionnement.**

This equipment has been tested and found to comply with the limits for a Class B digital device, pursuant to part 15 of the FCC Rules. These limits are designed to provide reasonable protection against harmful interference in a residential installation.

This equipment generates uses and can radiate radio frequency energy and, if not installed and used in accordance with the instructions, may cause harmful interference to radio communications. However, there is no guarantee that interference will not occur in a particular installation. If this equipment does cause harmful interference to radio or television reception, which can be determined by turning the equipment off and on, the user is encouraged to try to correct the interference by one or more of the following measures:

- Reorient or relocate the receiving antenna.
- Increase the separation between the equipment and receiver.
- Connect the equipment into an outlet on a circuit different from that to which the receiver is connected.
- Consult the dealer or an experienced radio/TV technician for help.

To comply with FCC RF exposure compliance requirements, please use the supplied belt clips provided by the manufacturer. This device must not be co-located or operation in conjunction with any other antenna or transmitter except complying with FCC multi-transmitter requirements.