

1. System operation instructions

Group	Frequency Type	B	C	D
Compatible Models	UF-20R	R-4	RU-8011	Other
	UF-20S			
	UF-20DA			
Remoset	Yes	No	No	No
Frequency	Auto	Manual	Manual	Manual
Group/Channel	Auto	Manual	Manual	No

- Before connecting to power, make sure the voltage marked on equipment is the same as that on the power socket.
- Do not place the equipment in damp and hot environment.
- Prior to operation, please dry your hands.
- Keep the equipment away from fire and heat source.
- Transmitter and receiver need to be adjusted to the same “default channel” or “frequency” .
- Caution: The suitable environment for this product is with a temperature between -10°C (14°F) and +50°C (122°F).

2. Features

- 2400 to 3000 selectable frequencies.
- Preset 15 groups each of up to 63 compatible channels.
- Phase-Locked Loop (PLL) synthesized tune.
- Extended dynamic range and smooth frequency response.
- Adjustable transmission power between Low and High.
- The panel Lock-On function prevents tampering and RF interruption.
- Full-color LCD display.
- Provide 12V & 48V phantom power.
- Selectable polarity assignment for the audio input connector.
- It is compatible with all JTS receivers.

3. Specification

Frequency Preparation	PLL Synthesized Control
Frequency Setting	JTS patented obstacles-free RF REMOSET
Carrier Frequency Range	UHF 470~960 MHz
Bandwidth	75MHz Wideband (MAX)
RF Outputs	Low / High
Stability	<±10KHz
Frequency Deviation	±48KHz (Peak)
LCD Display	Group, Channel, Frequency, Remoset, User Name, Phantom Power, Polarity, Pad Control, Low Cut, Sensitivity, Battery Status, Mute, Key Lock
Controls	Power ON/OFF, Frequency, Group, Sensitivity, Low Cut, Device ID, Remoset, RF Power, Light Time, User Name, Reset, Key Lock, Mute, Low Cut, Phantom Power, Polarity
Input Connector	XLR
Spurious Emissions	<-50 dBC
Audio Frequency Response	50Hz~18KHz
Battery	AM3 AA*2
Dimension (mm)	40mm(W)x 130mm(H)x 40mm(D)
Weight	320g
Note	Actual product specifications may vary depending on region.

4. Parts Identification & Accessories

Front panel

- LED status display
Green: power on / Blue: Remoset transmitting (approximately 5 seconds)
Red: battery low / Flashing red: mute
Flashing red, green: battery low and mute
- ▲,▼: up and down buttons to select the desired function of the handheld device.
- XLR Input Connector
- Locking ring
- Full-Color LCD display
- SET: set and save handheld transmitter.
- Power
(1) Transmitter on/off
Power on: push the Power button.
Power off: push and hold the Power button for two second till the display shows “Power Off.”
(2) Mute: the transmitter is in use (with main screen on display)
To mute: Short push the Power button display.
To cancel: Short push the Power button display again.
- Exit Setting Menu:
Already in the Setting Menu: push the Power button to return to main screen.
Already in a function setting: push the Power button to return to the Setting Menu and again to return to the main screen.
- Battery Compartment Cover
- Battery Holder Cover Latch

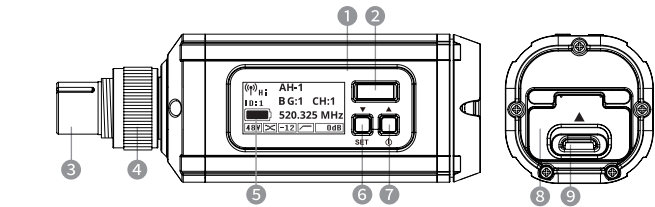

Description of Transmitter LCD display

- Transmission Power: Hi (High) and Lo (Low)
- Remoset ID: from 0 to 255
- Battery Indicator: in 5 levels
- Phantom Power: OFF,12V, 48V
- Input Polarity: Positive, Negative
- Pad Control: 0dB, -3dB, -6dB, -12dB, four sections
- Low Cut indication
- Sensitivity: -15dB~ +15dB, 1dB step
- Current Frequency
- Current Group / Channel
- User Name
- Default Group Frequency Type Mapping

It supports the mapping of three group frequency types: B, C, and D

Battery Replacement Instructions

- Push the battery holder cover latch upward.
- Press the battery holder all the way down, and it will pop out.
- Remove the battery holder to replace the battery.
- Insert the battery holder along the track.
- Slowly push it inward.
- When you hear a click, it means that it is locked in place. (Don't press the battery holder all the way down.)
- Close the battery holder cover to complete the process.

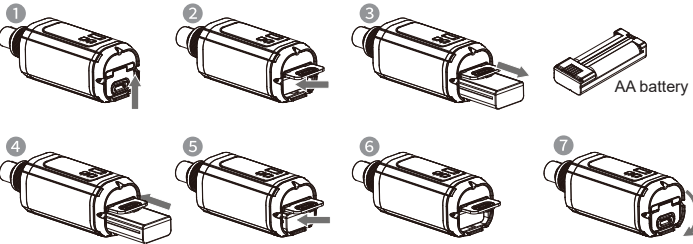

Microphone Installation Instructions

- Insert AH-1 into a microphone or audio device with an XLR connector.
- When you hear a click, it means that it is locked in place.
- Tighten the locking ring to complete the installation.

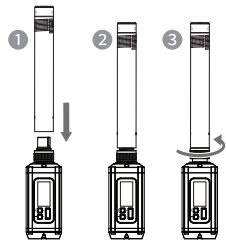

Accessories

- AA Battery Holder
- NIMH Rechargeable Battery

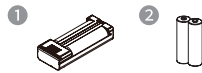

5.Operation

Parameter setting

Press the SET button for 2 seconds to enter the setting mode. By pressing the SET button repeatedly, you can enter different setting items in order, then you can press ▲/▼ button to set the parameters, and press SET again to save the setting and leave. Press the Power button to not save and return to the previous page.

1.Radio

(1) Frequency	
1MHz per unit	Select with ▲/▼
0.025MHz per unit	Select with ▲/▼

(2) Group/Channel (Some models with group frequency type D are not compatible.)

G (group)	Select default group1~6
CH (channel)	Select default channel(s)

(3) RF Power

Select ▲	High RF power
Select ▼	Low RF power

(4) Return: to main menu



1. Frequency
2. Group/Channel
3. RF Power
4. Return

Setup Frequency
520.375 MHz
G: 1 CH: 1

Group/Channel
G: 1 CH: 1
520.325 MHz

RF Power
High
Low

2.Audio

- Sensitivity: Press ▲/▼ to select the Sensitivity. The range of sensitivity is -15dB~+15dB. 1dB step.

(2) Low Cut

Select ▲	ON
Select ▼	OFF

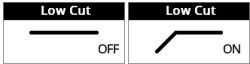

(3) Pad Control: Press ▲/▼ to select the Pad Control. 0dB, -3dB, -6dB, -12dB four sections.

Pad Control
-12 dB

(4) Phantom Power: Press ▲/▼ to select the Phantom Power. 48V, 12V and OFF.

Phantom Power
OFF 12V 48V

(5) Input Polarity

Select ▲	Positive
Select ▼	Negative

Input Polarity
Positive
Negative

(6) Manual Mute

Select ▲	Enable mute control
Select ▼	Disable mute control

Mute Control
Enable
Disable

※After enabling the mute function, you can turn it on/off by pressing the Power button when not in the setting mode.

(7) Return: to main menu

3.Remoset

(1) Remoset (Only the models with group frequency type B have the specific function.)

<input checked="" type="radio"/>	Frequency can be matched to the transmitter.
<input type="radio"/>	No frequency can be matched to the transmitter.

Remoset	<input checked="" type="radio"/>
Enable ID	<input checked="" type="radio"/>
Remoset ID	1
Save and exit	
Exit without save	

(2) Enable ID

<input checked="" type="radio"/>	The ID must be the same as the transmitter in order to pair with the transmitter.
<input type="radio"/>	Pair with the transmitter regardless of the transmitter ID.

(3) Remoset ID: Press ▲/▼ to select 0~255.

(4) Save and exit: Save the setting value and return to the main menu.

(5) Exit without save: Do not save the setting value and return to the main menu.

4.User Name

Press ▲/▼ to select the characters. After confirmation, press SET to select the next character. After confirmation, press SET to save the setting. If no character is needed, select the first "space". There is a total of 10 characters for setting. Press SET until the 10th word and it will be saved after leaving the setting.

Edit User Name
H-1 1/10
= > ? @ A B C D E

1. Light Time
2. Screen Color
3. Language
4. Factory Reset
5. Return

Light Time
15 Sec

Screen Color
Dark Light Color

Language
English
中文

Factory Reset
YES
NO
Restore factory settings
Cancellation

5.System Option

(1) Light Time: Press ▲/▼ to select the backlight time. You can select "OFF" , 5~30 seconds (having 5 seconds as the unit of change).

(2) Screen Color: You can select Screen Color style: color, dark, light, etc.

(3) Language: Press ▲/▼ to select the Language in English or 中文.

(4) Factory Reset

(5) Return: to main menu

6.Key Lock

Select ▲	Lock
Select ▼	Unlock

※ When the screen is locked, you can press and hold the SET button to enter this page and select "Unlock" to release the lock of buttons.

Key Lock
Lock
Unlock

7.Return

6. Product notes

- To get the best signal performance, please keep at least 3 meters between a receiver and a transmitter.
- Keep a receiver and transmitter from other metal object for at least 50cm.
- To prevent feedback and whistle, please do not aim transmitter to speaker.
- It is suggested to hold the middle section of transmitter (microphone) body to achieve the best pickup effect.
- When transmitter is not used for a long time, please remove batteries from battery compartment to avoid leakage of electrolyte solution to damage transmitter.
- When replacing batteries, please replace two batteries at the same time and use the same brand of battery, to assure the best power performance.

7. Important Notice

- JTS offers wireless systems in a selection of bands that conform to the different government regulations of specific nations or geographic regions. These regulations help limit radio frequency (RF) interference among different wireless devices and prevent interference with local public communications channels, such as television and emergency broadcasts.
- For information on bands available in your area, consult your local dealer or phone JTS. More information is also available at JTS's website (www.jts.com.tw).
- This Radio apparatus may be capable of operating on some frequencies not authorized in your region. Please contact your national authority to obtain information on authorized frequencies and RF power levels for wireless microphone products.

IMPORTANT NOTE

This equipment has been tested and found to comply with the limits for a Class B digital device, pursuant to part 15 of the FCC Rules. These limits are designed to provide reasonable protection against harmful interference in a residential installation. This equipment generates, uses and can radiate radio frequency energy and, if not installed and used in accordance with the instructions, may cause harmful interference to radio communications. However, there is no guarantee that interference will not occur in a particular installation. If this equipment does cause harmful interference to radio or television reception, which can be determined by turning the equipment off and on, the user is encouraged to try to correct the interference by one or more of the following measures:
-Reorient or relocate the receiving antenna.
-Increase the separation between the equipment and receiver.
-Connect the equipment into an outlet on a circuit different from that to which the receiver is connected.
-Consult the dealer or an experienced radio/ TV technician for help

CAUTION:
Any changes or modifications not expressly approved by the grantee of this device could void the user's authority to operate the equipment.

This device complies with Part 15 of the FCC Rules. Operation is subject to the following two conditions:
(1) This device may not cause harmful interference, and (2) This device must accept any interference received, including interference that may cause undesired operation.

The equipment complies with FCC RF exposure limits set forth for an uncontrolled environment.
The equipment must not be co-located or operating in conjunction with any other antenna or transmitter.