

APPLICANT: MOTOROLA, INC.

FCC ID: IHDT56DD1

INSTRUCTION MANUAL

A preliminary draft copy of the Users Manual follows:

Welcome

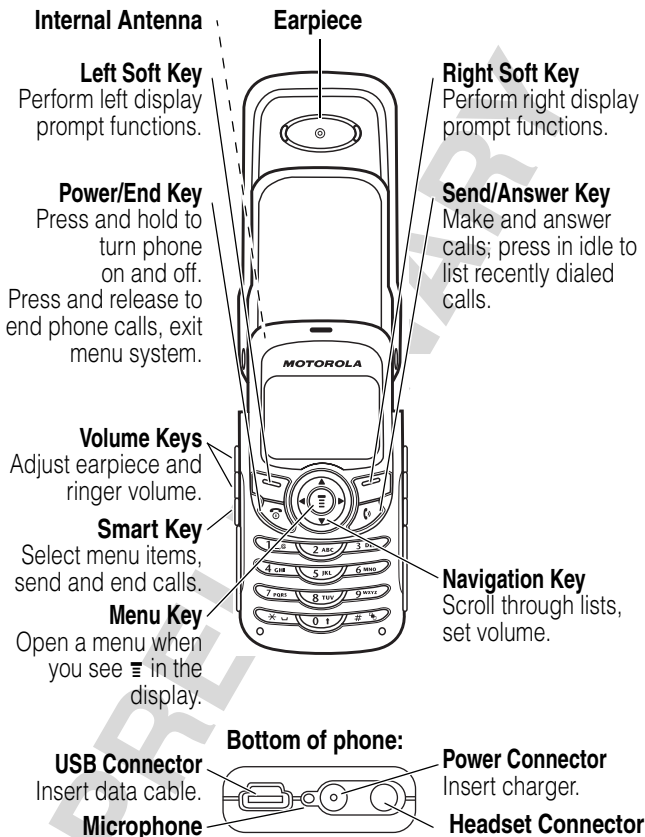

Personal Communications Sector
600 North U.S. Highway 45
Libertyville, Illinois 60048

1-800-331-6456 (United States)
1-888-390-6456 (TTY/TDD United States)
1-800-461-4575 (Canada)

www.motorola.com (United States)
www.motorola.ca (Canada)

MOTOROLA and the Stylized M Logo are registered in the US Patent & Trademark Office. All other product or service names are the property of their respective owners.

© Motorola, Inc. 2003.

Software Copyright Notice

The Motorola products described in this manual may include copyrighted Motorola and third party software stored in semiconductor memories or other media. Laws in the United States and other countries preserve for Motorola and third party software providers certain exclusive rights for copyrighted software, such as the exclusive rights to distribute or reproduce the copyrighted software. Accordingly, any copyrighted software contained in the Motorola products may not be modified, reverse-engineered, distributed, or reproduced in any manner to the extent allowed by law. Furthermore, the purchase of the Motorola products shall not be deemed to grant either directly or by implication, estoppel, or otherwise, any license under the copyrights, patents, or patent applications of Motorola or any third party software provider, except for the normal, non-exclusive, royalty-free license to use that arises by operation of law in the sale of a product.

Manual number: 6809461A46-O
Cover number: 8988485L49-O

Contents

Getting Started	12
What's in the Box?	12
About This Guide	12
Installing the Battery	13
Charging the Battery	14
Battery Use	15
Changing Your SIM Card	16
Changing Your Phone's Lens	18
Turning Your Phone On	20
Adjusting the Volume	20
Making a Call	21
Answering a Call	22
Viewing Your Phone Number	22
Learning to Use Your Phone	23
Using the Display	23
Using the 4-Way Navigation Key	27
Using Menus	28
Entering Text	30
Choosing a Text Entry Method	38
Using Your Phone While it is Closed	39
Using the Smart Key	41
Locking and Unlocking Your Phone	42
Changing a Code or Password	43
If You Forget a Code or Password	44
Locking and Unlocking the Keypad	44
Setting Up Your Phone	45
Storing Your Name and Phone Number	45
Setting the Time and Date	45

Setting an Alert Style	46
Setting Answer Options	47
Activating Club Lights	47
Setting a Wallpaper Image	48
Selecting a Screen Saver	49
Setting Display Color	50
Setting Display Contrast	50
Adjusting the Backlight	50
Zooming In and Out	50
Conserving Battery Power	51
Calling Features	52
Changing the Active Line	52
Redialing a Number	52
Using Caller ID	53
Canceling an Incoming Call	53
Turning Off a Call Alert	54
Calling an Emergency Number	54
Dialing International Numbers	55
Viewing the Received Calls or Dialed Calls List	55
Returning an Unanswered Call	57
Using the Notepad	58
Attaching a Number	58
Calling With Speed Dial	59
Calling With 1-Touch Dial	59
Using Voicemail	59
Using Call Waiting	61
Putting a Call on Hold	62
Transferring a Call	62
Phone Features	64
Main Menu	64
Feature Quick Reference	66

Specific Absorption Rate Data	79
Additional Health and Safety Information	81
Warranty	89
Product Registration	94
Export Law Assurances	94
RF Energy Interference	94
Index.	95
Wireless Phone Safety Tips.	103

PRELIMINARY

Safety and General Information

IMPORTANT INFORMATION ON SAFE AND EFFICIENT OPERATION.
READ THIS INFORMATION BEFORE USING YOUR PHONE.

The information provided in this document supersedes the general safety information in user guides published prior to December 1, 2002.

Exposure To Radio Frequency (RF) Energy

Your phone contains a transmitter and a receiver. When it is ON, it receives and transmits RF energy. When you communicate with your phone, the system handling your call controls the power level at which your phone transmits.

Your Motorola phone is designed to comply with local regulatory requirements in your country concerning exposure of human beings to RF energy.

Operational Precautions

To assure optimal phone performance and make sure human exposure to RF energy is within the guidelines set forth in the relevant standards, always adhere to the following procedures.

External Antenna Care

Use only the supplied or Motorola-approved replacement antenna. Unauthorized antennas, modifications, or attachments could damage the phone.

Do NOT hold the external antenna when the phone is IN USE. Holding the external antenna affects call quality and may cause the phone to operate at a higher power level than needed. In addition, use of unauthorized antennas may result in non-compliance with the local regulatory requirements in your country.

Phone Operation

When placing or receiving a phone call, hold your phone as you would a wireline telephone.

Body-Worn Operation

To maintain compliance with RF energy exposure guidelines, if you wear a phone on your body when transmitting, always place the phone in a Motorola-supplied or approved clip, holder, holster, case, or body harness for this phone, if available. Use of accessories not approved by Motorola may exceed RF energy exposure guidelines. If you do not use one of the body-worn accessories approved or supplied by Motorola, and are not using the phone held in the normal use position, ensure the phone and its antenna are at least 1 inch (2.5 centimeters) from your body when transmitting.

Data Operation

When using any data feature of the phone, with or without an accessory cable, position the phone and its antenna at least 1 inch (2.5 centimeters) from your body.

Approved Accessories

Use of accessories not approved by Motorola, including but not limited to batteries and antenna, may cause your phone to exceed RF energy exposure guidelines. For a list of approved Motorola accessories, visit our website at www.Motorola.com.

RF Energy Interference/Compatibility

Note: Nearly every electronic device is susceptible to RF energy interference from external sources if inadequately shielded, designed, or otherwise configured for RF energy compatibility. In some circumstances your phone may cause interference.

Facilities

Turn off your phone in any facility where posted notices instruct you to do so. These facilities may include hospitals or health care facilities that may be using equipment that is sensitive to external RF energy.

Aircraft

When instructed to do so, turn off your phone when on board an aircraft. Any use of a phone must be in accordance with applicable regulations per airline crew instructions.

Medical Devices

Pacemakers

Pacemaker manufacturers recommend that a minimum separation of 6 inches (15 centimeters) be maintained between a handheld wireless phone and a pacemaker.

Persons with pacemakers should:

- ALWAYS keep the phone more than 6 inches (15 centimeters) from your pacemaker when the phone is turned ON.
- NOT carry the phone in the breast pocket.
- Use the ear opposite the pacemaker to minimize the potential for interference.
- Turn OFF the phone immediately if you have any reason to suspect that interference is taking place.

Hearing Aids

Some digital wireless phones may interfere with some hearing aids. In the event of such interference, you may want to consult your hearing aid manufacturer to discuss alternatives.

Other Medical Devices

If you use any other personal medical device, consult the manufacturer of your device to determine if it is adequately shielded from RF energy. Your physician may be able to assist you in obtaining this information.

Use While Driving

Check the laws and regulations on the use of phones in the area where you drive. Always obey them.

When using your phone while driving, please:

- Give full attention to driving and to the road.
- Use hands-free operation, if available.
- Pull off the road and park before making or answering a call if driving conditions so require.

Responsible driving best practices may be found in the “Wireless Phone Safety Tips” at the end of this manual and at the Motorola website:

www.Motorola.com/callsmart.

Operational Warnings

For Vehicles With an Air Bag

Do not place a phone in the area over an air bag or in the air bag deployment area. Air bags inflate with great force. If a phone is placed in the air bag deployment area and the air bag inflates, the phone may be propelled with great force and cause serious injury to occupants of the vehicle.

Potentially Explosive Atmospheres

Turn off your phone prior to entering any area with a potentially explosive atmosphere, unless it is a phone type especially qualified for use in such areas and certified as “Intrinsically Safe.” Do not remove, install, or charge batteries in such areas. Sparks in a potentially explosive atmosphere can cause an explosion or fire resulting in bodily injury or even death.

Note: The areas with potentially explosive atmospheres referred to above include fueling areas such as below decks on boats, fuel or chemical transfer or storage facilities, areas where the air contains chemicals or particles, such as grain, dust, or metal powders. Areas with potentially explosive atmospheres are often but not always posted.

Blasting Caps and Areas





To avoid possible interference with blasting operations, turn OFF your phone when you are near electrical blasting caps, in a blasting area, or in

areas posted “Turn off electronic devices.” Obey all signs and instructions.

Batteries

Batteries can cause property damage and/or bodily injury such as burns if a conductive material such as jewelry, keys, or beaded chains touch exposed terminals. The conductive material may complete an electrical circuit (short circuit) and become quite hot. Exercise care in handling any charged battery, particularly when placing it inside a pocket, purse, or other container with metal objects. **Use only Motorola original batteries and chargers.**

Your battery or phone may contain symbols, defined as follows:

Symbol	Definition
	Important safety information will follow.
	Your battery or phone should not be disposed of in a fire.
	Your battery or phone may require recycling in accordance with local laws. Contact your local regulatory authorities for more information.
	Your battery or phone should not be thrown in the trash.
	Your phone contains an internal lithium ion battery.

Seizures/Blackouts

Some people may be susceptible to epileptic seizures or blackouts when exposed to blinking lights, such as when watching television or playing video games. These seizures or blackouts may occur even if a person never had a previous seizure or blackout.

If you have experienced seizures or blackouts, or if you have a family history of such occurrences, please consult with your doctor before

playing video games on your phone or enabling a blinking-lights feature on your phone. (The blinking-light feature is not available on all products.)

Parents should monitor their children's use of video game or other features that incorporate blinking lights on the phones. All persons should discontinue use and consult a doctor if any of the following symptoms occur: convulsion, eye or muscle twitching, loss of awareness, involuntary movements, or disorientation.

To limit the likelihood of such symptoms, please take the following safety precautions:

- Do not play or use a blinking-lights feature if you are tired or need sleep.
- Take a minimum of a 15-minute break hourly.
- Play in a room in which all lights are on.
- Play at the farthest distance possible from the screen.

Repetitive Motion Injuries

When you play games on your phone, you may experience occasional discomfort in your hands, arms, shoulders, neck, or other parts of your body. Follow these instructions to avoid problems such as tendonitis, carpal tunnel syndrome, or other musculoskeletal disorders:

- Take a minimum 15-minute break every hour of game playing.
- If your hands, wrists, or arms become tired or sore while playing, stop and rest for several hours before playing again.
- If you continue to have sore hands, wrists, or arms during or after play, stop playing and see a doctor.

Getting Started



What's in the Box?

Your digital wireless phone typically comes with a battery and a charger. Other accessory options can customize your phone for maximum performance and portability.

To purchase Motorola Original™ accessories, contact the Motorola Customer Call Center at 1-800-331-6456 in the United States or 1-800-461-4575 in Canada.

About This Guide

This user guide describes how to use your Motorola wireless phone.

Note: A reference guide for your phone is also available that describes your phone's features in more detail.

To obtain the reference guide for your phone, or another copy of this user guide, see the Motorola Web site at:

<http://motorola.com/consumer/manuals>

or contact the Motorola Customer Call Center at 1-800-331-6456 in the United States or 1-800-461-4575 in Canada.



Optional Features

This label identifies an optional network, SIM card, or subscription-dependent feature that may not be offered by all service providers in all geographical areas. Contact your service provider for more information.



Optional Accessories

This label identifies a feature that requires an optional Motorola Original™ accessory.

Installing the Battery

You must install and charge the battery to use your phone.



Your phone is designed to be used only with Motorola Original batteries and accessories. We recommend that you store batteries in their protective cases when not in use.

Action

- 1 Remove the battery from its protective clear plastic case, if necessary.
- 2 Press the cover release button.
- 3 Slide the phone's back cover down, then lift it off.

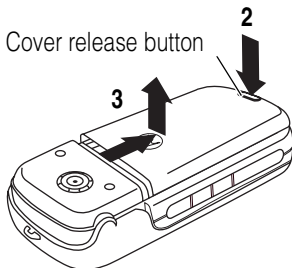



Action

- 4 Insert the battery with printed arrows and two tabs at the top of the battery compartment.
- 5 Push down until the battery inserts at the bottom.
- 6 Set the back cover on the phone, then slide it up to lock it.

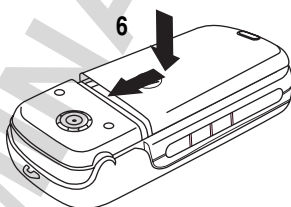
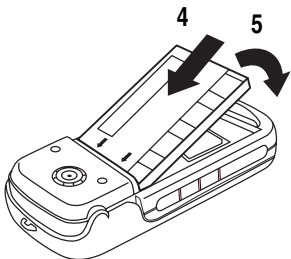

Charging the Battery

New batteries are partially charged. Before you can use your phone, you need to install and charge the battery. Some batteries perform best after several full charge/discharge cycles.

Caution: If the battery is fully discharged, your phone may not display **Charging** for up to 1 minute after inserting the

charger. **Do not** attempt to force the charger further in if you do not see an immediate response.

Action

- 1 Plug the travel charger into the middle jack as shown.

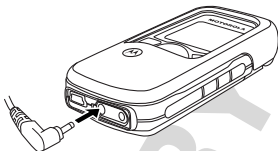

- 2 Plug the other end of the travel charger into the appropriate electrical outlet.
- 3 When your phone indicates **Charge Complete**, remove the travel charger.

When you charge the battery, the battery level indicator in the upper right corner of the display shows how much of the charging process is complete. See “Battery Level Indicator” on page 24.

Battery Use

Caution: To prevent injuries or burns, do not allow metal objects to contact or short-circuit the battery terminals.

To maximize battery performance:

- Always use Motorola Original™ batteries and battery chargers. The phone warranty does not cover damage caused from using non-Motorola batteries and/or battery chargers.
- New batteries or batteries that have been stored for a long time may require a longer initial charge time.





- Maintain the battery at or near room temperature when charging.
 - Do not expose batteries to temperatures below -10°C (14°F) or above 45°C (113°F). Always take your phone with you when you leave your vehicle.
 - When you do not intend to use a battery for a while, store it uncharged in a cool, dark, dry place, such as a refrigerator.
- Over time, batteries gradually wear down and require longer charging times. This is normal. If you charge your battery regularly and notice a decrease in talk time or an increase in charging time, then it is probably time to purchase a new battery.



The rechargeable batteries that power this product must be disposed of properly and may need to be recycled. Refer to your battery's label for battery type. Contact your local recycling center for proper disposal methods. Never dispose of batteries in a fire because they may explode.

Changing Your SIM Card

Your SIM (Subscriber Identity Module) card contains your phone number, service details, and phonebook/message memory. It must be installed in your phone, and must be a **3-volt** SIM card. If you have problems with your SIM card, contact your service provider.

Caution: Do not bend or scratch your SIM card. Avoid exposing your SIM card to static electricity, water, or dirt.

Action

- 1 Press the cover release button.
- 2 Slide the phone's back cover down, then lift it off.

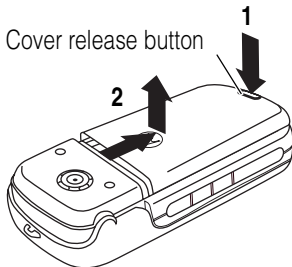

- 3 Lift out the battery from the base of the phone.

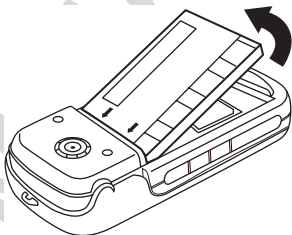

- 4 Slide the metal SIM card cover to unlock it.
- 5 Lift out the old SIM card, if necessary.

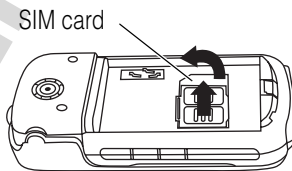



Action

- 6 Slide in the new SIM card in the holder with the cut corner on the upper right and the gold plate facing down.

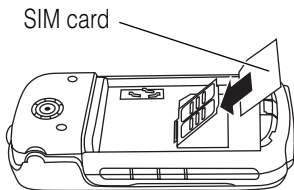

- 7 Insert the battery with printed arrows and two tabs at the top of the battery compartment.

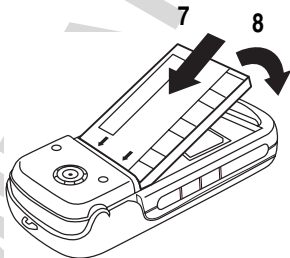

- 8 Push down until the battery inserts at the bottom.

- 9 Set the back cover on the phone, then slide it up to lock it.

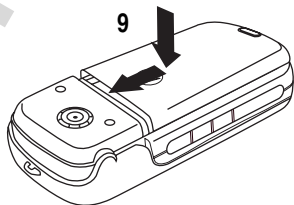

Changing Your Phone's Lens



Always use Motorola Original™ lenses. The phone warranty does not cover damage caused from using non-Motorola accessories.

Your phone has a removable lens that you can replace to change its appearance.

Action

- 1 Open your phone flip.
- 2 Press the lens carefully until it pops out.

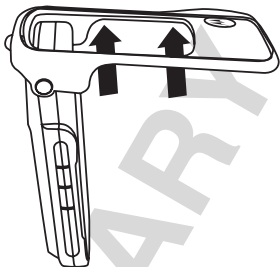

- 3 Insert the bottom of the new lens into the bottom of the phone flip.
- 4 Press the top of the new lens onto the phone until it snaps into place.

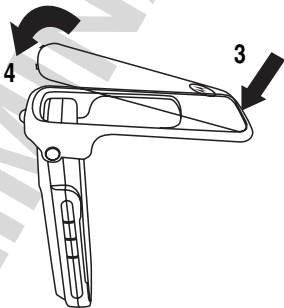

Turning Your Phone On



Action

- 1 Press and hold  (the End/Power key).

End/
Power
key



- 2 If necessary, enter your SIM card PIN code and press **OK** () to unlock your SIM card.

Note: If you enter an incorrect PIN code 3 times in a row, your SIM card is disabled and your phone displays **SIM Blocked**.

- 3 If necessary, enter your 4-digit unlock code and press **OK** () to unlock your phone.

Note: The unlock code is originally set to 1234. (For more information, see page 42.)

Adjusting the Volume

Press up and down on volume keys or right and left on the  to:

- increase and decrease earpiece volume during a call

Volume
keys



- increase and decrease the ringer volume setting when the idle display is visible (flip must be open)

Tip: At the lowest volume setting, press the down volume key once to switch to vibrate alert. Press it again to switch to silent alert. Press the up volume key to switch back to vibrate alert, then ring alert.

- turn off an incoming call alert





Making a Call

Note: Do not block the built-in antenna in the top of your phone while you are on a call.

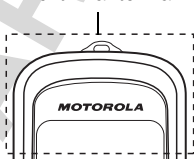
Built-in antenna





Press	To
1 keypad keys	dial the phone number
	Tip: If you make a mistake, press DELETE (☒) to delete the last digit, or press and hold DELETE (☒) to delete all digits.
2 	make the call
3 	end the call and “hang up” the phone

Answering a Call

When you receive a call, your phone rings and/or vibrates and displays an incoming call message.



Press	To
1 	answer the call
or	
ANSWER 	
2  (end key)	hang up when the call is done

Tip: You can answer a call by opening the phone if you turn on the **Open to Answer** option (see page 47).

Note: If the phone is locked, you must unlock it to answer the call.

Viewing Your Phone Number

To view your phone number from the idle display, press  .

While you are on a call, press  > **My Tel. Numbers**.

Note: You must store your phone number on your SIM card to use this feature. To store your phone number on your SIM card, see page 45. If you do not know your phone number, contact your service provider.

Learning to Use Your Phone

See page 1 for a basic phone diagram.

Using the Display

The *idle display* (shown below) is the standard display when you are not on a call or using the menu.

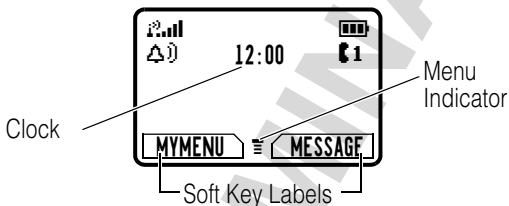

The ≡ (menu) indicator at the bottom center of the display indicates you can press the menu key (Ⓜ) to display the main menu to see more features.

Labels at the bottom corners of the display show the current soft key functions. Press the left soft key (Ⓛ) or right soft key (Ⓡ) to perform the function indicated by the left or right soft key label.



The following status indicators can appear:

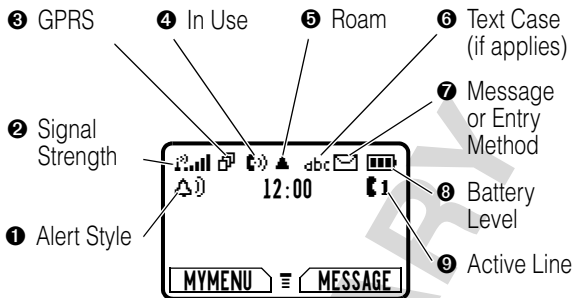

1 Alert Style Indicator Shows the currently selected alert style. The default alert style is **Loud Ring**.



2 Signal Strength Indicator Indicates the strength of your phone's connection with the network.





You cannot make or answer calls when the “no signal” indicator displays.



3 GPRS Indicator Indicates that your phone is using a high-speed GPRS network connection (G). GPRS allows faster data transfer speeds. The indicator does not mean that you are in a call; only that you are registered on the

network with a GPRS connection. Other possible indicators:

-  GPRS PDP context active  GPRS packet data available

4 In Use Indicator Indicates when you are on a call, and when you have a secure (Ⓜ) or insecure (Ⓜ) connection.



5 Roam Indicator Indicates when your phone uses another network outside your home network (▲). When you leave your home network area, your phone *roams* or seeks

another network.

6 Text Case Indicator Indicates the text case when you are in a text editor.

- abc No capital letters ABC All capital letters
Abc Next letter capital

To change the case, press  (see page 38).



7 Message or Entry Method Indicator

Indicates when you have an active Chat session, or when you have a new voice (☎) or text (✉) message waiting. When you enter a text message, a number here indicates how many more characters can fit in the message.



Any time you enter text, an icon here indicates the entry method: **Symbol** (!@#), **Numeric** (123), **Primary**, or **Secondary**:



Primary	Secondary	
1	2	Tap, no capital letters
1↕	2↕	Tap, next letter capital
1↑	2↑	Tap, all capital letters
☐	☐	iTAP, no capital letters
☐↕	☐↕	iTAP, next letter capital
☐↑	☐↑	iTAP, all capital letters

To change the entry method, press  (see page 38).

⑧ Battery Level Indicator Shows the amount of charge left in your battery. The more bars visible, the greater the charge.

High     Low

Recharge your battery as soon as possible when you see the **Low Battery** warning message and hear the low battery alert.

⑨ Active Line Indicator Shows  or  to indicate the currently active phone line.

Using the 4-Way Navigation Key

Use the 4-way navigation key like a joystick to navigate the menu system, change feature settings, change feature settings, and play games.

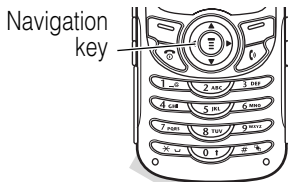

Tip: Down and up are the primary movements within menus. Move left and right to change feature settings, navigate the datebook, and edit text.



PRELIMINARY

Using Menus

From the idle display, press  to display the main menu.

Left Soft Key
Perform functions identified by left display prompt.

Right Soft Key
Perform functions identified by right display prompt.

Power/End Key
Press and hold to power phone on and off.
Press and release to end phone calls, exit menus.

Menu Key
Enter menu system or open a sub-menu.

Navigation Key
Scroll through menus and lists, set feature values.

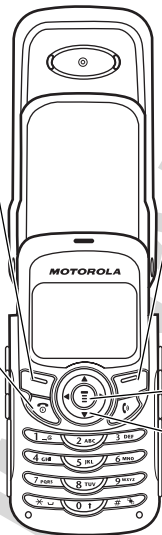



Selecting a Menu Feature

From the idle display, select a menu feature as follows:

Find the Feature

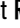
 > **Recent Calls**
> **Dialed Calls**

This example shows that from the idle display, you must press , scroll to and select **Recent Calls**, then scroll to and select **Dialed Calls** to display the dialed calls list. Use  to scroll, and the left/right soft keys to perform the functions in the bottom left and right corners of the display.

Selecting a Feature Option

Some features require you to select an item from a list:

Press **BACK** (⏪) to show the previous screen.

Press (⏮) to open the sub-menu.

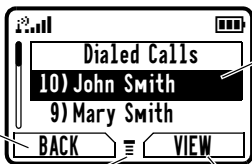

Highlighted item

Press **VIEW** (⏮) to show details for the highlighted item.

- Press (⬆) to scroll up or down to highlight an item.
- In a numbered list, press a number key to highlight the item.
- In an alphabetized list, press a key repeatedly to cycle through the letters on the key and highlight the closest matching list item.
- When an item has a list of possible values, press (⬅) left or right to scroll and select a value.
- When an item has a list of possible numeric values, press a number key to set the value.



Entering Text

Some features require you to enter information.

Press  to scroll down to additional items.

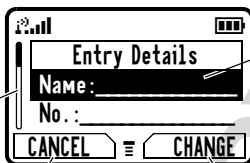

Highlighted item

Press **CANCEL** () to exit without making changes. **DONE** () displays when you enter or edit information.

Press **CHANGE** () or number keys to edit the information.

The message center lets you compose and send text messages. A *flashing cursor* shows where text will appear:

Flashing cursor indicates insertion point.

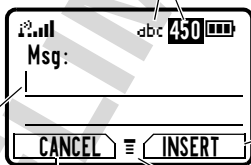

For indicators, see page 24



Press **INSERT** () to view and insert stored text or objects.

Press **CANCEL** () to exit without making changes.

Press  to open the sub-menu.

Using the Tap Method

This is the standard method for entering text on your phone.

Press	To
1 A number key (one or more times)	select a letter, number, or symbol shown in the chart on page 32.
2 Number keys	enter remaining characters Tip: Press  right to accept a word completion, or  to insert a space
3 OK 	store the text

In a text entry screen, you can press  to switch entry methods. An indicator tells you which method is active (see page 24). If **Tap Method** (1 or 2) is not available, see page 38.



When you enter text using the standard tap method, the flashing cursor changes to a *block cursor*, and the soft key functions change:

Block cursor indicates currently highlighted character.

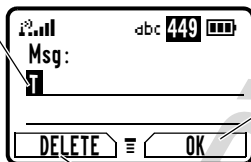

Press **OK** (OK icon) to accept and store the text.

After 2 seconds, the block cursor reverts to a flashing cursor and moves to the next position.

Press **DELETE** (DELETE icon) to delete the character to the left of the insertion point.

When you enter 3 or more characters in a row, your phone may guess the rest of the word. For example, if you enter **prog** you might see:

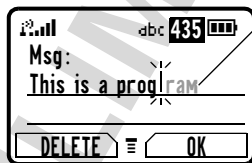







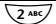

In **Tap**, press (Tap icon) right to accept the word, or press (Reject icon) to reject it and enter a space after **prog**.

If you want a different word, such as **progress**, continue pressing number keys to enter the remaining characters.

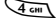
Character Chart

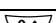
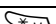

Use this chart as a guide for entering characters with the tap method.

	. 1 0 ? ! , @ _ & ~ : ; " - () ' ` ; % £ \$ ¥ ¤ € + x * / \ [] = > < # §
--	---

	a b c 2 ä å á à â ã α β ç
	d e f 3 ð ë é è ê Æ
	g h i 4 ï î ÿ
	j k l 5 λ
	m n o 6 ñ ö ø ó ò ô õ ω
	p q r s 7 π β σ
	t u v 8 θ ü ú û û
	w x y z 9 ξ ψ
	<i>change text case, for capital letters</i>
	<i>enter a space (hold to enter a return)</i>
	<i>change text entry method (hold for default)</i>

Note: This chart may not reflect the exact character set available on your phone. In an email address or URL editor,  shows the common characters for that editor first.

Tap Method Text Entry Rules

- Press a number key repeatedly to cycle through its characters. See the chart on page 32.
- If you do not press a key for 2 seconds, the character in the block cursor is accepted, and the cursor moves to the next position.
- Press  left or right to move the flashing cursor to the left or right in a text message.
- The first character of every sentence is capitalized. Press  down to force the character to lowercase while it is highlighted by the block cursor.



- Your phone may support multiple languages. The current language setting determines whether a new message begins on the left or right side of the display.
- If you enter or edit information and do not want to save the changes, press  to exit without saving.

Using the iTAP™ Method

iTAP™ software provides a predictive text entry method that lets you enter a word using one key press per letter. This can be faster than the **Tap Method**, because your phone combines the key presses into common words.

For example, if you press    , letter combinations that match your key presses appear:

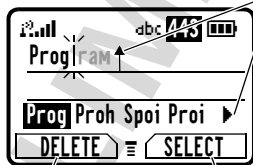

Press  up to accept **Program**, or right to highlight another option. Press  to enter **Prog** and a space.

Press **DELETE** () to clear the last letter entered.



Press **SELECT** () to insert the highlighted word.

If you want a different word, such as **progress**, continue pressing number keys to enter the remaining characters.

Entering Words

In a text entry screen, you can press  to switch entry methods. An indicator tells you which method is active

(see page 24). If iTAP (☐☐ or ☐☐) is not available, see page 38.



	Press	To
1	Number keys (one press per letter)	show possible letter combinations at the bottom of the display
2	 right or left	highlight the combination you want
3	SELECT 	lock a highlighted combination You can press number keys to add more letters to the end of the combination.
	or 	enter the highlighted combination when it spells a word A space appears after the word.





If you enter a word your phone does not recognize, your phone stores it to use as one of your word options. When you fill memory space for unrecognized words, your phone deletes the oldest words as you add new words.







Using the Symbol Method







In a text-entry screen, press  to switch entry methods until you see the Symbol icon () in the status bar.

	Press	To
1	Number keys (one press per symbol)	show possible symbol combinations at the bottom of the display
2	 right or left	highlight the combination you want
3	SELECT ()	lock a highlighted combination
		You can press number keys to add more symbols to the end of the combination
	or	
		enter the highlighted combination
		A space appears after the combination.

Symbol Chart

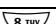
Use this chart as a guide for entering symbols in symbol method.

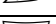
	. ? ! , @ _ & ~ : ; " - () ' ` ; % £ \$ ¥ ¢ €
	@ _ \
	/ : ;
	" & '

	() [] {}
	! @ ~
	< > =
	\$ £ ¥ ¢ €
	# % *
	+ - x * / = > < # §
	enter a space (hold to enter a return)
	change text entry method (hold for default)

Note: In an email address or URL editor,  shows the common characters for that editor first.

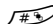

Using the Numeric Method

In a text entry screen, press  to switch entry methods until you see the Numeric icon (123) in the status bar.

Press keypad keys to enter the numbers you want. When you finish entering numbers, press  to switch to another entry method.

Deleting Letters and Words

Place the cursor to the right of the text you want to delete, and then:

Do This	To
Press DELETE ()	delete one letter at a time
Hold DELETE ()	delete the entire message



Choosing a Text Entry Method

Multiple text entry methods make it easy for you to enter names, numbers, and messages. The method you select remains active until you select another method.

Press  in any text entry screen to change to one of the following entry methods:

Primary	The primary text entry method you set up (see the next section).
Numeric (123)	Enter numbers only.
Symbol (@#?)	Enter symbols only (see page 36).
Secondary	The secondary text entry method you set up (see the next section).

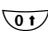
Press  in any text entry screen to change your entry *case*. An icon in the status bar indicates when you select *no capital letters* (abc), *next letter capital only* (Abc), or *all capital letters* (ABC).

Setting Up a Text Entry Method

To set the primary or secondary text entry methods, press  > **Entry Setup** from any text entry screen. Select **Primary Setup** or **Secondary Setup**, and choose:

(None)	Hide the Secondary setting (only available for Secondary Setup).
iTAP	Let the phone predict each word as you press keys (see page 34).

Tap Method

Enter letters, numbers, and symbols by pressing a key 1 or more times (see page 31).

Using Your Phone While it is Closed

When your phone is closed, you can still see the display.

You can use the volume keys and the smart key to do the following tasks, even though the keypad is covered.

Volume
Keys
scroll

Smart
Key
selects

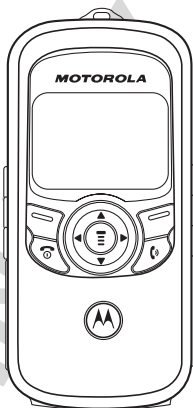

Opening the Quick Menu

When your phone is closed and idle, press the smart key to see these options. Use the volume keys to scroll through options, and the smart key to select an option:

Option	Description
Ring Style	lets you choose a style of ring tones and alerts (see page 46)
Club Lights	lets you activate the flashing lights (see page 47)

Option	Description
Voice Dial *	opens your voice dial list (see page 68)
Received Calls *	opens the list of received calls
Dialed Calls *	opens the list of received calls

* Available only if a headset is plugged into the phone

Answering an Incoming Call

When a call arrives while your phone is closed, your phone rings and/or vibrates and shows an incoming call message. If you have a headset or other hands-free device plugged into your phone:

Action	To
Press the smart key	answer the call
Press either volume key	silence the call alert without cancelling the call
Press and hold the smart key	cancel the call

Tip: You can answer a call by opening the phone if you turn on the **Open to Answer** option (see page 47).

Note: If the phone is locked, you must unlock it to answer the call.

Returning an Unanswered Call

Your phone keeps a record of unanswered calls and displays **X Missed Calls**.

Press	To
1 smart key	see the received calls list Note: Press either volume key to dismiss the reminder.
2 volume keys	select a call in the received calls list
3 smart key	make the call

Note: Because the microphone and earpiece are unavailable when the phone is closed, you must use a headset or other hands-free device with this feature.

Using the Smart Key

The smart key provides another way to perform many basic phone functions. It anticipates the next action you are likely to perform. For example, when you highlight a menu item, you can press the smart key to select it. You can use the smart key to make and end calls, toggle features on and off, and open your phonebook. The smart key usually performs the same function as the right soft key (☐).

Tip: The smart key provides an optional way to do some things faster. It is never the only way to perform a task.



Locking and Unlocking Your Phone

You can lock your phone manually or set it to lock automatically whenever you turn it off.

A locked phone still rings or vibrates for incoming calls or messages, *but you must unlock it to answer*. To use a locked phone, enter the unlock code.



You can make emergency calls on your phone even when it is locked. See page 54.

Locking Your Phone Manually

Find the Feature

ⓘ > Settings > Security
> Phone Lock
> Lock Now

Press	To
1 keypad keys	enter your 4-digit unlock code
2 OK (⏏)	lock the phone

Unlocking Your Phone

At the **Enter UnLock Code** prompt:

Press	To
1 keypad keys	enter your 4-digit unlock code
	The unlock code is originally set to 1234. If necessary, see “If You Forget a Code or Password” on page 44.

Press	To
2 OK (☞)	unlock your phone

Setting Your Phone to Lock Automatically

You can set your phone to lock every time you turn it off.

Find the Feature

⊞ > Settings > Security
> Phone Lock
> Automatic Lock > On

Press	To
1 keypad keys	enter your 4-digit unlock code
2 OK (☞)	set the phone to lock automatically

Changing a Code or Password

Your 4-digit unlock code is originally set to 1234, and the 6-digit security code is originally set to 000000. Your service provider may reset these numbers before you receive your phone.

If your service provider has *not* reset these numbers, we recommend that you change them to prevent others from accessing your personal information or modifying your phone settings. The unlock code must contain 4 digits, and the security code must contain 6 digits.

Find the Feature

⊞ > Settings > Security
> New Passwords





If You Forget a Code or Password

If you forget your security code (originally set to 000000), SIM PIN, SIM PIN2, or call barring password, contact your service provider.



If you forget your unlock code, try entering 1234 or the last 4 digits of your phone number. If that does not work, do the following when you see the **Enter Unlock Code** message:



Press	To
1 	go to the unlock code bypass screen
2 keypad keys	enter your security code
3 OK 	submit your security code

Locking and Unlocking the Keypad

You can lock the keypad to prevent accidental key presses (for example, when carrying your phone in a purse or pocket).

Press	To
 	lock or unlock the keypad

Note: Incoming calls and messages unlock the keypad.

Setting Up Your Phone

Storing Your Name and Phone Number

To store or edit your name and phone number information on your SIM card:

Find the Feature

- ⊖ > Settings
- > Phone Status
- > My Tel. Numbers

If you do not know your phone number, contact your service provider. To view your phone number from the idle display or during a call, see page 22.

Setting the Time and Date

To use the datebook, you must set the time and date.

Find the Feature

- ⊖ > Settings
- > Other Settings
- > Initial Setup
- > Time and Date



Setting an Alert Style

Your phone can ring or vibrate when you receive a call, message, or other event. This is called an *alert*. An indicator in the display shows the current alert style:

 **Loud Ring**

 **Vibrate**

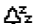
 **Silent**



 **Soft Ring**

 **Vibe&Ring**

To set an alert style:

Find the Feature

⊖ > **Alert Styles**
> **Ring Style**

Press	To
1 	scroll to the style
2 SELECT ()	select the style

Tip: You can choose a single theme to set your wallpaper, screen saver, alert style, and other settings. From idle, press ⊖ > **Media Center** > **Theme** and select a theme.

Each alert style has settings for specific event alerts and ringer and keypad volume. To change these settings:

Find the Feature

⊖ > **Alert Styles**
> **Loud Detail**

Loud changes to the name of the current Ring Style.

Note: *Some ring tones vibrate automatically.* If you use one of these tones, your phone vibrates even when it is not set to **Vibrate** or **Vibe&Ring**. To turn off these vibrations, see page 71.

Tip: You can make your phone flash when you receive a call or message from someone in your phonebook. See page 69.

Setting Answer Options

You can use different methods to answer an incoming call.

Find the Feature

- ⊞ > Settings
- > In-Call Setup
- > Answer Options

The **Answer Options** menu includes:

- Multi-Key** answer by pressing any key
- Open to Answer** answer by opening the flip

Activating Club Lights

Club Lights make your phone's display, keys, and side band flash in beat with music or noise around you. You can activate Club Lights for up to 10 minutes.

Find the Feature

- ⊞ > Settings
- > Other Settings
- > Personalize
- > Club Lights

Setting	Description
Pattern	choose a light pattern to activate Club Lights, or turn the lights Off
Timer	set how many minutes Club Lights will stay active (up to 10 minutes)



Setting	Description
Sensitivity	set how loud the music has to be before Club Lights respond (1 to 7)

Notes:

- Club Lights only work when your phone is idle and your battery is not low. Club Lights pause if you press a key or receive a call or message.
- Your phone can also flash for incoming calls and messages (see page 69). Some games might make your phone flash and vibrate.

Tip: To create a shortcut to the **Club Lights** feature, highlight it, then press and hold .

To use a shortcut, press  > **Shortcuts** in idle.

Setting a Wallpaper Image

You can set a picture or an animation as a wallpaper (background) image in your phone's idle display.

Note: When you set an animation as a wallpaper image, only the first frame of the animation displays.

Find the Feature

-  > **Settings**
- > **Other Settings**
- > **Personalize**
- > **Wallpaper**

Setting	Description
Picture	select the picture or animation for the background image in your idle display
Layout	select Center or Tile

Tip: You can choose a single theme to set your wallpaper, screen saver, alert style, and other settings. From idle, press **⌘** > **Media Center** > **Theme** and select a theme.

Selecting a Screen Saver

You can set a picture or an animation as a screen saver image. The image displays when the phone detects no activity for a specified time.

The screen saver image shrinks to fit the display, if necessary. An animation repeats for 1 minute, then the first frame of the animation displays.

Find the Feature

- ⌘ > **Settings**
- > **Other Settings**
- > **Personalize**
- > **Screen Saver**

Setting	Description
Picture	select the picture that appears when your phone is idle
Delay	select how long your phone must be idle before the screen saver picture appears

Tip: You can choose a single theme to set your wallpaper, screen saver, alert style, and other settings. From idle, press **⌘** > **Media Center** > **Theme** and select a theme.



Setting Display Color

You can select the color palette that your phone uses to display indicators, highlights, and soft key labels.

Find the Feature

- ⊖ > Settings
- > Other Settings
- > Personalize
- > Color Style

Setting Display Contrast

Find the Feature

- ⊖ > Settings
- > Other Settings
- > Initial Setup
- > Contrast



Adjusting the Backlight

You can set the amount of time that the display backlight remains on, or turn off the backlight to conserve battery power.

Find the Feature

- ⊖ > Settings
- > Other Settings
- > Initial Setup
- > Backlight

Zooming In and Out

Press and release ⊖, then press and hold ⊖ to zoom in and out on the display. Zoom in to increase text size, zoom out to display more information.

You can also zoom in and out from the menu.

Find the Feature

- ⊖ > Settings
- > Other Settings
- > Initial Setup > Zoom

Conserving Battery Power



Some networks and phones include a battery save setting to conserve battery power.

Find the Feature

- ⊖ > Settings
- > Other Settings
- > Initial Setup
- > Battery Save



Calling Features

For basic instructions on how to make and answer calls, see page 21.

Changing the Active Line



Change the active phone line to make and receive calls from your other phone number.

Find the Feature

- ⊖ > Settings
- > Phone Status
- > Active Line

The active line indicator in the display shows the current active phone line (see page 24).

Redialing a Number

From the idle display:

Press	To
1	view the dialed calls list
2	scroll to the entry you want
3	redial the number



Using Caller ID



Calling line identification (caller ID) displays the phone number for incoming calls.

For **Incoming Calls**: The phone displays the caller's name when the name is stored in your phonebook, or **Incoming Call** when caller ID information is not available.

For **Outgoing Calls**: Other phones can display your phone number when you call them or send a message. To hide your number for the next call or message, press **Ⓢ > Settings > In-Call Setup > My Caller ID > Next Call Only**.

Canceling an Incoming Call

While the phone is ringing or vibrating:

Press	To
IGNORE (📞)	cancel the incoming call



Depending on your phone settings and the type of subscription you have, the call may be forwarded to another number, or the caller may hear a busy signal.



Turning Off a Call Alert

You can turn off your phone's incoming call alert before answering the call:

Press	To
 up or down	turn off the alert

Calling an Emergency Number

Your service provider programs one or more emergency phone numbers (such as 112 or 911) that you can call under any circumstances, even when your phone is locked.

Note: Emergency numbers vary by country. Your phone's emergency number(s) may not work in all locations, and sometimes an emergency call cannot be placed due to network, environmental, or interference issues.

Press	To
1 keypad keys	dial the emergency number
2 	call the emergency number



Dialing International Numbers

To dial the local international access code:



Action	To
Press  for 2 seconds	insert the international access code (+) for the country from which you are dialing

Viewing the Received Calls or Dialed Calls List

Your phone keeps lists of the calls you recently received and dialed, even if the calls did not connect. The lists are sorted from newest to oldest, and contain up to 10 entries. The oldest entries are deleted as new ones are added.







Shortcut: From the idle display, press  to display the dialed calls list.



Find the Feature  > Recent Calls

Press	To
1 	scroll to Received Calls or Dialed Calls
2 SELECT ()	select the list
3 	scroll to an entry

Note: ✓ means the call connected.



Press	To
4 	call the entry's number
	Note: Press and hold  for 2 seconds to send the number as DTMF tones during a call.
or	
	if View appears above the  key—view the entry's details
	if Store appears above the  key—store the entry's details in the phonebook
or	
	open the Last Calls Menu to perform other procedures in the following list



Option	Description
Store	Create a phonebook entry with the selected number in the No. field. (This option does not appear if STORE appears above the  key, or if the number is already stored as a phonebook entry.)
Delete	Delete the entry. (This option does not appear if DELETE appears above the  key.)
Delete All	Delete all entries in the current list.

Option	Description
Hide ID/Show ID	Hide (or show) your caller ID for the next call.
Send Message	Create a new text message, with the selected number in the Te1 No. field. See page 10.
Add Digits	Add digits to the end of the selected number.
Attach Number	Attach another number from the phonebook or recent calls list to the end of the selected number.

Returning an Unanswered Call

Your phone displays the following for unanswered calls:

- the  (missed call) indicator
- **X Missed Calls**, where *X* is the total number of missed calls

Press	To
1 VIEW 	see the received calls list, beginning with the most recent call
2 	scroll through the list and select a call that you want to return
3 	make the call



Using the Notepad

Your phone stores the most recent string of digits entered on the keypad in a temporary memory location called the *notepad*. This can be a phone number that you called, or a number that you entered but did not call. To retrieve the number stored in the notepad:

Find the Feature

☎ > Recent Calls
> Notepad

Press	To
☎	call the number
or	
☎	open the Dialing Menu to attach a number or insert a special character.
or	
STORE (☎)	create a new phonebook entry, with the notepad number copied into the No. field.

See “Creating a Phonebook Entry” on page 29.

Attaching a Number



While dialing (with digits visible in the display):

Press	To
☎ > Attach Number	attach a number from the phonebook or recent calls list to the end of the digits you entered



Calling With Speed Dial

Each entry in your phonebook is assigned a unique *speed dial* number that identifies where the entry is stored in phone memory or on the SIM card. To speed dial a phonebook entry, in the idle display:

Press	To
1 keypad keys	enter the speed dial number for the entry you want to dial
2 	submit the number
3 	call the entry

Calling With 1-Touch Dial

To call phonebook entries 1 through 9 from the idle display, press and hold the 1-digit speed dial number for 1 second.

Tip: You must specify which phone number list you want to use with this feature: phone memory phonebook, or SIM card phonebook. See the Reference Guide.

Using Voicemail



You can listen to your voicemail messages by calling your network voicemail phone number. Voicemail messages are stored on the network—not on your phone.



Storing Your Voicemail Number

Storing your voicemail number in your phone makes it easy for you to listen to new voicemail messages. Your voicemail number is provided by your service provider.

Find the Feature

☰ > Messages

☰ > VoiceMail Setup

Press	To
1 keypad keys	enter the phone number for your voicemail
2 OK (☑)	store the number

Note: You cannot store pause, wait, or n characters in this number. If you want to store a voicemail number with these characters, create a phonebook entry for it. Then, you can use the entry to call your voicemail. For more about these characters, see page 69.

Receiving a New Voicemail Message

When you receive a voicemail message, your phone displays ☑ (voice message waiting) and **New VoiceMail**. Some networks only indicate when you have messages, whether they are new or not.

Press	To
CALL (☑)	call the voicemail phone number you stored and listen to the message



Listening to a Voicemail Message





Find the Feature ☰ > Messages > VoiceMail

Your phone calls your voicemail number. If no voicemail number is stored, the phone prompts you to store one.

Using Call Waiting



When you are on a call, an alert tone sounds to indicate that you have received a second call.

Press	To
1 	answer the new call
2 SWITCH 	switch back to the first call
or	Note: You can press SWITCH  at any time to switch between calls.
LINK 	connect the two calls

You must turn on call waiting to use this feature. To turn call waiting on or off:

Find the Feature ☰ > Settings
> In-Call Setup
> Call Waiting



Putting a Call on Hold

Press	To
HOLD (☎) (if available)	put a call on hold
or	Your phone displays a 📞 (flashing phone) indicator to indicate the call is on hold.
☰ > Hold	

Transferring a Call

While you are on a call, you can transfer the call to another phone by first talking to the person who answers the other phone, or by directly transferring the call.

Announcing the Call Transfer

Find the Feature ☰ > Hold

Press	To
1 keypad keys	enter the phone number where you are transferring the call
2 📞	dial the phone number Speak to the person who answers the target phone.
3 ☰	open the menu
4 🔄	scroll to Transfer
5 SELECT (☎)	select Transfer



Press	To
6 OK (☞)	confirm the transfer Your phone displays the message Transfer: Complete when it transfers. You can hang up the phone when you see this message.

Not Announcing the Call Transfer

Find the Feature

☰ > Transfer

















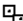

Press	To
1 keypad keys	enter the phone number where you are transferring the call
2 ☞	dial the phone number Your phone displays the message Transfer: Complete when it transfers. You can hang up the phone when you see this message.



Phone Features

Main Menu

This is the standard main menu layout. **Menu organization and feature names may vary on your phone.** Not all features may be available for all users.

-  **Voice Dial**
-  **Phonebook**
-  **Recent Calls**
 - Received Calls
 - Dialed Calls
 - Notepad
 - Call Times
 - Call Cost
 - Data Times
 - Data Volumes
-  **Chat ***
-  **Alert Styles**
 - Ring Style
 - *alert* Detail
 - Ring Lights
 - Event Lights
-  **Media Center**
 - Theme
 - Pictures
 - Sound
 - MotoMixer
-  **Games & Apps**
-  **WebAccess**
 - Web Browser
 - Web Shortcuts
 - Stored Pages
 - History
 - Go to URL
 - Web Sessions
 - Browser Setup
-  **Office Tools**
 - Datebook
 - Calculator
- More** 
 -  **Alarm Clock**
 -  **Settings**
 - (see next page)
 -  **MyMenu**
 -  **Messages ***
 - Create Message
 - Voicemail
 - Message Inbox
 - Browser Msgs
 - Info Services
 - Quick Notes
 - Outbox
 - Drafts
 -  **SIM Applications ***
 -  **Fixed Dial**
 -  **Service Dial ***
 -  **Quick Dial**
 -  **Java Tools**
 - Java App Loader
 - Java System
 - Network Access
 - DNS IP

Note: Select **More** when it appears in the menu to see more menu items.

* optional network, SIM card, or subscription-dependent features

Settings Menu

Call Forward *

- Voice Calls
- Fax Calls
- Data Calls
- Cancel All
- Forward Status

Phone Status

- My Tel. Numbers *
- Credit Info/Available *
- Active Line
- Battery Meter
- Other Information

In-Call Setup

- In-Call Timer
- Call Cost Setup *
- My Caller ID
- Talk and Fax *
- Answer Options
- Call Waiting *

Security

- Phone Lock
- Lock Keypad
- Lock Application
- Fixed Dial
- Call Barring *
- SIM PIN
- New Passwords

Other Settings

- Personalize
 - Club Lights
 - Main Menu
 - Keys
 - Color Style
 - Greeting *
 - Wallpaper
 - Screen Saver
 - Quick Dial *
- Initial Setup
 - Time and Date
 - 1-Touch Dial
 - Backlight
 - Zoom
 - TTY Setup
 - Scroll
 - Animation
 - Haptics
 - Language
 - Battery Save
 - Contrast
 - DTMF
 - Master Reset
 - Master Clear
- Network
 - New Network
 - Network Setup
 - Available Networks
 - My Network List
 - Service Tone
 - Call Drop Tone
- Car Settings
- Headset

Note: This is the standard phone menu layout. Menu organization and feature names may vary on your phone. Not all features may be available for all users.

* optional network, SIM card, or subscription-dependent features

Shortcuts

Open **Phonebook**:

Press  ▲ or ▼ in idle

Set **Ring Volume**:

Press  ◀ or ▶ in idle

Change **Display Zoom**:

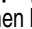
Press , then hold 







Feature Quick Reference

You can do more with your phone than make and receive phone calls! For example, you can:

- store frequently called numbers in the phonebook for easy dialing
- organize your meetings and other events in the datebook
- browse the Web
- download applications
- send messages

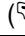
This section provides information to help you use features on your phone that are not described in this user guide. For more detailed information, see the reference guide.

Calling Features

Feature	Description	
Conference Call	During a call: ☎ > Hold , dial next number, press  , press LINK ()	
Call Forwarding	Set up or cancel call forwarding: ☎ > Settings > Call Forward	
Call Barring	Restrict outgoing or incoming calls: ☎ > Settings > Security > Call Barring	

Feature	Description
TTY Calls	Set up your phone for use with an optional TTY device:  Ⓜ > Settings > Other Settings > Initial Setup > TTY Setup

Message Features

Feature	Description
Send Message	Send a text message: Ⓜ > Messages > Create Message To enter text, see page 30.
Insert Pictures and Sounds	While composing a message: Ⓜ > Insert
Received Messages	Read received messages: Ⓜ > Messages > Message Inbox Press Ⓜ to perform various operations on the selected message.
Store Pictures and Sounds	Highlight a picture or sound in a message, then: Ⓜ > Store

Chat Features

Feature	Description
Start Chat	Start a new chat session: Ⓜ > Chat Ⓜ > New Chat



Feature	Description
Receive Chat Request	When you receive a chat request: Press ACCEPT (☞) or IGNORE (☞)
End Chat	During a chat session: ☹ > End Chat

Phonebook Features

Feature	Description
Create Entry	Create a new phonebook entry: ☹ > Phonebook ☹ > New > Phone Number or Email Address
Dial Number	Call a number in the phonebook: ☹ > Phonebook > <i>entry to call</i> ☞
Voice Dial Number	Voice dial a number in the phonebook: Press ☹ > Voice Dial , and say the entry's name (in 2 seconds)



Feature	Description
Store a PIN Code in a Number	<p>While entering the number: Ⓜ > Insert Pause, Wait, or 'n'</p> <p>Pause: waits for the call to connect, then sends the remaining digit(s). If your network does not recognize the first pause character, try two (pp).</p> <p>Wait: waits for the call to connect, then prompts you for confirmation before it sends the remaining digit(s).</p> <p>'n': prompts you for a number before dialing the call. The number you enter is inserted into the dialing sequence in place of the n character</p>
Phonebook Categories	<p>You can put phonebook entries into categories. When you get a call or message from someone in a category, your phone uses the category's special ring or flashing lights.</p> <p>To set up a category, press Ⓜ > Phonebook Ⓜ > Categories. Scroll to the category, then press Ⓜ > Edit</p> <p>To set an entry's category, press Ⓜ > Phonebook > <i>entry to edit</i>, then press EDIT (✉).</p>



Feature	Description
1-Touch Dial	Set 1-touch dial to call entries stored in your phone memory phonebook or the SIM card phonebook: Ⓜ > Settings > Other Settings > Initial Setup > 1-Touch Dial

Personalizing Features

Feature	Description
Event Alert	Change an event alert: Ⓜ > Alert Styles > <i>alert Detail</i> > <i>event name</i>
Ring Volume	Adjust ringer volume: Ⓜ > Alert Styles > <i>alert Detail</i> > Ring Volume
Keypad Volume	Adjust keypad key press volume: Ⓜ > Alert Styles > <i>alert Detail</i> > Key Volume
My Tones	Compose your own ring tones, manage ring tones that you have composed or downloaded: Ⓜ > Media Center > MotoMixer
Themes	Apply the wallpaper, screen saver, alert style, and other settings in a theme: Ⓜ > Media Center > Theme

Feature	Description
Haptic Vibrations	Turn on or off the vibrations in special games and ring tones: ⌘ > Settings > Other Settings > Initial Setup > Haptics
Main Menu	Reorder your phone's main menu: ⌘ > Settings > Other Settings > Personalize > Main Menu
Soft Keys	Change soft key labels in the idle display: ⌘ > Settings > Other Settings > Personalize > Keys
Shortcuts	Create a shortcut to a menu item: Highlight the menu item, then press and hold ⌘. Select a shortcut: ⌘ > MyMenu > <i>shortcut name</i>



Menu Features

Feature	Description
Language	Set menu language: ⌘ > Settings > Other Settings > Initial Setup > Language
Master Reset	Reset all options <i>except</i> unlock code, security code, lifetime timer: ⌘ > Settings > Other Settings > Initial Setup > Master Reset



Feature	Description
Master Clear	Reset all options <i>except</i> unlock code, security code, lifetime timer, clear all user settings and entries: Ⓜ > Settings > Other Settings > Initial Setup > Master Clear

Dialing Features

Feature	Description	
Fixed Dial	Turn fixed dialing on or off: Ⓜ > Settings > Security > Fixed Dial Use the fixed dial list: Ⓜ > Fixed Dial	
Service Dial	Dial service phone numbers: Ⓜ > Service Dial	
Quick Dial	Dial pre-programmed phone numbers: Ⓜ > Quick Dial	

Feature	Description
DTMF Tones	Activate DTMF tones: Ⓜ > Settings > Other Settings > Initial Setup > DTMF Send DTMF tones during a call: Press number keys Send stored numbers as DTMF tones during a call: Highlight a number in the phonebook or recent call lists, then press Ⓜ > Send Tones

Call Monitoring Features

Network connection time is the elapsed time from the moment you connect to your service provider's network to the moment you end the call by pressing the end key. This time includes busy signals and ringing.

The amount of network connection time you track on your resettable timer may not equal the amount of time for which you are billed by your service provider. For billing information, please contact your service provider directly.

Feature	Description
Call Times	View call timers: Ⓜ > Recent Calls > Call Times



Feature	Description
In-Call Timer	Display time or cost information during a call: Ⓜ > Settings > In-Call Setup > In-Call Timer
Call Cost	View call cost trackers: Ⓜ > Recent Calls > Call Cost



Hands-Free Features

Feature	Description
Auto Answer (car kit or headset)	Automatically answer calls when connected to a car kit or headset: Ⓜ > Settings > Other Settings > Car Settings or Headset > Auto Answer



Data and Fax Call Features

Feature	Description
Send Data or Fax	Connect your phone to the device, then place the call through the device application



Feature	Description
Talk Then Fax	Connect your phone to the device, enter the number, press ☎ > Talk Then Fax , then press ☎ to make the call



Network Features

Feature	Description
Network Settings	View network information and adjust network settings: ☎ > Settings > Other Settings > Network



Personal Organizer Features

Feature	Description
Add Datebook Event	Add an event to the datebook: ☎ > Office Tools > Datebook > <i>day</i> ☎ > New
View Datebook Event	View or edit event details: ☎ > Office Tools > Datebook > <i>day</i> > <i>event name</i>
Respond to Event Reminder	View event when reminder appears: VIEW (☎) Dismiss event reminder: EXIT (☎)



Feature	Description
Set Alarm Clock	<p>You can set alarms to make your phone ring.</p> <p>☰ > Alarm Clock > [New Alarm]</p> <p>Alarms do <i>not</i> appear in the datebook and do not ring if your phone is off.</p>
View Alarm Clock	<p>To see or change an alarm you set:</p> <p>☰ > Alarm Clock > <i>the alarm</i></p> <p>Scroll (⊙) to the alarm. Press the right softkey (☐) to ENABLE or DISABLE the alarm. Press ☰ for more options.</p>
Respond to Alarm	<p>Alarms ring for 30 minutes unless you press</p> <p>DISABLE (☐) to turn off the alarm, or SNOOZE (☐) to snooze for 8 minutes.</p>
Calculator	<p>Calculate numbers:</p> <p>☰ > Office Tools > Calculator</p>
Currency Converter	<p>Convert currency:</p> <p>☰ > Office Tools > Calculator</p> <p>☰ > Exchange Rate</p> <p>Enter exchange rate, press OK (☐), enter amount, select \$ function</p>

Security Features

Feature	Description
SIM PIN	Lock or unlock the SIM card: ☰ > Settings > Security > SIM PIN Caution: If you enter an incorrect PIN code 3 times in a row, your SIM card is disabled and your phone displays SIM Blocked .
Lock Application	Lock phone applications: ☰ > Settings > Security > Lock Application

News and Entertainment Features

Feature	Description
Launch Micro-Browser	Start a micro-browser session: ☰ > Web Access > Browser
Web Sessions	Select or create a Web session: ☰ > Web Access > Web Sessions
Launch Game or Application	Launch a game or application: ☰ > Games & Apps , highlight the application, press SELECT (☑)
Download Game or Application (not China)	Download a game or application: ☰ > Web Access > Browser , find the application, press SELECT (☑), press DWNL (☑)



Feature	Description
Download Game or Application (China only)	Download a game or application: ☰ > Get JavaApps and select a Web Session to open a list of applications you can download.
Network Access	Edit network connection settings for Java games and applications: ☰ > Java Tools
Application Manager	View information about a Java game or application: Highlight the application and press ☰
Java System	View Java version and memory information: ☰ > Java Tools > Java System

Specific Absorption Rate Data

This model phone meets the government's requirements for exposure to radio waves.

Your mobile phone is a radio transmitter and receiver. It is designed and manufactured not to exceed limits for exposure to radio frequency (RF) energy. These limits are part of comprehensive guidelines and establish permitted levels of RF energy for the general population. The guidelines are based on standards that were developed by independent scientific organizations through periodic and thorough evaluation of scientific studies. The guidelines include a substantial safety margin designed to assure the safety of all persons, regardless of age and health.

The exposure standard for mobile phones employs a unit of measurement known as the Specific Absorption Rate, or SAR. Under the guidelines for your phone model, the SAR limit is 2.0 W/kg.¹ Tests for SAR are conducted in accordance with CENELEC² testing procedures using standard operating positions with the phone transmitting at its highest certified power level in all tested frequency bands. Although the SAR is determined at the highest certified power level, the actual SAR of the phone while operating can be well below the maximum value. This is because the phone is designed to operate at multiple power levels so as to use only the power required to reach the network. In general, the closer you are to a base station, the lower the power output of the phone.

Before a phone model is available for sale to the public, it is tested to confirm compliance with the guidelines. The tests are performed in positions and locations (e.g., at the ear and worn on the body) that conform to a uniform testing methodology determined by an expert standards body. The highest SAR value for this model phone when tested for use at the ear is ___ W/kg.³

While there may be differences between the SAR levels of various phones and at various positions, they all meet the governmental requirements for safe exposure. Please note that improvements to this

product model could cause differences in the SAR value for later products; in all cases, products are designed to be within the guidelines.

1. The SAR limit recommended by international guidelines (ICNIRP) for mobile phones used by the public is 2.0 watts/kilogram (W/kg) averaged over ten grams of tissue. The limit incorporates a substantial margin for safety to give additional protection for the public and to account for any variations in measurements.
2. CENELEC is a European Union standards body.
3. Additional related information includes the Motorola testing protocol, assessment procedure, and measurement uncertainty range for this product.

PRELIMINARY

The U.S. Food and Drug Administration's Center for Devices and Radiological Health Consumer Update on Mobile Phones



FDA has been receiving inquiries about the safety of mobile phones, including cellular phones and PCS phones. The following summarizes what is known—and what remains unknown—about whether these products can pose a hazard to health, and what can be done to minimize any potential risk. This information may be used to respond to questions.

Why the concern?

Mobile phones emit low levels of radio frequency energy (i.e., radio frequency radiation) in the microwave range while being used. They also emit very low levels of radio frequency energy (RF), considered non-significant, when in the stand-by mode. It is well known that high levels of RF can produce biological damage through heating effects (this is how your microwave oven is able to cook food). However, it is not known whether, to what extent, or through what mechanism, lower levels of RF might cause adverse health effects as well. Although some research has been done to address these questions, no clear picture of the biological effects of this type of radiation has emerged to date. Thus, the available science does not allow us to conclude that mobile phones are absolutely safe, or that they are unsafe. However, the available scientific evidence does not demonstrate any adverse health effects associated with the use of mobile phones.

What kinds of phones are in question?

Questions have been raised about hand-held mobile phones, the kind that have a built-in antenna that is positioned close to the user's head during normal telephone conversation. These types of mobile phones are

of concern because of the short distance between the phone's antenna—the primary source of the RF—and the person's head. The exposure to RF from mobile phones in which the antenna is located at greater distances from the user (on the outside of a car, for example) is drastically lower than that from hand-held phones, because a person's RF exposure decreases rapidly with distance from the source. The safety of so-called “cordless phones,” which have a base unit connected to the telephone wiring in a house and which operate at far lower power levels and frequencies, has not been questioned.

How much evidence is there that hand-held mobile phones might be harmful?

Briefly, there is not enough evidence to know for sure, either way; however, research efforts are on-going. The existing scientific evidence is conflicting and many of the studies that have been done to date have suffered from flaws in their research methods. Animal experiments investigating the effects of RF exposures characteristic of mobile phones have yielded conflicting results. A few animal studies, however, have suggested that low levels of RF could accelerate the development of cancer in laboratory animals. In one study, mice genetically altered to be predisposed to developing one type of cancer developed more than twice as many such cancers when they were exposed to RF energy compared to controls. There is much uncertainty among scientists about whether results obtained from animal studies apply to the use of mobile phones. First, it is uncertain how to apply the results obtained in rats and mice to humans. Second, many of the studies that showed increased tumor development used animals that had already been treated with cancer-causing chemicals, and other studies exposed the animals to the RF virtually continuously—up to 22 hours per day.

For the past five years in the United States, the mobile phone industry has supported research into the safety of mobile phones. This research has resulted in two findings in particular that merit additional study:

- 1 In a hospital-based, case-control study, researchers looked for an association between mobile phone use and either glioma (a type of

brain cancer) or acoustic neuroma (a benign tumor of the nerve sheath). No statistically significant association was found between mobile phone use and acoustic neuroma. There was also no association between mobile phone use and gliomas when all types of types of gliomas were considered together. It should be noted that the average length of mobile phone exposure in this study was less than three years.

When 20 types of glioma were considered separately, however, an association was found between mobile phone use and one rare type of glioma, neuroepitheliomatous tumors. It is possible with multiple comparisons of the same sample that this association occurred by chance. Moreover, the risk did not increase with how often the mobile phone was used, or the length of the calls. In fact, the risk actually decreased with cumulative hours of mobile phone use. Most cancer causing agents increase risk with increased exposure. An ongoing study of brain cancers by the National Cancer Institute is expected to bear on the accuracy and repeatability of these results.¹

- 2 Researchers conducted a large battery of laboratory tests to assess the effects of exposure to mobile phone RF on genetic material. These included tests for several kinds of abnormalities, including mutations, chromosomal aberrations, DNA strand breaks, and structural changes in the genetic material of blood cells called lymphocytes. None of the tests showed any effect of the RF except for the micronucleus assay, which detects structural effects on the genetic material. The cells in this assay showed changes after exposure to simulated cell phone radiation, but only after 24 hours of exposure. It is possible that exposing the test cells to radiation for this long resulted in heating. Since this assay is known to be sensitive to heating, heat alone could have caused the abnormalities to occur. The data already in the literature on the response of the micronucleus assay to RF are conflicting. Thus, follow-up research is necessary.²

FDA is currently working with government, industry, and academic groups to ensure the proper follow-up to these industry-funded research findings. Collaboration with the Cellular Telecommunications Industry Association

(CTIA) in particular is expected to lead to FDA providing research recommendations and scientific oversight of new CTIA-funded research based on such recommendations.

Two other studies of interest have been reported recently in the literature:

- 1 Two groups of 18 people were exposed to simulated mobile phone signals under laboratory conditions while they performed cognitive function tests. There were no changes in the subjects' ability to recall words, numbers, or pictures, or in their spatial memory, but they were able to make choices more quickly in one visual test when they were exposed to simulated mobile phone signals. This was the only change noted among more than 20 variables compared.³
- 2 In a study of 209 brain tumor cases and 425 matched controls, there was no increased risk of brain tumors associated with mobile phone use. When tumors did exist in certain locations, however, they were more likely to be on the side of the head where the mobile phone was used.

Because this occurred in only a small number of cases, the increased likelihood was too small to be statistically significant.⁴

In summary, we do not have enough information at this point to assure the public that there are, or are not, any low incident health problems associated with use of mobile phones. FDA continues to work with all parties, including other federal agencies and industry, to assure that research is undertaken to provide the necessary answers to the outstanding questions about the safety of mobile phones.

What is known about cases of human cancer that have been reported in users of hand-held mobile phones?

Some people who have used mobile phones have been diagnosed with brain cancer. But it is important to understand that this type of cancer also occurs among people who have not used mobile phones. In fact, brain cancer occurs in the U.S. population at a rate of about 6 new cases per

100,000 people each year. At that rate, assuming 80 million users of mobile phones (a number increasing at a rate of about 1 million per month), about 4800 cases of brain cancer would be expected each year among those 80 million people, whether or not they used their phones. Thus it is not possible to tell whether any individual's cancer arose because of the phone, or whether it would have happened anyway. A key question is whether the risk of getting a particular form of cancer is greater among people who use mobile phones than among the rest of the population. One way to answer that question is to compare the usage of mobile phones among people with brain cancer with the use of mobile phones among appropriately matched people without brain cancer. This is called a case-control study. The current case-control study of brain cancers by the National Cancer Institute, as well as the follow-up research to be sponsored by industry, will begin to generate this type of information.

What is FDA's role concerning the safety of mobile phones?

Under the law, FDA does not review the safety of radiation-emitting consumer products such as mobile phones before marketing, as it does with new drugs or medical devices. However, the agency has authority to take action if mobile phones are shown to emit radiation at a level that is hazardous to the user. In such a case, FDA could require the manufacturers of mobile phones to notify users of the health hazard and to repair, replace or recall the phones so that the hazard no longer exists.

Although the existing scientific data do not justify FDA regulatory actions at this time, FDA has urged the mobile phone industry to take a number of steps to assure public safety. The agency has recommended that the industry:

- support needed research into possible biological effects of RF of the type emitted by mobile phones
- design mobile phones in a way that minimizes any RF exposure to the user that is not necessary for device function

- cooperate in providing mobile phone users with the best possible information on what is known about possible effects of mobile phone use on human health

At the same time, FDA belongs to an interagency working group of the federal agencies that have responsibility for different aspects of mobile phone safety to ensure a coordinated effort at the federal level. These agencies are:

- National Institute for Occupational Safety and Health
- Environmental Protection Agency
- Federal Communications Commission
- Occupational Health and Safety Administration
- National Telecommunications and Information Administration

The National Institutes of Health also participates in this group.

In the absence of conclusive information about any possible risk, what can concerned individuals do?

If there is a risk from these products—and at this point we do not know that there is—it is probably very small. But if people are concerned about avoiding even potential risks, there are simple steps they can take to do so. For example, time is a key factor in how much exposure a person receives. Those persons who spend long periods of time on their hand-held mobile phones could consider holding lengthy conversations on conventional phones and reserving the hand-held models for shorter conversations or for situations when other types of phones are not available.

People who must conduct extended conversations in their cars every day could switch to a type of mobile phone that places more distance between their bodies and the source of the RF, since the exposure level drops off dramatically with distance. For example, they could switch to:

- a mobile phone in which the antenna is located outside the vehicle

- a hand-held phone with a built-in antenna connected to a different antenna mounted on the outside of the car or built into a separate package
- a headset with a remote antenna to a mobile phone carried at the waist

Again, the scientific data do not demonstrate that mobile phones are harmful. But if people are concerned about the radio frequency energy from these products, taking the simple precautions outlined above can reduce any possible risk.

Where can I find additional information?

For additional information, see the following Web sites:

Federal Communications Commission (FCC) RF Safety Program (select “Information on Human Exposure to RF Fields from Cellular and PCS Radio Transmitters”):

<http://www.fcc.gov/oet/rfsafety>

World Health Organization (WHO) International Commission on Non-Ionizing Radiation Protection (select Qs & As): <http://www.who.int/emf>

United Kingdom, National Radiological Protection Board:

<http://www.nrpb.org.uk>

Cellular Telecommunications Industry Association (CTIA):

<http://www.wow-com.com>

U.S. Food and Drug Administration (FDA) Center for Devices and Radiological Health:

<http://www.fda.gov/cdrh/consumer/>

1. Muscat et al. Epidemiological Study of Cellular Telephone Use and Malignant Brain Tumors. In: State of the Science Symposium; 1999 June 20; Long Beach, California.
2. Tice et al. Tests of mobile phone signals for activity in genotoxicity and other laboratory assays. In: Annual Meeting of the Environmental Mutagen Society;

March 29, 1999, Washington, D.C.; and personal communication, unpublished results.

3. Preece, AW, Iwi, G, Davies-Smith, A, Wesnes, K, Butler, S, Lim, E, and Varey, A. Effect of a 915-MHz simulated mobile phone signal on cognitive function in man. *Int. J. Radiat. Biol.*, April 8, 1999.
4. Hardell, L, Nasman, A, Pahlson, A, Hallquist, A and Mild, KH. Use of cellular telephones and the risk for brain tumors: a case-control study. *Int. J. Oncol.*, 15: 113-116, 1999.

PRELIMINARY

Motorola Limited Warranty for the United States and Canada

What Does this Warranty Cover?

Subject to the exclusions contained below, Motorola, Inc. warrants its telephones, pagers, messaging devices, and consumer and professional two-way radios (excluding commercial, government or industrial radios) that operate via Family Radio Service or General Mobile Radio Service, Motorola-branded or certified accessories sold for use with these Products (“Accessories”) and Motorola software contained on CD-ROMs or other tangible media and sold for use with these Products (“Software”) to be free from defects in materials and workmanship under normal consumer usage for the period(s) outlined below. This limited warranty is a consumer's exclusive remedy, and applies as follows to new Motorola Products, Accessories and Software purchased by consumers in the United States or Canada, which are accompanied by this written warranty:

Products and Accessories

Products Covered	Length of Coverage
Products and Accessories as defined above, unless otherwise provided for below.	One (1) year from the date of purchase by the first consumer purchaser of the product unless otherwise provided for below.
Decorative Accessories and Cases. Decorative covers, bezels, PhoneWrap™ covers and cases.	Limited lifetime warranty for the lifetime of ownership by the first consumer purchaser of the product.

Products Covered	Length of Coverage
Monaural Headsets. Ear buds and boom headsets that transmit mono sound through a wired connection.	Limited lifetime warranty for the lifetime of ownership by the first consumer purchaser of the product.
Consumer and Professional Two-Way Radio Accessories.	Ninety (90) days from the date of purchase by the first consumer purchaser of the product.
Products and Accessories that are Repaired or Replaced.	The balance of the original warranty or for ninety (90) days from the date returned to the consumer, whichever is longer.

Exclusions

Normal Wear and Tear. Periodic maintenance, repair and replacement of parts due to normal wear and tear are excluded from coverage.

Batteries. Only batteries whose fully charged capacity falls below 80% of their rated capacity and batteries that leak are covered by this limited warranty.

Abuse & Misuse. Defects or damage that result from: (a) improper operation, storage, misuse or abuse, accident or neglect, such as physical damage (cracks, scratches, etc.) to the surface of the product resulting from misuse; (b) contact with liquid, water, rain, extreme humidity or heavy perspiration, sand, dirt or the like, extreme heat, or food; (c) use of the Products or Accessories for commercial purposes or subjecting the Product or Accessory to abnormal usage or conditions; or (d) other acts which are not the fault of Motorola, are excluded from coverage.

Use of Non-Motorola Products and Accessories. Defects or damage that result from the use of Non-Motorola branded or certified Products, Accessories, Software or other peripheral equipment are excluded from coverage.

Unauthorized Service or Modification. Defects or damages resulting from service, testing, adjustment, installation, maintenance, alteration, or modification in any way by someone other than Motorola, or its authorized service centers, are excluded from coverage.

Altered Products. Products or Accessories with (a) serial numbers or date tags that have been removed, altered or obliterated; (b) broken seals or that show evidence of tampering; (c) mismatched board serial numbers; or (d) nonconforming or non-Motorola housings, or parts, are excluded from coverage.

Communication Services. Defects, damages, or the failure of Products, Accessories or Software due to any communication service or signal you may subscribe to or use with the Products Accessories or Software is excluded from coverage.

Software

Products Covered	Length of Coverage
Software. Applies only to physical defects in the media that embodies the copy of the software (e.g. CD-ROM, or floppy disk).	Ninety (90) days from the date of purchase.

Exclusions

Software Embodied in Physical Media. No warranty is made that the software will meet your requirements or will work in combination with any hardware or software applications provided by third parties, that the operation of the software products will be uninterrupted or error free, or that all defects in the software products will be corrected.

Software NOT Embodied in Physical Media. Software that is not embodied in physical media (e.g. software that is downloaded from the internet), is provided “as is” and without warranty.

Who is Covered?

This warranty extends only to the first consumer purchaser, and is not transferable.

What Will Motorola Do?

Motorola, at its option, will at no charge repair, replace or refund the purchase price of any Products, Accessories or Software that does not conform to this warranty. We may use functionally equivalent reconditioned/refurbished/pre-owned or new Products, Accessories or parts. No data, software or applications added to your Product, Accessory or Software, including but not limited to personal contacts, games and ringer tones, will be reinstalled. To avoid losing such data, software and applications please create a back up prior to requesting service.

How to Obtain Warranty Service or Other Information

USA	Phones 1-800-331-6456 Pagers 1-800-548-9954 Two-Way Radios and Messaging Devices 1-800-353-2729
Canada	All Products 1-800-461-4575
TTY	1-888-390-6456
For Accessories and Software , please call the telephone number designated above for the product with which they are used.	

You will receive instructions on how to ship the Products, Accessories or Software, at your expense, to a Motorola Authorized Repair Center. To obtain service, you must include: (a) a copy of your receipt, bill of sale or other comparable proof of purchase; (b) a written description of the problem; (c) the name of your service provider, if applicable; (d) the name and location of the installation facility (if applicable) and, most importantly; (e) your address and telephone number.

What Other Limitations Are There?

ANY IMPLIED WARRANTIES, INCLUDING WITHOUT LIMITATION THE IMPLIED WARRANTIES OF MERCHANTABILITY AND FITNESS FOR A

PARTICULAR PURPOSE, SHALL BE LIMITED TO THE DURATION OF THIS LIMITED WARRANTY, OTHERWISE THE REPAIR, REPLACEMENT, OR REFUND AS PROVIDED UNDER THIS EXPRESS LIMITED WARRANTY IS THE EXCLUSIVE REMEDY OF THE CONSUMER, AND IS PROVIDED IN LIEU OF ALL OTHER WARRANTIES, EXPRESS OR IMPLIED. IN NO EVENT SHALL MOTOROLA BE LIABLE, WHETHER IN CONTRACT OR TORT (INCLUDING NEGLIGENCE) FOR DAMAGES IN EXCESS OF THE PURCHASE PRICE OF THE PRODUCT, ACCESSORY OR SOFTWARE, OR FOR ANY INDIRECT, INCIDENTAL, SPECIAL OR CONSEQUENTIAL DAMAGES OF ANY KIND, OR LOSS OF REVENUE OR PROFITS, LOSS OF BUSINESS, LOSS OF INFORMATION OR DATA, SOFTWARE OR APPLICATIONS OR OTHER FINANCIAL LOSS ARISING OUT OF OR IN CONNECTION WITH THE ABILITY OR INABILITY TO USE THE PRODUCTS, ACCESSORIES OR SOFTWARE TO THE FULL EXTENT THESE DAMAGES MAY BE DISCLAIMED BY LAW.

Some states and jurisdictions do not allow the limitation or exclusion of incidental or consequential damages, or limitation on the length of an implied warranty, so the above limitations or exclusions may not apply to you. This warranty gives you specific legal rights, and you may also have other rights that vary from state to state or from one jurisdiction to another.

Laws in the United States and other countries preserve for Motorola certain exclusive rights for copyrighted Motorola software such as the exclusive rights to reproduce and distribute copies of the Motorola software. Motorola software may only be copied into, used in, and redistributed with, the Products associated with such Motorola software. No other use, including without limitation disassembly of such Motorola software or exercise of the exclusive rights reserved for Motorola, is permitted.

Product Registration

Online Product Registration:

<http://www.motorola.com/warranty>

Product registration is an important step toward enjoying your new Motorola product. Registering helps us facilitate warranty service, and permits us to contact you should your product require an update or other service. Registration is for U.S. residents only and is not required for warranty coverage.

Please retain your original dated sales receipt for your records. For warranty service of your Motorola Personal Communications Product you will need to provide a copy of your dated sales receipt to confirm warranty status.

Thank you for choosing a Motorola product.

Export Law Assurances

This product is controlled under the export regulations of the United States of America and Canada. The Governments of the United States of America and Canada may restrict the exportation or re-exportation of this product to certain destinations. For further information contact the U.S. Department of Commerce or the Canadian Department of Foreign Affairs and International Trade.

RF Energy Interference

This device complies with Part 15 of the FCC Rules. Operation is subject to the following two conditions: (1) this device may not cause harmful interference, and (2) this device must accept any interference received, including interference that may cause undesired operation.

Index

A

accessories

- connector ports 1
- optional 13, 67
- standard 12

accessory 41

Add Digits feature 57

alarm clock 76

alert

- creating 70
- defined 46
- indicators 24, 46
- personalizing 70
- setting 46
- turning off 21
- volume 70

animation

- inserting in message 67
- storing 67
- wallpaper 48

application, locking and unlocking 77

Attach Number feature 57, 58

B

backlight 50

barring calls 66

battery

Battery Save feature 50

- charging 14–15
- extending battery life
15–16, 50

installing 13

level indicator 15, 24, 26

block cursor, defined 32

C

calculator 76

call

adding digits after phone number 57

alert profile, setting 46

alert, turning off 21

answer options 47

answering 22

barring 66

call waiting 61

canceling 53

costs 74

deleting 55

dialed calls list 55

dialing

dialing a recent call 55

emergency number 54

ending 21, 22

- forwarding 66
- hold 62
- ignoring 53
- making
- placing
- prefix digits, inserting 58
- received calls list 55
- receiving 22
- recent calls 55
- storing 55
- terminating 53
- timers 73, 74
- transferring 62
- unanswered call 41, 57
- call waiting 61
- caller ID
 - incoming calls 53
 - outgoing calls 57
- calling line identification.
See caller ID
- car kit
 - automatic answer 74
- categories, phonebook 69
- chat 67
- clock 23
- club lights 47
- codes. See passwords
- color, display 50
- conference call 66
- contrast, display 50
- cursor 30

D

- data call
 - receive 75
 - send 74
- date, setting 45
- datebook 75
- default passwords 43
- deleting a call 55
- dialed calls list 55
- dialing
 - fixed numbers 72
 - quick dial numbers 72
 - service numbers 72
- dialing a number
- display
 - backlight 50
 - color 50
 - contrast 50
 - described 23
 - idle display 23
 - illustration 23
 - language 71
 - with phone closed 39
 - zoom setting 50
- downloading 77, 78
- DTMF tones 56
 - activating 73
 - sending 73

E

- earpiece

- illustration 1
- earpiece volume 20
- emergency number 54
- end key
 - functions 1, 21, 22, 28
- ending a call 21, 22
- Enter Unlock Code** message
 - 42, 44

F

- fax call
 - receive 75
 - send 74
- fixed dial 72
- flashing cursor, defined 30
- forwarding calls 66
- 4-way navigation key 27

G

- games 77, 78
- Get JavaApps 78

H

- hands-free mode
 - external display 41
- hands-free use
 - automatic answer 74
- haptics 71
- headset
 - automatic answer 74

- use with external display
 - 41

- Hide ID** feature 57
- hold a call 62

I

- idle display, defined 23
- ignoring a call 53
- incoming call
 - canceling 53
 - ignoring 53
 - terminating 53
- Incoming Call** message 53
- indicators
 - alert setting 24, 46
 - alert type 24, 46
 - battery level 15, 24, 26
 - GPRS 24
 - menu 23
 - message 25
 - message waiting 24
 - missed call 57
 - roam 24, 25
 - signal strength 24
 - silent alert 24, 46
 - text entry 25
 - transmit 25
 - vibrate alert 24, 46
- iTAP software
 - activating 38
 - entering words 34

J

Java applications 77, 78

K

key

- end 1, 21, 22, 28
- 4-way navigation 27
- left soft key 1, 28, 71
- menu 1, 22, 28
- navigation 1, 27
- right soft key 1, 28, 71
- send 1, 21, 22, 55
- smart 1, 41
- volume 1
- volume control 20

keypad

- answering calls 47
- volume, adjusting 70

L

language, setting 71

Last Calls Menu

- opening 56
- options 56

left soft key

- functions 1, 28
- personalizing 71

lights

- club 47
- incoming call 69

line, active 52

lock

- application 77
- phone 42
- SIM card 77

loud ring alert 24, 46

M

making a call

master clear 72

master reset 71

menu

- entering text 30
- language, setting 71

Last Calls Menu 56

lists 29

navigating 28

personalizing 71

quick 39

rearranging features 71

using features 30

menu indicator

- defined 23
- illustration 23

menu key 1, 22, 28

message

- chat 67
- deleting 67
- locking 67
- reading 67
- sending 67
- voicemail 59

message indicator

- defined 25
- message waiting indicator
 - illustration 24
- micro-browser
 - browser setup 77
 - Java applications 77
 - using 77
 - Web sessions 77
- microphone 1
- missed call indicator 57
- Missed Calls** message 41, 57
- my phone number 22
- my telephone number 22
- my tones 70

N

- n character, storing in a number 69
- navigation key 1, 27
- network settings 75
- notepad
 - defined 58
 - entering digits 58
- number, viewing your own 22
- numeric text entry method 38

O

- 1-touch dial
 - defined 59

- setting preference 70
 - using 59
- optional accessory, defined 13
- optional feature, defined 13

P

- passwords
 - changing 43
 - default 43
 - if you forget a password 44
- pause, storing in a number 69
- phone
 - accessories, optional 13
 - accessories, standard 12
 - alert, turning off 21
 - answer options 47
 - clear stored information 72
 - date, setting 45
 - keypad, answering calls 47
 - language, setting 71
 - line 52
 - locking 42
 - network settings 75
 - 1-touch dial 59
 - passwords 43, 44
 - reset all options 71
 - security code 44

- speed dial, using 59
- text entry indicator 25
- time, setting 45
- unlock code 44
- unlocking 20, 42
- phone number
 - adding digits after 57
 - attaching to prefix digits 58
 - attaching two numbers 57
 - line 52
 - redialing 52
 - storing in phonebook 68
 - viewing your own 22
- phonebook
 - attaching two numbers 57
 - categories 69
 - dialing a number 68
 - 1-touch dial 59
 - prefix digits, inserting 58
 - speed dial number 59
 - speed dial, using 59
 - storing an entry 68
 - voice dialing 68
- picture
 - inserting in message 67
 - storing 67
 - wallpaper 48
- PIN code
 - entering 77

- PIN code, storing in number 69
- predictive text entry
 - activating 38
 - entering words 34
- profile
 - setting 46
- prompt, storing in a number 69

Q

- quick dial 72
- quick menu 39

R

- received calls list 55
- receiving a call 22
- recent calls 55
- redial
 - busy number 52
- right soft key
 - functions 1, 28
 - personalizing 71
- ring alert
 - turning off 21
- ring and vibrate alert 24, 46
- ring style
 - setting 21
- ring. *See* alert
- ringer volume, setting 21
- roam indicator
 - defined 25

illustration 24

S

security code 44

send key 1, 21, 22, 55

sending a call. *See* making
a call

service dial 72

shortcuts

creating 71

Show ID feature 57

signal strength indicator

defined 24

illustration 24

silent alert indicator 24, 46

silent ring style, setting 21

SIM Blocked message 20,
77

SIM card

defined 16

locking 77

precautions 17

SIM Blocked message 20,
77

SIM PIN code

entering 77

smart key

functions 41

location 1

soft keys

illustration 1, 28

personalizing 71

soft ring alert 24, 46

sound

inserting in message 67

storing 67

special characters 69

speed dial

number, defined 59

using 59

storing a call 55

symbol text method 36, 37

symbols, entering 36, 37

T

tap method text entry 31

telephone number, viewing

your own 22

text

block cursor 32

character chart 32

entering from keypad 30

entry method, changing
38

entry method, setup 38

flashing cursor 30

iTAP software predictive
text entry 34

numeric entry method 38

symbol chart 36

symbol method 36, 37

tap method 31

text entry indicator

defined 25

text method, changing 38
text method, setup 38
time, setting 45
timers 73, 74
transfer a call 62
transmit indicator
 defined 25
travel charger, using 15
TTY device 67

U

unlock
 application 77
unlock code 42, 44

V

vibrate alert
 indicator 24, 46
 setting 46, 71
 turning off 21, 71
vibrate ring style, setting 21
voice dial
 dialing a number 68
voicemail 59
volume
 earpiece 20
 keypad 70
 ringer 21, 70
volume keys 1, 20

W

wait, storing in a number 69
wallpaper 48
warranty 89
Web pages 77
Web sessions 77

Z

zoom setting 50



MOTOROLA

Wireless Phone Safety Tips

“Safety is your most important call!”

Your Motorola wireless telephone gives you the powerful ability to communicate by voice—almost anywhere, anytime, wherever wireless phone service is available and safe conditions allow. But an important responsibility accompanies the benefits of wireless phones, one that every user must uphold.

When driving a car, driving is your first responsibility. If you find it necessary to use your wireless phone while behind the wheel of a car, practice good common sense and remember the following tips:

- 1 Get to know your Motorola wireless phone and its features such as speed dial and redial.** If available, these features help you to place your call without taking your attention off the road.
- 2 When available, use a hands-free device.** If possible, add an additional layer of convenience to your wireless

phone with one of the many Motorola Original™ hands-free accessories available today.

- 3 **Position your wireless phone within easy reach.** Be able to access your wireless phone without removing your eyes from the road. If you receive an incoming call at an inconvenient time, if possible, let your voice mail answer it for you.
- 4 **Let the person you are speaking with know you are driving; if necessary, suspend the call in heavy traffic or hazardous weather conditions.** Rain, sleet, snow, ice, and even heavy traffic can be hazardous.
- 5 **If you receive an incoming call at an inconvenient time do not take notes or look up phone numbers while driving.** Jotting down a “to do” list or going through your address book takes attention away from your primary responsibility—driving safely.
- 6 **Dial sensibly and assess the traffic; if possible, place calls when you are not moving or before pulling into traffic.** Try to plan calls when your car will be stationary. If you need to make a call while moving, dial only a few numbers, check the road and your mirrors, then continue.
- 7 **Do not engage in stressful or emotional conversations that may be distracting.** Make people you are talking with aware you are driving and suspend conversations which have the potential to divert your attention away from the road.
- 8 **Use your wireless phone to call for help.** Dial 9-1-1 or other local emergency number in the case of fire, traffic accident or medical emergencies.*



- 9 **Use your wireless phone to help others in emergencies.** If you see an auto accident, crime in progress or other serious emergency where lives are in danger, call 9-1-1 or other local emergency number, as you would want others to do for you.*
- 10 **Call roadside assistance or a special non-emergency wireless assistance number when necessary.** If you see a broken-down vehicle posing no serious hazard, a broken traffic signal, a minor traffic accident where no one appears injured, or a vehicle you know to be stolen, call roadside assistance or other special non-emergency wireless number.*

* Wherever wireless phone service is available.

Check the laws and regulations on the use of wireless telephones and their accessories in the areas where you drive. Always obey them. The use of these devices may be prohibited or restricted in certain areas.



PRELIMINARY

For more information,
please call
1-888-901-SAFE
or visit the
CTIA Web site at
www.wow-com.comTM

