

Bluetooth® PTT – Full Kit

EXPERT

Bluetooth Speaker Microphone

USER MANUAL

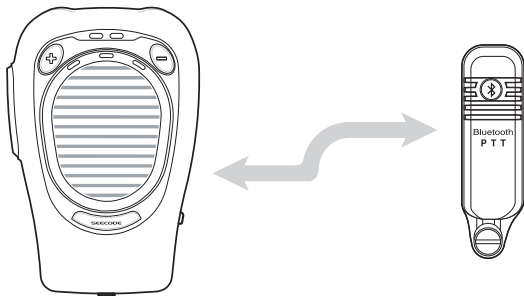

Thank you for choosing SEECODE Bluetooth PTT full kit.
This device connects your two-way radio to Bluetooth Speaker Mic.
without wire and let you more comfortable to use.

Patent List	29, Nov. 2006	KOREA	10-0791097
	6, Nov. 2007	EUROPE	07021512.4
	12, Nov. 2007	JAPAN	4361584
	8, Jan. 2007	U.S.A	11/650,812





| Contents |

Product overview	4
In the package	5
Part description	6
Connecting wireless dongle to radio	8

How to use Bluetooth Speaker Mic.

Charging	9
Power on / off	10
Pairing	11
Pairing completion	11
Direction	12

Appendix

On pairing disconnection	13
Using only radio	13
Specifications	14
Warranty	15

Product overview

What is Bluetooth Speaker Microphone?

Substitute wired Speaker microphone by wireless system using Bluetooth technology.

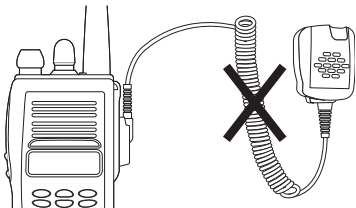

What is air-conduction earphone?

It is an accessory that helps conversation at noisy environment by using air-conduction system with a built-in microphone.

(* This is an option)

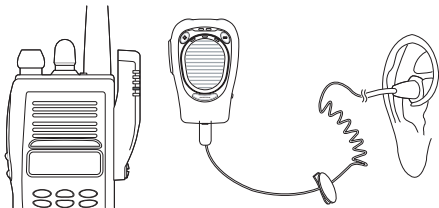

| In the package |



Speaker Mic.
(SCP860)



Wireless Dongle
(SHD614)



User's Manual



Charging adapter

☒ Option



Cigarette Charger



Earphone



Air-conduction earphone
(BA-01)

Part description

Bluetooth Speaker Mic. (SCP860)

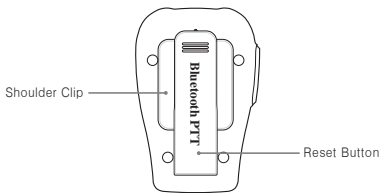
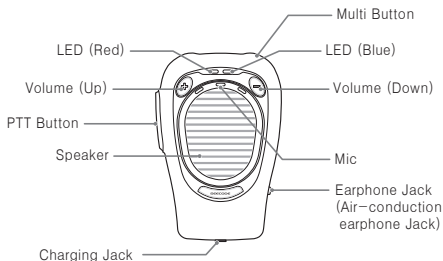

Wireless Dongle (SHD614)

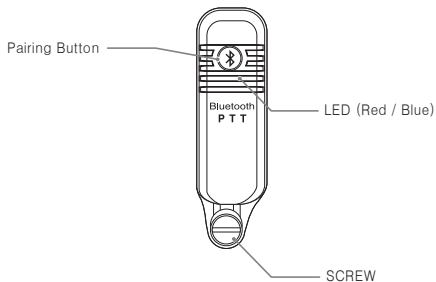

Connecting wireless dongle to radio

Insert projecting part of wireless dongle to groove of radio when the radio is power off.

Then tighten the screw up clockwise so that the wireless dongle can be adhered to radio.

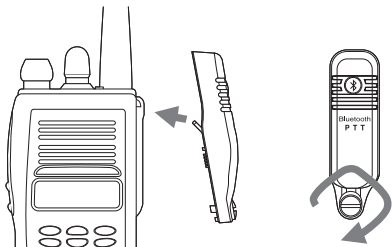

How to use Bluetooth Speaker

This product has a built-in battery and need to be fully charged before you use.

| Charging |

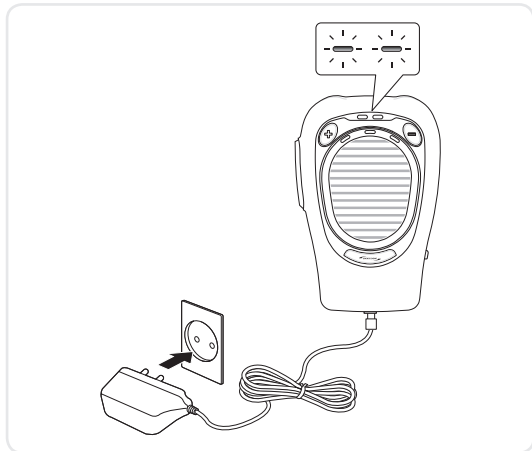

- **On charging** : Both Red & Blue LED flashes at the same time periodically.
- **After charging** : Both LED off.
- **Low battery** : Red LED flashes 4 times at 0.5 second interval with alarm sound.
- **Low battery of radio** : There is an alarm sound.

| Power on / off |

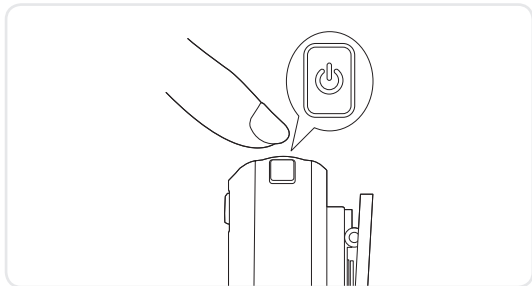

- **Turning On** : Press Multi Button for 2 seconds when it was powered off.
(There is a beep sound and blue LED flashes five times)
- **Turning Off** : Press Multi Button for 4 seconds when it was powered on.
(There is a beep sound and blue LED turns on for two seconds and turns off)

| Pairing |

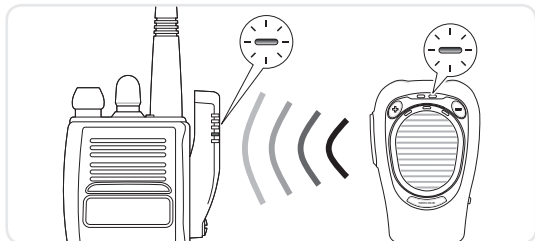

- **Bluetooth Speaker Microphone :** As power off, press Multi Button for 6 seconds (Blue LED flashes 5 times continuously and rapidly flashes with pairing sound).
- **Wireless Dongle :** Press Pairing Button for 6 seconds after radio is turned on (Blue LED flashes continuously).

| Pairing completion |

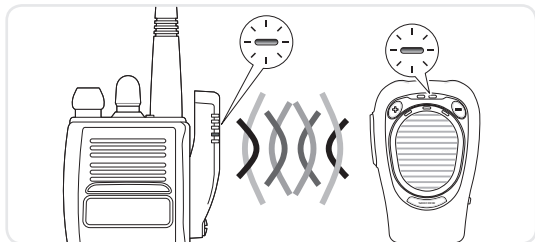

- **Bluetooth Speaker Microphone & Wireless Dongle :**
Blue LED flashes 3 times at 5 seconds interval

| Direction |

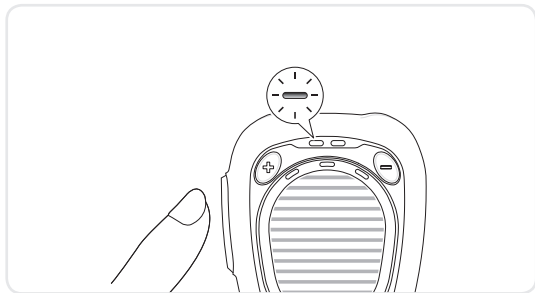

- **Speaking** : Press PTT Button while you are speaking and the red LED turns on.
- **Hearing** : Release PTT Button while you are hearing and the blue LED turns on.
- **Standby** : Blue LED flashes 3 times periodically.

- Auto re-connection (pairing)
 - Once pairing is completed, you do not need to pair ever again. When you power on the product, they are automatically connected. If there is a delay, please press Multi Button once on Speaker Mic.
- Air-conduction earphone
 - Please adhere this tightly to inside of your earhole to prevent air from venting.

Appendix

| On pairing disconnection |

- If radio is turned off or operating range is exceeded (abnormal status), pairing is dis-connected and there is an alarm sound for 5 times.
When it comes to normal status, they are automatically connected.

| Using only radio |

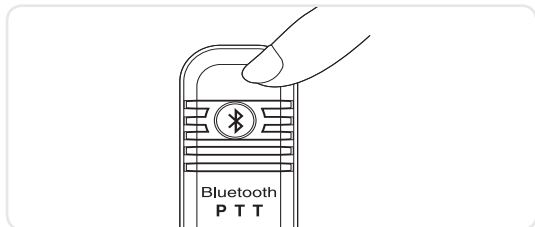

- If you want to use only radio when Bluetooth Speaker Microphone is connected, press Pairing Button for 10 seconds.
Then red & blue LED flashes by turns.
If you want to return to Bluetooth Speaker Microphone, press Multi Button for 3 seconds.

Specifications

	Bluetooth Speaker Mic. (SCP860)	Wireless Dongle (SHD614)
Bluetooth version	Bluetooth® Ver2.0	Bluetooth® Ver2.0
Operating range	Up to 100m (Variable up to environment)	Up to 100m (Variable up to environment)
Operating temperature	-10°C ~ +60°C	-10°C ~ +60°C
Battery	3.7V / 1100mA	Same as radio
Talking time	Up to 8 hours	
Stand-by time	Up to 250 hours (50 hours without sleep mode)	
Charging time	Less than 3 hours	
FCC ID	WWTSCP8601	IBNSHD614

	Bluetooth Speaker Mic. (SCP860)	Wireless Dongle (SHD614)
Firm name	SHINPOONG ELECTRONICS	SHINPOONG ELECTRONICS
Model name	SCP860	SHD614
Manufactured date	201 . . .	201 . . .
Manufacturer / Country	SHINPOONG ELECTRONICS / KOREA	SHINPOONG ELECTRONICS / KOREA
Identification code	SFK	S1E

Declaration of confirmation

Section 15.19 Labelling requirements

This device complies with part 15 of the FCC rules.

Operations is subject to the following two conditions :

1. This device may not cause harmful interference and
2. This device must accept any interference received, including interference that may cause undesired operation.

Section 15.21 Information to user

The changes or modifications not expressly approved by the party responsible for compliance could void the user's authority to operate the equipment.

IMPORTANT NOTE

To comply with the FCC RF exposure compliance requirements, no change to the antenna or the device permitted. Any change to the antenna or the device could result in the device exceeding the RF exposure requirements and void user's authority to operate the device.



WARRANTY

This product was produced under strict quality management and inspection.

Free of charge service

1. All defective units within the applicable Warranty period/s will be repaired or replaced, in the case those faulty goods were handled normally.
2. If you use it commercially, the warranty period/s will be reduced half.

Free of charge Warranty shall not apply to

1. Defects or damage resulting from use of the unit in other than its normal and intended manner, eg, in excess of their maximum specifications or operating instructions.
2. Defects or damage from misuse, accident, neglect, improper testing, installation, alteration or modification of any kind, or spillage of food or liquid.
3. Faulty is caused by a nature Disaster.
4. The capacity of expendables is exhausted.

Product name	Bluetooth PTT Full Kit
Model number	SCP860, SHD614
Warranty period	1 year
Purchases date	
Outlet the unit was purchased	
Tel	
Customer	Address
	Name
	Tel



Bluetooth Professional

www.seecode.com



Rm. A-1107, Gwangmyeong Technopark, 60, Haan-Ro, Gwangmyeong-City, Gyeonggi-Do, KOREA
Tel : 82-70-7945-2401, Fax : 82-2-2083-2272 www.seecode.com e-mail : sale@seecode.com

TCB**GRANT OF EQUIPMENT
AUTHORIZATION****TCB****Certification****Issued Under the Authority of the
Federal Communications Commission****By:****Compliance Certification Services
47173 Benicia Street
Fremont, CA 94538****Date of Grant: 12/02/2008****Application Dated: 12/02/2008****SEHWA Electronics Co.,LTD
378-1 Maetan Dong, Yeongtong-Ku
Suwon-Si, 443-374
South Korea****Attention: HyunSeok Nam****NOT TRANSFERABLE**

EQUIPMENT AUTHORIZATION is hereby issued to the named GRANTEE,
and is VALID ONLY for the equipment identified hereon for use under the
Commission's Rules and Regulations listed below.

FCC IDENTIFIER: WWTSCP860**Name of Grantee: SEHWA Electronics Co.,LTD****Equipment Class: Part 15 Spread Spectrum Transmitter
Notes: Bluetooth Speaker Mic**

<u>Grant Notes</u>	<u>FCC Rule Parts</u>	<u>Frequency Range (MHZ)</u>	<u>Output Watts</u>	<u>Frequency Tolerance</u>	<u>Emission Designator</u>
	15C	2402.0 - 2480.0	0.01644		

Power listed is conducted. The antenna(s) used for this transmitter must not be co-located or operating in conjunction with any other antenna or transmitter. End-Users must be provided with transmitter operation conditions for satisfying RF exposure compliance.

Bluetooth Professional **SEECODE**

SEECODE CO.,LTD
www.seecode.com

Bluetooth® PTT -POLICE I **PTT FULL KIT** User Manual



Thank you for choosing SEECODE Bluetooth PTT Full Kit. This device connect your two-way radio to Bluetooth Speaker Mic. without wire and let you more comfortable to use.

Patent List	29, Nov 2006	KOREA	10-2006-0118972
	6 Nov. 2007	EUROPE	07021512 4
	12, Nov. 2007	JAPAN	2007 293205
	8, Jan 2007	U.S.A	11/650 812



| Contents |

Product overview	4
In the package	5
Part description	6

How to use Bluetooth PTT Full Kit

Charging	8
Power on / off	9
Pairing	10
Use as walkie-talkie mode	11
Volume control	11
When any device works abnormally	12

Appendix

Quick manual	13
LED indicator	14
Precautions for safety	16
Specifications	17
Declaration of confirmation	18
Warranty	19



Product overview

Thank you for choosing SEECODE **Bluetooth PTT Full Kit**. This device connect your two-way radio to **Bluetooth Speaker Mic** without wire and let you more comfortable to use.

You can put heavy two-way radio in car or office and just use **Bluetooth Speaker Mic** instead. This device removes inconvenience and danger especially for police, sailor, workers in plant, construction site & etc.

In the package



Speaker Mic.
(SCP860)



PTT Dongle
(SHD612)



Charging Adapter



Multi-Charging Jack



User's Manual



Velcro

☒ Option



Cigarette Charger



Audio Jack

Part description

SCP860 (Bluetooth Speaker Mic.)

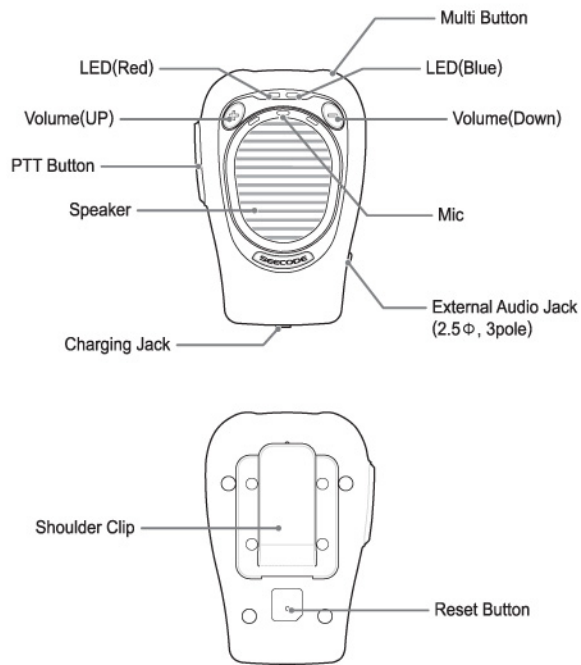

SHD612 (PTT Dongle)

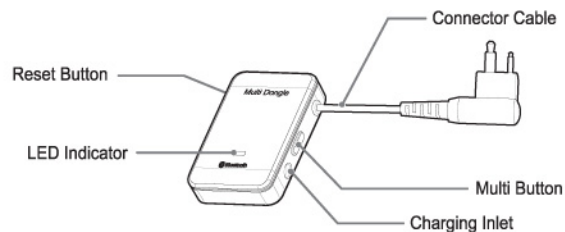

How to use Bluetooth PTT Full Kit

This device connects your two-way radio to **Bluetooth Speaker Mic.** without wire and let you more comfortable to use.

Charging

Bluetooth Speaker Mic. and **PTT Dongle** have a built-in battery and need to be fully charged before you use.

1. You can charge **Bluetooth Speaker Mic.** and **PTT Dongle** at the same time using Multi-Charging Jack through Charging Adapter within the house and Cigarette Charger(option) in the car.

While charging, the Red & Blue LED flashes 1 time at a 3 second interval and it turns off when charging is completed.

2. The charging time is less than 3 hours.

 **Tips** All devices are working normally while charging and you could use them.



Low Battery State

Bluetooth Speaker Mic. : Red LED flashes 4 times at 0.5 second interval
PTT Dongle : Blue and Red LED flashes at 10 seconds interval



Notice Do not use other charger except the supplied charger.
It may cause a trouble and damage.

Power on / off

Turning On	Button Action	LED State
· Bluetooth Speaker Mic.	Press Multi Button for 2 seconds	Blue LED flashes 5 times
· PTT Dongle	Press Multi Button for 2 seconds	Blue LED flashes 5 times
Turning Off	Button Action	LED State
· Bluetooth Speaker Mic.	Press Multi Button for 4 seconds	Blue LED turns on for 1 second and turns off
· PTT Dongle	Press Multi Button for 4 seconds	Blue LED turns on for 1 second and turns off

| Pairing |

Pairing Mode	Button Action	LED State
· Bluetooth Speaker Mic.	As power off, press Multi Button for 6 seconds	Blue LED flashes 5 times continuously and rapidly flashes (pairing standby)
· PTT Dongle	As power off, press Multi Button for 6 seconds	Blue LED flashes 5 times continuously and rapidly flashes (pairing standby)

- When pairing standby mode, **PTT Dongle** registers **Speaker Mic.** automatically.
- When pairing failed, please proceed from the first step.
- Once pairing completed, you don't need to pair any more.
When you power on the product, they're automatically connected.
- When you are out of range, as long as you come back within 20minutes, they're automatically connected. If not connected, please press Multi Button once of **Speaker Mic.**

| Use as walkie-talkie mode |

When you use as walkie - talkie mode, press PTT Button on **Speaker Mic.** and you can talk to the opposite party. You should press and hold PTT Button while you're speaking. You should release PTT Button while you're hearing. These usage is the same as normal two - way radio.

| Volume control |

Press Volume Button [+] or [-] on Speaker Mic. to increase or decrease the speaker volume.

Volume is made up by 6 stages.

There is a beep sound when you adjusting volume on stand-by status but no sound on receiving(hearing) status.

There is a long beep sound on high & low end volume.

When any device works abnormally

When you have any serious trouble in use, press the reset button on the rear side of PTT Dongle & Speaker Mic.

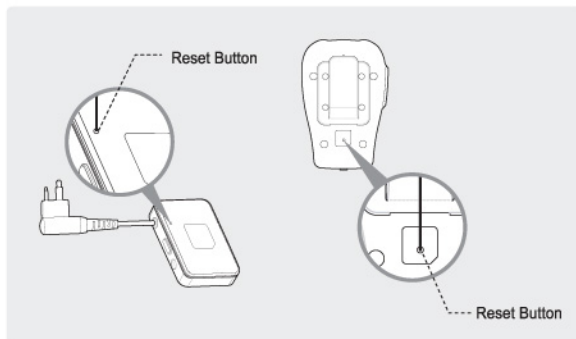

Appendix

Quick manual

Menu	Product	Action
Turning On	· Bluetooth Speaker Mic. · PTT Dongle	Press Multi Button for 2 seconds
Turning Off	· Bluetooth Speaker Mic. · PTT Dongle	Press Multi Button for 4 seconds
Pairing	· Bluetooth Speaker Mic. · PTT Dongle	As power off, press Multi Button for 6 seconds
Speaking	· Bluetooth Speaker Mic.	Press PTT Button while you are speaking
Hearing	· Bluetooth Speaker Mic.	Release PTT Button while you are hearing

LED indicator

Low Battery	· Bluetooth Speaker Mic.	Red LED flashes 4 times at a 0.5 second interval
	· PTT Dongle	Blue and Red LED flashes at 10 seconds interval
Pairing Mode	· Bluetooth Speaker Mic.	Blue LED flashes 5 times continuously and rapidly flashes (pairing standby)
	· PTT Dongle	
Paired Mode	· Bluetooth Speaker Mic. · PTT Dongle	Blue LED flashes 3 times at a 5 seconds interval

● Bluetooth Speaker Mic.(Normal case)

	Red LED	Blue LED
PTT On	Always on	Off
PTT Off	Off	Blue LED flashes 3 times at a 5seconds interval
Receiving	Off	Always on

● Bluetooth Speaker Mic.(Abnormal case)

	Red LED	Blue LED
PTT On	Off	Off
PTT Off	Off	Blue LED flashes 1 time at a 5 seconds interval
Receiving	Off	Off

* Abnormal case : Problem occurs on unit or operating distance is beyond 10m.

Precautions for safety

- ❗ Keep a place of safety with turning off product.
- ❗ Do not place the product under over 50℃ high temperature or a direct ray of light. It may cause to lower of performance and reduce battery life.
- ❗ Keep the product away from humidity & dust.
- ❗ Do not drop the product from high place.
- ❗ Do not touch product and plug with a wet hand.
- ❗ Pay attention that a baby or pet do not suck or bite product.
- ❗ Do not modify, repair, take a part at discretion.
- ❗ Turn off at the place where product use is for bidden.
- ❗ If possible, do not use while driving.
- ❗ Keep the product away from micro-wave or wireless LAN. It may cause a noise.
- ❗ Risk of explosion if battery is replaced by an incorrect type.
- ❗ Dispose of used batteries according to the instructions

Specifications

	SCP860 (Bluetooth Speaker Mic.)	SHD612 (PTT Dongle)
Bluetooth® Version	Bluetooth® Ver 2.1	Bluetooth® Ver 2.0
Supported Bluetooth® profile	Headset & Serial profile	Headset & Serial profile
Carrier frequency	2,402~2,480GHz	2,402~2,480GHz
Operating range	Up to 10m	Up to 10m
Dimension(mm)	88(L) x 59(W) x 27(H)	45(L) x 29(W) x 10(H)
Weight	112.7g	16.3g
Operating temperature	-10℃ ~ +60℃	-10℃ ~ +60℃
Battery	3.7V/1,100mA	3.7V/150mA
Talking time	Up to 8 hours	Up to 7 hours
Stand-by time	Up to 200 hours	Up to 200 hours
Charging time	Less than 3 hours	Less than 2 hours

Declaration of confirmation

Section 15.19 Labelling requirements

This device complies with part 15 of the FCC rules.

Operations is subject to the following two conditions :

1. This device may not cause harmful interference and
2. This device must accept any interference received, including interference that may cause undesired operation.

Section 15.21 Information to user

The changes or modifications not expressly approved by the party responsible for compliance could void the user's authority to operate the equipment.

IMPORTANT NOTE

To comply with the FCC RF exposure compliance requirements, no change to the antenna or the device permitted. Any change to the antenna or the device could result in the device exceeding the RF exposure requirements and void user's authority to operate the device.



WARRANTY

This product was produced under strict quality management and inspection.

Free of charge service

1. All defective units within the applicable Warranty period/s will be repaired or replaced, in the case those faulty goods were handled normally.
2. If you use it commercially, the warranty period/s will be reduced half.

Free of charge Warranty shall not apply to

1. Defects or damage resulting from use of the unit in other than its normal and intended manner, eg, in excess of their maximum specifications or operating instructions.
2. Defects or damage from misuse, accident, neglect, improper testing, installation, alteration or modification of any kind, or spillage of food or liquid.
3. Faulty is caused by a nature Disaster.
4. The capacity of expendables is exhausted.

Product name	Bluetooth PTT Full Kit	
Model number	SCP860, SHD612	
Warranty period	1 year	
Purchases date		
Outlet the unit was purchased		
Tel		
Customer	Address	
	Name	
	Tel	



FCC Information to User

This equipment has been tested and found to comply with the limits for a Class B digital device, pursuant to Part 15 of the FCC Rules. These limits are designed to provide reasonable protection against harmful interference in a residential installation. This equipment generates, uses and can radiate radio frequency energy and, if not installed and used in accordance with the instructions, may cause harmful interference to radio communications. However, there is no guarantee that interference will not occur in a particular installation. If this equipment does cause harmful interference to radio or television reception, which can be determined by turning the equipment off and on, the user is encouraged to try to correct the interference by one of the following measures:

- Reorient or relocate the receiving antenna.
- Increase the separation between the equipment and receiver.
- Connect the equipment into an outlet on a circuit different from that to which the receiver is connected.
- Consult the dealer or an experienced radio/TV technician for help.



Caution

Modifications not expressly approved by the party responsible for compliance could void the user's authority to operate the equipment.

FCC Compliance Information : This device complies with Part 15 of the FCC Rules. Operation is subject to the following two conditions: (1) This device may not cause harmful interference, and (2) this device must accept any interference received, including interference that may cause undesired operation

IMPORTANT NOTE:

IMPORTANT Safety Instruction:

CAUTION	
To reduce the risk of electric shock, do not remove the top cover (or the rear section). No user serviceable parts inside, refer servicing to qualified personnel.	
	This symbol, wherever it appears, alerts you to the presence of uninsulated dangerous voltage inside the enclosure-voltage that may be sufficient to constitute a risk of shock.
	This symbol, wherever it appears, alerts you to the important operating and maintenance instructions in the accompanying literature. Please read the manual.

- 1) Read these instructions.
- 2) Keep these instructions.
- 3) Heed all warnings.
- 4) Follow all instructions.
- 5) Do not use this equipment near water.
- 6) Do not use near any heat sources such as radiators, heat resistors, stove, or other equipment that produce heat.

CAUTION
RISK OF EXPLOSION IF BATTERY IS REPLACED
BY AN INCORRECT TYPE.
DISPOSE OF USED BATTERIES ACCORDING
TO THE INSTRUCTIONS

Information to user.

The users manual or instruction manual for an intentional or unintentional radiator shall caution the user that changes or modifications not expressly approved by the party responsible for compliance could void the user's authority to operate the equipment. In cases where the manual is provided only in a form other than paper, such as on a computer disk or over the Internet, the information required by this section may be included in the manual in that alternative form, provided the user can reasonably be expected to have the capability to access information in that form.

Shinpoong Electronics Inc.

A1107, Gwangmyeong Technopark, 60, Haan-Ro, Gwangmyeong-City, Gyeonggi-Do, KOREA

TEL : +82-70-8855-8300 / FAX : +82-2-2083-2272 / E-mail : jaebongoh@hanmail.net

CONTACT INFORMATION

Manufacturer Address : A1107, Gwangmyeong Technopark, 60, Haan-Ro, Gwangmyeong-City,
Gyeonggi-Do, KOREA

To locate in-country Shinpoong Electronics Inc., distributors of the Wireless Dongle,
please refer to the Shinpoong Electronics Inc. Website <http://www.seecode.com>

These distributor(s) represent local contacts for this product.

CORPORATE HEADQUARTERS:

Shinpoong Electronics Inc.

A1107, Gwangmyeong Technopark, 60, Haan-Ro, Gwangmyeong-City, Gyeonggi-Do, KOREA

Tel: +82-70-8855-8300

Fax: +82-2-2083-2272

Email: jaebongoh@hanmail.net

Web: [http:// www.seecode.com](http://www.seecode.com)

This device complies with Industry Canada license-exempt RSS standard(s).

Operation is Subject to the following two condition: (1) this device may not cause interference
,and (2) this device must accept any interference, including interference that may cause undesired
operation of the device.

EUROPEAN UNION “DECLARATION OF CONFORMITY”

DECLARATION OF CONFORMITY

Shinpoong Electronics Inc.

A1107, Gwangmyeong Technopark, 60, Haan-Ro, Gwangmyeong-City,
Gyeonggi-Do, KOREA

declare under our sole responsibility that the product(s)

Wireless Dongle – SHD614

to which this declaration relate(s) is in conformance with the following standards:

EN 301 489-1 V1.9.2:2011

EN 301 489-17 V2.1.1 :2009

EN60950-1:2006

EN 300 328 V1.8.0:2011

following the provisions of the 1999/5/EC Directives.