

Regulatory Compliance Statements

● **FCC Warning Statement**

This equipment has been tested and found to comply with the limits for a Class B digital device, pursuant to part 15 of the FCC rules. These limits are designed to provide reasonable protection against harmful interference in a residential installation.

This equipment generates, uses and can radiate radio frequency energy and, if not installed and used in accordance with the instructions, may cause harmful interference to radio communications. However, there is no guarantee that interference will not occur in a particular installation. If this equipment does cause harmful interference to radio or television reception, which can be determined by turning the equipment off and on, the user is encouraged to try to correct the interference by one or more of the following:

- Relocate the receiving antenna.
- Increase the separation between the equipment and receiver.
- Connect the equipment into an outlet on a circuit that is different from the receiver.
- Consult the dealer or an experienced radio/television technician for help.

FCC Statement

This device complies with Part 15 of the FCC Rules. Operation is subject to the following two conditions: (1) this device may not cause harmful interference, and (2) this device must accept any interference received, including interference that may cause undesired operation.

Caution!

Any changes or modifications not expressly approved by the party responsible for compliance could void the user's authority to operate the equipment.

● **Canadian Compliance Statement**

Industry Canada Notice Operation is subject to the following two conditions: (1) This device may not cause interference and (2) This device must accept any interference, including interference that may cause undesired operation of the device.

● **European Conformity Statement**

Declaration of Conformity with Regard to the R&TTE 1999/5/EC and EMC 89/336/ EEC directives.

● **RoHS Statement**



This device conforms to RoHS (Restriction of Hazardous Substances) European Union regulations that set maximum concentration limits on hazardous materials used in electrical and electronic equipment.

- **Taiwan NCC Warning Statement**

根據NCC低功率電波輻射性電機管理辦法 規定:

第十二條 經型式認證合格之低功率射頻電機，非經許可，公司、商號或使用者均不得擅自變更頻率、加大功率或變更原設計之特性及功能。

第十四條 低功率射頻電機之使用不得影響飛航安全及干擾合法通信；經發現有干擾現象時，應立即停用，並改善至無干擾時方得繼續使用。

前項合法通信，指依電信法規定作業之無線電通信。

Warranty

The following items are covered under Unitech Limited Warranty:

- MT200L Intercom & Access Control Terminal -- 1-year limited warranty.
- Cables -- three-month limited warranty.

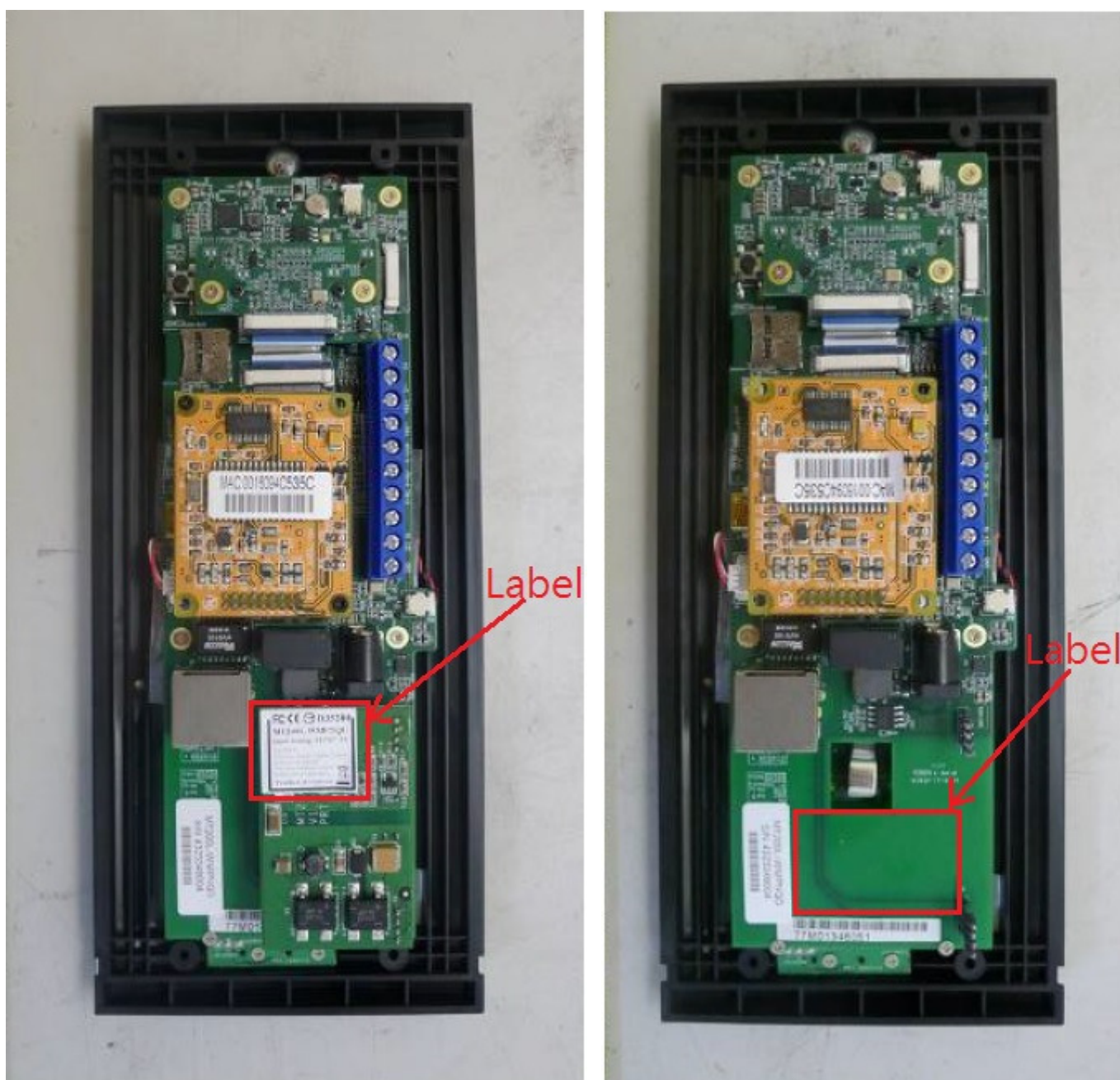

TASHI

Front View

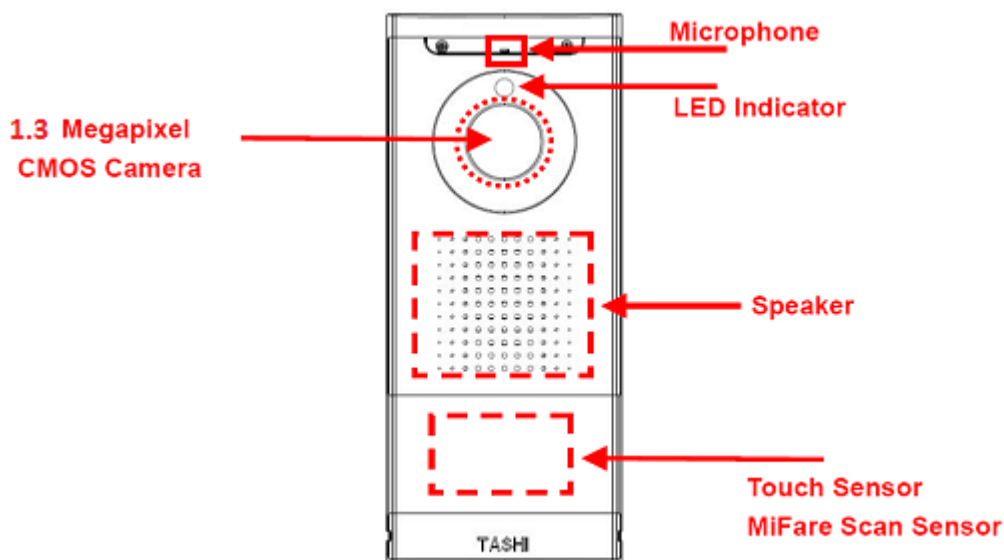

Rear View

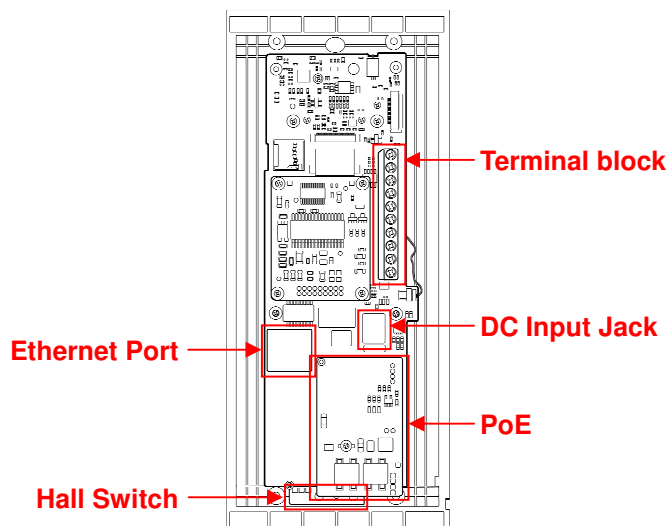

Terminal Block Pin Assignment

Pin	Description
J10_1	D1+
J10_2	D1-
J11_1	RS485+
J11_2	RS485-
J12_1	R1C
J12_2	R1NO
J13_1	R1NC
J13_2	(Floated)
J14_1	12Vin
J14_2	GND

Relay Output

RL1-CTRL→High	R1 (C & NO Linked)
RL1-CTRL→Low	R1 (C & NC Linked)

Digit Input

D1+ and D1- are the positive and negative terminals of the external power input

D1 = High	Digit input1 = High
D1 = Low	Digit input1 = Low

MT200 SERIES Installation Notes

● Connect Power

Plug the Power Adapter Cable into the MT200 SERIES's DC input jack, then connect the other end of the Power Adapter into an electrical outlet.

● Using Terminal Block

The MT200 SERIES provides one 10-position terminal blocks for input/output signals. The I/O panels are on the MT200 SERIES's rear side.

● Installation (I) – Plastic in wall box

Mount and fix the MT200 SERIES terminal with four screws (M2 x 20mm) to the housing embedded into the wall. Next, install an upper plaque and a lower plaque for ornaments on the cover of MT200 SERIES terminal.

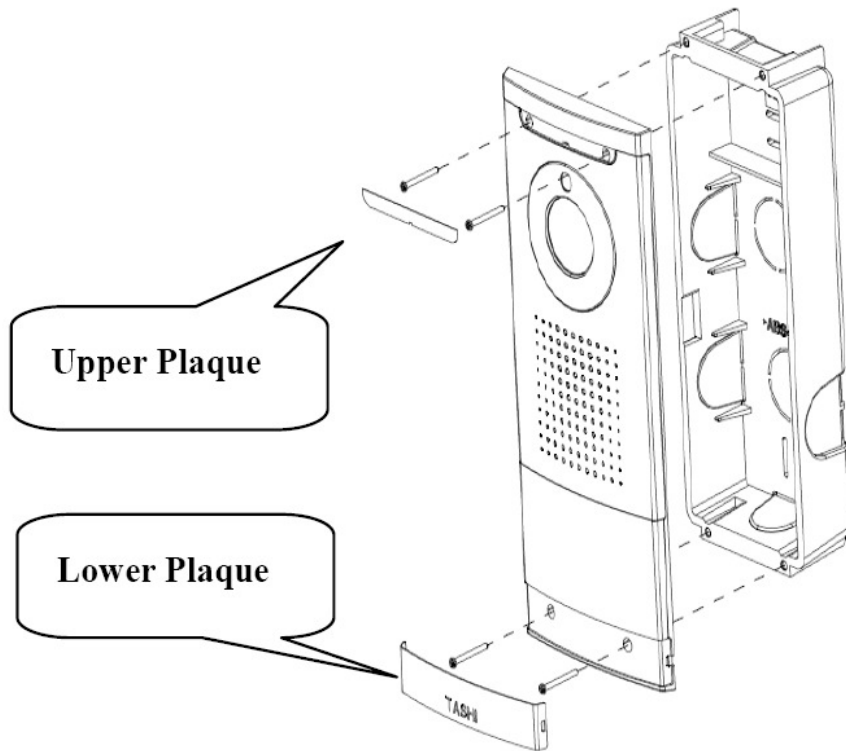

Caution

1. The upper and lower plaques are consumptive materials, so carefully attach the two plaques. If the materials are damaged, please contact your dealer for solution.
2. MT200 is a door phone with front panel IP65 degree. While outdoors on-site installation, please have "shield case" to protect the device to avoid the rain flows into device body that might be resulting in oxidation or short circuit. While installing the device in the wall, please use "Silicone" sealing the gap between the device with the wall to prevent infiltration of rainwater from the wall surface.

● Installation (II) – Iron in wall box

Follow below picture, mount and fix the MT200 SERIES terminal with accessories to the housing embedded into the wall.

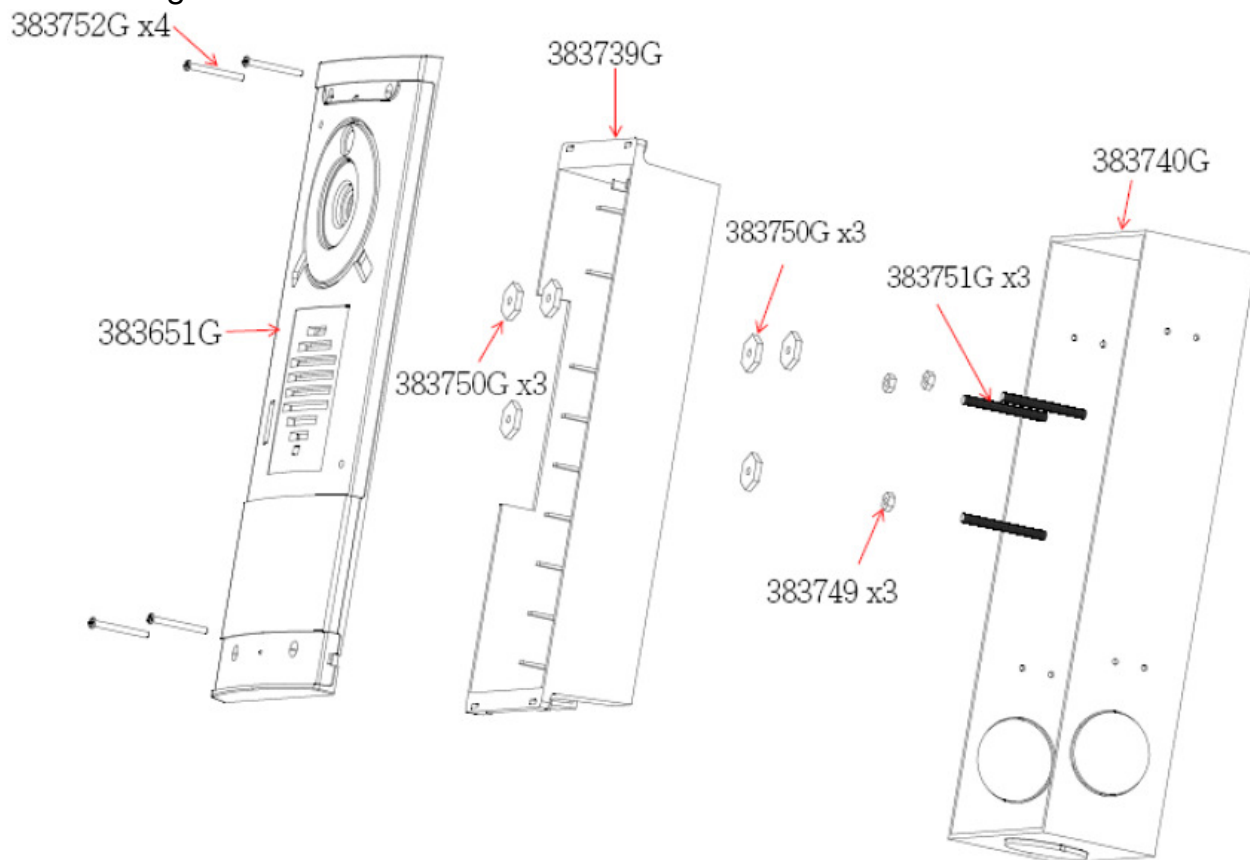

Install an upper plaque and a lower plaque for ornaments on the cover of MT200 SERIES terminal.

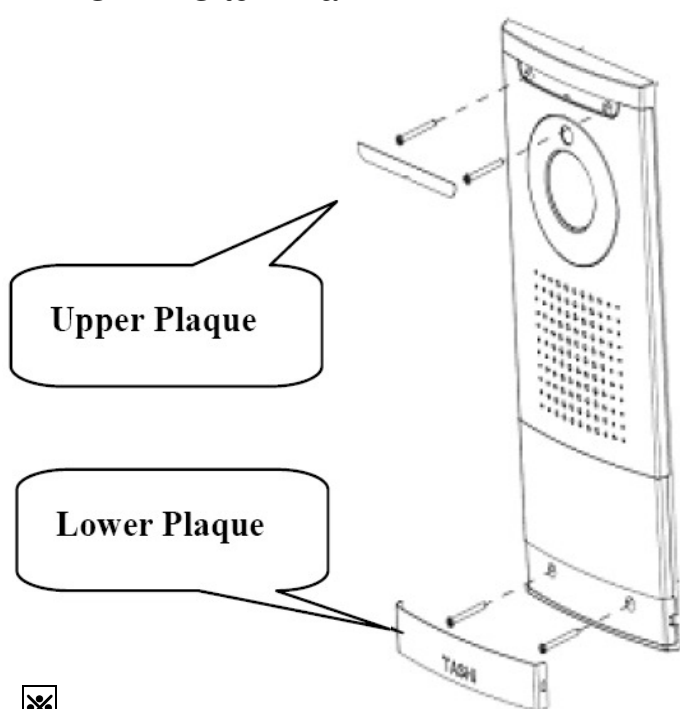

Caution

1. The upper and lower plaques are consumptive materials, so carefully attach the two plaques. If the materials are damaged, please contact your supplier for solution.
2. MT200 is a door phone with front panel IP65 degree. While outdoors on-site installation, please have "shield case" to protect the device to avoid the rain flows into device body that might be resulting in oxidation or short circuit. While installing the device in the wall, please use "Silicone" sealing the gap between the device with the wall to prevent infiltration of rainwater from the wall surface.



手冊 請逕洽經銷商索取說明光碟。

產品安裝手冊 及 Elfin 社區對講系統安裝 / 使用

MT200 SERIES 裝機注意事項

● 連接電源

將變壓器纜線插至MT200 SERIES 的DC 輸入插孔(Input Jack)，然後將另一端接至電源插座。

● 使用端子台

MT200 SERIES具備一個10腳位的端子台供輸入/輸出訊號使用。I/O面板位於MT200 SERIES的背側。

● 安裝方法1 – 塑膠預埋盒

利用4顆螺絲(M2 x 20mm)將MT200 SERIES本體上蓋與下蓋固定鎖緊。同時，將上飾板和下飾板分別黏貼於MT200 SERIES本體上。

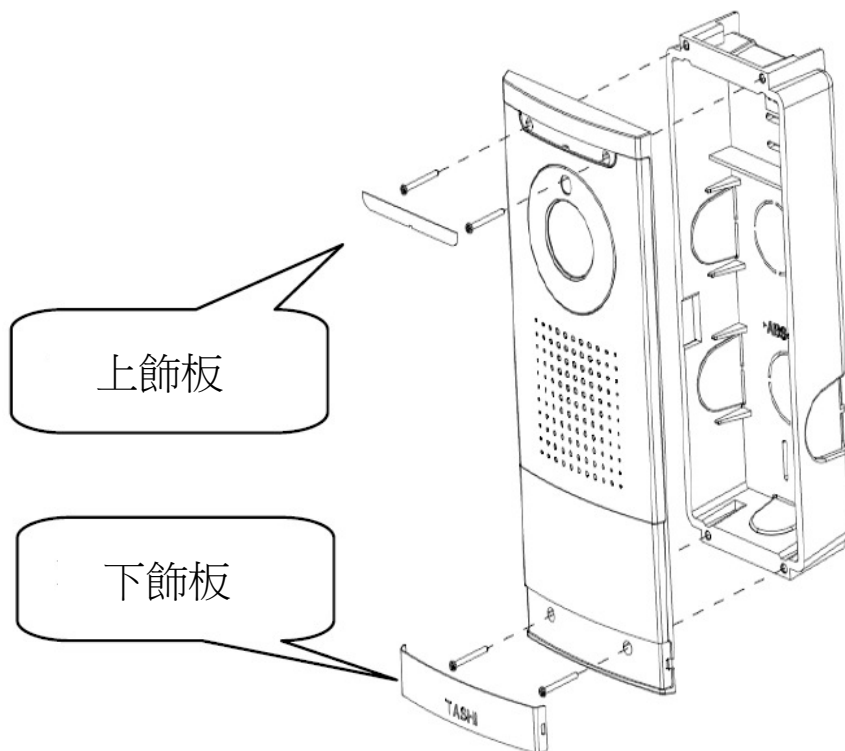

注意：

1. 上飾板與下飾板為耗材，請小心黏貼；若該耗材損毀而需要再次購買，請與經銷商聯絡。
2. MT200僅正面為 IP65 防護等級。於現場安裝於戶外時，需有「雨遮」保護機器，避免雨水從壁面流入機器本體內，造成電路氧化或短路。設備安裝於牆面時，設備與牆面周圍請用「矽利康Silicone」收邊，同時也可防雨水由壁面滲入。

● 安裝方法2 – 鐵件預埋盒

下圖為MT200 SERIES、下蓋、以及預埋盒組合安裝之分解圖，請參照以下圖示進行施工。

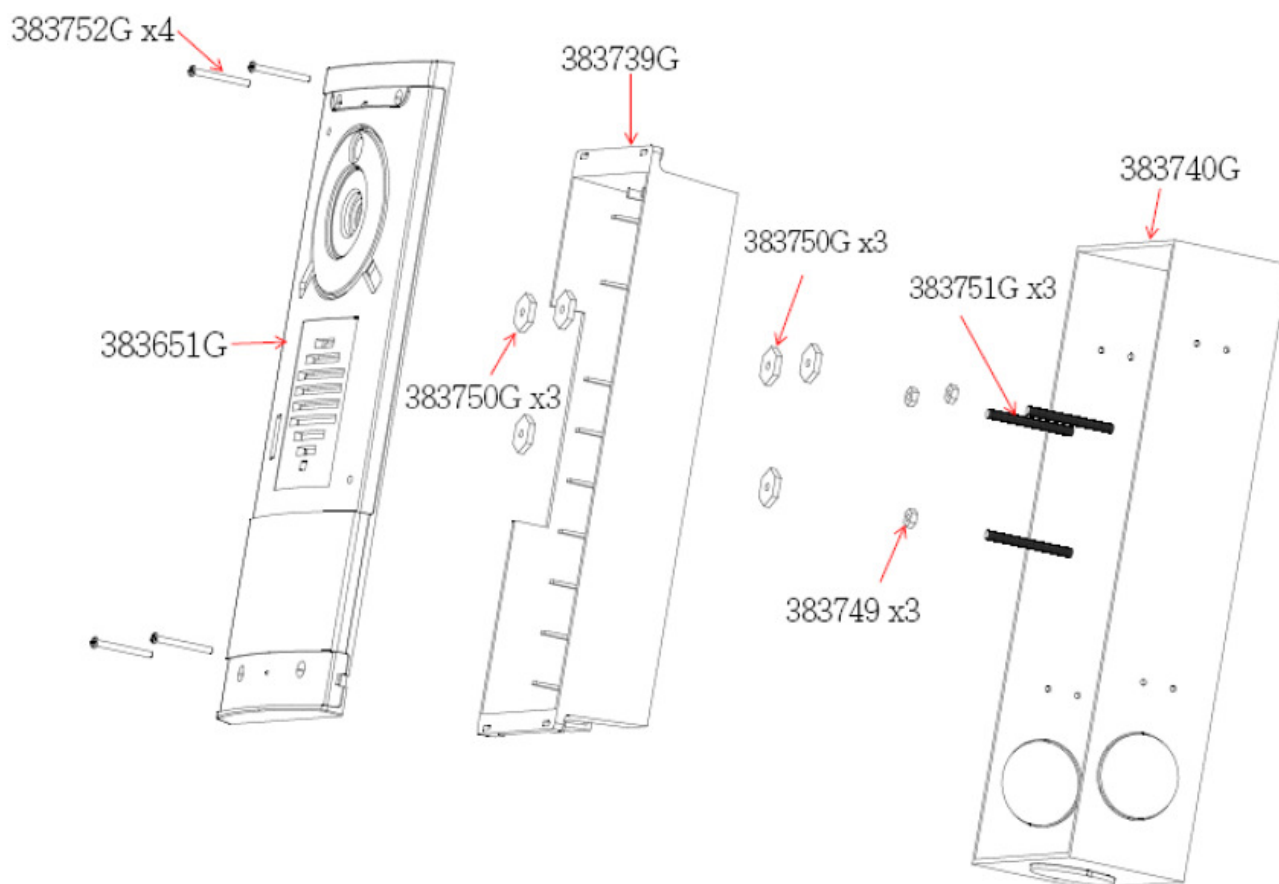

請將上飾板和下飾板分別黏貼於MT200 SERIES本體上。

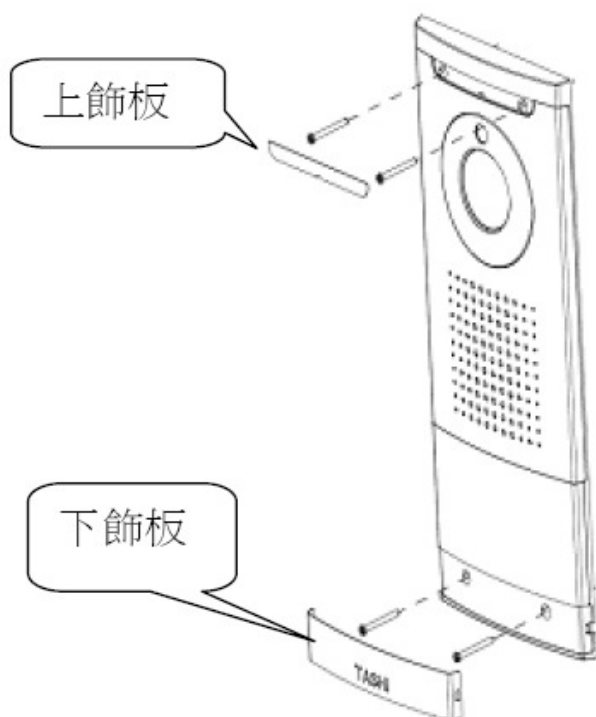

注意：

1. 上飾板與下飾板為耗材，請小心黏貼；若該耗材損毀而需要再次購買，請與經銷商聯絡。
2. MT200僅正面為 IP65 防護等級。於現場安裝於戶外時，需有「雨遮」保護機器，避免雨水從壁面流入機器本體內，造成電路氧化或短路。設備安裝於牆面時，設備與牆面周圍請用「矽利康Silicone」收邊，同時也可防雨水由壁面滲入。

MT200 SERIES 装机注意事项

● 连接电源

将变压器缆线插至MT200 SERIES 的DC 输入插孔(Input Jack) ,然后将另一端接至电源插座。 .

● 使用端子台

MT200 SERIES具备一个10脚位的端子台供输入/输出讯号使用。I/O面板位于MT200 SERIES的背侧。

● 安装方法1 – 塑料预埋盒

利用4颗螺丝(M2 x 20mm)将MT200 SERIES本体上盖与下盖固定锁紧。同时，将上饰板和下饰板分别黏贴于MT200 SERIES本体上。

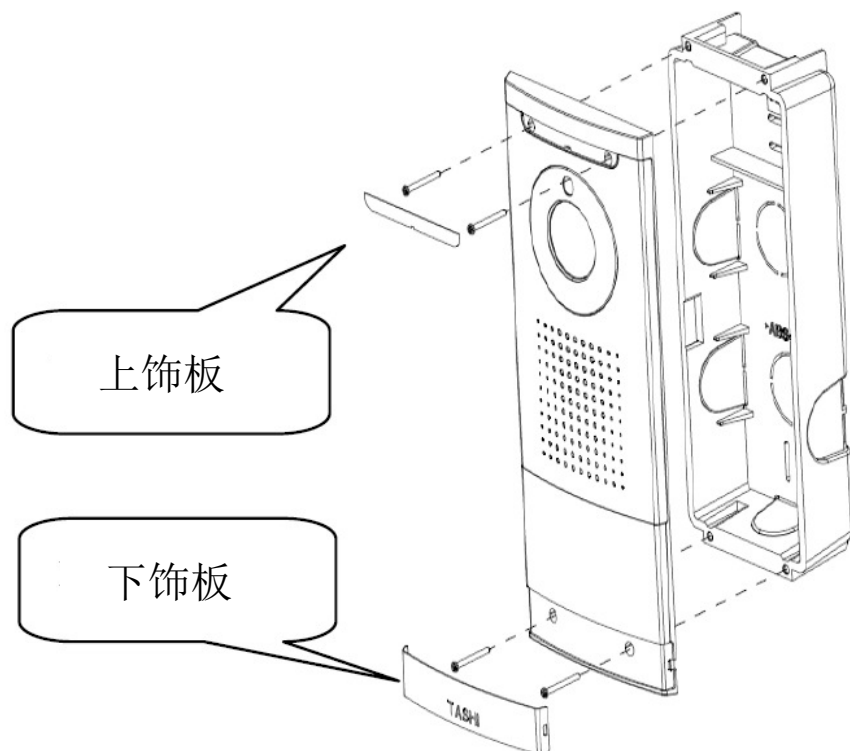

注意：

1. 上饰板与下饰板为耗材，请小心黏贴；若该耗材损毁而需要再次购买，请与经销商联络。
2. MT200仅正面为 IP65 防护等级。于现场安装于户外时，需有「雨遮」保护机器，避免雨水从壁面流入机器本体内，造成电路氧化或短路。设备安装于墙面时，设备与墙面周围请用「硅利康Silicone」收边，同时也可防雨水由壁面渗入。

● 安装方法2—铁件预埋盒

下图为MT200 SERIES、下盖、以及预埋盒组合安装之分解图，请参照以下图示进行施工。

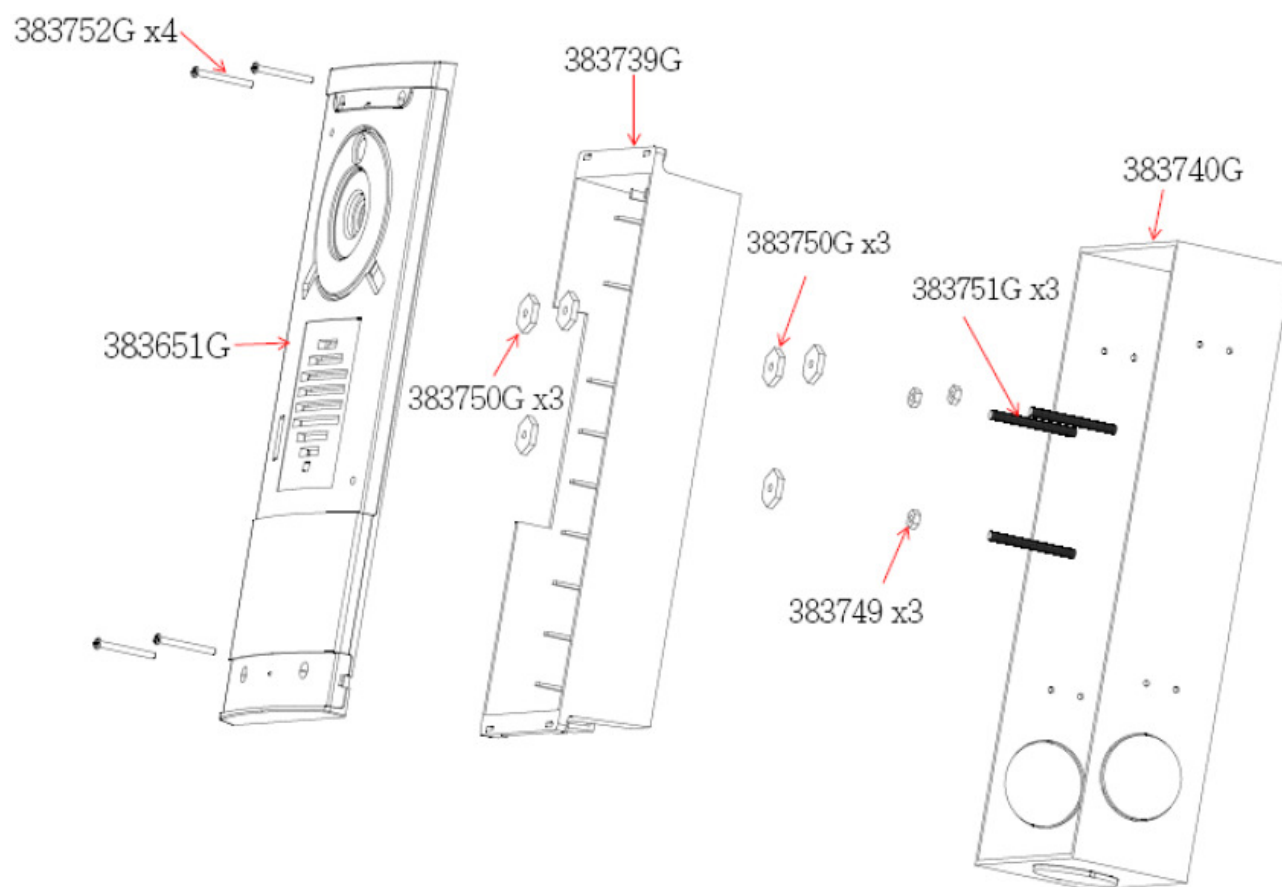

请将上饰板和下饰板分别黏贴于MT200 SERIES本体上。

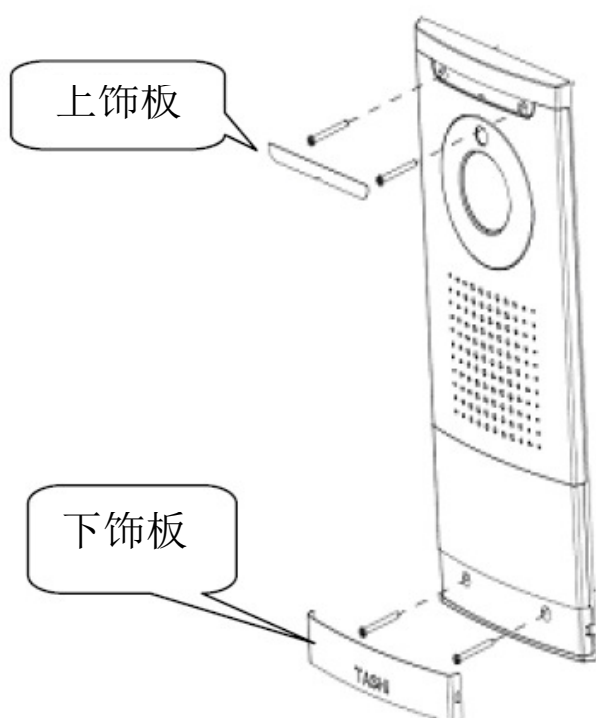

注意：

1. 上饰板与下饰板为耗材，请小心黏贴；若该耗材损毁而需要再次购买，请与经销商联络。
2. MT200仅正面为 IP65 防护等级。于现场安装于户外时，需有「雨遮」保护机器，避免雨水从壁面流入机器本体，造