

LiftMaster®

TX4UL

Remote Control 4 Channel

WARNING

To prevent possible **SERIOUS INJURY** or **DEATH** from a moving gate:

- ALWAYS keep remote controls out of reach of children. NEVER permit children to operate, or play with remote controls.
- Activate gate or door **ONLY** when it can be seen clearly, is properly adjusted, and there are no obstructions to door travel.
- ALWAYS keep gate or garage door in sight until completely closed. NEVER permit anyone to cross path of moving gate or door.

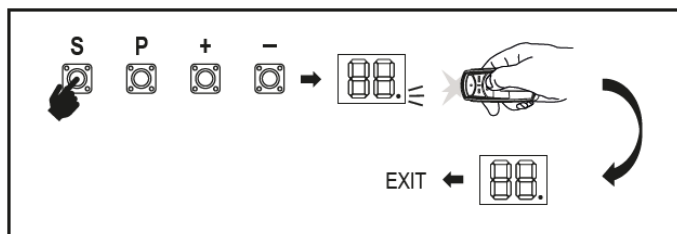

Your gate opener receiver and one of the buttons remote control are pre-programmed. If you purchase additional remote controls, the gate opener must be programmed to accept the new remote code.

NOTE: Only the original remote controls from the manufacturer should be used. Remote controls that may look very similar, but do not originate from the manufacturer are not compatible. Such third-party remotes create malfunctions such as automatic opening, and the guarantee on the function and safety expires.

Programming SL600UL, SL1000UL:

Press S for 1-2 seconds. LED begins to glow (for approx. 30 seconds).

Briefly press a button of the remote control.

LED goes out. The Code is programmed.

To Erase all Remote Control Codes:

All programmed remote control codes will be deleted. Press S and hold it until LED goes out (approx. 6 seconds). All programmed codes are now erased. Reprogram each remote control you wish to use.

How to use the Remote Control

Press and hold the button down until the gate starts to move. The remote control will operate from up to 3 car lengths away on typical installations. Installations and conditions vary, contact an installing dealer for more information.

Replacement Parts

3V CR2032 Lithium battery10A20

ONE YEAR LIMITED WARRANTY

LiftMaster warrants to the first consumer purchaser of this product that it is free from defect in materials and/or workmanship for a period of 1 year from the date of purchase.

Make: LiftMaster

Model: TX4UL

Description: Remote Control

Uses 1 3Vdc battery (CR2032)

Country of Origin: China

Operation of this equipment is subject to the following two conditions: (1) This equipment or device may not cause harmful interference and (2) this equipment or device must accept any interference, including that which may cause undesired operation.

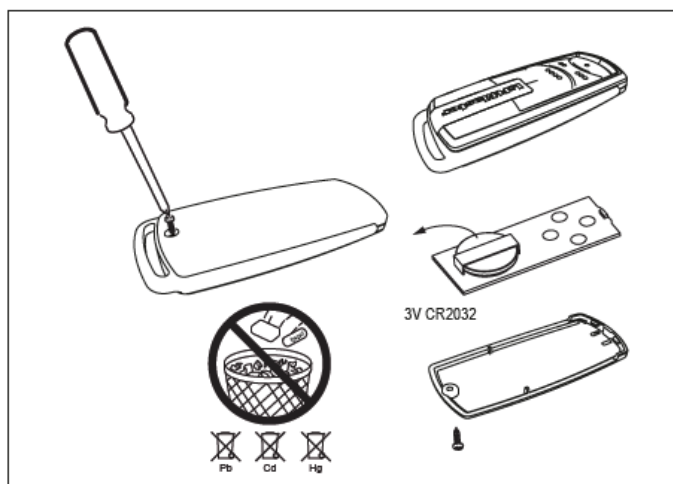

WARNING

To prevent possible **SERIOUS INJURY** or **DEATH**:

- NEVER allow small children near batteries.
- If battery is swallowed, immediately notify doctor.

To reduce risk of fire, explosion or chemical burn:

- Replace **ONLY** with 3V CR2032 coin batteries.
- **DO NOT** recharge, disassemble, heat above 212° F (100° C) or incinerate.

NOTICE: To comply with FCC rules, adjustment or modifications of this receiver and/or transmitter are prohibited, except for changing the code setting or replacing the battery. Changes or modifications not expressly approved by the party responsible for compliance could void the user's authority to operate the equipment.

THERE ARE NO OTHER USER SERVICEABLE PARTS.

Tested to Comply with FCC Standards FOR HOME OR OFFICE USE.

Operation is subject to the following two conditions: (1) this device may not cause harmful interference, and (2) this device must accept any interference received, including interference that may cause undesired operation.



WARNING: This product can expose you to chemicals including lead, which are known to the State of California to cause cancer or birth defects or other reproductive harm. For more information go to www.P65Warnings.ca.gov.

WARNING

- **INGESTION HAZARD:** This product contains a button cell or coin battery.
- **DEATH** or serious injury can occur if ingested.
- A swallowed button cell or coin battery can cause Internal Chemical Burns in as little as 2 hours.
- **KEEP** new and used batteries **OUT OF REACH** of **CHILDREN**.
- **Seek immediate medical attention** if a battery is suspected to be swallowed or inserted inside any part of the body.



- Remove and immediately recycle or dispose of used batteries according to local regulations and keep away from children. Do NOT dispose of batteries in household trash or incinerate.
- Even used batteries may cause severe injury or death.
- Call a local poison control center for treatment information.
- Battery Type: CR2032
- Battery Voltage: 3 V
- Non-rechargeable batteries are not to be recharged.
- Do not force discharge, recharge, disassemble, heat above (manufacturer's specified temperature rating) or incinerate. Doing so may result in injury due to venting, leakage or explosion resulting in chemical burns.
- Ensure the batteries are installed correctly according to polarity (+ and -).
- Do not mix old and new batteries, different brands or types of batteries, such as alkaline, carbon-zinc, or rechargeable batteries.
- Remove and immediately recycle or dispose of batteries from equipment not used for an extended period of time according to local regulations.
- Always completely secure the battery compartment. If the battery compartment does not close securely, stop using the product, remove the batteries, and keep them away from children

Contact Information

LiftMaster.com

LiftMaster Dealer Extranet: partner.liftmaster.com/

LiftMaster Training Academy: liftmastertraining.com

800-528-2806

Mon-Fri 5:00 am to 6:00 pm MST

300 Windsor Drive Oak Brook, IL 60523 **LiftMaster.com**

© 2024 The Chamberlain Group LLC
All Rights Reserved