



Asst. #91450  
Item. #91452

CREATION

# RADIO CONTROL BLACK RAPTOR CYCLE™



**WARNING:**  
**CHOKING HAZARD - Small parts.**  
**Not for Children under 3 years.**

**CAUTION:** Keep batteries away from children. Batteries may be harmful if swallowed. Requires three AA batteries and one 9V battery. Batteries not included. **NOTE:** Do not mix old and new batteries. Do not mix alkaline, standard (carbon-zinc) or rechargeable (nickel-cadmium) batteries. Dispose of used batteries properly.

**CAUTION: PLEASE READ BEFORE PLAYING WITH TOY**

- **Do not:** 1) aim toy at anyone, 2) hit anyone with toy, 3) poke anyone with toy, 4) swing toy at anyone, 5) step on toy.
- **Be careful** not to pinch fingers with hinged parts of toy.

RADIO CONTROL BLACK RAPTOR CYCLE 91452



Tested To Comply  
With FCC Standards

FOR HOME OR OFFICE USE

## CONTENTS

Black Raptor Cycle ..... 1  
Morpher Remote Control ..... 1

## HOW TO INSERT OR REPLACE BATTERIES

### 1 Black Raptor Cycle

- 1) Open battery case with a + screwdriver (not included). Turn screw counter-clockwise until loose, then remove battery case.
- 2) Insert or replace three AA batteries, making sure to match + and - indicators.
- 3) Reattach battery case and turn screw clockwise until secure.
- 4) Turn the switch "ON."

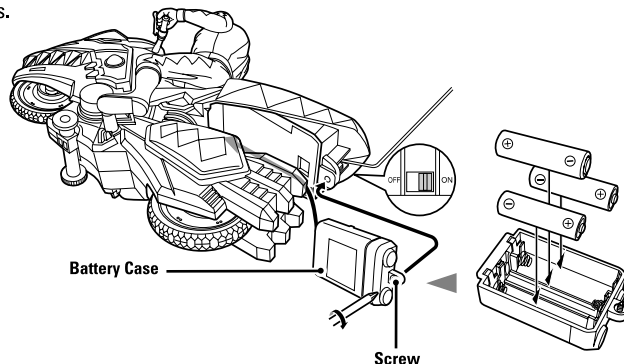

### 2 Morpher Remote Control

- 1) Open battery case with a + screwdriver (not included). Turn screw counter-clockwise until loose and remove cover.
- 2) Insert or replace one 9V battery, making sure to match + and - indicators.
- 3) Reattach battery case and turn screw clockwise until secure.
- 4) Turn the switch "ON."

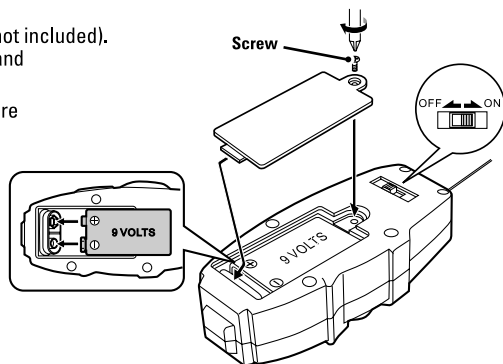

**NOTE:** Requires three AA batteries and one 9V battery. Batteries not included in this package.

## HOW TO PLAY WITH BLACK RAPTOR CYCLE

- 1 Push the left button to move Black Raptor Cycle forward and activate chomping action at the front.

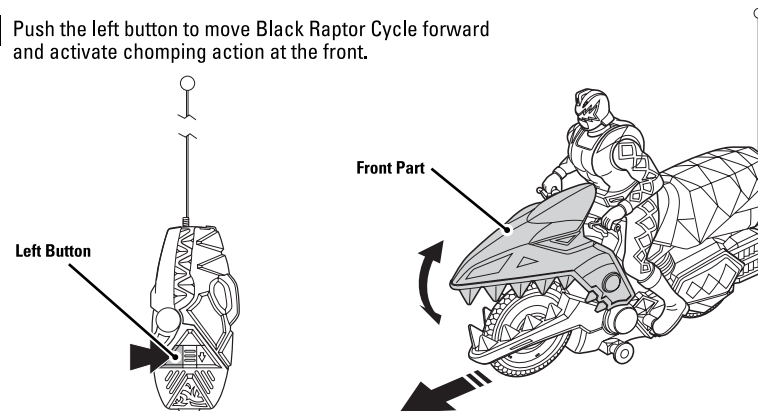

- 2 Push the right button to move Black Raptor Cycle backward and morph from Dino Thunder Black Ranger to teenager.

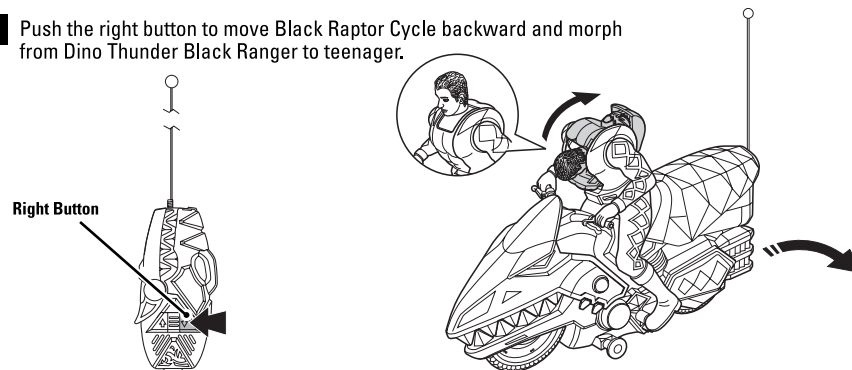

**NOTE:** Black Ranger cannot be detached from bike. Operational distance is approximately 15 feet. Carrier frequency is 49.860 MHz. Field strength is 67.5 dBu V/m at 3 meters. sensor on Cycle may not receive signal from remote control under certain conditions.

## DISCLAIMER

**Warning:** Changes or modifications to this unit not expressly approved by the party responsible for compliance could void the user's authority to operate the equipment. **NOTE:** This equipment has been tested and found to comply with the limits for a Class B digital device, pursuant to Part 15 of the FCC Rules. These limits are designed to provide reasonable protection against harmful interference in a residential installation. This equipment generates, uses and can radiate radio frequency energy and, if not installed and used in accordance with the instructions may cause harmful interference to radio communications. However, there is no guarantee that interference will not occur in a particular installation. If this equipment does cause harmful interference to radio or television reception, which can be determined by turning the equipment off and on, the user is encouraged to try to correct the interference by one or more of the following measures: • Reorient or relocate the receiving antenna. • Increase the separation between the equipment and receiver. • Connect the equipment into an outlet on a circuit different from that to which the receiver is needed. • Consult the dealer or an experienced radio/TV technician for help. Shielded cables must be used with this unit to ensure compliance with the Class B FCC limits. • This device complies with Part 15 of the FCC Rules. Operation is subject to the following two conditions: (1) This device may not cause harmful interference, and (2) This device must accept any interference received, including interference that may cause undesired operation.

Conforms to safety standard ASTM F963-96a. Color, style and decoration may vary. Manufactured by Bandai America Incorporated, Bandai Creation Division, 5551 Katella Avenue, Cypress, California 90630. TM & © 2003 BVS Entertainment, Inc. and BVS International N.V. Used under license by Bandai America Incorporated. All Rights Reserved.

BANDAI HK PRINT PROOF

ASST NO:

ITEM NO:

VERSION:

REVISION:

PREPARED BY:

DATE:

REMARK:

U/E		JAPAN			QA/QC			OTHERS		
RD	PS	JR	JP	JE	QA	QC	QS	A/C		
CONTROLLED DISTRIBUTION										

All the die cut film are just for your reference, pls check with the product.  
啤綫只作參考，請自行跟進。

BAI K 11"x8.5"

RO NO: 0209678-#91451

#91451

出片日期: 03年 09月 12 日