

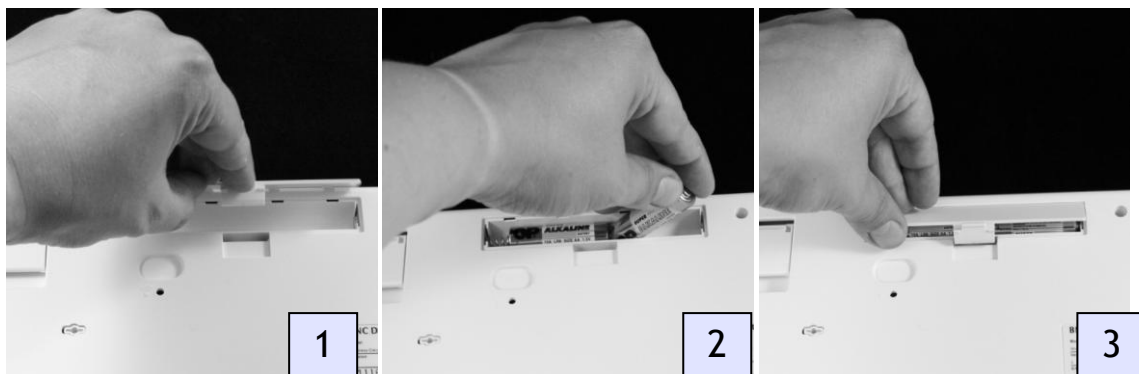

Bluetooth Clevy Keyboard (RJ Coopers coloured rows) User Manual

Batteries

Two AA batteries are required to power the keyboard.



Bluetooth pairing

Go to the Bluetooth preferences of your computer and search for devices. Then briefly press the keyboard's rear pairing button with the help of a pen or any other pointed object.



The device “Clevy Bluetooth Keyboard US” should appear. Subsequently, you can activate it and start using it after following the steps suggested by your operating system.

Led Lights

There are two led lights on the Clevy Keyboard. One on the left (blue) and one on the right (red). The light on the left hand side indicates the Bluetooth connection status. The light on the right hand side indicates the modes.

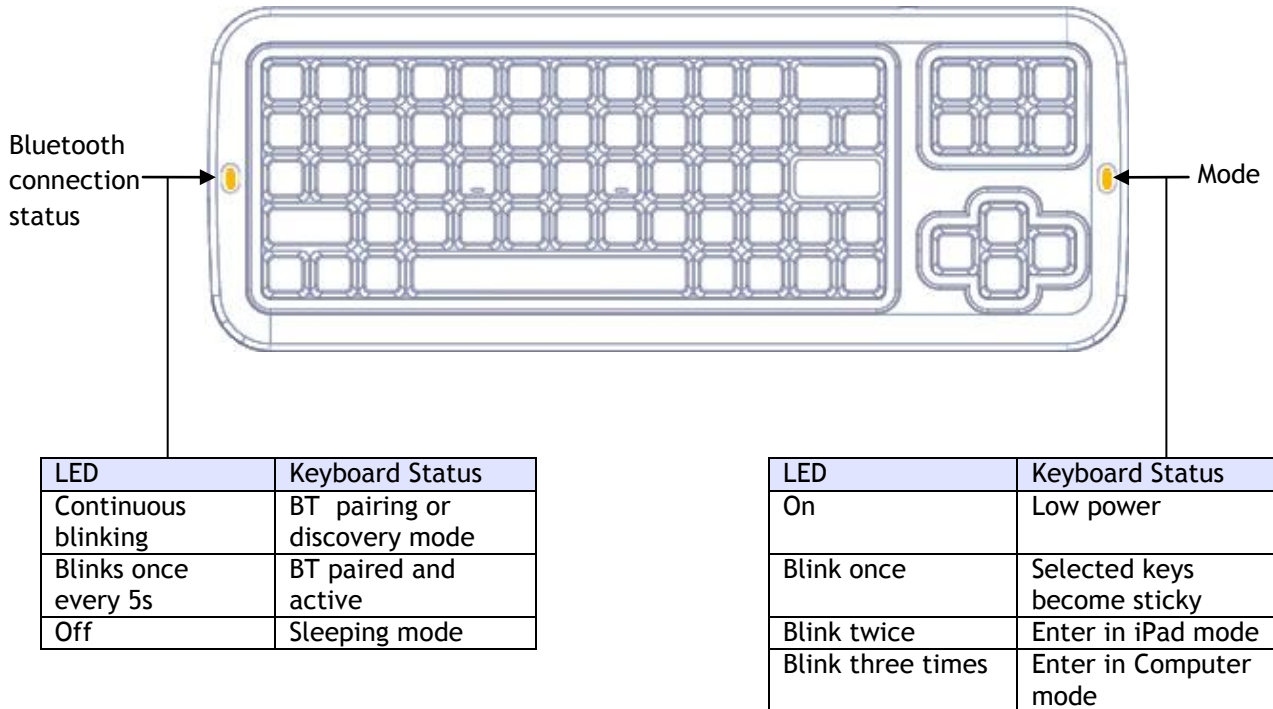

Note: In standby mode all LED's are switched off.

Key Repeat / Function Keys switch

On the backside of the keyboard is a switch. This switch enables the choice between two options:

Key Repeat

The repetition of a character when the user holds down a key representing that character.

Function Keys Tool

When you press and hold one of the following keys "F/ALT/AltGr/CTRL/SHIFT/Windows/Apple" for more than 2 seconds on the keyboard, the key is locked. You can then press another key to create a combination of keys. For example pressing ALT for 2 seconds, then pressing "F" for 2 seconds and finally press "4" will result in the "ALT+F4" command.

Note: If a key is locked, press it again to unlock it.

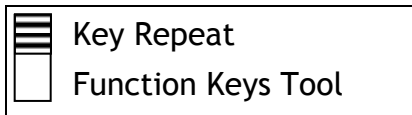

Key Repeat **ON** / Function Key Tool **OFF**

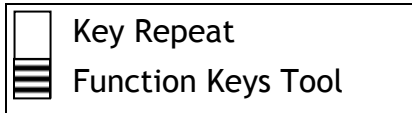

Key Repeat **OFF** / Function Key Tool **ON**

iPad / Computer modes

The keyboard is initially in iPad mode. Press **CTRL+ALT+C** to toggle to computer mode and press **CTRL+ALT+I** to toggle to iPad mode.

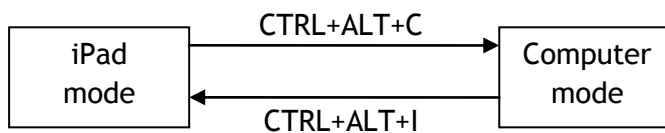

iPad mode

This mode features 2 shortcuts customized for iPad:

- Home = ALT+CTRL+H
- AltGr = LEFT+RIGHT

Computer mode

This mode is similar to typical keyboards.

If you have any other questions, please have a look here: www.clevy.com/faq, or contact us at the following email address: info@bnc-distribution.com.

Federal Communications Commission (FCC) Statement

You are cautioned that changes or modifications not expressly approved by the part responsible for compliance could void the user's authority to operate the equipment.

This equipment has been tested and found to comply with the limits for a Class B digital device, pursuant to part 15 of the FCC rules. These limits are designed to provide reasonable protection against harmful interference in a residential installation. This equipment generates, uses and can radiate radio frequency energy and, if not installed and used in accordance with the instructions, may cause harmful interference to radio communications. However, there is no guarantee that interference will not occur in a particular installation. If this equipment does cause harmful interference to radio or television reception, which can be determined by turning the equipment off and on, the user is encouraged to try to correct the interference by one or more of the following measures:

- Reorient or relocate the receiving antenna.
- Increase the separation between the equipment and receiver.
- Connect the equipment into an outlet on a circuit different from that to which the receiver is connected.
- Consult the dealer or an experienced radio/TV technician for help.

This device complies with Part 15 of the FCC Rules. Operation is subject to the following two conditions:

- This device may not cause harmful interference, and
- This device must accept any interference received, including interference that may cause undesired operation of the device.

FCC RF Radiation Exposure Statement

This equipment complies with FCC radiation exposure limits set forth for an uncontrolled environment. End users must follow the specific operating instructions for satisfying RF exposure compliance. This transmitter must not be co-located or operating in conjunction with any other antenna or transmitter.