

General Introduction

SR203 is a panic button designed with a specialized panic function that enables users to activate an emergency panic condition instantly. By simply pressing the button on the device, an emergency event notification is promptly transmitted to the VIAS host system. The seamless integration of SR203 with our U-Net family security products makes it a perfect fit for VIAS. Its compatibility and reliability make it an ideal choice for enhancing security measures in modern households.

Product Overview

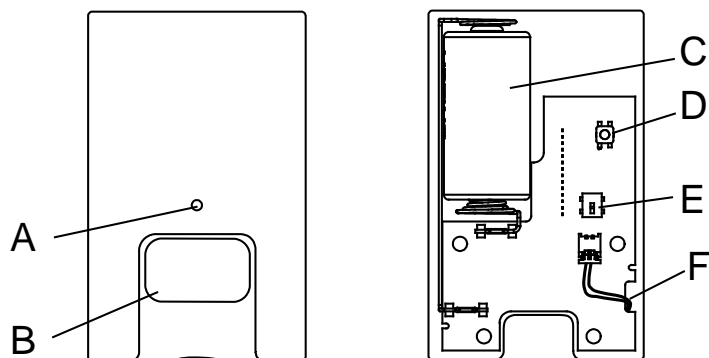

A.	LED indicator
B.	Panic button
C.	Battery (CR123A)
D.	Binding button
E.	Tamper switch
F.	Vibration motor

Installation

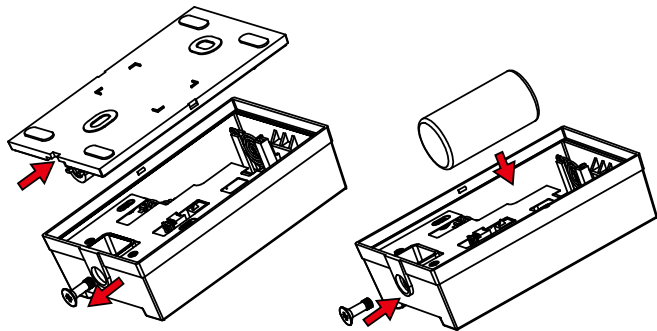

Pairing to controller

1. Use a screwdriver to open the back plate and insert 1 CR123A battery as shown below.
2. When the battery installed on the first time, SR203 panic button will be in auto-pairing status for 30seconds. If it's time out, reinstall the battery again can initiate the auto-binding mode again.
3. Locate the Binding button "D" (see Product Overview).
4. Log into the VIAS account from the APP, and enter the gateway to system main control page.
5. Please follow and complete the instruction on the APP to binding with central gateway.
6. If the button has been added on another controller before, you need to run manual binding to another one. Press and hold the binding button for more than 3 seconds until the LED flashes moderately then release the button.
7. The LED should stop blinking indicating the pairing process is complete.

LED Indicators

Function	LED status
Binding mode	Green LED flashes with a 0.5-second interval, continuously flashing for 30 seconds.
Reset to factory mode	Green LED alternates between 2 seconds on and 2 seconds off.
Binding Error	Indicator light flashes with a 0.1-second interval, flashing three times.
Binding Success	Indicator light turns off.
Panic Sending Success or Fail	When panic is activated, LED flashes for 1 second , then flashes until controller confirms back the signal received successfully in Green LED on 3 seconds or received fails in Red LED on 3 seconds .

Mounting

Choosing a location

Where possible, mount the panic button under the table or in a reasonable location, so that when an emergency occurs, users can press the panic button to report to the VIAS system and trigger an alarm event, subsequently connecting to the security system.

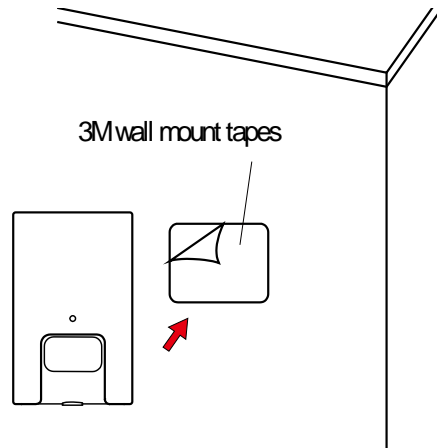

Operation

The device information page will display device's status as shown below.



SR203 will vibrate and transmit a panic message to the VIAS system where the icon will be displayed as shown below.

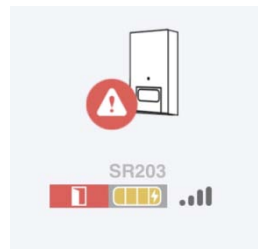

When the cover of the SR203 is removed, the tamper icon (hammer) is displayed as below.

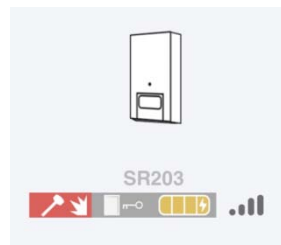

Other settings

Press the panic button icon on device list to enter the Sensor Information page. You can assign it into different areas and classify it in the rooms, where you can set the zone behaviors and zone type attributed to panic button or run RF testing. On the top right advance settings options, there are several features can be set.

Panic activation level: fast or slow

There are two types of activation ways for triggering the panic button. You can select fast or slow to activate the panic event.

- Fast Mode: Panic event can be activated either by pressing the red button press 2 times within 1.5 seconds or press and hold over around 2 seconds (release before 8seconds).
- Slow Mode: Panic event can be activated either by pressing the red button press 3 times within 1.5 seconds or press and hold over around 3 seconds (release before 8seconds).
- LED indicator: enable or disabled
- Vibration Strength: High, Low or Off.
- Tamper detection: enable or disabled

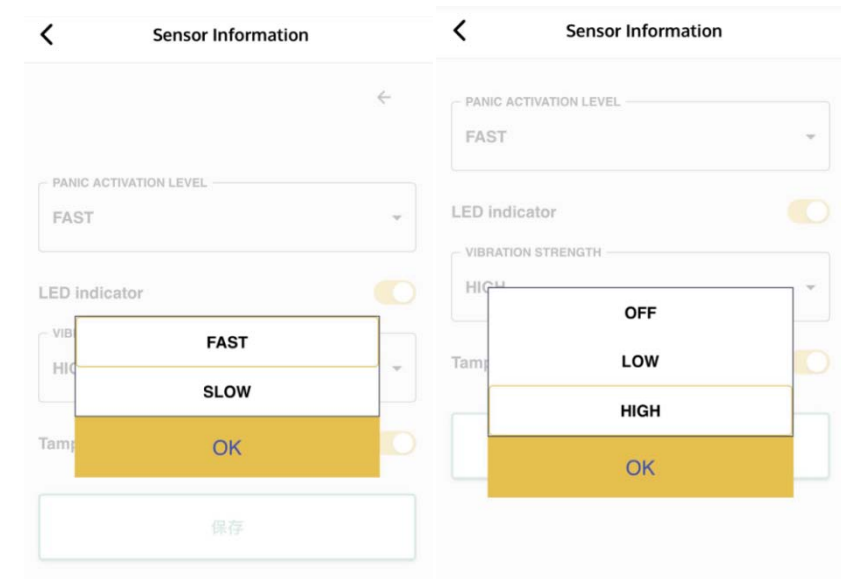

When the settings have been changed, press the save button on APP and you need to active the panic button again to keep the settings on the device or wait until sensor next report to controller then it will change to new settings.

Maintenance

Low Battery: When the battery becomes low, it will report to the controller. Please replace the battery when receive the notification. After "LOW BATTERY" warning, it can still remain in standby mode for an additional 30 days

Software reporting commands

Battery condition	Auto report battery condition to controller every hour.
-------------------	---

Troubleshooting

The troubleshooting table lists some possible causes and solutions. Please contact your original retailer or nearest service center if the below solutions cannot solve your problem.

Symptom	Possible Cause	Recommendation
Device unable to operate, LED not displaying	1.The device is not properly connected powered	Please check the battery connection, or replace a new battery
The buttons are functional, but VIAS control is not working:	There might be interference from nearby sources emitting radio waves on the same frequency.	Please try again later.
LED does illuminate, appliance does not respond	Binding with controller did not complete successfully.	Bind again using manual binding

Reset to Factory Settings

1. Enter binding mode by press and holding the binding button for a minimum of 3 seconds..
2. Then press and hold the binding button again, this time for 6 seconds until the LED turns off. Reset to factory settings is complete.

Specifications

Operating temp	-20°C ~ +50°C
Storage Temp	-20°C ~ +60°C
Operating Humidity	95%RH Max
Battery Type	1 x CR123A

Low Battery Detection	When the battery level is too low, it will be reported to VIAS. After "LOW BATTERY" warning, it can still remain in standby mode for an additional 30 days
Battery life	Estimated 5years (if the device is operated once a month with motor vibration feedback and LED flashing)
RF Protocol	U-Net 5.0
RF frequency	SR203-1(EU): 868MHz SR203-2(US): 923MHz
RF transmission range (@free space)	SR203-1(EU): up to 1000M line of sight SR203-2(US): up to 400M line of sight
Security Grade 2, Environmental Class II	EN 50131-1:2006/A1:2009/A2:2017/A3:2020, EN 50131-3:2009, EN 50131-5-3:2017, EN 50131-6:2017/A1:2021

** Specifications are subject to change without notice.



WARNING:

Do not dispose of electrical appliances as unsorted municipal waste, use separate collection facilities. Contact your local government for information regarding the collection systems available.

If electrical appliances are disposed of in landfills or dumps, hazardous substances can leak into the groundwater and get into the food chain, damaging your health and well-being.

When replacing old appliances with new ones, the retailer is legally obligated to take back your old appliance for disposal free of charge.

CAUTION:

RISK OF EXPLOSION IF BATTERY IS REPLACED BY AN INCORRECT TYPE. DISPOSE OF USED BATTERIES ACCORDING TO THE INSTRUCTIONS

Federal Communication Commission Interference Statement

FCC warning:

This device complies with part 15 of the FCC Rules. Operation is subject to the following two conditions: (1) This device may not cause harmful interference, and (2) this device must accept any interference received, including interference that may cause undesired operation.

Any Changes or modifications not expressly approved by the party responsible for compliance could void the user's authority to operate the equipment.

Note: This equipment has been tested and found to comply with the limits for a Class B digital device, pursuant to part 15 of the FCC Rules. These limits are designed to provide reasonable protection against harmful interference in a residential installation. This equipment generates uses and can radiate radio frequency energy and, if not installed and used in accordance with the instructions, may cause harmful interference to radio communications. However, there is no guarantee that interference will not occur in a particular installation. If this equipment does cause harmful interference to radio or television reception, which can be determined by turning the equipment off and on, the user is encouraged to try to correct the interference by one or more of the following measures:

- Reorient or relocate the receiving antenna.
- Increase the separation between the equipment and receiver.
- Connect the equipment into an outlet on a circuit different from that to which the receiver is connected.
- Consult the dealer or an experienced radio/TV technician for help.

This equipment complies with FCC radiation exposure limits set forth for an uncontrolled environment. This equipment should be installed and operated with minimum distance 20cm between the radiator & your body.

Industry Canada statement:

This device complies with Industry Canada licence-exempt RSS standard(s).

Operation is subject to the following two conditions: (1) This device may not cause interference, and (2) This device must accept any interference, including interference that may cause undesired operation of the device.

Le présent appareil est conforme aux CNR d'Industrie Canada applicables aux appareils radio exempts de licence. L'exploitation est autorisée aux deux conditions suivantes:

- (1) l'appareil ne doit pas produire de brouillage, et
- (2) l'utilisateur de l'appareil doit accepter tout brouillage radioélectrique subi, même si le brouillage est susceptible d'en compromettre le fonctionnement.

This equipment complies with IC RF radiation exposure limits set forth for an uncontrolled environment.

This equipment should be installed and operated with a minimum distance of 20 centimeters between the radiator and your body."

Ce matériel est conforme aux limites d'exposition aux rayonnements rf de ic énoncés dans un autre environnement.

Ce matériel doit être installé et exploité à une distance minimale de 20 cm entre le radiateur et votre corps.



EVERSPRING®
www.everspring.com

50 Sect. 1 Zhonghua Rd Tucheng
NewTaipeiCity 236 Taiwan