

60-4422

Dodge Viper GTS-R

Thank you for purchasing your Dodge Viper GTS-R from RadioShack. Built to 1:12 scale, it can reach speed of 1020 feet per minute with turbo function and it is perfect for children, ages 8 and up.

What's Included

Dodge Viper GTS-R

Transmitter

9.6V Rechargeable Battery Pack (Ni-Cd 700mAh)

9.6V Battery Pack Charger (AC 120/DC 12V 200mA 6 Hour)

9V Battery

Please read this user's guide before installing, setting up and using your new product.

IMPORTANT: The rechargeable Ni-Cd battery pack is not charged, please charge it for six hours prior to use.

Charging Rechargeable Ni-Cd Battery pack

1. Plug the battery charger into a standard AC outlet.
2. Attach the battery pack and charger connectors. They fit together only one way. Do not force them. Charging time is needed at least 6 Hour.
3. To disconnect the connectors from charger and battery pack, unplug the charger from the AC outlet, then press down on the clip and pull apart and also please do not pull on the connector's wires. You might damage the battery pack.

How to connet

How to connet

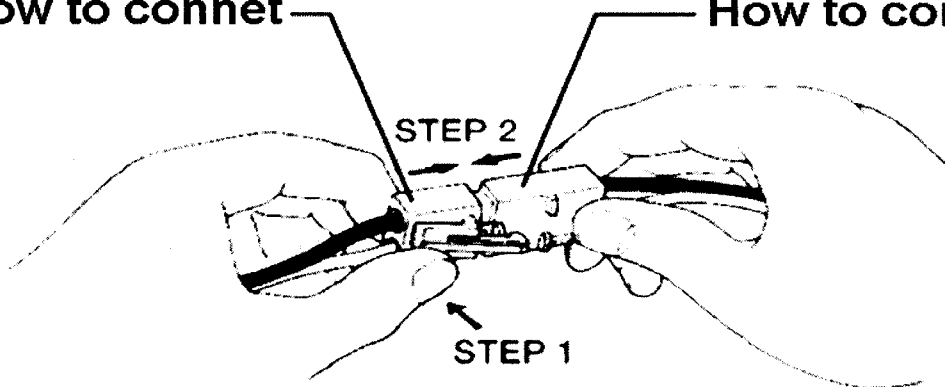

NOTES:

After charging, the battery pack will be warm. This condition is normal for fully charged battery pack. Overcharging could damage it.

If the speed of the vehicle getting down suddenly, it is time to recharge.

When the power of battery pack is finished. The battery pack will get hot, let cool it down for at least 20 minutes before recharging.

Note: Recharging a warm or hot battery pack, it will greatly shorten the useful life of the battery pack.

Battery Pack Care

1. Make sure the battery pack and the charging connectors are dry before you start to recharge the battery pack.

2. Battery pack can be charged for long times without harm.

Cautions:

Do not charge a battery pack that is hot, wet or shows leakage or corrosion.

The battery pack may explode if disposed of in fire!

Do not disassemble the battery pack.

Installing Your Batteries

One 9.6V rechargeable battery pack (Ni-Cd 700mAh) for the vehicle (included) and one 9V battery for transmitter (included).

In Your Vehicle

1. Set ON/OFF on the bottom of the vehicle to OFF.
2. Use a coin to turn the battery compartment's latches in the direction of the arrow. Lift the cover to remove it.
3. Place the battery pack in the compartment with the wires in the slot on the side of the compartment. Attach the battery pack's white plastic connector to the vehicle's matching connector. Do not force them together. They fit only one way. Carefully tuck in the wire.
4. Replace the cover and secure the latches

Note: If the vehicle runs slowly, not at all, or does not respond to the transmitter, recharge the rechargeable battery pack.

In the Transmitter

1. Slide ON/OFF on the transmitter to OFF.
2. Slide the battery compartment cover in the direction of the arrow to remove the cover.
3. Snap the 9V battery in the compartment according to the polarity symbols (+and-) marked inside.
4. Replace the cover and snap it shut.

Note: When your transmitter's range decreases, replace its battery.

Driving Your Vehicle

1. Turn your transmitter and vehicle ON.
2. Use the control levers to drive your vehicle.

Left Control Lever

- Push forward to move forward
- Push right then further forward for turbo speed
- Pull back to move backward
- Release to stop.

Right Control Lever

- Push left to move left.
- Push right to move right
- Release to go straight

When you finish driving your vehicle, turn your vehicle and transmitter OFF.

Caution

If the vehicle gets stuck under an object, immediately release the control levers

on the transmitter and retrieve it.

Battery Notes :

- Dispose of batteries promptly and properly; do not burn or bury them.
- Do not recharge non-rechargeable batteries.
- Use only fresh batteries of the required size and recommended type.
- Do not mix old and new batteries, different types of batteries (standard, alkaline, or rechargeable), or rechargeable batteries of different capacities
- If you do not plan to use your vehicle or transmitter for several days, remove all the batteries from the transmitter and the vehicle. Batteries can leak chemicals that can destroy electronic parts.
- Never leave dead or weak batteries in the transmitter or vehicle.

Caution

- Do not charge or recharge the battery pack while it is in the vehicle.
- After you charge or recharge the battery pack, disconnect it from the charger. Overcharging the battery pack could damage it.
- When you disconnect the battery pack from the charger, do not pull on the connector's wires. You might damage the battery pack.

Hint

- Running your vehicle continuously for long periods generates high heat levels. Heat causes wear and tear on the motor. To help keep heat levels down, when your vehicle's battery pack dies, let the vehicle cool at least 10 minutes before installing a new or newly charged battery pack.
- If someone uses a CB nearby, it might interfere with control of the vehicle. If this happens, move the vehicle away from the CB.
- You cannot operate your vehicle near devices with transmitters that use the same frequency as your vehicle (27 MHz or 49 MHz). Check your vehicle's box to see which frequency your vehicle uses.
- If the vehicle does not drive in a straight line when you release the right control lever, adjust the wheel alignment control on the bottom of the vehicle. Turn the control toward L if the vehicle is pulling to the right or toward R if the vehicle is pulling to the left.

Care and Maintenance

- Keep the vehicle dry; if it gets wet, wipe it dry immediately.
- Use and store the vehicle in normal temperature environments only.

- Handle the vehicle carefully; do not drop it.
- Keep the vehicle away from dust and dirt, and wipe it with a damp cloth occasionally to keep it looking new.
- Do not drive your vehicle through puddles or mud, in the rain, snow or sand.
- Modifying or tampering with the vehicle's internal components can cause a malfunction and might invalidate its warranty, and void your FCC authorization to operate it.

The FCC wants you to know

Your vehicle might cause TV or radio interference even when it is operating properly. To determine whether your vehicle is causing the interference, turn off your vehicle and transmitter. If the interference stops, your vehicle or transmitter is causing it. Try to eliminate the interference by:

- Moving your vehicle away from the receiver.
- Contacting your local RadioShack store for help.

This device complies with Part 15 of the FCC rules. Operation is subject to the following two conditions:

- (1) this device may not cause harmful interference, and
- (2) this device must accept any interference received, including interference that may cause undesired operation.

Changes or modifications to this product not expressly approved by RadioShack, or operation of this product in any other way other than as detailed by the User's Guide, could void your authority to operate your vehicle.

Product	: Dodge Viper GTS-R
Model	: 60-4422
Responsible Party	: RadioShack
	300 RadioShack Circle
	Fort Worth, TX 76102
Phone	: 817-415-3200

UL CAUTION

PLEASE SUPPLY ISI wordings if you have.

Warranty

Date code

60-4422

printed in China