

# Occupancy Sensor (PIR) Settings

The items in the table below are available in all wiring diagrams

## Unoccupied



If the time since last presence detection exceeds the minimum Occupancy threshold setting (30-120 mins), the system predicts that the room is no longer occupied and your predefined Unoccupied Heat/Cool setpoints (or set-back temperatures) take effect. Once a room is considered unoccupied, the thermostat allows the ambient room temperature to drift to the Unoccupied minimum or maximum temperature setpoint. The thermostat will return to the default mode and comfort setpoint once presence is detected again.

## Occupied



The guest room is considered “occupied” when the occupancy sensor detects movement. While the guest room is “occupied”, the room temperature will be maintained according to the mode and temperature set point selected by the user.

Option		Default
Local Occupancy Sensor (PIR)	You can choose to utilize the occupancy sensor to set the room temperature while it is not being occupied  Options: On, Off	On
Incidental Occupancy Threshold	The thermostat will enter the occupied mode for a duration of this threshold that is selected here once occupancy is detected. It allows for incidental room visits.  In minutes: 0 to 30 minutes	0 min(s)
Occupancy Threshold	The thermostat will enter the unoccupied mode from occupied mode with this threshold selected.  In minutes: 30, 45, 60, 75, 90, 105, or 120 minutes	60 min(s)
Occupancy Prediction Threshold	In minutes: 0 to 30 minutes	0 min(s)
Occupancy Prediction Start	In hours: 24 hour clock	21:00
Occupancy Prediction End	In hours: 24 hour clock	9:00
Cycle Minimizer	Options: On, Off	On
Unoccupied Cool Setpoint	—	83°F
Unoccupied Heat Setpoint	—	62°F
Current PIN Code on Thermostat	—	000000
Reset PIN Code to Thermostat	—	—

# Manage Properties and Profiles

## Create a Property

1. Tap the Manage tab.

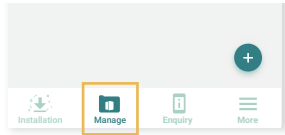

2. Tap the Add button (+).

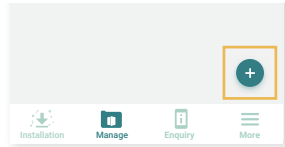

3. Enter your property name and then tap Save.

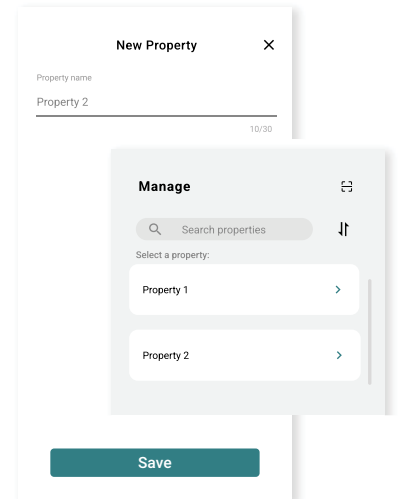

### Note

The system will automatically generate a property name during creating a new property, such as Property 2.

## Edit a Property

1. Tap the property you want edit.

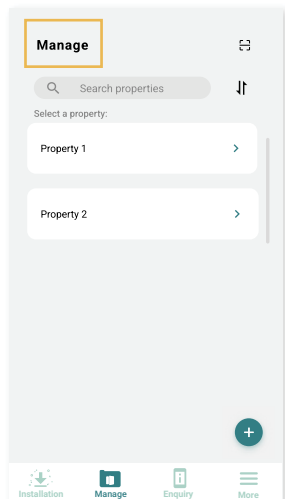

2. Tap the Edit icon (✎), then select Edit Property from the drop down menu and then enter the new property name and tap Save.

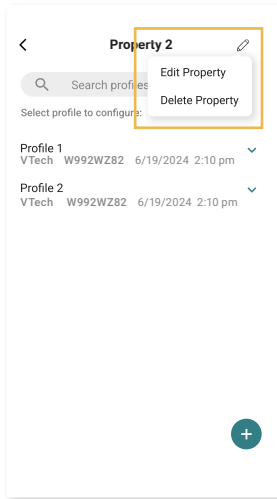

# Manage Properties and Profiles

## Delete a Property

1. Tap on the property you want to delete.

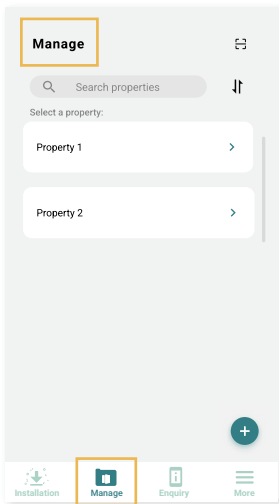

2. Tap on the Edit icon (✎) and select Delete Property from the drop-down menu

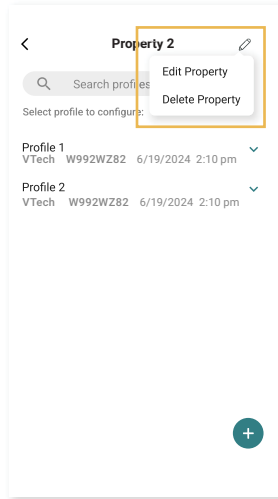

3. Tap Delete on the popup window to confirm deletion.

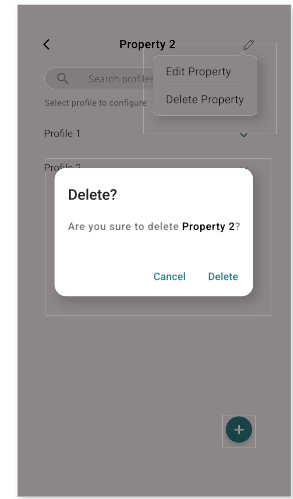

## Create a Profile

1. Tap to select a property.

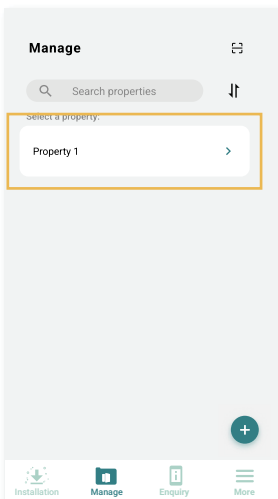

2. Tap the Add icon (+) to create a new profile.

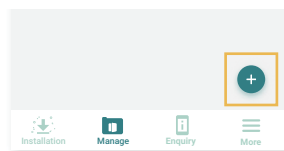

3. Follow the steps on page 4 to create a new profile: Enter your profile name, and select thermostat model, wiring diagram, etc.

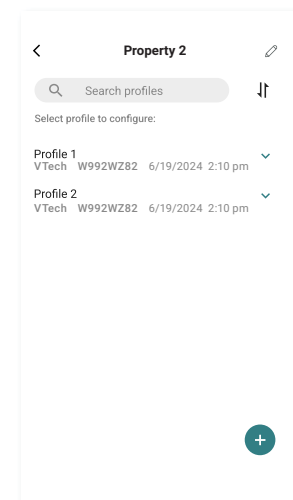

# Manage Properties and Profiles

## Edit a Profile

1. Tap on the property you want to edit.

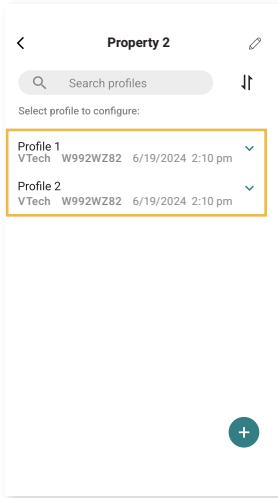

2. Tap edit (  Edit ) to edit the selected profile and follow the steps in define profile settings and values on pages 18-25.

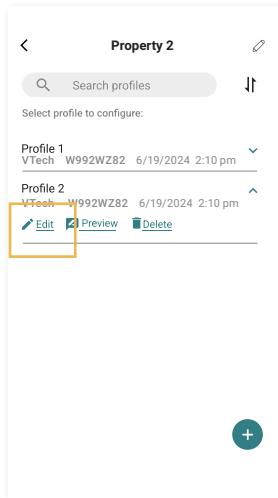



### Note

To quit the editing process, tap X in the top right at any time. The changes you have made will not be saved to the EC Tool Pro app.

## Preview a Profile

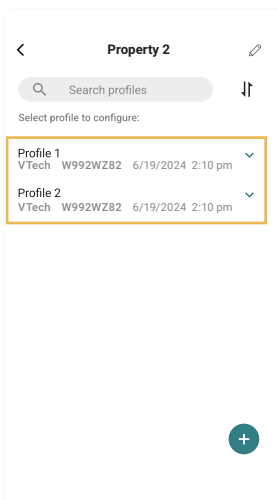
1. Tap on the profile you want to view.



2. Tap preview (  Preview ) under the selected profile.

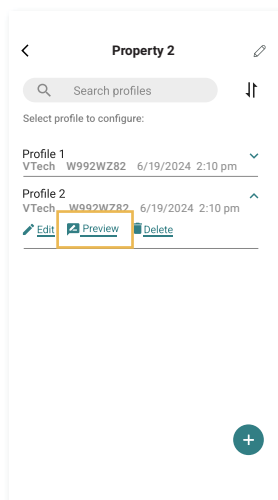

3. Scroll down through all of the settings.

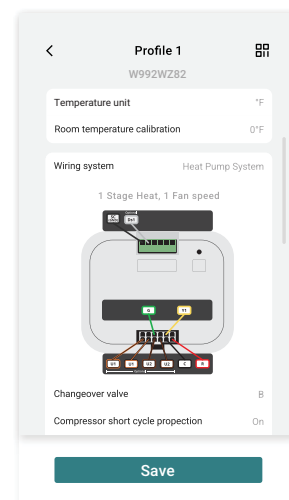

# Manage Properties and Profiles

## Preview a Profile

### 4. Save the profile's QR code (optional)

Tap the QR code icon on the top right. Tap Save Photo to save the QR code to your photo library on your smartphone and send it to another smartphone for scanning it later to view the profile. You can also ask another system administrator or engineer to scan this QR code saved on your smartphone.

#### Note

- The interface is a preview only and no settings can be adjusted here. To edit the profile settings, tap the Edit icon instead.
- **Save the profile's QR code features** - Transferring a profile to another EC Tool Pro app. This feature helps you easily transfer a profile. After saving the profile to another EC Tool Pro app, you can edit it there to be a new profile.

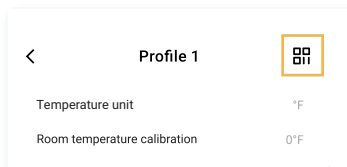

## Delete a Profile

1. Tap on the profile you want to delete. Then tap the delete (Delete).

2. Tap Delete on the popup window to confirm deletion.

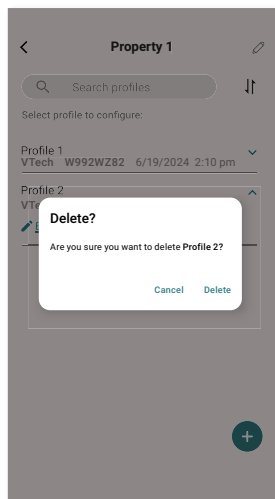
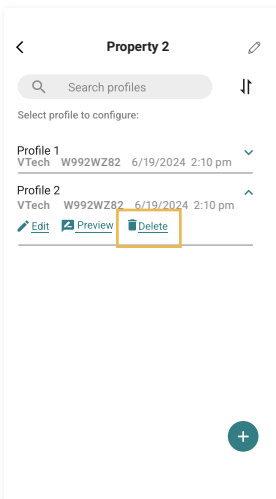

# Manage Properties and Profiles

## View Profile - QR Code

Tap Scan icon on top right and scan the QR code you have sent to another smartphone to view the profile's details.

**Note**  
The interface is a preview only and no settings can be adjusted here. To edit the profile settings, tap the Edit icon instead.

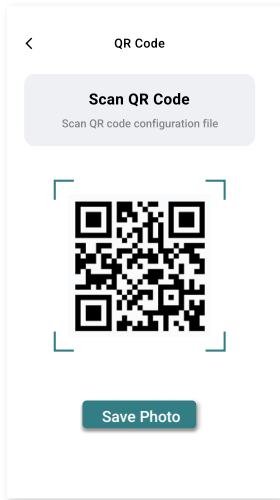

## Install a Saved Profile

1. Tap Installation tab, then select a property.



2. Tap the Install icon for the profile you want to install.

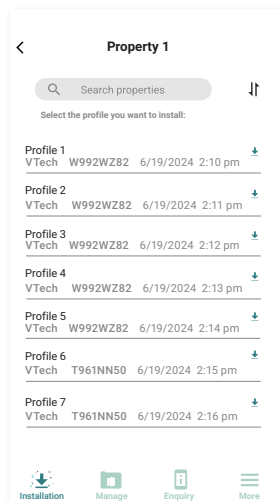

3. Enter your room name and tap Next.

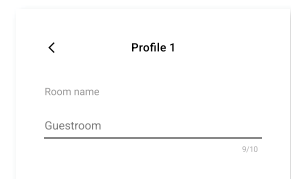

**Note**

- System will automatically generate Guestroom as the room name.
- Naming rule: Only numbers, letters, and spaces up to 10 characters are allowed.

# Install a Saved Profile

## Preview PIN

4. If the current PIN recorded in the profile here matches the one on your thermostat, Tap Next. If it doesn't match, tap Manage tab to update the current thermostat PIN recorded in the profile to match the one on your thermostat, then tap Installation tab to restart the installation process.

or

Tap Set temporary current PIN, then enter the temporary current PIN to match the one on your thermostat, and tap Next.

- To cancel setting temporary current pin, tap Remove temporary pin.

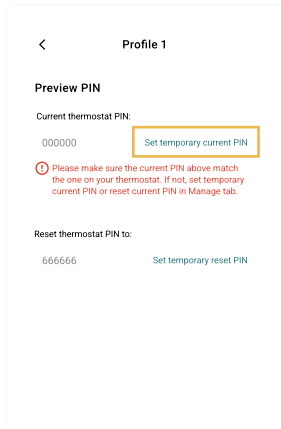

### Note

- To check your thermostat's current PIN, refer to pages 43 & 45.
- To set temporary reset PIN, tap Set temporary reset PIN. After installing the profile on your thermostat, your thermostat's PIN will be updated to the temporary reset PIN, but neither the temporary current PIN nor the temporary reset PIN will be recorded in the profile.

## Preview Wiring Diagram

5. Tap Next after previewing the wiring diagram.

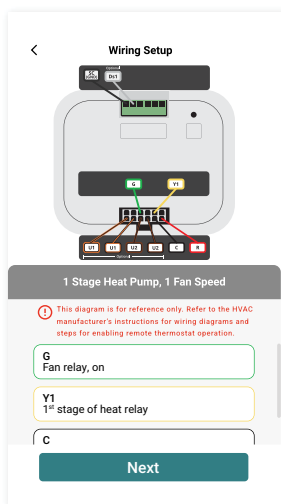

## Install Profile

6. Once you see the Connect Device screen in the app, move to the thermostat. Using Mode (⌘), Up (△), and Down (▽) keys, select System Settings > System Configuration > Adv. Config. via App > Bluetooth.

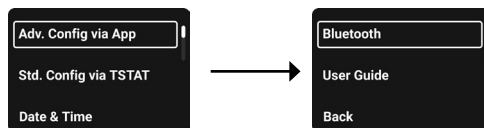

# Install a Saved Profile

7. After selecting Bluetooth, a QR code will appear on the thermostat display. Using the app, tap Scan QR Code, then use your camera to scan the QR code displayed by the thermostat.



8. Enter the Bluetooth passkey that appears on the thermostat into the app, then tap Start to install the profile. Once the profile has been installed, you will see Success! popup in the app and the thermostat. The thermostat will reboot upon completion and tap the Done button in the app. You can now test the thermostat.

iOS

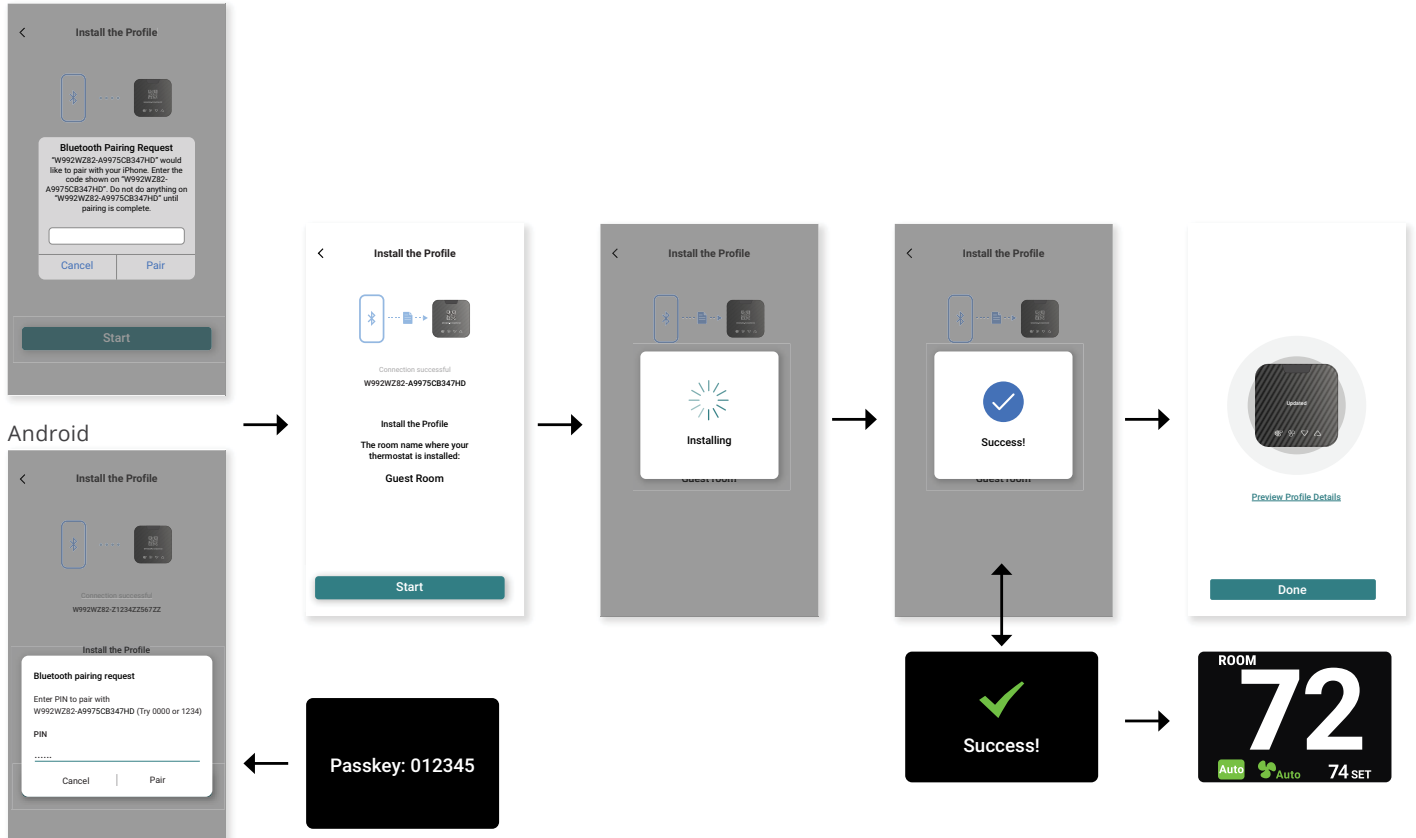

# View and Save Thermostat Profile

## Access Profile

1. In the Engineering mode on the thermostat, enable Bluetooth and connect to your phone.
2. After selecting Bluetooth, a QR code will appear on the thermostat display. Using the app, tap Scan QR Code, then use your camera to scan the QR code displayed by the thermostat.

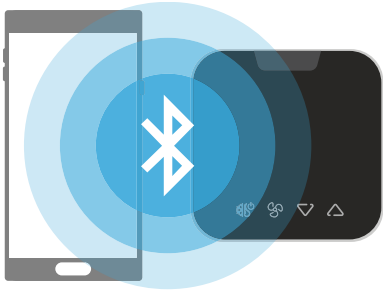

3. Enter the randomly generated six digit Bluetooth passkey that appears on the thermostat into the app, then tap Start to access the profile. After accessing the profile, you can view its details.

iOS

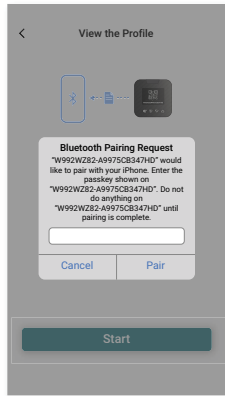

Android

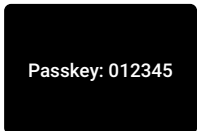
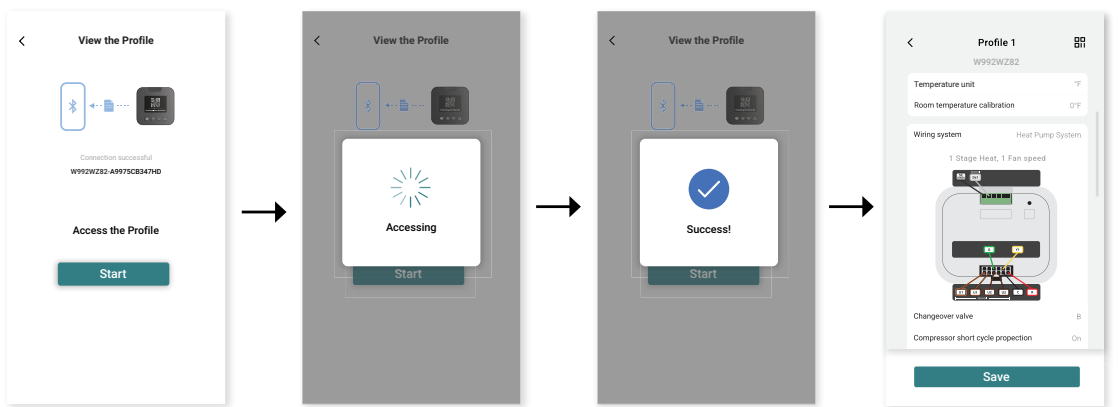
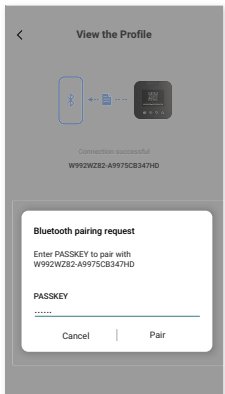

---

# View and Save Thermostat Profile

## Save Profile's QR Code

4. Tap the QR code icon (📄) on the top right to open the profile's QR code.
5. Tap Save Photo to save the QR code to your photo library. This allows you to scan it later to view the profile. You can also share the QR code with another smartphone for future scanning and profile viewing. Then tap < on top left to go back to the interface for profile setting details.

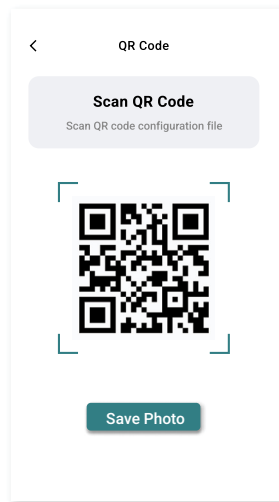
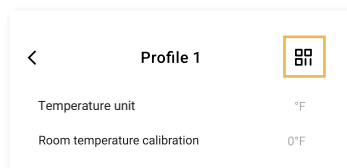

## Save Profile to EC Tool Pro App

6. Tap Save and then select your target property, or tap Add icon (+) to create a new property. If your target property already has a profile with a duplicated name, the app will remind you to rename this profile. You can rename it, create a new property, or choose to quit saving.
7. Tap Next to save the profile to this target or newly-created property and go back to the property list in Manage tab.

## Scan Profile's QR Code

8. To view a profile by scanning its QR Code, tap the scan (📄) icon in top right corner of the app. This will open the Scan QR Code screen. You can then scan the QR code displayed in your photo library or on another smartphone.

### Note

- **Save profile's QR code and Save profile features**

Transferring a profile to another EC Tool Pro app is important. Both features help you easily achieve this goal. After saving the profile to another EC Tool Pro app, you can edit it there to be a new profile.

---

# App Error Messages and Troubleshooting

## Popup Error Message

## Solution

---

1.

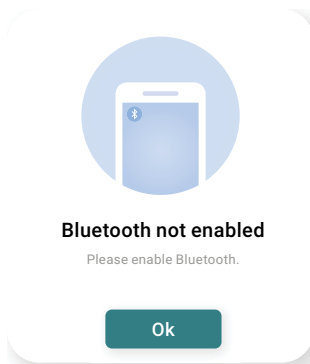

Tap OK and enable Bluetooth on your thermostat.

2.

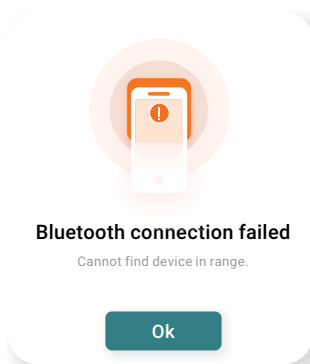

Tap OK. Then tap < on top left to go back to the Connect Device page. Tap Scan QR Code or Search for Device.

3.

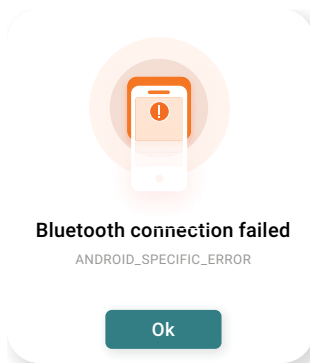

Tap OK. Then tap < on top left to go back to the Connect Device page. Tap Scan QR Code or Search for Device.

4.

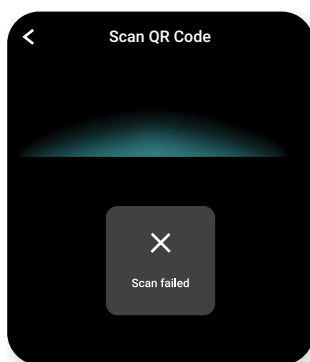

Tap < on top left to go back to the Connect Device page. Tap Scan QR Code or Search for Device.

---

# App Error Messages and Troubleshooting

## Popup Error Message

## Solution

---

5.

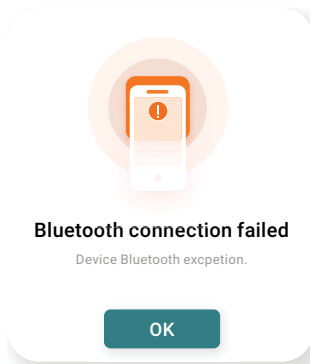

Tap OK. Your smartphone will automatically start searching for any thermostats that are nearby. If several thermostats are found, tap Connect to the right of a W992WZ82 that thermostat you want to connect to.

6.

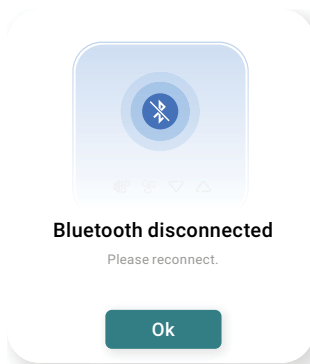

Tap OK. Your smartphone will automatically start searching for any thermostats that are nearby. If several thermostats are found, tap Connect to the right of a W992WZ82 that thermostat you want to connect to.

7.

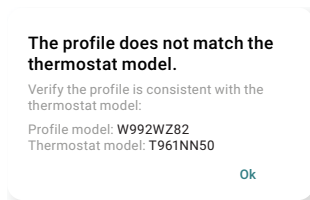

Tap OK. Then tap < on top left to go back to the Connect Device page. Tap Scan QR Code or Search for Device.

OR

Tap OK. Your smartphone will automatically start searching for any thermostats that are nearby. If several thermostats are found, tap Connect to the right of a W992WZ82 that thermostat you want to connect to.

# App Error Messages and Troubleshooting

## Popup Error Message

## Solution

8.

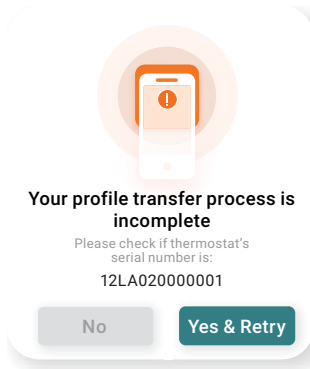

Tap Yes & retry to install the profile transfer via Bluetooth, or Tap No, then Back to quit installation.

### Note

- Check the thermostat's serial number in the label at the back of the thermostat, or its the engineering menu About This Unit.
- To check the thermostat's serial number in its the engineering menu About This Unit, please refer to Engineering settings on pages 43-45.
- If you quit the installation in this step, you need reset your thermostat to factory defaults first before you install a profile on it next time.

### ⚠ CAUTION

The serial number shown on the prompt is the serial number of your previously installed thermostat recorded this profile. Both thermostat and profile must have the same serial number for a safe profile transfer. Otherwise, both the thermostat you are setting up, but with a different serial number, and the other with the same serial number as the profile, may damage.

9.

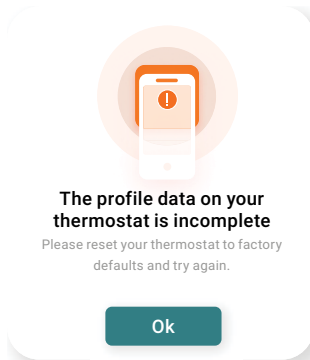

Tap OK to restore the thermostat to factory default settings, and try to install the profile on your thermostat via Bluetooth again.

# App Error Messages and Troubleshooting

## Popup Error Message

## Solution

10.

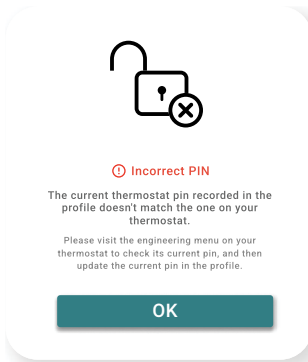

1. Tap OK to set temporary current pin.
2. Check the thermostat's PIN in the engineering menu PIN & Room Name.
3. Tap Set temporary current pin, then enter the temporary current PIN.
4. Tap Next to go on installing the profile.
  - To remove temporary current pin, tap Remove temporary pin.

OR

1. Tap Manage to Go to the homepage of Manage tab.
2. Check the thermostat's PIN in the engineering menu PIN & Room Name.
3. Select the profile you are installing in Manage tab, then tap [Edit](#) to enter the correct current thermostat PIN.
4. Try again to install the profile on your thermostat via Bluetooth.

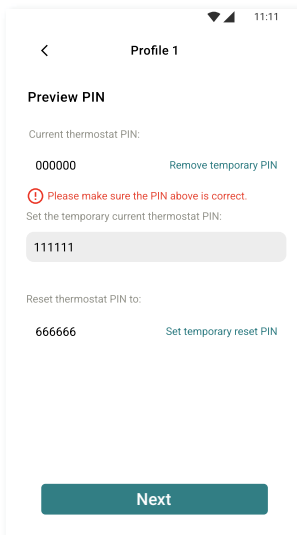
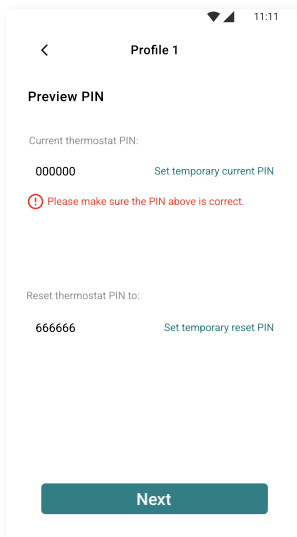

# App Error Messages and Troubleshooting

## Popup Error Message

## Solution

11.

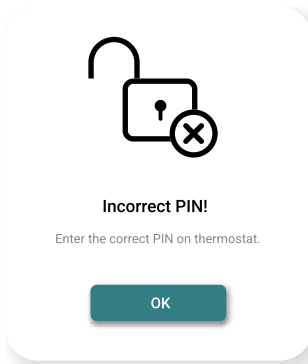

1. Tap OK.
2. Check the thermostat's PIN in the engineering menu PIN & Room Name.
3. Select the profile in Manage tab, then tap [Edit](#) to enter the correct current PIN on thermostat.
4. Try again to install the profile on your thermostat via Bluetooth.

12.

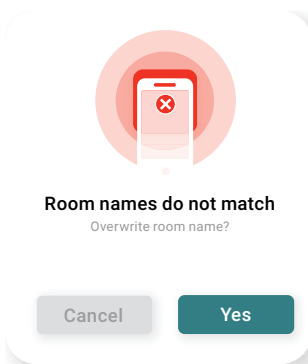

1. Tap Yes to confirm to overwrite the room name recorded in your thermostat, then go on the profile transfer via Bluetooth.  
OR  
Tap Cancel to quit the installation.
2. Check the thermostat's room name in the engineering menu PIN & Room Name.
3. Select the profile in Manage tab, then tap [Edit](#) to rename this profile.
4. Try again to install the profile on your thermostat via Bluetooth.

### Note

To check the thermostat's room name, refer to Engineering settings on pages 43-45.

13.

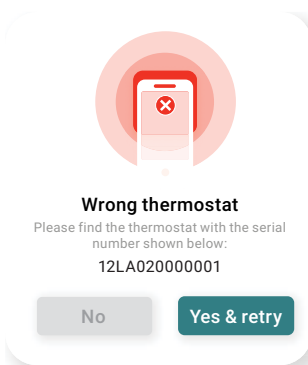

- Find the thermostat with the same serial number shown on the prompt, then tap Yes & retry to confirm and install the profile via Bluetooth.
- OR
- Tap No, then Back to quit the installation.

### Note

- Check the thermostat's serial number in the label at the back of the thermostat, or its the engineering menu About This Unit.
- To check the thermostat's serial number in its the engineering menu About This Unit, please refer to Engineering settings on pages 43-45.

### ⚠ CAUTION

The serial number shown on the prompt is the serial number of your previously installed thermostat recorded this profile. Both thermostat and profile must have the same serial number for a safe profile transfer. Otherwise, both the thermostat you are setting up, but with a different serial number, and the other with the same serial number as the profile, may damage.

---

# App Error Messages and Troubleshooting

## Popup Error Message

## Solution

---

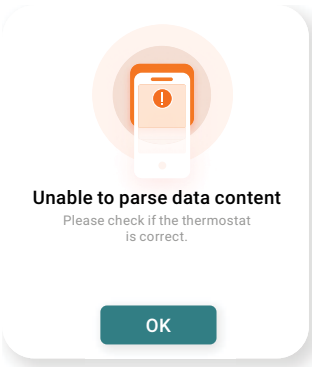
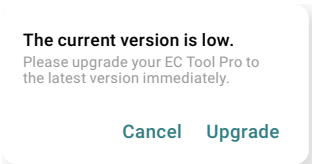
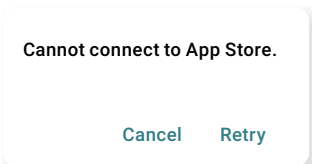
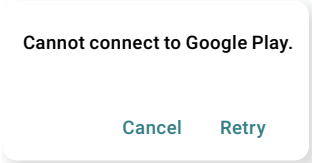
14.  Tap OK, then check if your thermostat's model number is W992WZ82. If yes, tap Installation tab and install a profile on your thermostat.
15.  Tap Upgrade to upgrade your EC Tool Pro to the latest version.
16.  Tap Retry to connect to App Store or Google Play for upgrading your EC Tool Pro App.
- 

---

# Engineering Menus

## Engineering Settings

If no profile has been installed on your thermostat, the thermostat will enter its engineering mode when it is powered up. If a profile has been installed on your thermostat, tap and hold the Fan/🌀, Down/▽, and Up/△ buttons simultaneously for at least eight seconds at home screen to enter the engineering mode menu. If the thermostat is not at home screen or you are setting temperature on the thermostat, you will not enter the engineering mode even if you tap and hold these three buttons simultaneously for at least eight seconds.



# Engineering Menus

## Engineering Mode Menu

Follow these steps to set up your thermostat on its four-level engineering menus:

1. Tap Down/▽ and Up/△ to rotate through the menu items. The last item loops back to first item at the end of items in menu. Tap Mode/⌘ or Fan/⌘ to enter a sub-menu item.
2. Tap Down/▽ and Up/△ to change the setting in the sub-menu item. Tap Mode/⌘ or Fan/⌘ to confirm the setting and return to menu item selection. Settings will not be changed unless you confirm the setting by tapping the Mode/⌘ or Fan/⌘ button.
3. To leave Engineering Mode, navigate back to the first level until (Exit) menu item appears and tap Mode/⌘ or Fan/⌘.

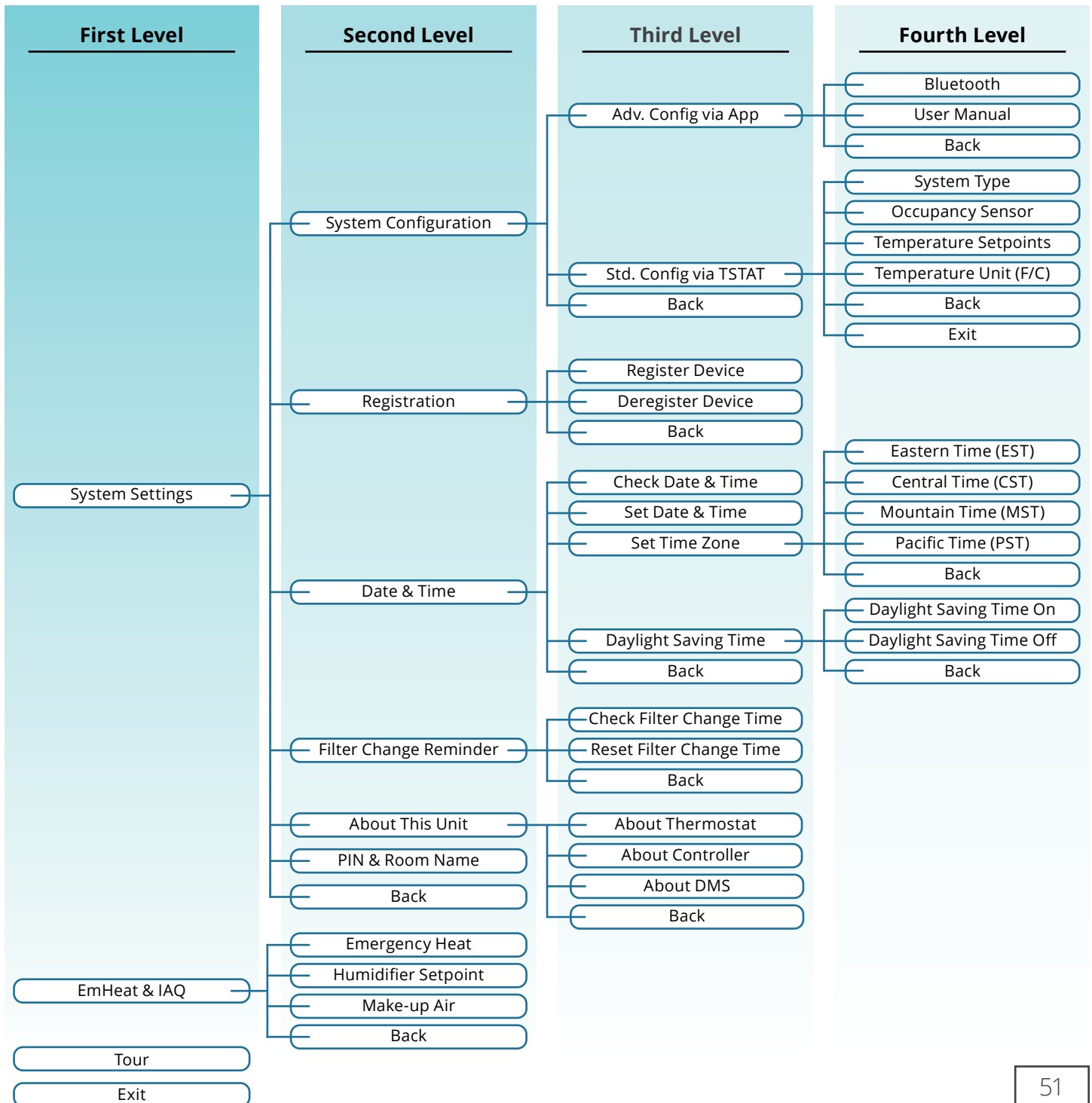

---

# Engineering Menus

## Engineering Mode Menu

System Configuration	Scan the QR code displayed in this menu to visit W992WZ82's web page at <a href="http://www.vtechhotelphones.com">www.vtechhotelphones.com</a> .
Check Date & Time	<p>This menu may display:</p> <ol style="list-style-type: none"><li>1. Factory default time.</li><li>2. User setting time.</li><li>3. The message Clock is not set yet.</li></ol> <p>One of the time zones may display in this interface: (EST) -5, (CST) -6, (MST) -7, (PST) -8, the four time zones of United States and (UTC) +8, the coordinated Universal Time</p>
Set Date & Time	<p>Follow these steps to set the clock date and time.</p> <ol style="list-style-type: none"><li>1. The four digits of the year will start to flash on the display.</li><li>2. Repeatedly to select the year, and then tap Mode or Fan.</li><li>3. Tap Up or Down to cycle through the years until the required year is displayed and leave it to activate.</li><li>4. Repeat step 2 to change your month &gt; day &gt; time &gt; AM/PM &gt; Time Zone &gt; Daylight Saving Time. A check mark will appear when the setting is activated.</li></ol> <p><b>NOTE</b></p> <ul style="list-style-type: none"><li>• If you do not tap any button for about five minutes while setting the clock, the current setting page will stay on the screen when waking up the screen.</li><li>• You can also set time zone and turn daylight saving time on or off in the menu Set Time Zone and Daylight Saving Time respectively.</li></ul>
Set Time Zone	<ul style="list-style-type: none"><li>• Tap Up or Down or to go through the time zones and tap Mode or Fan to select your desired time zone. It will take three to four seconds to update the setting. A check mark will appear when the setting is activated.</li><li>• Four time zone options: (EST) -5, (CST) -6, (MST) -7, (PST) -8</li><li>• If you have set the date and time in "Set Date &amp; Time" menu, then change the time zone in this menu, the set date and time will be automatically updated to the new time zone.</li></ul>
Daylight Savings Time	If you select Daylight Saving Time On or Daylight Saving Time Off, it will take three to four seconds to update the setting. A check mark will appear when the setting is activated.
Filter Change Reminder	If no profile has been installed on your thermostat or Filter Change Reminder is disabled, this menu will not appear in the engineering mode menu.
Check Filter Change Time	<p>The screen may display the days left or the filter change reminder.</p> <ol style="list-style-type: none"><li>1. The days remaining of seven days or above.</li><li>2. The days remaining (shown in red text) of the last six days or below.</li><li>3. The red message The filter change time has expired / Replace your filter immediately displays when time is out. The filter change reminder/  displays on the screen at the same time.</li></ol>



---

# Engineering Menus

## Engineering Mode Menu

Reset Filter Change Time	Select Reset to restart the countdown of filter change time. The countdown days, namely filter change time, have been and can only be configured in the EC Tool Pro app.
About This Unit	About This Unit Model W992WZ82 Firmware Version No. [Firmware version No. (E.g., W01B21)] Serial No. [Your thermostat's serial number (e.g., 12LA020000001)]
PIN & Room Name	If a profile has been installed on your thermostat, it will display: About PIN & Room Name PIN [The six-digit password set in the profile (e.g., 666666)] Room Name [The room name set in the profile (e.g., Guestroom1)]  If no profile has been installed on your thermostat, it will display: About PIN & Room Name PIN 000000 (the factory default password) Room Name UNKNOWN
Tour	If no operation is performed in five seconds, the system returns. Nothing will be saved during TOUR mode.

# Configuration via the Thermostat Menu

If you need to reenter the Engineering Menu to make any changes after configuration is completed, tap and hold    for 10 seconds. If you used the App for configuration and set a security PIN, you will need to make all changes from the app.

**Note**  
The onboard programming menu will allow you to configure PTAC-Heat Pump, PTAC-Conventional, 2-Pipe FCU, and 4-Pipe FCU systems and their basic setpoints. For additional system support and access to all of the setpoints and features, use the EC Tool Pro app to create a custom profile for your HVAC system.

1. Turn on the power to your HVAC system. When the thermostat powers up, you will see the Main menu. Select System Settings by tapping the Mode/Fan button.

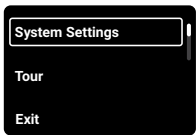

2. Then select System Configuration and choose Std. Config via TSTAT.

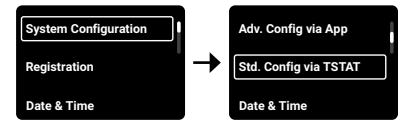

3. Select System Type, then Change System Type. From there, you will select the system your facility uses and the settings associated with your system.

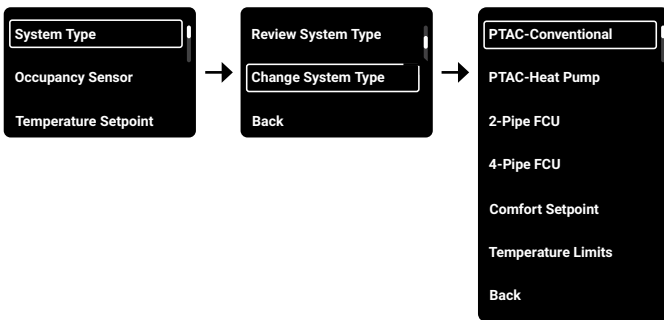

### Example for PTAC-Conventional

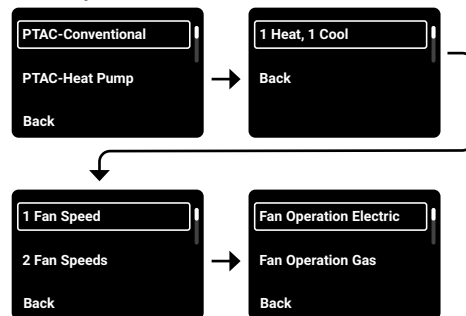

4. Once you are done with the settings, tap the Mode/Fan button and you will see the thermostat updating. Once it has been updated, you can continue within settings or scroll down to the Back button. Test your system to verify functionality and replace the cover.

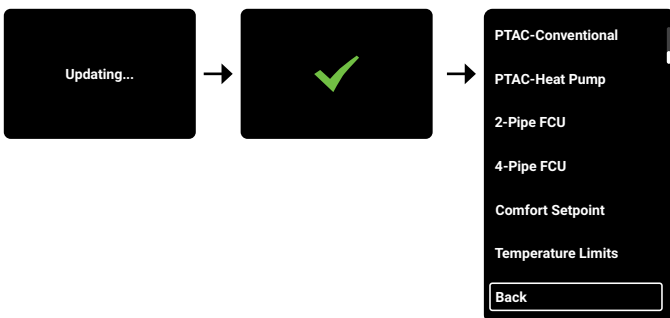

**Note**  
You will have to manually navigate to the beginning of the settings and exit the menu.

## Power Outages

When a temporary or extended power outage occurs or there is a power loss that affects the HVAC equipment, the thermostat display will turn off. Once power is restored to the system, the thermostat will automatically resume HVAC control based on the last known settings prior to the outage with a few possible exceptions:

### Before Powering Off

### After Powering On Again

The schedule icon/🕒 is on the screen.

The schedule icon/🕒 is still on the screen.

The schedule held icon/👉 is on the screen.

The schedule held icon/👉 is still on the screen if the next schedule event hasn't begun yet.

An error alert with E01-E04 error code(s) displays on the thermostat screen.

The error alert is still there if the problem wasn't automatically fixed during the restart.

### Before Powering Off

### While Powering Off

### After Powering On Again

The schedule icon/👉 is on the screen.

The schedule hold icon/👉 changes back to the schedule icon/🕒 if the next scheduled event has been executed at its preset start time.

An error alert with E01-E04 error code(s) displays on the thermostat display.

The error alert is cleared from the display if the problem has been automatically fixed during the restart.

The thermostat is in override mode.

The thermostat exits override mode.

A new profile is installed on the thermostat.

The new profile is activated and the thermostat settings are updated with the new profile.

## Restore Factory Defaults

The thermostat can be reset to factory default. Resetting to factory default will remove all stored programs and parameters. Once the reset is complete, the thermostat must be reprogrammed before it will function again.

To perform a factory reset:

1. The thermostat must be connected to a 24v power source.
2. When your thermostat is on the home screen, tap and hold Fan/🌀, Down/▽, and Up/△ simultaneously for at least eight seconds to enter the Engineering Mode
3. With the thermostat in Engineering Mode, tap and hold Mode/⚙️, Fan/🌀, Down/▽, and Up/△ simultaneously for eight seconds to restore the factory default settings.

After the reset is complete, the thermostat will return to the default engineering menu.

# Thermostat Error Alerts and Troubleshooting

If an error alert displays on your thermostat's screen, the screen will turn off after five minutes of idleness. To wake the thermostat screen from idle, tap any of the four hard buttons (Mode/⚙️, Fan/🌀, Down/▽, or Up/△) on the thermostat display unit. From there, you can check the current error alert again.

When errors are resolved, the alert will be cleared and the system will return to normal operation.

## Error Alert Examples

The examples show the following error codes and messages:

- E01:** Call for service E01. T: Zigbee FW Version: 10123001, T: UI FW Version: W01B21
- E02:** Call for service E02. T: Zigbee FW Version: 10123001, T: UI FW Version: W01B21
- E03:** Call for service E03. T: Zigbee FW Version: 10123001, T: UI FW Version: W01B21
- E04:** Call for service E04. T: Zigbee FW Version: 10123001, T: UI FW Version: W01B21
- E01 E02 E03:** Call for service E01 E02 E03. T: Zigbee FW Version: 10123001, T: UI FW Version: W01B21
- E01 E02 E04:** Call for service E01 E02 E04. T: Zigbee FW Version: 10123001, T: UI FW Version: W01B21

**Note**

T = Thermostat | C = Controller

Tap the down button to view the controller information.

Error Code	Error	Severity Rating
E01	Low voltage - Thermostat's voltage is insufficient and not within the normal range.	Critical
Reason	Solution	Note
Wiring error or circuit problem	Power off the HVAC equipment, check the wiring and circuit, and then power up it again after making sure the current and circuit is normal.	The standard power supply of the thermostat is 24V, and the normal voltage range is 18-30V. The voltage range of E01 alarm occurs when the voltage detected is 30.1-33V and 17.9-9V.

---

## Thermostat Error Alerts and Troubleshooting

Error Code	Error	Severity Rating
------------	-------	-----------------

E02	High internal heat - Thermostat's internal temperature is above 167°F (75°C).	Critical
-----	---	----------

Reason	Solution	Note
--------	----------	------

Wiring error or circuit problem	Power off the HVAC equipment, check wiring and circuit, and then power up thermostat again after its internal temperature is below 167°F (75°C).	
---------------------------------	--	--

Error Code	Error	Severity Rating
------------	-------	-----------------

E03	Clock is not set or RTC lost power.	Critical
-----	-------------------------------------	----------

Reason	Solution	Note
--------	----------	------

The clock hasn't been set yet, or RTC lost power during the power outage.	After powering up the thermostat again, tap Fan, Down, and Up for at least eight seconds to enter Set Date & Time menu to set date & time, time zone, and turn Daylight Saving Time on or off, or install the profile into thermostat by Bluetooth feature.	RTC will lost power due to both a dead or failing backup battery and HVAC power failure. The RTC backup battery is a non-replaceable battery designed for an operational life of 10 years.
---	---	---

Error Code	Error	Severity Rating
------------	-------	-----------------

E04	RTC (Real time clock) IC is not working.	Critical
-----	--	----------

Reason	Solution	Note
--------	----------	------

RTC IC is damaged.	Replace the existing thermostat with a new one.	RTC IC is non-replaceable.
--------------------	---	----------------------------

# Operation

---

## Wake up Screen

There are two types of idle screens. If Always-on display is enabled via the EC Tool Pro app, the thermostat's screen will go dim after eight seconds of idleness and the idle screen can show the current HVAC mode, fan mode, room temperature, and the set temperature.

There are three brightness levels for the dimmed display. Dimmed display brightness is set to level two by default. level three is the brightest, while level one is the dimmest. You can adjust the level of dimmed display brightness via the EC Tool Pro app.

## Levels of Dimmed Display Brightness

---

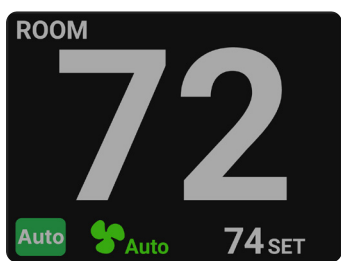

Level 1 (minimum)

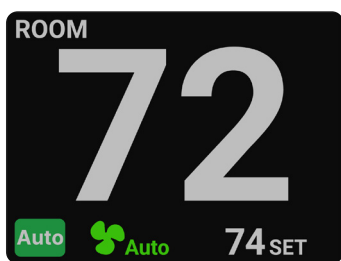

Level 2 (default)

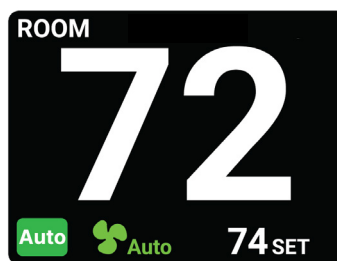

Level 3 (maximum)

If Always-on display is disabled via the EC Tool Pro app, the screen will go dim after eight seconds of idleness and then turn black eight seconds after that.

To wake the thermostat screen from idle, tap any of the four touch buttons (Mode, Fan, Down, or Up) on the thermostat.

From there, you can check the current HVAC mode, fan mode, room temperature, and the set temperature.

The humidity, schedule and filter change reminder features are disabled by default. If these three features are enabled via the EC Tool Pro app, the current room humidity and schedule icon will also be displayed on both the dimmed screen and awake screen, but the filter change reminder will only be displayed on the screen when your filter life is low and it's time to replace.

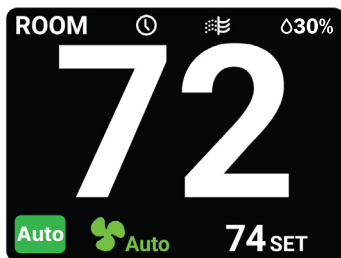
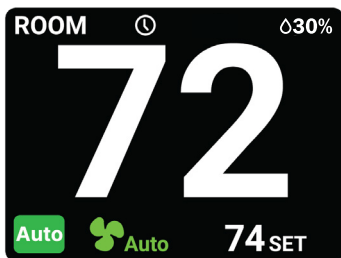

### Note

If you tap the up or down button to wake up the screen, the set temperature will go to the next available degree by +/-1°F or +/-0.5°C.

## Schedule

If a daily schedule has been programmed via the EC Tool Pro app, you will see a schedule icon displayed on the screen. Adjusting any settings will override the existing schedule and a hold icon will be displayed until the next scheduled event. You can exit the hold and return to your schedule at any time by tapping and holding the Fan button for three seconds.

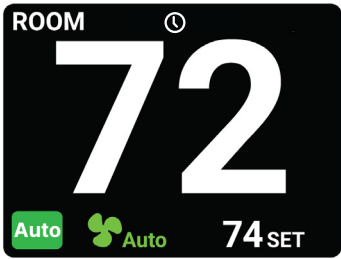

Schedule Enabled

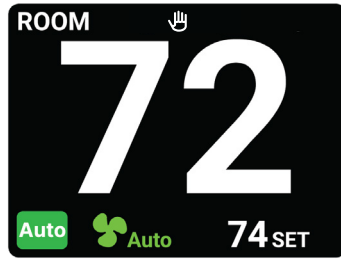

Schedule On Hold

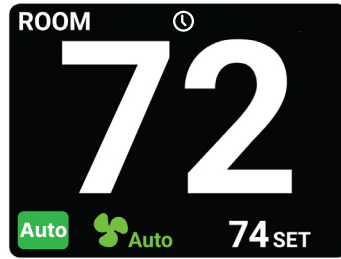

Schedule Resumed

## Filter Change Reminder



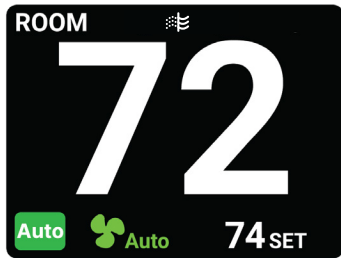

Filter change reminders are configured in the EC Tool Pro app and include run time options from 15 to 180 days. Once the HVAC system has run for this number of days, you will see a filter change reminder. After cleaning or replacing the filter, the system icon can be reset in the thermostat's engineering menu "Reset Filter Change Time". The filter change reminder will disappear until it's time to change your filter again.



## Set HVAC Mode

1. When the screen is awake, tap Mode to cycle to the next available HVAC system mode.
2. Cycle through the modes until the required HVAC system mode is displayed and leave it to activate.

### HVAC System Modes

Auto		Auto mode (Auto-changeover) - The thermostat will switch the HVAC system mode (heat / cool) automatically after deadband limit is reached.
Heat		Thermostat set to only heat to the target temperature
Cool		Thermostat set to only cool to the target temperature
Off		HVAC system is turned off

## Set HVAC Mode

### Note









To quickly change the HVAC mode to Off mode, tap and hold the Mode button for three seconds.



## Set Fan Mode

1. When the screen is awake, tap Fan to cycle to the next available fan mode.
2. Cycle through the modes until the required fan mode is displayed and leave it to activate.

### Fan Modes in Auto, Heat, and Cool Modes







	Fan Mode	Fan Status
Fan Modes Available In 1 Fan Speed Setting	Auto  <b>Auto</b>	Fan cycles on/off with call for heat or cool.
	On 	Fan is turned on.
Fan Modes Available In 2 Fan Speed Setting	Auto  <b>Auto</b>	Fan cycles on/off with call for heat or cool.
	Low  <b>Low</b>	Continuous low fan
	High  <b>High</b>	Continuous high fan
Fan Modes Available In 3 Fan Speed Setting	Auto  <b>Auto</b>	Fan cycles on/off with call for heat or cool.
	Low  <b>Low</b>	Continuous low fan
	Mid  <b>Mid</b>	Continuous mid fan
	High  <b>High</b>	Continuous high fan

### Note

Available fan modes vary with fan speed settings and HVAC mode selection.

# Set Fan Mode

## Fan Modes in Off Mode

	Fan Mode	Fan Status
Fan Modes Available In 1 Fan Speed Setting	Off —	Fan is turned off.
	On 	Fan is turned on.
Fan Modes Available In 2 Fan Speed Setting	Off —	Fan is turned off.
	Low  Low	Continuous low fan
	High  High	Continuous high fan
Fan Modes Available In 3 Fan Speed Setting	Off —	Fan is turned off.
	Low  Low	Continuous low fan
	Mid  Mid	Continuous mid fan
	High  High	Continuous high fan

- Fan Off mode option is only available in HVAC system Off mode. This means only when you turn off the HVAC system, can you turn off the fan. If the HVAC system is operating, no matter in Auto, Heat, or Cool mode, you cannot turn off the fan. The fan keeps running while the HVAC system is operating will help balance air throughout the room. The constant running status allows your blower to keep air circulating, which can help equalize temperatures and reduce hot-and-cold spots in certain areas.
- If you set the fan mode to Off, no icon will be displayed at the fan mode position on the screen.



## Switch Temperature Unit Between °F and °C

When the screen is awake, tap and hold up and down buttons at the same time for three seconds to switch to the opposite unit of temperature. If the screen had been displaying the default temperature unit °F, it will now display °C and vice-versa.

# Adjust Set Temperature



When the screen is awake, tap up or down button to adjust the set temperature to the next available degree by +/-0.5°C or +/-1°F.

## Set your desired temperature beyond range by override mode

The thermostat can be programmed to limit the maximum and minimum temperature settings that are available to occupants. This feature as well as the override timeout can be enabled or disabled as a parameter within the profile you used when programming the thermostat using the EC Tool Pro app.

When Temporary Override is enabled, occupants have the ability to temporarily override the minimum or maximum temperatures that have been defined via the EC Tool Pro app. To override the preset threshold, tap the up or down button until the maximum temperature setting is reached, then tap and hold the up or down button for three seconds. This will allow the occupant to override the current setting for the predefined period of time. Once the override time has expired, the system will automatically return to the current schedule or previous mode.

## Set Temperature Range

	Cool 	Auto  Heat 
Available Temperature Range	49-89°F (9.5-31.5°C)	
Comfort Point Range	55-82°F (13-28°C)	
Setpoint Range	Max setpoint range: Comfort point + 1-89°F (31.5°C) Min setpoint range: Comfort point -1 to 49°F (9.5°C)	
Set Temperature Range In Normal Operation	Min setpoint - Max setpoint	
Override Temperature Range	Tap Up Button: Max setpoint + 1-89°F (31.5°C) Tap Down Button: Min setpoint -1 to 49°F (9.5°C)	
Comfort Point (Default)	74°F (23.5°C)	
Setpoints (Default)	Max 77°F (25°C) Min 64°F (18°C)	Max 80°F (26.5°C) Min 65°F (18.5°C)
Normal Operation (Default)	64-77°F (18-25°C)	65-80°F (18.5-26.5°C)
Override Mode (Default)	Tap Up Button 78-89°F (25.5-31.5°C) Tap Down Button: 49-63°F (9.5-17.5°C)	Tap Up Button 81-89°F (27-31.5°C) Tap Down Button: 49-64°F (9.5-18°C)

---

# Occupancy Sensor

## Unoccupied





If the time since last presence detection exceeds the minimum Occupancy threshold setting (30-120 mins), the system predicts that the room is no longer occupied and your predefined Unoccupied Heat/Cool setpoints (or set-back temperatures) take effect. Once a room is considered unoccupied, the thermostat allows the ambient room temperature to drift to the Unoccupied minimum or maximum temperature setpoint. The thermostat will return to the default mode and comfort setpoint once presence is detected again.











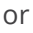

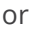





## Occupied



The guest room is considered "occupied" when the occupancy sensor detects movement. While the guest room is "occupied", the room temperature will be maintained according to the mode and temperature set point selected by the user.

## Enable/Disable Sensor

Enter Engineering mode by tapping and holding    for eight seconds.

1. Enter System Setting by tapping  or  button.
2. Then select System Configuration by tapping  or  button.
3. Tap  then select Std. Config via TSTAT by tapping  or  button.
4. Tap  key and then select Occupancy Sensor by tapping  or  button.
5. Select Enable/Disable Sensor by tapping  or  button.
6. Select Occupancy Sensor On by tapping  or  button. To turn Occupancy Sensor off, press  or  button. After your selection, the thermostat will display Updating... for four seconds and then a check mark to confirm your selection. Either tap any button or wait one second for the thermostat to time out and return to the Occupancy Sensor menu item.
7. To exit Engineering mode, tap  and then select Exit by tapping  or  button.

---

## Restore Profile Defaults

Tap and hold Mode and Up buttons at the same time for eight seconds to restore the default settings of the profile installed on your thermostat, which was configured via the EC Tool Pro app.

---

## VTech Hospitality Limited Warranty Program

VTech Communications, Inc., the manufacturer of VTech Hospitality Product ("Product"), warrants to the holder of a valid proof of purchase ("end user" or "you") that the Product and all accessories provided by VTech in the Product's package are free from defects in material and workmanship, pursuant to the following terms and conditions, when installed and used normally and in accordance with the Product's operating instructions. The limited warranty extends to the end user of this Product and applies only if such Product is purchased through a United States of America and/or Canadian distributor. The limited warranty period for this Product is 3 years.

During the limited warranty period, VTech's authorized service representative will repair or replace, at VTech's option, without charge, a Product that is not free from defects in materials and workmanship. If VTech's authorized service representative repairs the Product, new or refurbished replacement parts may be used.

If the Product is replaced, it may be replaced with a new or refurbished Product of the same or similar design. Repair or replacement of Product, at VTech's option, is the exclusive remedy. The limited warranty period for the Product begins on the date that the end user takes possession of the Product. This limited warranty also applies to repaired or replacement Products for a period of either: (a) 90 days from the date the repaired or replacement Product is shipped to you; or (b) the time remaining on the original limited warranty as described above; whichever is longer.

### Limited warranty does not cover:

1. Product or parts that have been subjected to misuse, accident, shipping or other physical damage, improper installation, abnormal operation or handling, neglect, inundation, fire, water or other liquid intrusion; or
2. Product that has been damaged due to repair, alteration or modification by anyone other than an authorized service representative of VTech; or
3. Product to the extent that the problem experienced is caused by signal conditions, network reliability or cable or antenna systems; or
4. Product to the extent that the problem is caused by use with non-VTech accessories; or
5. Product whose warranty/quality stickers, product serial number plates or electronic serial numbers have been removed, altered or rendered illegible; or
6. Product purchased, used, serviced, or shipped for repair from outside the United States or Canada, or used for non-approved commercial or institutional purposes (including but not limited to Products used for rental purposes); or
7. Product returned without valid proof of purchase; or
8. Charges or costs incurred by the end user, and risk of loss or damage, in removing and shipping the Product, or for installation or set up, adjustment of customer controls, and installation or repair of systems outside the unit.

Except as provided by applicable law, you assume the risk of loss or damage during transit and transportation and are responsible for delivery or handling charges incurred in the transport of Product(s) to the service location. VTech's authorized service representative will return repaired or replaced product under this limited warranty to you, transportation, delivery and handling charges prepaid. VTech assumes no risk for damage or loss of the Product in transit.

If the Product failure is not covered by this limited warranty, or proof of purchase does not meet the terms of this limited warranty, VTech will notify you and will request that you authorize the cost of repair and return shipping costs for the repair of Products that not covered by this limited warranty. You must pay for the cost of repair and return shipping costs for the repair of Products that are not covered by this limited warranty.

---

## **VTech Hospitality Limited Warranty Program**

### **Other Limitations**

This warranty is the complete and exclusive agreement between you and VTech. It supersedes all other written or oral communications related to this Product. VTech provides no other warranties for this Product, whether express or implied, oral or written, or statutory. The warranty exclusively describes all of VTech's responsibilities regarding the Product. No one is authorized to make modifications to this warranty and you should not rely on any such modification.

VTech's liability to end user hereunder shall not exceed the purchase price of the Product. In no event shall VTech be liable for any indirect, special, incidental, consequential, or similar damages (including, but not limited to lost profits or revenue, inability to use the product, or other associated equipment, the cost of substitute equipment, and claims by third parties) resulting from the use of this Product. Some states/provinces do not allow the exclusion or limitation of incidental or consequential damages, so the above limitation or exclusion may not apply to you.

This warranty gives you specific legal rights, and you also have other rights which vary from state to state or province to province.