

# *EXPRESS GSM*

## USER'S MANUAL

insert a SIM card

insert a battery

call to the detector SIM card

press the remote controller button

Install the device in a suitable location

EXPRESS GSM is ready for operation



# MOTION DETECTOR ALARM SYSTEM EXPRESS - GSM VERSION 2 Quick Start Guide

Watch the instructional set up video at: <http://www.alpha-safe.com/prod/video2.php>

## 1 PREPARATION

The operational principle of the Motion Detector is similar to that of an automatic door sensor located in a store. As you approach the door; it opens.

The Motion Detector, likewise, senses human movement and sends an SMS message containing the text "Alarm" and places a call to your mobile phone.

An optional wireless Siren can be connected to the Motion Detector.

Remove the screw from the lower base of the unit and lift off the Motion Detector cover.

Do not touch or service the circuit board components contained inside the Motion Detector and/or Siren. These are for access by qualified service technicians only.

If you purchased an optional Siren, open it by removing the screw from the lower base of the unit body. Place a slotted screwdriver, exerting slight pressure, alternately, into each slot located to the right and left of the screw. Lift off the Siren cover.

Purchase a new SIM card and record the telephone number below:

Insert a SIM card into the Motion Detector SIM card holder. The beveled SIM card corner should be located in the upper left corner of the SIM card holder.

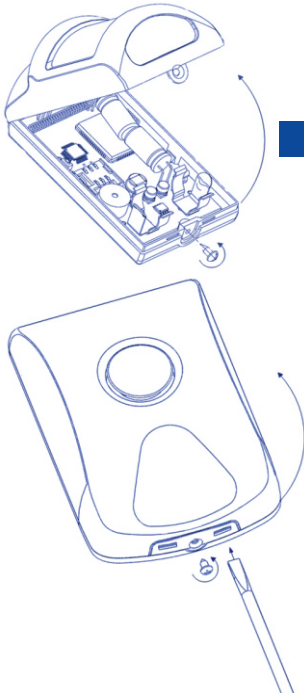

## 2 SET UP

**You will have only one minute to complete the set up procedure**, after which the Motion Detector will turn off. If you were unable to complete all the set up procedure steps, remove the battery from the Motion Detector and the Siren, wait 2 minutes and repeat the set up procedure from the beginning.

Re-install the battery into the Motion Detector battery holder observing the correct polarity. Wait for 3 audible sound signals and then call the Motion Detector (the telephone number recorded in the space on page 1) from your telephone. After receiving the call, the Motion Detector will emit an audible sound signal and will then disconnect the incoming call.

In order to set up the Siren, remove the protective plastic insert from between the battery and its holder. After an audible sound signal, the LED (Light Emitting Diode) will blink 3 times indicating that the Siren is successfully connected to the Motion Detector.

Set up the Remote Controller by briefly pressing button "A"; Set up will conclude by emitting an audible sound signal.

Replace the covers on the Motion Detector and Siren; insert and tighten the screws. In approximately 1 minute you will receive an incoming SMS message containing set up details. Simply confirm that immediately following position 1) your telephone number is registered and visible. The additional sets up details are for advanced users only.

## 3 INSTALLATION

Install the Motion Detector in a location inaccessible by unauthorized persons and with an unobstructed view of the protected zone. The recommended installation height is approximately 2 m/ 6.5 ft. The detection range for human presence is approximately 10 m/ 32 ft within the protected zone.

Do not install the Motion Detector near heat sources (fireplaces, stoves, air conditioners, heating radiators) or in any location exposed to strong air flow or direct sunlight.

Use the included wall bracket or double sided adhesive tape to mount the Motion Detector on the wall. The wall on which the Motion Detector is mounted should not be exposed to vibration. The presence of objects in the protected zone, such as furniture, screens, plants, etc., might create "blind spots", possibly hindering the detection of human presence. The presence of animals and birds within the protected zone may trigger false alarming.

The Siren may be placed in any convenient location, for example, on a bookshelf or hung on a screw. For stable and dependable operation, the distance between the Motion Detector and Siren should not exceed 10-15 m/ 32-48 ft.

## 4 VERIFICATION

- Press button "A" on the Remote Controller, the LED will blink yellow and red, the Siren will beep once and will then emit an audible sound signal. For 1 minute, the Motion Detector will continue to emit audible sound signals. During this span of time, the protected zone must be vacated. Simply exit to an adjacent room.
- Wait for an incoming SMS message containing the text "Armed by Remote Controller 1".
- Wait for 2-3 minutes and then enter the protected zone.
- The Siren will start emitting audible sound and visual light signals.
- Wait for an incoming SMS message containing the text "Alarm" and an incoming call from the Motion Detector.
- Place a call from your telephone to the Motion Detector SIM card telephone number.
- The Siren will beep twice and will then emit 2 audible sound signals.
- Wait for an incoming SMS message containing the text "Disarmed by incoming call from +XXXXXXXXXXXX" (your telephone number).

## 5 ARMING & DISARMING

- **Arming protection mode:** Press button "A" on the Remote Controller, the LED will blink yellow and red, the Siren will beep once and will then emit an audible sound signal. For 1 minute, the Motion Detector will continue to emit audible sound signals. During this span of time, the protected zone must be vacated. Simply exit to an adjacent room.
- Wait for an incoming SMS message containing the text "Armed by Remote Controller 1".
- Wait for 2-3 minutes.
- **Disarming protection mode:** Prior to entering the protected premises, press button "B" on the Remote Controller. The LED will blink yellow and green.
- The Siren will beep twice and will then emit 2 audible sound signals.
- Wait for an incoming SMS message containing the text "Disarmed by Remote Controller 1"; now enter the premises.

## 6 WARRANTY INFORMATION

The internet site: [www.alpha-safe.com](http://www.alpha-safe.com) contains the full version of the Motion Detector operating manual. Together with you, we have just executed basic set up. If you desire to review set up more thoroughly, then access and familiarize yourself with the contents of this resource.

Also, we draw your attention to the possibility of setting up the Motion Detector by using special programs available on this site. These programs allow for convenient and easy Motion Detector set up using your computer, smart phone or tablet running OS Android or iMac.

You may contact us with any questions at: 1.718.440.3281, or via the internet at: [www.alpha-safe.com](http://www.alpha-safe.com)

Warranty period is one year from date of purchase.

During the Warranty period manufacturer will repair, exchange, adjust, or replace at its discretion, any defective product.

This warranty does not cover damage resulting from any unauthorized attempt to repair or from any use not in accordance with the instruction manual. Warranty does not cover physical damage of any kind whatsoever or cover damage caused by any attempt to tamper with or disassemble the product.

Warranty does not cover the battery.

Warranty period commences on the day first purchased from manufacturer or an authorized reseller as evidenced by a purchase receipt. Without a valid receipt of purchase, manufacturer is relieved of its obligation to provide warranty service.

Date of sale:

Seller name:

Seal

\_\_\_\_\_

\_\_\_\_\_

\_\_\_\_\_



**Alpha Arsenal LLC**

104-20 Queens Blvd.,  
suite 1B Forest Hills, NY 11375  
Tel.: +1 (718) 440 3281  
E-mail: [info@alpha-safe.com](mailto:info@alpha-safe.com)  
Web site: [www.alpha-safe.com](http://www.alpha-safe.com)



QR code for the Android Market  
application page.  
Application for set-up  
configuration.



## **7 TEST CERTIFICATE**

### **FCC INFORMATION**

This device complies with Part 15 of the FCC Rules. Operation is subject to the following two conditions: This Device may not cause harmful interface, and this device must accept any interference received, including interference that may cause undesired operation.

**Note:** This equipment has been tested and found to comply with the limits for digital device, pursuant to Part 15 of FCC Rules. These limits are designed to provide reasonable protection against harmful interference when the equipment is operated in a commercial environment. This equipment generates uses and can radiate radio frequency energy and, if not installed and used in accordance with the instructions, may cause harmful interference to radio communications. However, there is no guarantee that interference will not occur in a particular installation. If this equipment does cause harmful interference to radio or television reception, which can be determined by turning the equipment off and on, the user is encouraged to try correct the interference by one or more of the following measures:

- 1.1. Reorient or relocate the receiving antenna.
- 1.2. Increase the separation between the equipment and receiver.
- 1.3. Connect the equipment into an outlet on a circuit different from that to which receiver is connected.
- 1.4. Consult the dealer or experienced radio/TV technician for help.

### **WARNING**

Changes or modifications not expressly approved by the manufacturer could void the user's authority to operate the equipment. FCC approved GSM module is used in this mobile/fixed application. The antenna (with required gain in its certification) used for the GSM transmitter must be installed to provide a separation distance of at least 20 cm from all persons in order to satisfy RF exposure compliance for the final host device.