

# PROPOSED ID LABEL AND LOCATION FOR MODULE



**TOSHIBA CORPORATION**

**FCC ID: CJ6UPA3613WL**

**IC: 248H-DPA3613W**

**Model: PA3613U-1MPC**

This device complies with Part 15 of the FCC Rules. Operation is subject to the following two conditions: (1) this device may not cause harmful interference, and (2) this device must accept any interference received, including interference that may cause undesired operation.

ID LABEL  
LOCATION

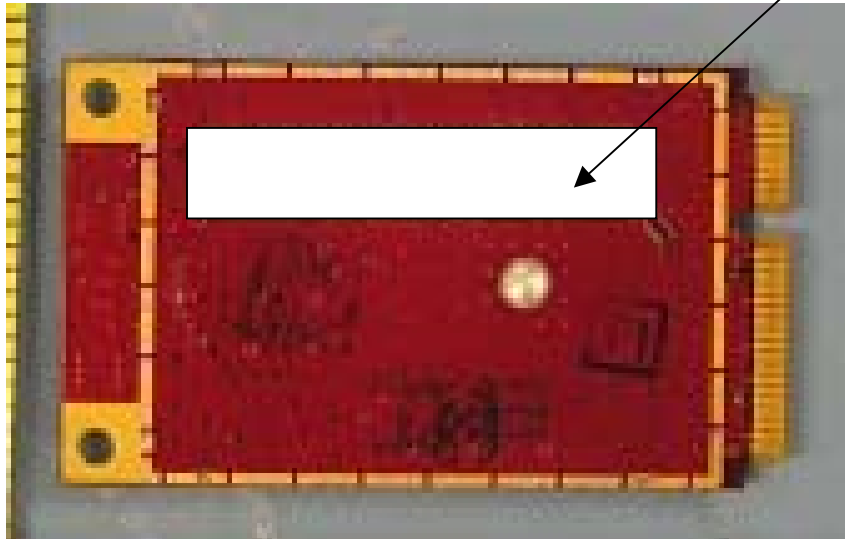

Bottom side view

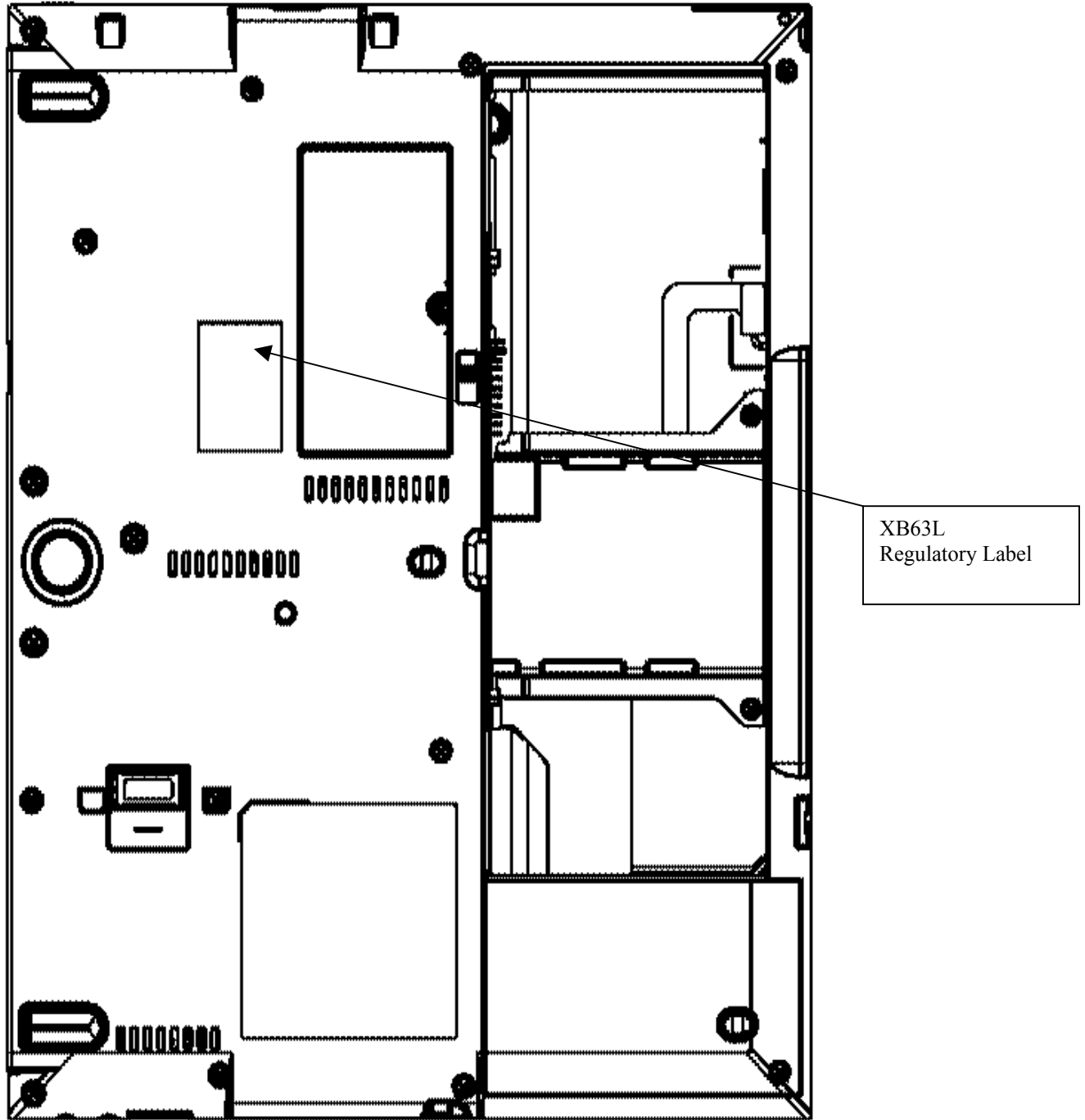

Regulatory Label of XB63L on bottom of PC

