

Jabra GN

USER MANUAL



PANACAST 40 VBS

Technology for life's new rhythm

© 2025 GN Audio A/S. All rights reserved. Jabra® is a trademark of GN Audio A/S. The Bluetooth® word mark and logos are registered trademarks owned by the Bluetooth SIG, Inc. and any use of such marks by GN Audio A/S is under license.

Notice for Canada: Use of the device in the 5150-5250 MHz band is restricted to indoor use.

Made in China

MODEL: VSM050; VTD050



Declaration of Conformity can be found on www.jabra.com/doc

1. Welcome.....	5	5.4 Single-stream Dynamic Composition	
2. Overview.....	6	5.5 Smart Gallery - Multi-stream - only for Zoom Rooms	
2.1 Jabra Panacast 40 VBS bar overview		5.6 Field of view	
2.2 Jabra PanaCast Control overview		5.7 Pan, Tilt, Zoom presets - available for Zoom Rooms	
2.3 Included accessories - Jabra Panacast 40 VBS bar		5.8 Image quality settings	
2.4 Included accessories - Jabra PanaCast Control		5.9 Video flicker	
2.5 Optional accessories		5.10Enhanced Noise Suppression	
3. Visual indicators.....	13	5.11Intelligent Meeting Space	
4. Settings management.....	14	6. Bring Your Own Device (BYOD) mode.....	24
5. Video settings.....	16	7. Share content.....	26
5.1 Intelligent Zoom		7.1 Wireless content sharing	
5.2 Virtual Director		7.2 Wired content sharing	
5.3 Panoramic View		8. Privacy cover.....	28

9. Safety capacity settings.....	29
10.Update firmware.....	30
11.Restart devices.....	32
12.Factory reset	35
13.Support.....	38
13.1FAQ and technical specifications	
13.2How to care for your Jabra device	

1. Welcome

Thank you for using the Jabra Panacast 40 VBS. We hope you will enjoy it!

Here are some key features you will benefit from by using the Jabra Panacast 40 VBS:

- World-class audio with full duplex and powerful stereo speaker
- Unique 180° full room coverage in high-definition Panoramic-4K for a more natural view of the meeting room
- Access to an easier meeting experience with the touchscreen-activated PanaCast Control
- Certified for the strict requirements of Microsoft Teams Rooms and Zoom Rooms to connect, share, and collaborate seamlessly and securely
- On-device AI that powers a range of intelligent features for immersive and natural virtual collaboration

Thank you for using the Jabra Panacast 40 VBS. We hope you will enjoy it!

2. Overview

2.1 Jabra Panacast 40 VBS bar overview

FRONT SIDE

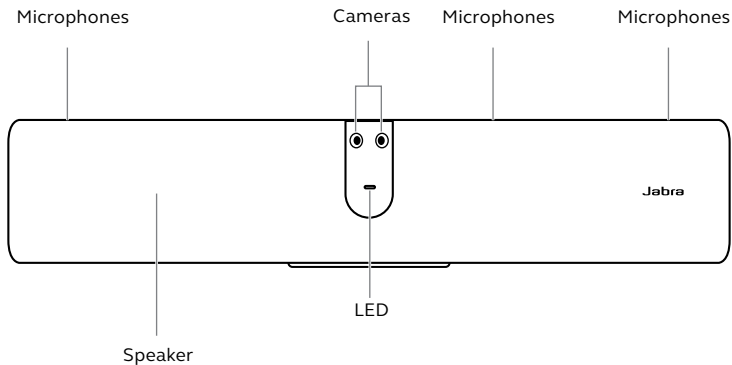

BACK SIDE

PORT CONNECTIONS



AUX OUT for assistive listening devices



Ethernet network



USB-A for touchscreen or mouse/keyboard



HDMI IN for wired content sharing



HDMI OUT to monitor



USB-C for BYOD



Power

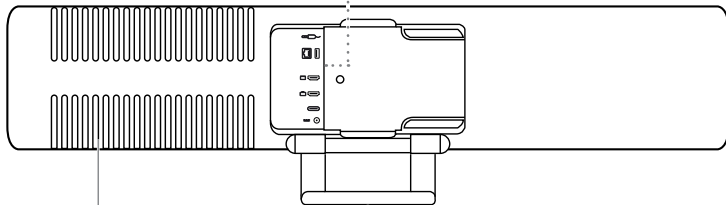

Air vents

Adjustable
mounting bracket

2.2 Jabra PanaCast Control overview

FRONT SIDE

10-inch LCD touch screen Proximity sensor

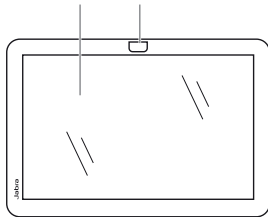

Proximity sensor

BACK SIDE

Ultrasonic sound proximity detector

Port connections
(remove cover for access)

USB-C port

Ethernet port (PoE)

Pinhole reset button

Kensington security slot

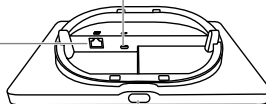
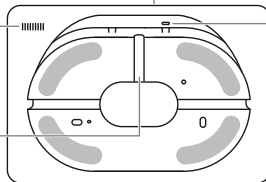

2.3 Included accessories - Jabra Panacast 40 VBS bar

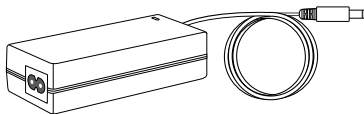

AC power adapter (1.83m/6ft)



AC power cable
(1m/3.28ft)

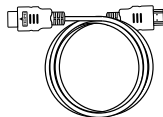

HDMI cable
(1.83m/6ft)

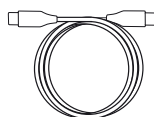

USB-C to C cable
(4.57m/15ft)



**Camera privacy
cover**

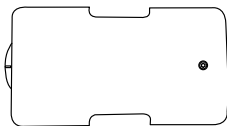

**Cable compartment cover
with embedded screw**

2.4 Included accessories - Jabra PanaCast Control

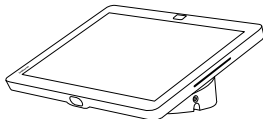

Jabra PanaCast Control 10 IP

2.5 Optional accessories

Accessories can be purchased at jabra.com/accessories

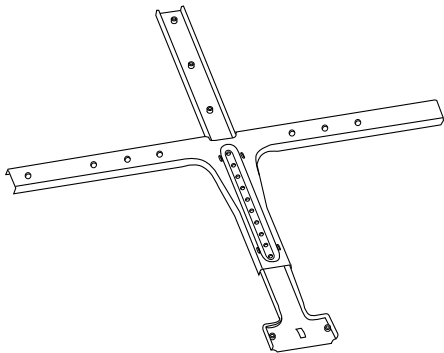

Screen mount

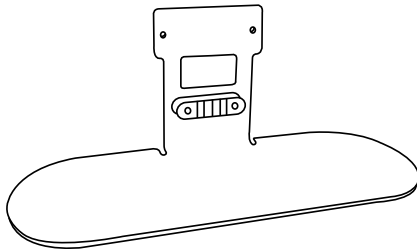
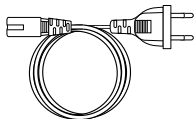
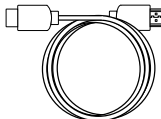

Table stand

Accessories can be purchased at jabra.com/accessories



**Regional power
cords**(1m/3.28ft)



HDMI cable
(1.83m/6ft)

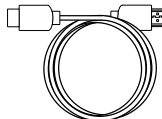

**HDMI ingest
cable**
(4.57m/15ft)

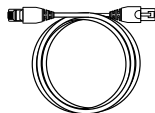

**RJ45 Ethernet
cable**
(4.57m/15ft)

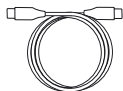

USB-C to C cable
(4.57m/15ft)

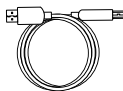

USB-A to B cable
(1.83m/6ft)



**Jabra PanaCast Control
table mount**

3. Visual indicators

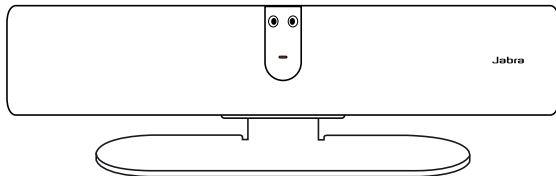

LED STATUS

Off or not streaming	(LED off)
Starting up	○ (breathing white)
USB-A connection (BYOD)	○ (on for 3 seconds)
In call or streaming video/media	○
In call, audio muted	●
Firmware updating	● (flashing pink)

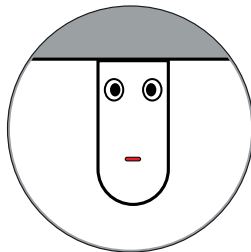

4. Settings management

After the Jabra Panacast 40 VBS configuration process is completed, the touch controller will display the video conferencing app of your service provider.

To access the Jabra Panacast 40 VBS settings, go to the **More** menu in the video conferencing app, select **Settings** and then **Device settings**.

Basic settings and **general information** of the touch controller will be displayed.

Advanced settings are available when logging in as an administrator. If this is the first login, the default username is **admin** and the password is the **last 6 digits of the touch controller serial number**.

Go to the **About** menu to find the touch controller serial number.

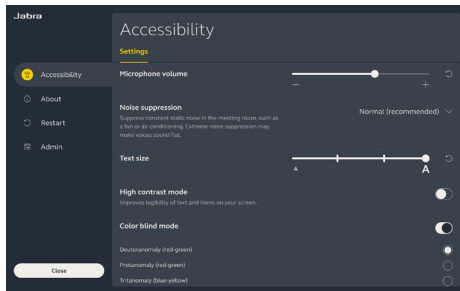

All Jabra Panacast 40 VBS settings can be configured using the Web Console or Jabra+.

To access the Web Console, enter the IP address of the video bar or touch controller in a browser. The IP address is displayed on the installation screen during the configuration process of the Jabra Panacast 40 VBS. The IP address is also available in the **About** section of the **Device settings** menu on the touch controller.

If this is the first time accessing the Web Console, the default username is **admin** and the password is the **last 6 digits of the serial number of the device used to access the Web Console**.

To access Jabra+, log in using your Jabra+ account. Go to the **Meeting rooms > Room inventory** menu, select your organization and corresponding meeting room. Select the provisioned Jabra Panacast 40 VBS to access its settings.

For more information on Jabra+, go to jabra.com/support

5. Video settings

Administrators can configure the video settings directly in the touch controller, remotely using the Web Console or Jabra+, or directly in your conferencing app, e.g Microsoft Teams or Zoom.

To access the video settings using the touch controller, go to the **More** menu in the video conferencing app, select **Settings** and then **Device settings**. The Jabra Panacast 40 VBS settings screen will be displayed. Go to the **Admin** menu and log in as an administrator.



If this is the first login, the default username is **admin** and the password is the **last 6 digits of the touch controller serial number**.

To access the video conferencing settings using the Web Console, enter the IP address of the video bar or touch controller in a browser. The IP address is displayed on the installation screen during the configuration process of the Jabra Panacast 40 VBS. The IP address is also available in the **About** section of the **Device settings** menu on the touch controller.

To access Jabra+, log in using your Jabra+ account. Go to the **Meeting room > Room inventory** menu, select your organization and corresponding meeting room. Select the provisioned Jabra Panacast 40 VBS to access the video settings.

5.1 Intelligent Zoom

Intelligent Zoom is a camera mode that dynamically frames all visible people in the meeting room in one view.

Only one camera mode can be active at a time. By default, camera mode is set to Intelligent Zoom.

5.2 Virtual Director

Virtual Director is a camera mode that dynamically switches to and focuses on the person who is speaking.

5.3 Panoramic View

Panoramic View is a camera mode that displays a panoramic view of the meeting room.

5.4 Single-stream Dynamic Composition

Single-stream Dynamic Composition is an advanced camera mode that displays a tiled view of up to four speakers and a full room view. The tiled view will dynamically update to display the participants who are actively speaking.



5.5 Smart Gallery - Multi-stream - only for Zoom Rooms

The Jabra PanaCast 40 VBS creates individual streams of in-room participants, as well as a full room view, so each in-room participant gets their own stream in a Zoom meeting. The tiled view will dynamically update to highlight the participant who is actively speaking.

To select this video mode, go to **Zoom Room** settings and select **Multi-Stream** option.

To hide the panoramic view and only display the individual video streams, go to **Zoom Room** settings and select **Hide Room View**.

5.6 Field of view

The angle of the camera is set to a 180° view of the meeting room.

5.7 Pan, Tilt, Zoom presets - available for Zoom Rooms

Pan, Tilt, Zoom presets allow users to adjust and save the camera view using the touch controller. Saved presets do not overwrite the default Pan, Tilt, Zoom settings. Users can select saved presets when a new meeting starts.

5.8 Image quality settings

The image brightness, contrast, saturation, sharpness, and white balance can be adjusted in the Web Console or using the touch controller through the admin device settings.

Additionally, Vivid HDR and Automatic white balance can be enabled. If Vivid HDR is enabled, contrast, saturation, and sharpness cannot be adjusted manually. If Automatic white balance is enabled, the white balance cannot be adjusted manually.

5.9 Video flicker

Video flicker can occur if the Jabra Panacast 40 VBS is not set to the correct geographical region. To prevent video flicker, select Auto (50Hz/60Hz) for regions that support NTSC format, or 50Hz for regions that support PAL format.

By default, **Video flicker** is set to Auto.

5.10 Enhanced Noise Suppression

The Jabra Panacast 40 VBS provides noise suppression which addresses noise, echo cancellation and suppresses constant static noise, such as a fan or air conditioning.

Based on the meeting room conditions, you can select Extreme Noise Suppression to suppress all background noise. Extreme Noise suppression may make voices sound flat.

5.11 Intelligent Meeting Space

Define a customized boundary that can be applied to a meeting space. This will ensure that only people within this boundary will be considered as meeting room participants.

Intelligent Meeting Space is especially useful for meeting rooms that have glass walls.



6. Bring Your Own Device (BYOD) mode

To enable BYOD mode, go to the **Admin** menu and login in as administrator. If this is the first login, the default username is **admin** and the password is the **last 6 digits of the touch controller serial number**.

Go to the **System** menu, select **Bring Your Own Device** and turn on **Enable BYOD**. This allows meeting participants to start and exit BYOD mode from the touch controller when required.

After enabling BYOD mode, it will be automatically available when connecting a personal computer to the video bar via USB-C. The camera, microphone and speakers from the video bar will be used during the meeting. To view the personal computer screen on the meeting room monitor, connect a HDMI cable between the video bar and the computer.

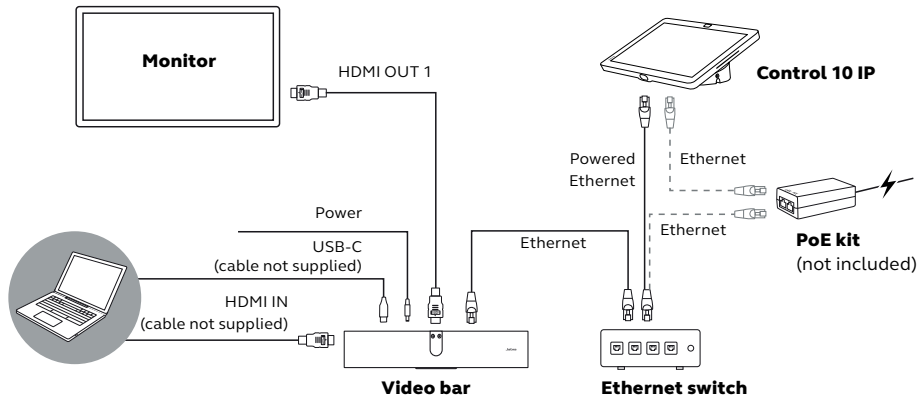

7. Share content

7.1 Wireless content sharing

The touch controller has both Bluetooth® technology (for MS Teams Cast and Apple Airplay) and an ultrasonic emitter (for Zoom Direct Share) that allows users to share content directly from their computers or mobile devices.

When sharing content using a wireless signal, the mobile device must be within 10 meters (32.8 feet) of the touch controller and the *share content* feature must be enabled in the video conferencing app.

For more information on how to share content wirelessly, go to the support page of your video conferencing service provider.

7.2 Wired content sharing

Connect an HDMI cable from the computer to the **HDMI IN** port on the back of the video bar. The content from the computer will be displayed in the meeting and on the room monitor connected to the video bar.

An additional HDMI cable is not supplied and can be purchased at jabra.com/accessories

8. Privacy cover

When the video bar is not in use, the privacy cover can be used to cover the lenses of the camera.

It is recommended not to use the privacy cover while the video bar is in a meeting as it may cause the image from the camera to flicker, which may be triggering for photosensitive individuals.

To stop the video feed during the meeting, users can use the in-meeting controls in the video conferencing application.

9. Safety capacity settings

The Jabra Panacast 40 VBS works together with the video conferencing app to monitor the safety capacity limit of a meeting room.

These settings are configured and managed directly in the admin portal of your video conferencing service provider.

10.Update firmware

Firmware updates improve performance or add new functionality to Jabra devices. Jabra Panacast 40 VBS firmware updates can be done:

- Locally on the video bar (mouse or touch screen monitor required)
- Locally on the paired touch controller
- Remotely using the Web Console(s) for the video bar and touch controller
- Remotely using the admin portal of your video conferencing service provider
- Remotely using Jabra+

For local updates, access the **Device settings** menu on the touch controller or video bar, go to the **System** section and select **Update**.

For remote updates, access the Web Console of the video bar and touch controller individually. Enter the IP address of the video bar or touch controller in a browser. If this is the first time accessing the Web Console, the default username is **admin** and the password is the **last 6 digits of the serial number** of the video bar or the touch controller.

Firmware updates in Jabra+ will follow the Firmware policy assigned to the meeting room configuration.

Go to the **Meeting rooms > Room configurations** menu and select **Firmware policy**.

11.Restart devices

You can restart the video bar and touch controller using one of the following options:

Touch Controller – log in as an admin and access the **Device Settings** Menu and go to the **Restart** section. The video bar and touch controller will be restarted.

Web Console – enter the IP address of the video bar or touch controller in the browser and go to the **System Reset** menu.

Jabra + – log in using your Jabra+ account. Go to the **Meeting room > Room inventory** menu, select your organization and corresponding meeting room. Go the action menu on the Jabra Panacast 40 video bar or touch controller, and select **Reboot device**.

Admin portal of your video conferencing service provider.

Physical restart of the video bar

Lift the front lid of the video bar. Press and hold the **Reset** button. Release the button after 5 seconds and a 'Restarting' message will be displayed on the monitor.

The video bar will restart and play an audio notification when ready for use. The reboot takes approximately 1 minute.

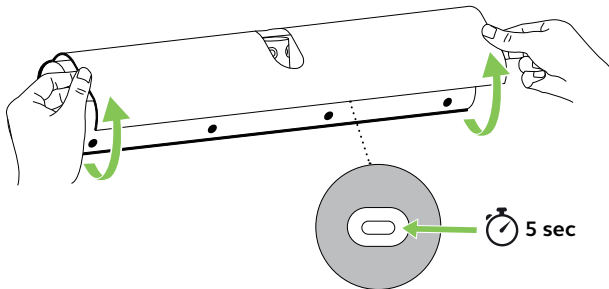

Physical restart of the touch controller

Use a paperclip to press and hold the **Pinhole reset** button on the back of the touch controller. Release the button after 5 seconds and a 'Restarting' message will be displayed on the monitor.

The reboot takes approximately 1 minute.

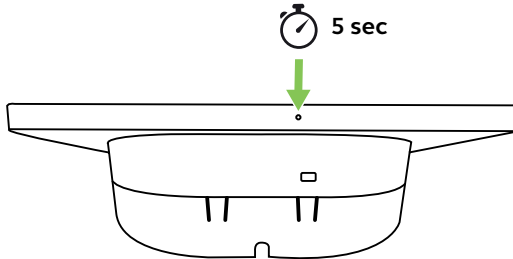

12.Factory reset

You can factory reset the video bar and touch controller using one of the following options:

Touch Controller – log in as admin and access the **Device settings** menu and go to the **Restart** section and select **Factory reset**. The video bar and touch controller will be reset.

Web Console – enter the IP address of the video bar or touch controller in the browser and go to the **System Reset** menu.

These are the recommended factory reset methods instead of physical factory resets of the video bar and the touch controller.

Physical factory reset of the video bar

Physical resetting will restore the video bar to its factory default settings and it will be necessary to re-pair the video bar to the touch controller.

Lift the front lid of the video bar. Press and hold the **Reset** button for 20 seconds until the LED flashes pink and the 'factory data reset' message is displayed on the monitor.

The video bar will restart and play an audio notification when ready for use. The reboot takes approximately 1 minute.

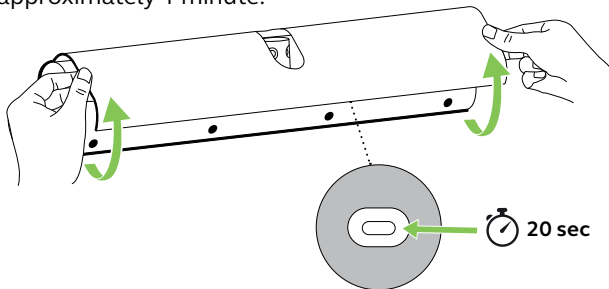

Physical factory reset of the touch controller

Physical resetting will restore the touch controller to its factory default settings and it will be necessary to re-pair the touch controller to the video bar.

Use a paperclip to press and hold the Pinhole reset button on the back of the touch controller for 20 seconds until the 'factory data reset' message is displayed on the screen.

The reboot takes approximately 1 minute.

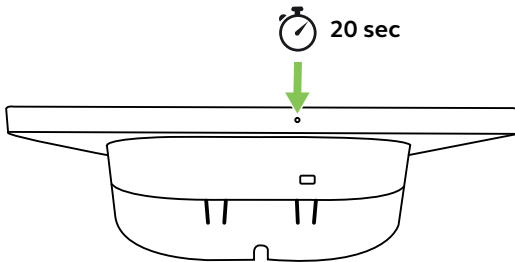

13.Support

13.1 FAQ and technical specifications

View the FAQ, certifications, and technical specifications at jabra.com/help/panacast40vbs

13.2 How to care for your Jabra device

The Jabra Panacast 40 VBS is for indoor use only.

- Avoid direct sunlight and temperatures above 40°C/104°F or below 0°C/32°F.
- Do not expose the camera or cables to rain or other liquids.
- Do not position the devices near the vents of a monitor or TV as this may cause the devices to overheat and malfunction.
- Clean the surface with a cloth dampened with a mild soap solution.

To learn more about the Jabra Panacast 40 VBS,
go to jabra.com/help/panacast40vbs/getstarted