

SHT	REV	B	THIS DOCUMENT AND THE DATA DISCLOSED HEREIN OR HEREWITH IS PROPERTY OF AND BELONGS TO ACR ELECTRONICS, INC. FT LAUDERDALE, FL. IT IS FURNISHED IN CONFIDENCE SOLELY FOR INFORMATIONAL PURPOSES. IT IS NOT TO BE REPRODUCED, USED OR DISCLOSED IN WHOLE OR IN PART TO ANYONE WITHOUT THE PERMISSION OF ACR.			
			REVISIONS			
			REV	DESCRIPTION	DATE	APPROVED
18560	A1-20-2008	DWG. NO.	A	RELEASED PER W/I 05-EN-01, SAME AS T3 EXCEPT UPDATED ARTWORK	FG	10/11/18
			B	ECO 17005; UPDATED: NOTE 1 " .175MM " TO " 7 MIL 8B35 VELVET MATTE "; UPDATED ARTWORK	FG	1/24/19

NOTES:

1. MATERIAL: 7 MIL 8B35 VELVET MATTE LEXAN
2. ADHESIVE BACKING: 3M 9671LE (300LSE)
3. DIE-CUT TO SIZE AND SHAPE
4. BULK PACK USING ACR PART NUMBER AND REVISION
5. LINER MUST HAVE PULL TAB
6. SUPPLIED INDIVIDUALLY CUT AND PACKAGED

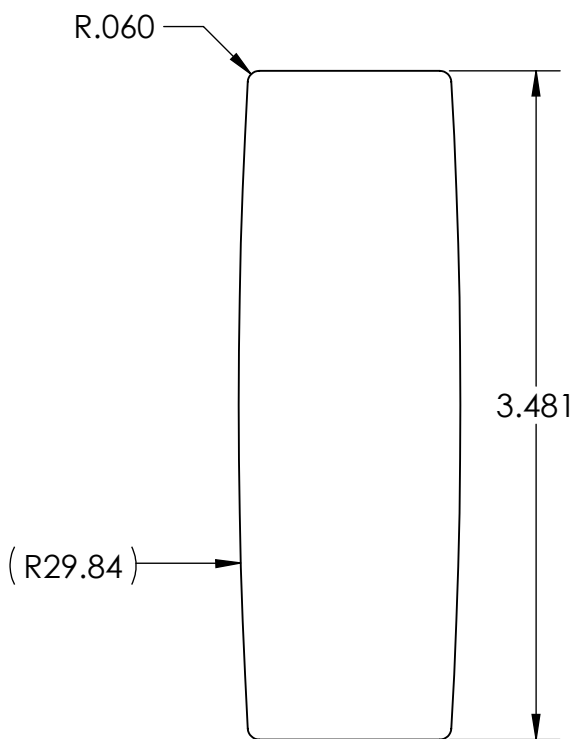

UNLESS OTHERWISE SPECIFIED ALL ANGLES ARE 90° DIMENSIONS ARE IN INCHES				DRAWN FD 3/23/18		ACR ELECTRONICS, INC 5757 RAVENSWOOD RD. FT. LAUDERDALE FL 33312			
				CHECKED CR 10/11/18					
				ENG. FG 10/11/18					
				APVD. JC 10/11/18					
TOLERANCES ON				<div>⬢ DENOTES REVISION CHANGE</div> <div>⊕ DENOTES DIMENSION PLUS DRAFT ANGLE</div> <div>⊖ DENOTES DIMENSION MINUS DRAFT ANGLE</div> <div>(XX) DENOTES REFERENCE NOTE OR DIMENSION</div> <div>ⓧⓧ DENOTES CRITICAL INSPECTION DIMENSIONS</div>		BACK LABEL, PLB-400 / 425			
MILLIMETER	FRACTIONS	DECIMALS	ANGLES						
X. ± .25	± 1/64	.X ± .030	X ± 5°						
X.X ± .125		.XX ± .010	X ± 2°						
X.XX ± .006		.XXX ± .005	.XX ± 1°						
			.XXX ± 1/2° IMPLIED: ± 1°						
ANSI-A SOLIDWORKS						SIZE A	CODE IDENT. NO. 18560	DRAWING NO. A1-20-2008	REV B
						SCALE 1:1			SHEET 1 OF 1