



Panasonic[®]

Operating Instructions Portable Stereo CD System

Model No. **RX-DBT30**

Dear Customer

Thank you for purchasing this product.

For optimum performance and safety, please read these instructions thoroughly before connecting, operating or adjusting this product. Please keep this manual for future reference.



Operations in these instructions are described with controls on the main unit.
Your unit may not look exactly the same as illustrated.

CAUTION!

This unit utilizes a laser. Use of controls or adjustments or performance of procedures other than those specified herein may result in hazardous radiation exposure.

WARNING:

- To reduce the risk of fire, electric shock or product damage,
- Do not expose this unit to rain, moisture, dripping or splashing.
 - Do not place objects filled with liquids, such as vases, on this unit.
 - Use only the recommended accessories.
 - Do not remove covers.
 - Do not repair this unit by yourself. Refer servicing to qualified service personnel.

CAUTION!

- To reduce the risk of fire, electric shock or product damage,
- Do not install or place this unit in a bookcase, built-in cabinet or in another confined space. Ensure this unit is well ventilated.
 - Do not obstruct this unit's ventilation openings with newspapers, tablecloths, curtains and similar items.
 - Do not place sources of naked flames, such as lighted candles, on this unit.

The mains plug is the disconnecting device. Install this unit so that the mains plug can be unplugged from the socket outlet immediately.

Oceania & Israel

This unit is intended for use in moderate climates.

South East Asia

This unit is intended for use in tropical climates.

This unit may receive radio interference caused by mobile telephones during use. If such interference occurs, please increase separation between this unit and mobile telephone.

-If you see this symbol-

Information on Disposal in other Countries outside the European Union



This symbol is only valid in the European Union. If you wish to discard this product, please contact your local authorities or dealer and ask for the correct method of disposal.

Safety precautions

- Avoid using or placing this unit near sources or heat. Do not leave it in an automobile exposed to direct sunlight for a long time with the doors and windows closed as this may deform the cabinet.
- Avoid cuts, scratches, or poor connections in the AC mains lead, as they may result in possible fire or electric shock hazard. Also, excessive bending, pulling or splicing of the lead should be avoided.
- Do not unplug the AC adaptor by pulling on the lead. To do so may cause premature failure or shock hazard.
- Do not operate this unit in a bathroom, as a potential shock hazard may result.
- When not in use, disconnect the AC mains lead from the household mains socket.

Compliance with FCC regulation

This device complies with Part 15 of the FCC Rules. Operation is subject to the following two conditions:

- (1) this device may not cause harmful interference, and
- (2) this device must accept any interference received, including interference that may cause undesired operation.

NOTE: This equipment has been tested and found to comply with the limits for a Class B digital device, pursuant to Part 15 of the FCC Rules. These limits are designed to provide reasonable protection against harmful interference in a residential installation. This equipment generates, uses and can radiate radio frequency energy and, if not installed and used in accordance with the instructions, may cause harmful interference to radio communications. However, there is no guarantee that interference will not occur in a particular installation. If this equipment does cause harmful interference to radio or television reception, which can be determined by turning the equipment off and on, the user is encouraged to try to correct the interference by one or more of the following measures:

- Reorient or relocate the receiving antenna.
- Increase the separation between the equipment and receiver.
- Connect the equipment into an outlet on a circuit different from that to which the receiver is connected.
- Consult the dealer or an experienced radio/TV technician for help.

CAUTION: Changes or modifications not expressly approved by the party responsible for compliance could void the user's authority to operate the equipment.

SURGE PROTECTORS: It is recommended to use a surge protector for AC connection. Lightning and power surges ARE NOT covered under warranty for this product.

Product Identification Marking is located on the bottom of the unit.

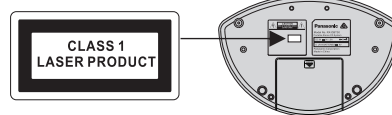

Use of batteries

If this unit is not used for a long period of time or is used only from an AC power source, remove all the batteries to prevent potential damage due to possible battery leakage.

- Make sure to match the + and - on each battery to the + and - signs in the unit battery compartment.
- Do not mix old and new batteries.
- Do not use different types of batteries at the same time.
- Do not take apart or short circuit the batteries.
- Do not attempt to recharge alkaline or manganese batteries.
- Do not use batteries if the covering has been peel off.
- Do not heat or expose to flame.
- Do not leave the battery(ies) in a car exposed to direct sunlight for a long period of time with doors and windows closed.
- Mishandling of batteries can cause electrolyte leakage, which may cause a fire.

CAUTION!

- Danger of explosion if battery is incorrectly replaced. Replace only with the type recommended by the manufacturer.
- When disposing of the batteries, please contact your local authorities or dealer and ask for the correct method of disposal.

Table of contents

Safety precautions	2
Maintenance	2
Use of batteries	2
Supplied accessories	3
Power sources	3
Overview of controls	4
Using your CD system	5
Pairing with a Bluetooth® device	5
Playing audio from a Bluetooth® device	5
To play the radio	5
Setting radio station presets	6
Playing audio from a connected audio device	6
To play a CD	6
To control CD playback	6
Repeating a track or CD	6
To play tracks in random order	6
Program CD/MP3 playback	7
Compatible CD	7
Compatible MP3 files	7
Troubleshooting guide	8
Specifications	9
About Bluetooth®	9
Warranty	10

Supplied accessories

Check and identify the supplied accessories.

- 3 x AC mains lead

For Australia, New Zealand

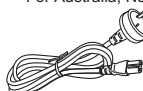

For Thailand



For Singapore, Malaysia, Israel

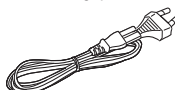

- 1 x AC Adaptor

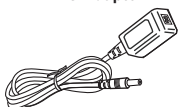

Power Sources

Using the household mains socket

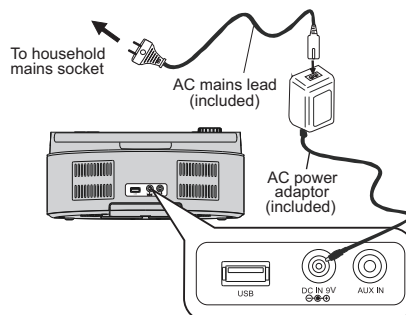

Connect the DC cord of the AC power adaptor firmly to the unit and connect the suitable AC mains lead firmly to the household mains socket.

Note

- The included AC power adaptor is for use with this unit only. Do not use it with other equipment.

Using batteries (not included)

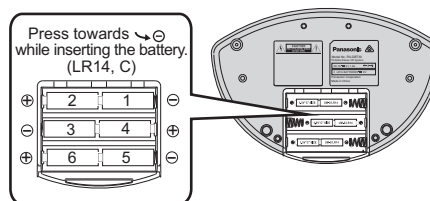

- This unit can be powered by either the included AC power adaptor, or by using six "C" sized alkaline batteries (not included).
- This unit only operates on batteries when the AC power adaptor is unplugged.
- Use only alkaline batteries.

When to change the batteries

When the battery indicator begins flashing, replace all six of the batteries.



USB charging port

This CD system included a USB port placed on the rear. The USB port supports powering and charging most USB devices. (USB cable sold separately).

Overview of controls

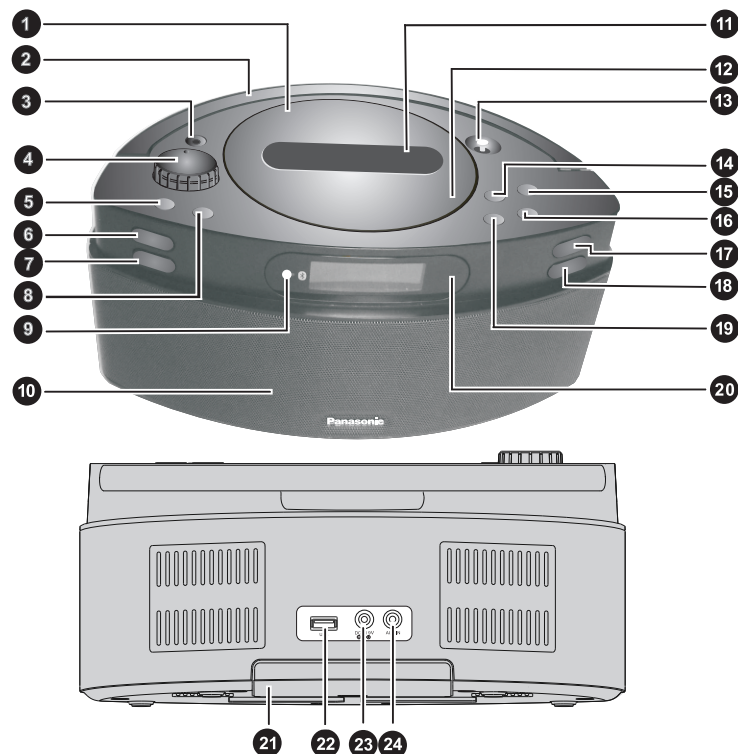

- | | | |
|--|--|---|
| 1 CD door | 7 Sound button | 17 Play mode/Preset button
(Rep 1, Rep ALL, RND) |
| 2 Handle | 8 Source button
(FM/AM/CD/B-T/AUX IN) | 18 Memory/Program button |
| 3 Headphone jack | 9 Bluetooth® (Pair) on LED | 19 Tune-/Skip backward button [◀◀] |
| 4 Volume +/- knob
0 (min) to 16 (max) | 10 Speakers | 20 LCD display lens |
| 5 Standby/on switch [⏻/⏻]
Press to switch the unit from on
to standby mode or vice versa.
In standby mode, the unit is
still consuming a small amount
of power. | 11 CD display window | 21 Battery compartment door |
| 6 Bluetooth® (Pair) button | 12 Open CD door | 22 USB Charging Port |
| | 13 FM antenna | 23 DC IN jack |
| | 14 Stop button [■] | 24 AUX IN jack |
| | 15 Play/Pause button [▶/⏸] | |
| | 16 Tune +/- Skip forward button [▶▶] | |

Headphone jack (PHONES)

Plug type : Ø 3.5 mm stereo (not included)

- Listening at full volume for long periods may damage the user's ears.
- Excessive sound pressure from earphones and headphones can cause hearing loss.

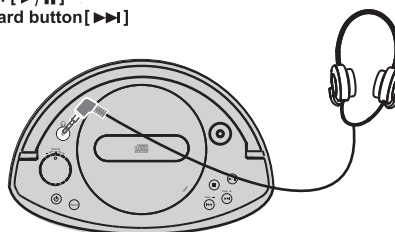

Using your CD system

To turn your CD system unit on or off

- Press **[⏻/I]** power button.

Selecting the audio source

- Press the **[Source]** button one or more times until the audio source you want appears on the LCD. You can select:
 - **FM** – FM radio band
 - **AM** – AM radio band
 - **CD** – CD player
 - **[B]** – Paired Bluetooth® device
 - **AUX IN** – Device connected to the AUX IN jack.

Selecting the sound mode

You can select a sound (equalizer) mode to automatically adjust the sound for the type of music you are playing.

- Press the **[Sound]** button one or more times until the sound mode you want appears on the LCD. You can select **JAZZ, POP, CLASSIC, ROCK**.

Pairing with a Bluetooth® device

To pair with a Bluetooth® device

1. On your CD System, press the **[Source]** one or more times until the **[B]** indicator appears of the LCD.
2. Make sure that your Bluetooth® device is turned on and within 33 feet (10 meters) of your CD System.
3. On your CD System, press the **[B]** Bluetooth® pairing button. Your CD System enters pairing mode, and the Bluetooth® LED blinks. Your CD System remains in pairing mode for 19 minutes or until it pairs with a Bluetooth® device.
4. On the Bluetooth® device, start pairing mode, then select **"RX-DBT30"**. See the instructions that came with the device for information pairing.
5. If you are asked for a password, enter **0000**. When pairing is complete, the Bluetooth® LED on your CD System lights solid.
6. To disconnect from the paired Bluetooth® device, press and hold the **[B]** Bluetooth® pairing button on your CD System for three seconds and it will display **"CLEAN BT"**. Your CD System disconnects from the Bluetooth® device and enters pairing mode again.
7. To reconnect your CD System to a paired device, search for and select **"RX-DBT30"** on the Bluetooth® device while the CD System is in pairing mode.

Note:

- Your CD System can store pairing information for eight devices.
- When your CD System is in Bluetooth® pairing mode, it automatically reconnects to the last paired device when the device is turned on, in Bluetooth® pairing mode, and within 33 feet (10 meters) of your CD System.
- If you want to reconnect with another previously paired device, make sure the device is within range, turn it on, and put it in pairing mode. Then press the **[B]** Bluetooth® pairing button.
- Your CD System searches for the pairing information and pairs with the device.

Playing audio from a Bluetooth® device

To play audio from a Bluetooth® device

1. On your CD System, press the **[Source]** button one or more times until the **[B]** indicator appears on the LCD.
2. Make sure that the Bluetooth® device has been paired to your CD System. See "Pairing with a Bluetooth® device" section.
3. To control playback from the Bluetooth® device, on your CD System:
 - Press the **[▶/II]** play/pause button to start or pause playback.
Your CD System plays the audio files on the Bluetooth® device.
 - Rotate the **[Volume]** knob to increase or decrease the volume.
 - Press the **[Tune +/▶▶]** skip forward button to go to the next song. Press and hold this button to fast forward.
 - If the current song has played less than two seconds, press the **[Tune -/◀◀]** skip backward button to go to the previous song. If the song has played more than two seconds, press this button to go to the beginning of the song. Press and hold this button to fast reverse.
 - Press **[■]** button to stop playback.

Note: Can't activate PLAY MODE & PROGRAM function at Bluetooth® mode.

To play the radio

1. Press the **[⏻/I]** power button to turn on your CD System.
2. Press the **[Source]** button one or more times until **"AM"**, **"FM"** appears on the LCD.
3. Press the **[Tune +/▶▶]** skip forward or **[Tune -/◀◀]** skip backward button to go to the next higher or lower radio frequency. When your CD System detects a strong FM signal, **"STEREO"** appears on the LCD.
OR
Press and hold the **[Tune +/▶▶]** skip forward or **[Tune -/◀◀]** skip backward button for two second to automatically tune to the next higher or lower radio station.
4. Rotate the **[Volume]** knob to increase or decrease the volume.

Note:

- To improve reception:
 - For FM reception, raise and extend the FM antenna. You may have to reposition the antenna for best reception.
 - For AM reception, turn your CD System slightly until reception improves.
- If the power AC adapter is connected to the power outlet, move the CD System away from the AC adaptor.

Setting radio station presets

Your CD System can store 10 AM and 10 FM radio station presets.

To set up radio station preset:

1. Press the **[P/I]** power button to turn on your CD System.
2. Press the **[Source]** button one or more times until "AM", "FM" appears on the LCD.
3. Press **[Tune + />▶]** skip forward or **[Tune - /<◀]** skip backward button to go to the radio station you want to preset.
4. Press the **[Memory]** button. "P-01" blinks on the LCD. If "P-01" has already be assigned to a radio station, the next available preset number appears.
5. Press the **[Memory]** button to save the radio station preset.
6. Press the **[Play Mode/Preset]** button one or more times to select the preset number (P-01 through P-10) you want to assign to the station.

To select a radio station preset:

- Press the **[Play Mode/Preset]** button one or more times until the preset number you want appears on the LCD.

Playing audio from a connected audio device

1. Make sure that your CD System is turned off.
2. Plug one end of a 3.5mm audio cable (not provided) into the **AUX IN** jack on the back of your CD System and to the audio out or line out jack on the audio device.

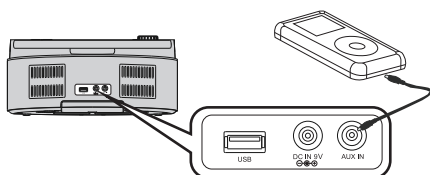

3. Press the **[P/I]** power button to turn on your CD System, then press the **[Source]** button one or more times until "AUX IN" appears on the LCD.
4. Adjust the volume using the **[Volume]** knob on your CD System.
5. Use the controls on the audio device to control playback.

To play a CD

1. Press the **[P/I]** power button to turn on the CD System.
2. Press **[OPEN]** on the CD door to open the CD compartment.
3. Insert a CD into the CD tray with the label facing up, then press **[OPEN]** again to close the CD compartment. The total number of tracks appears on the LCD and playback starts automatically. The currently playing track number appears on the LCD. When your CD System has played all the tracks on the CD, playback stops. Your CD System can play standard and 8cm CDs.

To control CD playback

1. Press the **[▶/⏸]** play/pause button to pause playback. Playback stops, but the CD continues to spin and the playback time blinks on the LCD. Press this button again to resume playback.
2. Press the **[Tune + />▶]** skip forward button to go to the next track on the CD. Press and hold this button to fast forward on the CD.
3. If the current track has played more than two seconds, press the **[Tune - /<◀]** skip backward button to go to the beginning of the currently playing tracks.
OR
If the current track has played for less than two seconds, press this button to go to the previous track. Press and hold for two seconds to fast reverse on the CD.
4. Press **[■]** stop button to stop playback before the CD has finished playing.

Repeating a track or CD

To repeat a single track:

1. While CD is playing, press **[Play Mode/Preset]** button once. "REPEAT" appears on the LCD, and your CD System repeats the currently selected track.
2. To repeat another track, press the **[Tune + />▶]** skip forward or **[Tune - /<◀]** skip backward button to select the track you want to repeat.
3. To cancel repeat mode, press **[Play Mode/Preset]** one or more times until the repeat indicator disappears from the LCD.

To repeat an entire CD:

1. While CD is playing, press **[Play Mode/Preset]** button twice. "REPEAT ALL" appears on the LCD, and your CD System repeats all the track on the CD.
2. To cancel repeat mode, press **[Play Mode/Preset]** button one or more times until the repeat indicator disappears from the LCD.

To play tracks in random order

1. While CD is playing, press the **[Play Mode/Preset]** button three times. "RANDOM" appears on the LCD and your CD System plays the CD's tracks in random order.
2. To cancel random mode, press the **[Play Mode/Preset]** button one or more times until **RANDOM** disappears from the LCD.

Note: No skip backward function in Random Mode.

Program CD/MP3 playback

This function allows you to program up to 20 tracks for CD and MP3 files to be played in the desired order. When 20 tracks have programmed. The LCD will show "FULL" for three seconds.

Note:

Programming can only be performed when playback is stopped.

1. In stop mode, press the **[Memory/Program]** button. The track number "P01 000" will show on LCD.
2. Press the **[Tune+ / >>>]** or **[Tune- / <<<]** button to select a track number.
3. Press the **[Memory/Program]** button to confirm.
4. Repeat steps 2 and 3 to program other tracks.
5. To play the program, press the **[▶/II]** play/pause button.
6. In play mode, press the **[■]** button once to go back to the program mode and the total program tracks will show on LCD.
7. In stop mode, to clear display the program and then press the **[■]** stop button, the LCD will show "CLEAR" for three seconds and exit to normal.

Note:

In MP3 mode press **[Memory/Program]** button to display ID3 information for one cycle and then show back to play mode.

When ID3 is scrolling, press **[Memory/Program]** button, the LCD will show back to playtime at once.

Compatible CD

- A disc with the CD Logo.
- This unit can playback discs that conform to the CD-DA format.
- This unit may not be able to play some discs due to the condition of the recording.



Note about using a Dual Disc

The digital audio content side of a Dual Disc does not meet the technical specifications of the Compact Disc Digital Audio (CD-DA) format so playback may not be possible.

Note on CDs

- This unit can access up to 99 tracks.
- This unit can play MP3 files and CD-R/RW due to the condition of the recording.
- Do not use irregularly shaped disc.
- Do not use disc with labels and stickers that are coming off or with adhesive exuding from under labels and stickers.
- Do not attach extra labels or stickers on the disc.
- Do not write anything on the disc.

Compatible MP3 files

- Supported format: files with the extension "mp3" or "MP3".
- Compatible compression rate : Between 16 kbps and 320 kbps (stereo).
- Depending on how you create the MP3 files. They may not play in the order you numbered them or may not play at all.

CD-R/RW

- Maximum number of tracks and albums: 999 tracks and 999 albums (Excluding Root folder).
- Disc formats :
 - ISO9660 level 1 and level 2 (except for extended formats).
 - Does not support files recorded in Universal Disc Format (UDF).
- If the disc includes both MP3 and normal audio data (CD-DA), the unit plays the type recorded in the inner part of the disc.
- This unit cannot play files recorded using packet write.

Note on MP3

- Files are treated as tracks and folders are treated as albums.
- This unit can access up to 999 tracks, 999 albums.
- Disc must conform to ISO9660 level 1 or 2 (except for extended formats).
- To play in a certain order, prefix the folder and file names with 3-digits numbers in the order you want to play them.

Limitations on MP3 play

- If you have record MP3 on the same disc as CD-DA, only the format recorded in the first session can be played.
- Some MP3s may not be played due to the condition of the disc or recording.
- Recordings will not necessarily be played in the order you recorded them.
- It does not support MP3 album selection.

Auto off

This unit will turn to Standby mode automatically if there is no sound and it is not being used for approximately 19 minutes.

Troubleshooting guide

Before requesting service, make the following check. If you are in doubt about some of the check points, or if the solutions indicated in the chart do not solve the problem, consult your dealer for instructions.

■ General

Problem	Possible cause	Possible solution
No sound	The volume control may be set too low.	Rotate the volume control knob to increase the volume.
	The wrong audio source may be selected.	Press the [Source] button until you see the correct indicator on the LCD.
	The system may not be turned on.	Press the [⏻/I] power button to turn on your system.
	The AC mains lead & AC power adaptor may not be connected or may be connected incorrectly.	Make sure that the AC mains lead & power adaptor are connected securely and correctly to your system and the power outlet.
	The batteries may be dead.	Replace the batteries
Noise is heard	When a device is connected to both the AUX IN jack and the USB charging port.	Remove the USB cable from the USB charging port.

■ Radio

Problem	Possible cause	Possible solution
There is noise or static when playing the radio	The FM antenna is not fully extended or needs to be repositioned.	Fully extend the FM antenna and adjust its position to get the best reception.
	Your system is not positioned correctly for AM band reception.	Move your system around to get the best reception.
	The station signal may be weak	Try another station.

■ CD player

Problem	Possible cause	Possible solution
CD will not play	The CD may be inserted incorrectly.	Insert the CD with the label facing up.
	The CD may be dirty.	Clean the CD.
	The CD may be damaged	Try another CD.
	CD contains not supported data	Refer to compatibility on page 7
CD skip while playing	You are moving your system.	Do not move your system while a CD is playing. The CD player should only be used on a flat steady surface.
	The CD may be dirty	Clean the CD.
	The CD may be damaged	Try another CD.

Troubleshooting guide

■ Bluetooth® device

This Portable Stereo CD System can stream music from paired Bluetooth® devices like smartphones, notebooks, and audio devices.

Problem	Possible cause	Possible solution
System will not start pairing mode	Bluetooth® is not selected as the audio source.	Press the [Source] button one or more times until "BT" appears on the LCD, then press the [BT] Bluetooth® pairing button.
System is in pairing mode, but does not pair with the Bluetooth® device	The Bluetooth® device may not be turned on.	Make sure that the Bluetooth® device is turned on.
	You have not selected your system on the Bluetooth® device.	Make sure that the Bluetooth® device is in pairing mode, then select your unit on the Bluetooth device.
	The Bluetooth® device is too far away from your system.	Move the Bluetooth® device within 33 feet (10 m) of your system.
	The Bluetooth® device does not use a supported Bluetooth® protocol.	Your system supports the A2DP and AVRCP Bluetooth protocols. Make sure that the Bluetooth® device you are trying to connect uses one of these protocols.
System was paired to the Bluetooth® device, but will not re-pair	You have not selected your system on the Bluetooth® device.	When a Bluetooth® device disconnects from your system, you have to re-select your system to re-pair to the Bluetooth® device. Make sure that the Bluetooth® device is in pairing mode, then select your unit on the Bluetooth® device.
	The Bluetooth® device is too far away from your system.	Move the Bluetooth® device within 33 feet (10 m) of your system.

Specifications

GENERAL

Power supply DC 9V (DC IN terminal)

Power consumption 37 W

Power consumption in standby mode

Approx. 0.2 W

When "BLUETOOTH STANDBY" is "ON"

Approx. 0.3 W

Power supply

(For Australia and New Zealand)

AC 220 V to 240 V, 50 Hz

(For Asia and the Middle East)

AC 110 V to 240 V, 50/60Hz

Dimensions (W x H x D)

310mm x 130mm x 210mm

Mass

Approx. 1.95 kg

Operating temperature range 0°C to +40°C

Operating humidity range

35 % to 80 % RH (no condensation)

AMPLIFIER SECTION

Output power

RMS Output Power Stereo mode

3 W per channel (8 Ohm), 1 kHz, 10 % THD

Total RMS Stereo mode power 6 W

(For Asia and Middle East)

PMPO output power 60 W

TUNER SECTION

Preset Memory FM 10 stations, AM 10 stations

Frequency Modulation (FM)

87.50 MHz to 108.00 MHz (50 kHz step)

Antenna Telescopic

Amplitude Modulation (AM)

Frequency range

522 kHz to 1629 kHz (9 kHz step)

DISC SECTION

Disc played (8 cm or 12 cm)

CD, CD-R/RW (CD-DA, MP3)

Pick up

Wavelength 765 nm (CD)

SPEAKER SYSTEM SECTION

Speaker unit(s)

Full range 7.6 cm Cone type x 1 per channel

BLUETOOTH SECTION

Version Bluetooth® Ver. 4.0

Class Class 2

Supported Profiles A2DP, AVRCP

Operating frequency 2.4 GHz band

Operation Distance 10m Line of sight

TERMINAL SECTION

USB Charging Port (USB A type) 5 V 1 A

AUX IN Stereo, Ø 3.5mm jack

Headphone Stereo, Ø 3.5mm jack

Specification are subject to change without notice.
Mass and dimensions are approximate.

About Bluetooth®

Panasonic cannot be held responsible for data and/or information that can possibly be compromised during a wireless transmission.

Frequency band

- This system uses the 2.4 GHz frequency band.

Certification

- This system conforms to the frequency restrictions and has received certification bases on frequency laws.

Thus, a wireless permit is not necessary.

- The actions below are punishable by law:

- Taking apart or modifying the main unit.
- Removing specification indications.

Restrictions of use

- Wireless transmission and/or usage with all Bluetooth® equipped devices is not guaranteed.
- All devices must conform to standards set by Bluetooth SIG, Inc.
- Depending on the specifications and settings of a device, it can fail to connect or some operations can be different.
- This system supports Bluetooth® security features.
But depending on the operating environment and/or settings, this security is possibly not sufficient.
Transmit data wirelessly to this system with caution.
- This system cannot transmit data to a Bluetooth® device.

Range to use

- Use this device at a maximum range of 10 m.
- The range can decrease depending on the environment, obstacles or interference.

Interference from other device

- This system may not function properly and troubles such as noise and sound jumps may arises due to radio wave interference if this unit is located too close to other Bluetooth® devices or the devices that use the 2.4 GHz band.
- This system may not function properly if radio waves from a nearby broadcasting station, etc. is too strong.

Intended usage

- This system is for normal, general use only.
- Do not use this system near an equipment or in an environment that is sensitive to radio frequency interference (example: airports, hospitals, laboratories, etc.).

The Bluetooth® word mark and logos are registered trademarks owned by Bluetooth SIG, Inc. and any use of such marks by Panasonic Corporation is under license. Other trademarks and trade names are those of their respective owners.

MPEG Layer-3 audio coding technology licensed from Fraunhofer IIS and Thomson.

Limited Warranty (ONLY FOR AUSTRALIA)

Panasonic Warranty

1. The product is warranted for 12 months from the date of purchase. Subject to the conditions of this warranty Panasonic or its Authorised Service Centre will perform necessary service on the product without charge for parts or labour, if in the opinion of Panasonic, the product is found to be faulty within the warranty period.
 2. This warranty only applies to Panasonic products purchased in Australia and sold by Panasonic Australia or its Authorised Distributors or Dealers and only where the products are used and serviced within Australia or its territories. Warranty cover only applies to service carried out by a Panasonic Authorised Service Centre and only if valid proof of purchase is presented when warranty service is requested.
 3. This warranty only applies if the product has been installed and used in accordance with the manufacturer's recommendations (as noted in the operating instructions) under normal use and reasonable care (in the opinion of Panasonic). The warranty covers normal domestic use only and does not cover damage, malfunction or failure resulting from use of incorrect voltages, incorrect installation, accident, misuse, neglect, build-up of dirt or dust, abuse, maladjustment of customer controls, mains supply problems, thunderstorm activity, infestation by insects or vermin, tampering or repair by unauthorised persons (including unauthorised alterations), introduction of sand, humidity or liquids, commercial use such as hotel, office, restaurant, or other business or rental use of the product, exposure to abnormally corrosive conditions or any foreign object or matter having entered the product.
 4. This warranty does not cover the following items unless the fault or defect existed at the time of purchase:

(a) Cabinet Part(s)	(e) DVD, Blu-ray or Recordable Discs
(b) Video or Audio Tapes	(f) Video / Audio Heads from wear and tear in normal use
(c) SD cards or USB devices	(g) Information stored on Hard Disk Drive, USB stick or SD card
(d) User replaceable Batteries	(h) DTV reception issues caused by TV Aerial / Cabling / Wall socket(s)

etc
 5. Some products may be supplied with Ethernet connection hardware. The warranty is limited on such products and will not cover
 - (a) Internet and or DLNA connection / setup related problems
 - (b) Access fees and or charges incurred for internet connection
 - (c) The use of incompatible software or software not specifically stipulated in the product operations manual; and
 - (d) Any indirect or consequential costs associated with the incorrect use or misuse of the hardware, its connection to the internet or any other device.
 6. To claim warranty service, when required, you should:
 - Telephone Panasonic's Customer Care Centre on 132600 or visit our website referred to below and use the Service Centre Locator for the name/address of the nearest Authorised Service Centre.
 - Send or take the product to a Panasonic Authorised Service Centre together with your proof of purchase receipt as a proof of purchase date. Please note that freight and insurance to and / or from your nearest Authorised Service Centre must be arranged by you.
 - Note that home or pick-up/delivery service is available for the following products in the major metropolitan areas of Australia or the normal operating areas of the nearest Authorised Service Centres:
 - Plasma/LCD televisions / displays (screen size greater than 103 cm)
 7. The warranties hereby conferred do not extend to, and exclude, any costs associated with the installation, de-installation or re-installation of a product, including costs related to the mounting, de-mounting or remounting of any screen, (and any other ancillary activities), delivery, handling, freighting, transportation or insurance of the product or any part thereof replacement of and do not extend to, and exclude, any damage or loss occurring by reason of, during, associated with, or related to such installation, de-installation, re-installation or transit.
- Panasonic Authorised Service Centres are located in major metropolitan areas and most regional centres of Australia, however, coverage will vary dependant on product. For advice on exact Authorised Service Centre locations for your product, please telephone our Customer Care Centre on 132600 or visit our website and use the Service Centre Locator.
- In addition to your rights under this warranty, Panasonic products come with consumer guarantees that cannot be excluded under the Australian Consumer Law. If there is a major failure with the product, you can reject the product and elect to have a refund or to have the product replaced or if you wish you may elect to keep the goods and be compensated for the drop in value of the goods. You are also entitled to have the product repaired or replaced if the product fails to be of acceptable quality and the failure does not amount to a major failure.
- If there is a major failure in regard to the product which cannot be remedied then you must notify us within a reasonable period by contacting the Panasonic Customer Care Centre. If the failure in the product is not a major failure then Panasonic may choose to repair or replace the product and will do so in a reasonable period of time from receiving notice from you.

**THIS WARRANTY CARD AND THE PURCHASE DOCKET (OR SIMILAR PROOF OF PURCHASE)
SHOULD BE RETAINED BY THE CUSTOMER AT ALL TIMES**

If you require assistance regarding warranty conditions or any other enquiries, please visit the **Panasonic Australia** website **www.panasonic.com.au** or contact by phone on 132 600
If phoning in, please ensure you have your operating instructions available.

Panasonic Australia Pty. Limited

ACN 001 592 187 ABN 83 001 592 187

1 Innovation Road, Macquarie Park NSW 2113

PRO-031-F11 Issue: 4.0

01-01-2011

