

# Hide & Speak® Parts List

## Pods:

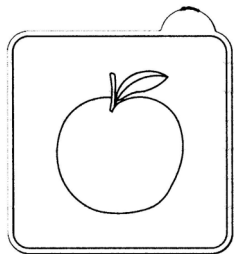

Picture card 50mm  
Picture cards fit inside Pods

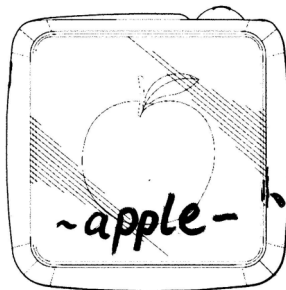

Front of Pod with  
picture card in place

You can make  
your own  
picture cards.

Using a write on,  
wipe off pen you  
can add words to  
the front of the Pod

At rear of Pod a gap gives  
easy access to picture card

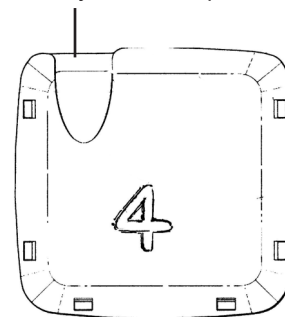

Pods each have a  
unique number.

2

## Fitting and Changing the Batteries (Use 3 AAA Cells)

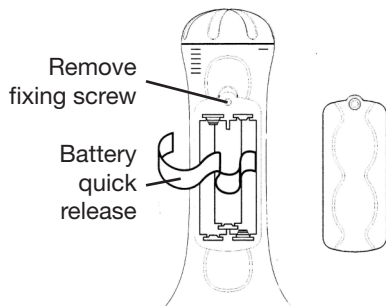

**Step 1**  
Remove battery cover

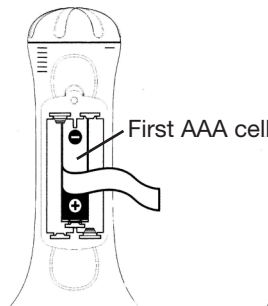

**Step 2**  
Insert AAA cell

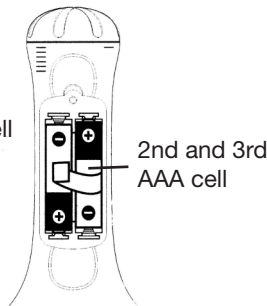

**Step 3**  
Insert 2 more AAA cells  
Refit cover

### Battery Safety Information

Follow these battery guidelines or battery life may be shortened, leak or rupture:

- Use AAA batteries only.
- Do not mix old and new batteries or batteries of a different type.
- Insert batteries inside the battery compartment as indicated.
- Never short-circuit battery terminals.
- Exhausted batteries are to be removed from the toy.
- Rechargeable batteries must only be charged under adult supervision.
- Batteries must be fitted with the correct polarity as shown in the graphic on this page.
- Rechargeable batteries must be removed from the toy before being recharged.
- Do not charge non-rechargeable batteries.
- Keep batteries away from children.
- Dispose of batteries safely.

This device complies with Part 15 of the FCC Rules. Operation is subject to the following two conditions: (1) this device may not cause harmful interference, and (2) this device must accept any interference received, including interference that may cause undesired operation. Changes or modifications not expressly approved by the party responsible for compliance could void the user's authority to operate the equipment. This equipment has been tested and found to comply with the limits for a Class B digital device, pursuant to Part 15 of the FCC Rules. These limits are designed to provide reasonable protection against harmful interference in a residential installation. This equipment generates, uses and can radiate radio frequency energy and, if not installed and used in accordance with the instructions, may cause harmful interference to radio communications. However, there is no guarantee that interference will not occur in a particular installation. If this equipment does cause harmful interference to radio or television reception, which can be determined by turning the equipment off and on, the user is encouraged to try to correct the interference by one or more of the following measures:

1. Reorient or relocate the receiving antenna. 2. Increase the separation between the equipment and receiver. 3. Connect the equipment into an outlet on a circuit different from that to which the receiver is connected. 4. Consult the dealer or an experienced radio/TV technician for help.