

MULTI-VOICE RADIO

MVR900 Users Guide

The Multi-Voice Radio MVR900 System
provides advanced full duplex
communication.



Compliance to US/CANADA

This device complies with part 15 of the FCC rules and with RSS 210 of Industry Canada. Operation is subject to the following two conditions: (1) This device does not cause harmful interference, and (2) this device must accept any interference received, including interference that may cause undesired operation.

Note: This equipment has been tested and found to comply with the limits for a Class B digital device, pursuant to Part 15 of the FCC Rules. These limits are designed to provide reasonable protection against harmful interference in a residential installation. This equipment generates, uses and can radiate radio frequency energy and, if not installed and used in accordance with the instructions, may cause harmful interference to radio communications.

However, there is no guarantee that interference will not occur in a particular installation. If this equipment does cause harmful interference to radio or television reception, which can be determined by turning the equipment off and on, the user is encouraged to try to correct the interference by one or more of the following measures:

- Reorient or relocate the receiving antenna.
- Increase the separation between the equipment and receiver.
- Connect the equipment into an outlet on a circuit different from that to which the receiver is connected.
- Consult the dealer or an experienced radio/TV technician for help.

Warning: Changes or modifications made to this equipment not expressly approved by Multi-Voice Radio may void the user's authority to operate the equipment.

This Class B digital device complies with Canadian ICES-003.

Cet appareil numérique de la classe B est conforme à la norme NMB-003 du Canada.

Le présent appareil est conforme aux CNR d'Industrie Canada applicables aux appareils radio exempts de licence. L'exploitation est autorisée aux deux conditions suivantes : (1) l'appareil ne doit pas produire de brouillage, et (2) l'utilisateur de l'appareil doit accepter tout brouillage radioélectrique subi, même si le brouillage est susceptible d'en compromettre le fonctionnement.

FCC ID: ALZMVR900 IC: 10263A-MVR900 Model: MVR900

Product Description

The Multi-Voice Radio combines conference communication with wireless radio. This full duplex system allows hands free communication on a secure signal for up to 8 people. Additional units may be added as listen only or push to talk devices.

Specifications

Measurements

Length: 5.2 in
Height: 3.0 in
Width: 1.0 in
Antenna: 1.3 In
Weight: 10.9 oz

Signal

Frequency: 902-928 MHz
Maximum Output Power: 500mW
Range: Up To 3/4 Mile Line of Sight
Frequency Hopping Spread Spectrum
Proprietary Encryption





Battery

14 Hour Operation
Rechargeable
Lithium-Ion
6000 mAh

Required Accessory

The MVR900 requires a headset for operation. The headset requirements are: an electret microphone with Impedance between 1K Ω and 5 K Ω , a speaker with impedance between 8 Ω and 50 Ω , a hirose HR30-6P-6S71 connector. To see the available headsets visit our website at www.multivoiceradio.com

Keypad Description

	Power ON/OFF Hold the button for 3 seconds to turn the device ON. Hold the button for 3 seconds to turn the device OFF.
	Volume UP
	Volume DOWN
	Mute Press to toggle the microphone off and on. When the device is in the optional PPT mode the button becomes the ppt activation.
	Channel / Sync Press switch between 6 channels. This button also acts as the sync button during setup.

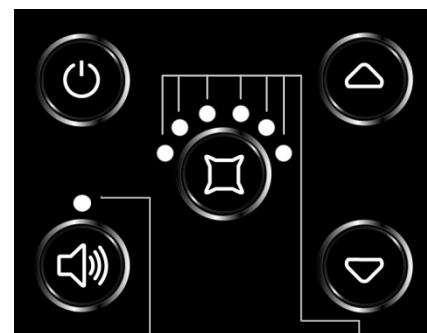

Mute LED:
Indicates
the mute is
toggled ON

Channel LED:
Indicates what
channel the
user is on.

Operating Modes

Full Duplex (Primary)

Microphone is always on.
User can communicate hands free.
Each radio with this mode takes 1 of 8 available communication slots.

Push To Talk (Optional)

User must push a button to activate microphone. This option needs at least one slot to be unused. The number of unused slots determines the number of PTT users that can talk at the same time. Unlimited number of radios can have this configuration.

Setup

Leave all devices off. Choose one device as the master. On this device hold the channel/sync button down. After a few seconds the LEDs will turn on, this indicates the master is in sync mode. Continue to hold the channel/sync button.

After the master is in sync mode with the LEDs on, take each additional device within 10 feet of the master and hold the channel/sync button down until the lights start to flash. Release the button.

After all additional devices have finished the procedure above. Release the button on the master device.

To Enable Push to Talk mode. After the radio is on, press and hold the mute button and the up arrow button at the same time until the LEDs turn off. To return to Full duplex mode, press and hold the mute button and the down arrow button at the same time until the LEDs turn off.

Operation

To turn on the device press and hold the Power button until a LED turns on. The devices will remember the group it was synchronized too and connect to the group automatically. Adjust volume to a comfortable level.

The setup process will need to be redone if the following situations occur: The master is not turned on or missing from the group, a device needs to be removed from the group, a device needs to be added to the group.