

Manual

Model: 98801(RX), YKQ05(TX)

1) Profile

1.1、 Input: DC 12V(TX) by battery

1.2、 The receiver is a UL listed product with grounded outlet

1.3、 The Transmitter is a light sensor.

2) Description:

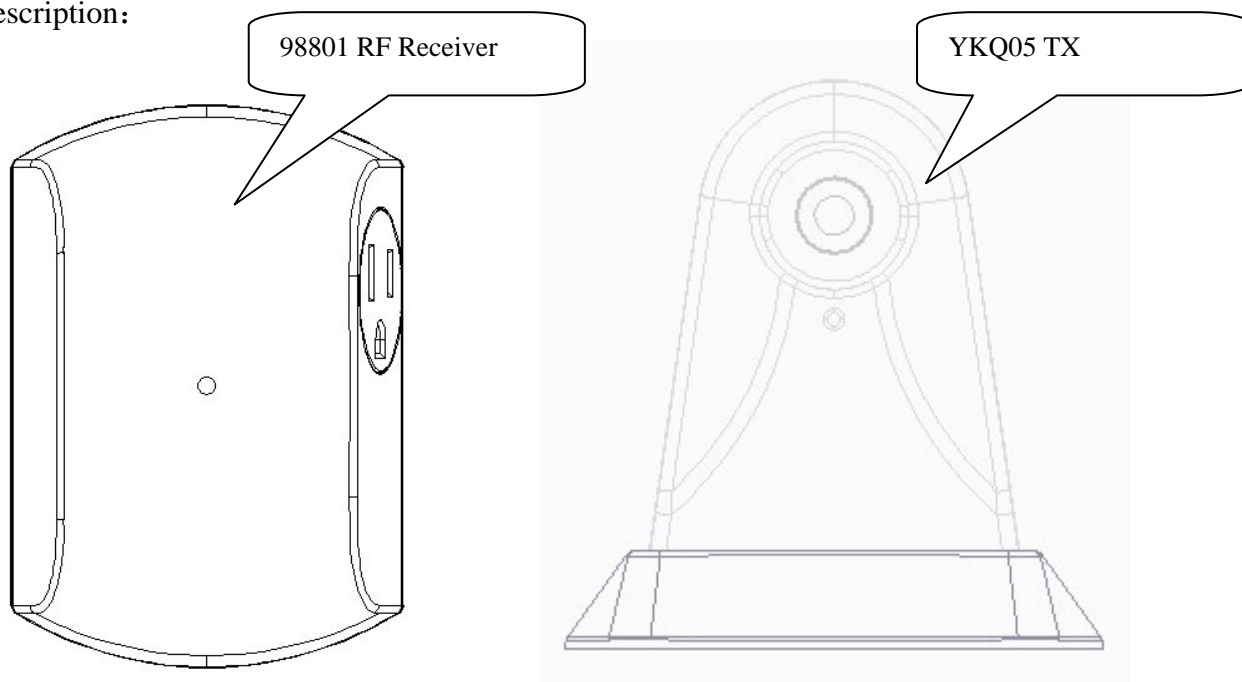

2.1、 Install the receiver to outlet. And connect the controlled device to the outlet of the receiver.

2.2、 Put the light sensor to proper place which can receives the light change of sun or other light source.

1、 Install a 23A battery into light sensor. The led will flash once and send out an off signal.。 set AUTO position, the CDS will detect the environment light. If the lux of the light is less than 15lux, it will send out an ON signal. Receiver will turn on after receiving the ON signal from light sensor. If the environment lux level is bigger than 60lux, the sensor will send out an off signal to turn off the receiver.。

2、 2 hours position: The light sensor resets first and send out an OFF signal to turn off receiver. If the environment lux level is less than 15lux, the Sensor will send out a signal to turn on the receiver. After 2 hours, it will send out a signal to turn off the receiver. Then the sensor will continue to monitor the lux level of environment. If the lux level is bigger than 60 lux, the sensor is ready to repeat next ON/OFF activity

3、 5 hours position: The light sensor resets first and send out an OFF signal to turn off receiver. If the environment lux level is less than 15lux, the Sensor will send out a signal to turn on the receiver. After 5 hours, it will send out a signal to turn off the receiver. Then the sensor will continue to monitor the lux level of environment. If the lux level is bigger than 60 lux, the sensor is ready to repeat next ON/OFF activity

4、 8 hours position: The light sensor resets first and send out an OFF signal to turn off receiver. If the environment lux level is less than 15lux, the Sensor will send out a signal to turn on the receiver. After 8 hours, it will send out a signal to turn off the receiver. Then the sensor will continue to monitor the lux level of environment. If the lux level is bigger than 60 lux, the sensor is ready to repeat next ON/OFF activity

5、 Random position: The light sensor resets first and send out an OFF signal to turn off receiver. If the environment lux level is less than 15lux, the Sensor will send out a signal to turn on the receiver. After 2, 5 or 8 hours (randomly chosen by programming), it will send out a signal to turn off the receiver. Then the sensor will continue to monitor the lux level of environment. If the lux level is bigger than 60 lux, the sensor is ready to repeat next ON/OFF activity



FCC Caution: Any changes or modifications not expressly approved by the party responsible for compliance could void the user's authority to operate this equipment.

This device complies with Part 15 of the FCC Rules. Operation is subject to the following two conditions:

(1) This device may not cause harmful interference, and (2) this device must accept any interference received, including interference that may cause undesired operation.

Industry Canada Notice: This device complies with Industry Canada licence-exempt RSS standard(s).

Operation is subject to the following two conditions: (1) This device may not cause harmful interference, and (2) This device must accept any interference received, including interference that may cause undesirable operation. This Class B digital apparatus complies with Canadian ICES-003. Le présent appareil est conforme aux CNR d'Industrie Canada applicables aux appareils radio exempts de licence.

L'exploitation est autorisée aux deux conditions suivantes : (1) l'appareil ne doit pas produire de brouillage, et (2) l'utilisateur de l'appareil doit accepter tout brouillage radioélectrique subi, même si le brouillage est susceptible d'en compromettre le fonctionnement. Cet appareil numérique de la classe B est conforme la norme NMB-003 du Canada

Company: Ningbo Sengye electrical Co, Ltd

Address: 87 Guangming north RD, Simen town, Yuyao city, zhenjian porvince