

**Player Source Display**

**CD-DA Mode Display**

**Play Mode indicators**  
Lights when each mode is activated.

- R▶** Random play
- REP** Repeat play

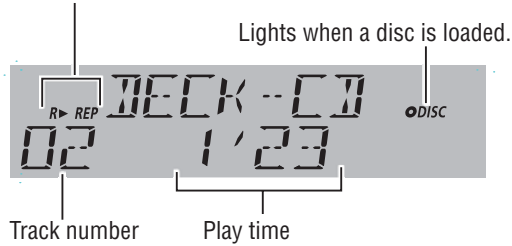

**MP3/WMA Mode Display**

**Play Mode indicators**  
lights when each mode is activated.

- R▶** Random play
- REP** Repeat play
- FOLDER** Folder Random, Folder Repeat

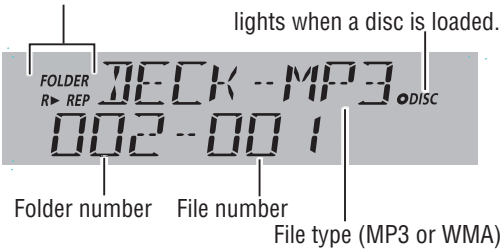

**Display Change**

Press [DISP].

**Disc Player (CD-DA disc):**



**Disc Player (MP3/WMA disc):**

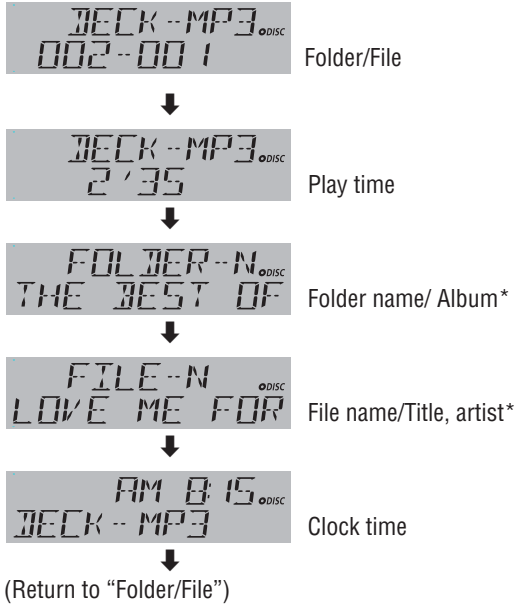

**\*ID3/WMA Tag Setting**

Hold down [3] (SCROLL) for more than 2 seconds.

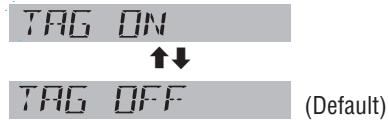

**When a folder name is displayed:**

- TAG ON: The album title is displayed.
- TAG OFF: The folder name is displayed.

**When a file name is displayed:**

- TAG ON: The title/artist name is displayed.
- TAG OFF: The file name is displayed.

**Notes:**

- To have another circle scroll while a text is displayed, press [3] (SCROLL). If the number of displayed characters is 11 or less, the characters do not scroll.
- "NO TEXT" is displayed when no information exists on the disc.
- ID3/WMA tag information is displayed for the album name and title/artist name.

## Disc Player (continued)

English

### Random Play Setting

Press [5] (RANDOM) to select the random play setting.

The LCD display shows the track name 'BECK --MP3' and the format 'ODISC' on the top line, and 'RANDOM ON' on the bottom line.

#### Random play

All the available songs (tracks/files) are played in a random sequence. (**R▶** lights.)



The LCD display shows 'FOLDER R▶' on the top left, 'BECK --MP3' and 'ODISC' on the top right, and 'F--RANDOM ON' on the bottom line.

#### Folder random play

(only for MP3/WMA)

All the available files in the current folder are played in a random sequence. (**FOLDER R▶** lights.)



The LCD display shows 'R▶' on the top left, 'BECK --MP3' and 'ODISC' on the top right, and 'RANDOM OFF' on the bottom line.

#### Random off

Return to regular play.

### Repeat Play Setting

Press [6] (REPEAT) to select the repeat play setting.

The LCD display shows 'BECK --MP3' and 'ODISC' on the top line, and 'REPEAT ON' on the bottom line.

#### Repeat play

The current song (track/file) is repeated. (**REP** lights.)



The LCD display shows 'FOLDER REP' on the top left, 'BECK --MP3' and 'ODISC' on the top right, and 'F--REPEAT ON' on the bottom line.

#### Folder repeat play

(only for MP3/WMA)

The current folder is repeated. (**FOLDER REP** lights.)



The LCD display shows 'REP' on the top left, 'BECK --MP3' and 'ODISC' on the top right, and 'REPEAT OFF' on the bottom line.

#### Repeat off

Return to regular play.

# USB (MP3/WMA)

## Notes for USB device

- This unit plays back MP3/WMA files stored on a USB memory.
- Back up any important data beforehand. We cannot accept responsibility for any lost data.
- Refer to the section on “Compatible USB devices” (→ below).
- Refer to the section on “Notes on MP3/WMA”.
- Connect your USB device to your car audio using a standard USB extension cable. Use of a 2 m or shorter USB 2.0 cable is recommended.



## Caution for USB Device

- Do not connect a USB device directly to this unit. If the USB device is connected directly to this unit and an accident occurs, or if the brakes are applied suddenly, the driver or passenger may bump into the USB device and may get injured.
- Position the USB device and USB extension cable/ optional adaptor so that they do not obstruct your driving.
- Do not connect any USB device other than a USB memory or a USB audio player. Do not connect multiple USB devices to the USB connector. Drawing power for multiple USB devices from the connector could cause overheating and smoking.

## Compatible USB devices

- USB Mass Storage Class  
This refers to a type of USB device, which when connected to a PC can be used as a storage device without the need for specialized drivers or software. For details as to whether your USB memory/USB Audio is compatible with USB Mass Storage Class, please contact the USB memory/USB Audio manufacturer.
- USB Standard Compatibility 1.1/2.0 Full Speed
- File system is FAT12/16/32
- Maximum current less than 1 A
- Capacity less than 32 GB (1 partition) is recommended.

### Notes:

- The use of USB devices that contain data files other than MP3/WMA stored is not recommended.
- Playback or display may not be possible depending on the type of the USB device or the condition of the recording.
- Even if PC playback is possible, it may not be possible on this product, because some USB devices are not compliant with the USB standard.
- Even with a USB device in the Mass Storage Class, playback may not be possible in some cases.

## Operation Flow

- 1 Press **[SOURCE]** to select the USB mode.
- 2 Open the USB connector cover.

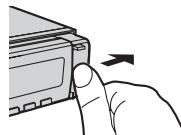

- 3 Using a USB extension cable, connect the USB memory to this unit.

### Notes:

- When connecting (disconnecting) the USB memory, turn down the volume of the unit.
- When connecting the cables, make sure the connector is pushed all the way into the socket.
- This unit may not operate correctly, depending on USB cable's quality and length. Use of a 2 m or shorter USB 2.0 cable is recommended.

USB extension cable (USB 2.0, not included)

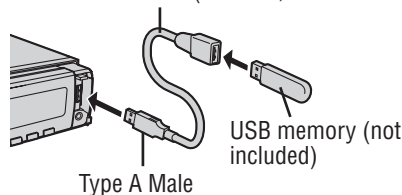

### Notes:

- MP3/WMA files recognized by the unit are played back automatically.
- If the USB memory is connected to this unit when the power is turned on, playback starts automatically.

- 4 Select a desired portion.

## Folder Selection

[^] (FOLDER): Next folder

[v] (FOLDER): Preceding folder

## File Selection

[▶▶]: Next file

[◀◀]: Preceding file (press twice)

**Note:** For fast forward/reverse, hold down either of them.

## Pause

Press **[BAND] (▶/||)**.

Press again to cancel.

# USB (MP3/WMA) (continued)

English

**[SOURCE]** selects a source.

**[BAND] (▶/⏸)** (Play/Pause) toggles between pause and play with the USB source.

**[VOL]** Rotates to select a file/folder in the file search mode.  
**(PUSH SEL: Select)** Push to determine the selection in the file search mode.

**[Q] (Search)** activates the file search mode.

**[DISP] (Display)** switches the information on the display.  
**(↶) (Return)** returns to the 1 level higher hierarchy.

**[5] (RANDOM)/ [6] (REPEAT)** toggles on/off each play mode.  
**[3] (SCROLL)** scrolls the information on the display.  
**[V] [^] (FOLDER)** skip to the previous/next folder.

**[◀◀] [▶▶]** skip to the previous/next file in the USB mode. For fast reverse/fast forward, hold down either of them.

USB (Universal Serial Bus) Connector (inside of the cover)

## File search

1 Press [Q] to activate the file search mode.

Example:



Press again to exit from the file search mode.

**Note:** **FOLDER** indicator lights when folder searching is performed.

2 Select a file for play.

Turn [VOL] clockwise or counterclockwise: Selects a folder or a file in the same hierarchy.

Push [VOL] (PUSH SEL): Determines the selection.

- When a folder is selected, the folder is opened and a file/folder inside becomes selectable.
- When a file is selected, the file is played.

**Note:** Press [↶]: Returns to the 1 level higher hierarchy.

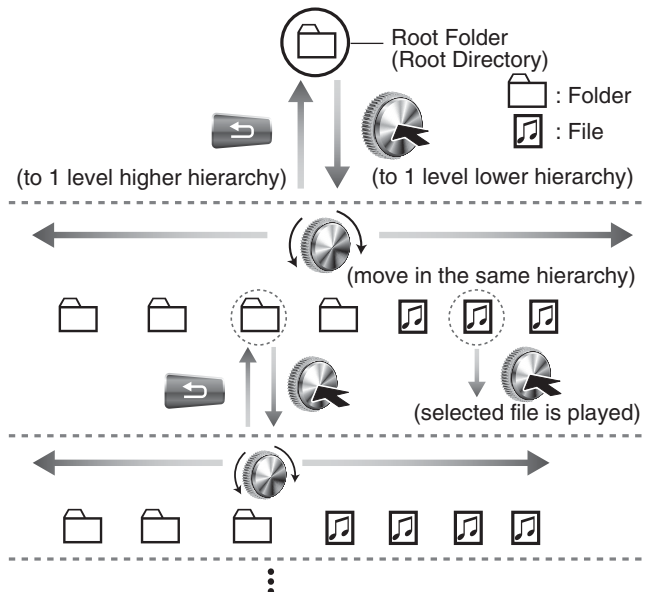

### USB Disconnect

Disconnect the USB memory and USB extension cable.



**Notes:**

- Do not leave the USB device for long periods of time in places inside the car where temperature becomes excessively high
- To prevent dirt and dust from adhering to the USB connector, close the cover of this unit when not in use.

### USB Mode Display

**Play Mode indicators**

lights when each mode is activated.

**R▶** Random play

**REP** Repeat play

**FOLDER** Folder Random, Folder Repeat

lights when the USB device is loaded.



Folder number

File number

File type (MP3 or WMA)

### Display Change

Press **[DISP]**.



Folder/File



Play time



Folder name/  
Album\*



File name/Title,  
artist\*



Clock time

(Return to "Folder/File")

### \*ID3/WMA Tag Setting

Hold down **[3] (SCROLL)** for more than 2 seconds.



(Default)

**When a folder name is displayed:**

TAG ON: The album title is displayed.

TAG OFF: The folder name is displayed.

**When a file name is displayed:**

TAG ON: The title/artist name is displayed.

TAG OFF: The file name is displayed.

**Notes:**

- To have another circle scroll while a text is displayed, press **[3] (SCROLL)**. If the number of displayed characters is 11 or less, the characters do not scroll.
- "NO TEXT" is displayed when no information exists on the USB device.
- ID3/WMA tag information is displayed for the album name and title/artist name.

## USB (MP3/WMA) (continued)

English

### Random Play Setting

Press [5] (RANDOM) to select the random play setting.



USB-MP3  
RANDOM ON

Random play

All the available files are played in a random sequence. (R▶ lights.)



FOLDER USB-MP3  
F-RANDOM ON

Folder random play

All the files in the current folder are played in a random sequence. (FOLDER R▶ lights.)

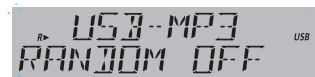

USB-MP3  
RANDOM OFF

Random off

Return to regular play.

### Repeat Play Setting

Press [6] (REPEAT) to select the repeat play setting.

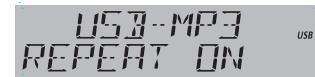

USB-MP3  
REPEAT ON

Repeat play

The current file is repeated. (REP lights.)



FOLDER USB-MP3  
F-REPEAT ON

Folder repeat play

The current folder is repeated. (FOLDER REP lights.)

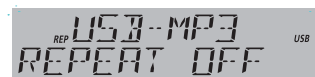

USB-MP3  
REPEAT OFF

Repeat off

Return to regular play.

# For use with iPod

By connecting compatible with iPod devices to USB connector via a USB extension cable for iPod (USB 2.0, not included), you can enjoy music files stored on the compatible with iPod devices in your vehicle.

**Note:** Refer to the section on “USB (MP3/WMA)” for connection.

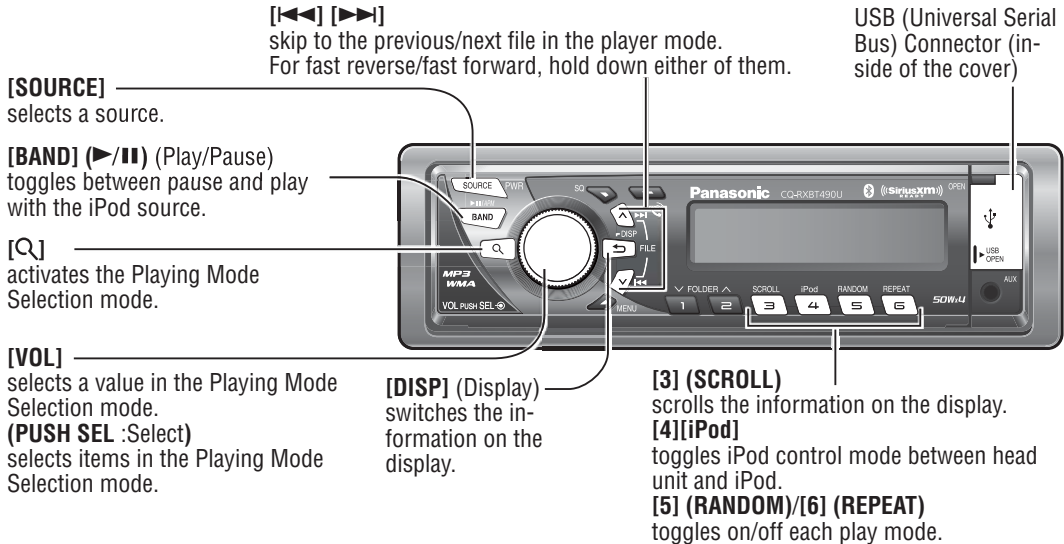

English

## Operation Flow

- 1 Connect a iPod.
- 2 Press **[SOURCE]** to select the iPod (USB) mode. Playback starts.

**Note:** If playback does not start, press **[BAND] (▶/||)**.

## File Selection

**[▶▶]**: Next file

**[◀◀]**: Beginning of the current file

For the preceding file, press twice.

### Notes:

- Hold down for fast forward/reverse.
- When fast forward comes to the end of a file or fast reverse comes to the beginning of a file, regular playback starts when the fast forward or reverse button is released.

## Pause

Press **[BAND] (▶/||)**.

Press again to cancel.

## Playing Mode Selection

- 1 Press **[Q]** to activate the Playing Mode Selection mode.
- 2 Turn **[VOL]** clockwise or counterclockwise to adjust.

**PLAYLIST:** Playback by playlist (Default)

**ARTIST:** Playback by artist

**ALBUM:** Playback by album

**GENRE:** Playback by genre

- 3 Press **[VOL] (PUSH SEL)** to determine the selection.
- 4 Turn **[VOL]** clockwise or counterclockwise to select a portion to be played.
- 5 Press **[VOL] (PUSH SEL)** to determine the selection.

### Notes:

- To return to the previous screen, press **[DISP]**.
- Files without an album name or an artist name are not playable in the playing mode of the album or artist display respectively.

# For use with iPod (continued)

English

## Setting the iPod Control

When an iPod/iPhone is connected, operate it from its own controls or from this head unit can be selectable. Press **[4] (iPod)** to switch iPod control mode between this head unit and iPod.



**iPod mode (Default):**

Operate the iPod/iPhone playback via this head unit.



**iPod control mode:**

Operate the iPod/iPhone playback using its own controls.

**Note:** The iPod control mode (function) can not be operated with the following iPod models.

- iPod nano (1st generation)
- iPod with video

## iPod Mode Display

### Play Mode indicators

lights when each mode is activated.

**REP** Repeat play

**R▶** Shuffle play (songs)

Blinks when shuffle play (albums) mode is activated.

**R▶** Shuffle play (albums)



Current file      All files (A number up to 999 is displayable.)

lights when a USB extension cable for iPod and iPod devices is connected with USB connector and the USB source is selected.

## Display Change

Press **[DISP]**.



Current file/all files (Default)



Play time



Title name



Album name



Artist name



Clock time



(Return to "Current file/all files")

### Notes:

- To have another circle scroll while a text is displayed, press **[3] (SCROLL)**. If the number of displayed characters is 11 or less, the characters do not scroll.
- "NO TEXT" is displayed when no information exists.

## Repeat, Shuffle Play

### Repeat Play Setting

Press **[6] (REPEAT)** to select the repeat play setting.



**One song repeat play**

The current file is repeated. (**REP** lights.)



**All songs repeat play**

The all songs in current album or list are repeated. (**REP** blinks.)



**Repeat play off**

## Shuffle Play Setting

The shuffle function of an iPod corresponds to the RANDOM function of this unit.

Press [5] (**RANDOM**) to select the shuffle play setting.



### Songs

All the available files are played in a random sequence. (▶ lights.)



### Albums

All the playable albums are played in a random sequence. (▶ blinks.)



### Shuffle off

Return to regular play.

### Compatible with iPod devices/software version (USB connector)

This unit is capable of controlling and playing music for iPod. (video playback is not feasible)

#### Made for.

- iPod touch (4th generation)/ver. 5.0.1
- iPod touch (3rd generation)/ver. 5.0.1
- iPod touch (2nd generation)/ver. 4.2.1
- iPod touch (1st generation)/ver. 3.1.3
- iPod classic (160 GB only)/ver. 2.0.4
- iPod classic (120 GB only)/ver. 2.0.1
- iPod classic/ver. 1.1.2
- iPod with video/ver. 1.3
- iPod nano (6th generation)/ver. 1.2
- iPod nano (5th generation)/ver. 1.0.2
- iPod nano (4th generation)/ver. 1.0.4
- iPod nano (3rd generation)/ver. 1.1.3
- iPod nano (2nd generation)/ver. 1.1.3
- iPod nano (1st generation)/ver. 1.3.1

#### Made for.

- iPhone 4S/ver. 5.0.1
- iPhone 4/ver. 5.0.1
- iPhone 3GS/ver. 5.0.1
- iPhone 3G/ver. 4.2.1
- iPhone/ver. 3.1.3

\* Operation check has been completed with software available at the end of August, 2011. We do not guarantee the operation with our future products or upgraded software.

### Notes:

- The shuffle function for iPod corresponds to the RANDOM function of this unit.
- Please make sure to detach the iPod after turning off the vehicle engine (turning the ACC to OFF). The iPod devices may not shut down while still connected, which may result in battery depletion.
- Please do not connect for iPod accessories such as for iPod remote control unit or headphones while connecting for iPod with the unit. The unit may not operate correctly.
- Connect this unit after turning down the volume for the iPod.
- "PAUSE" appears until for iPod is recognized after connecting for iPod. This indicates there is nothing wrong with the main unit.
- We do not guarantee all the operations of connectable devices.
- If your iPod or iPhone is not working correctly, disconnect it from this unit, reset it and then reconnect it to this unit.
- The iPod/iPhone will be recharged while connected to this unit.
- When iPhone is paired with this unit via Bluetooth® and connected with USB connector at the same time, please note when playing music via Bluetooth® and then switch to USB mode on this unit, the sound output of USB mode are muted. If such phenomenon occurs, please unplug the USB cable and plug again for normal operation.