

[1. Features and Functions]

- <1> Audio Function (Radio(AM/FM)/USB-Audio/iPod/Car PLAY/BT Audio)
- <2> M-CAN device compatible
 - Meter with STSW
- <3> Rear view camera (Alert/Graphics of vehicle width fixed line)
- <4> Clock System
- <5> Setting System (Adjustment of audio, image quality and language)
- <6> Front display
 - 7inch WVGA display (800 × 480 pixel)
- <7> Operation-input function (Key matrix, Rotary encoder, Touch panel)
- <8> Steering Switch
- <9> Bluetooth Hands Free
- <10> VoiceAssistant (VA : Siri) mode
- <11> Illumination control
 - Panel SW lighting ON/OFF, Panel SW illumination brightness adjustment, Display brightness switching

[2. OPERATIONAL SPECIFICATION]

[2-1. Switch Control]



SW No.	Function(Button Name)	Remarks
①	PWR	Push Audio Power ON/OFF
②	CAMERA	Move to camera display screen settings.
③	D/N	Push Change Illumination for Day or Night.
④	AUDIO	Return to playing audio mode
⑤	HOME	Push Display Home_Menu screen.
⑥	VOL	Rotate Volume Up/Down

[2-2. Touch Panel function]

Touch operations supported by the touch panel function are shown below.

Support detection number	Touch Operation	Operation image
Single Touch	Short Tap (Short Click)	
	Flick Up, down, left and right (4 directions)	

【2-3. Display Menu】

【AM Select】



【FM Select】



【USB Select】



【Bluetooth Audio Select】



【Phone Select (Bluetooth connected)】

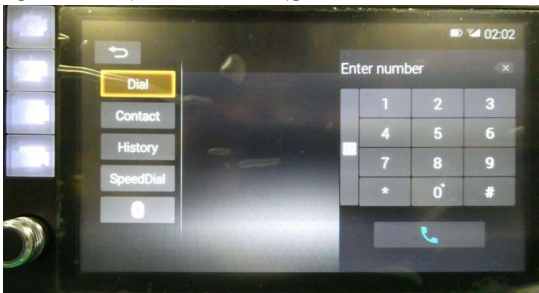

【Android Auto Select (Bluetooth connected)】

【Settings Select】



【Sound Adjust】

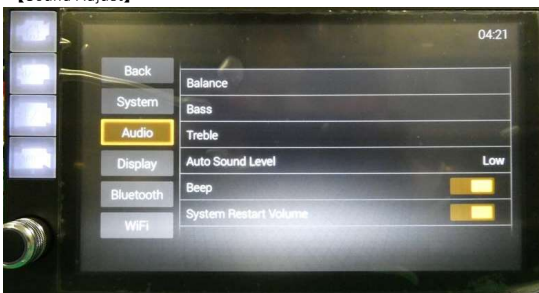

【Display Adjust】



【Clock Adjust】



[2-4. Bluetooth Connect]

2-4-1 Touch "Setting".

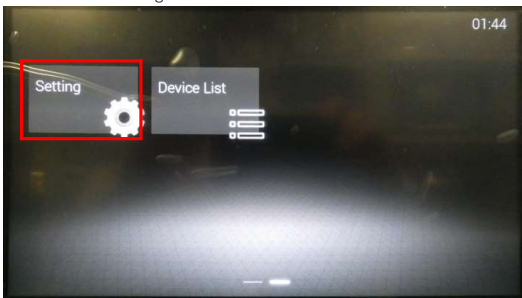

2-4-2 Touch "Add Device".



2-4-3 Touch "Search Device".



2-4-3 Looking for the DEVICE My Car.



2-4-4 Detect device and Select "My Car" and Select "Pairing" of the DEVICE.



2-4-5 BT Connection Complete

