



CERTIFICATION TEST REPORT

Report Number : R12844817-EP4

Applicant : Bose Corporation
100 The Mountain
Framingham, MA 01701, USA

Model : BMD0005, BMD0006, BMD0007, BMD0008

FCC ID : A94429638A

IC : 3232A-429638A

EUT Description : Wireless Headphones

Test Standard(s) : FCC 47 CFR PART 15 SUBPART C
ISED RSS-247 ISSUE 2
ISED RSS-GEN ISSUE 5

Date Of Issue:
2019-05-20

Prepared by:
UL LLC
12 Laboratory Dr.
Research Triangle Park, NC 27709 USA
Tel: (919) 549-1400

REPORT REVISION HISTORY

Rev.	Issue Date	Revisions	Revised By
--	--	Initial Issue	

TABLE OF CONTENTS

REPORT REVISION HISTORY	2
TABLE OF CONTENTS	3
1. DESCRIPTION OF TEST SETUP	4
2. SETUP PHOTOS.....	6

1. DESCRIPTION OF TEST SETUP

SUPPORT EQUIPMENT

Support Equipment List				
Description	Manufacturer	Model	Serial Number	FCC ID
Laptop	Lenovo	T450	A2UQS	N/A
Laptop Power Supply	Lenovo	ADLX65NLC2A	11S45N0259Z1ZS974CH2W9	N/A

I/O CABLES

I/O Cable List						
Cable No	Port	# of identical ports	Connector Type	Cable Type	Cable Length (m)	Remarks
1	Charging	1	Charging Pins to USB	USB	<1m	Magnetic

TEST SETUP

The EUT is connected to a test laptop during the tests. Test software exercised the radio card.

SETUP DIAGRAMS

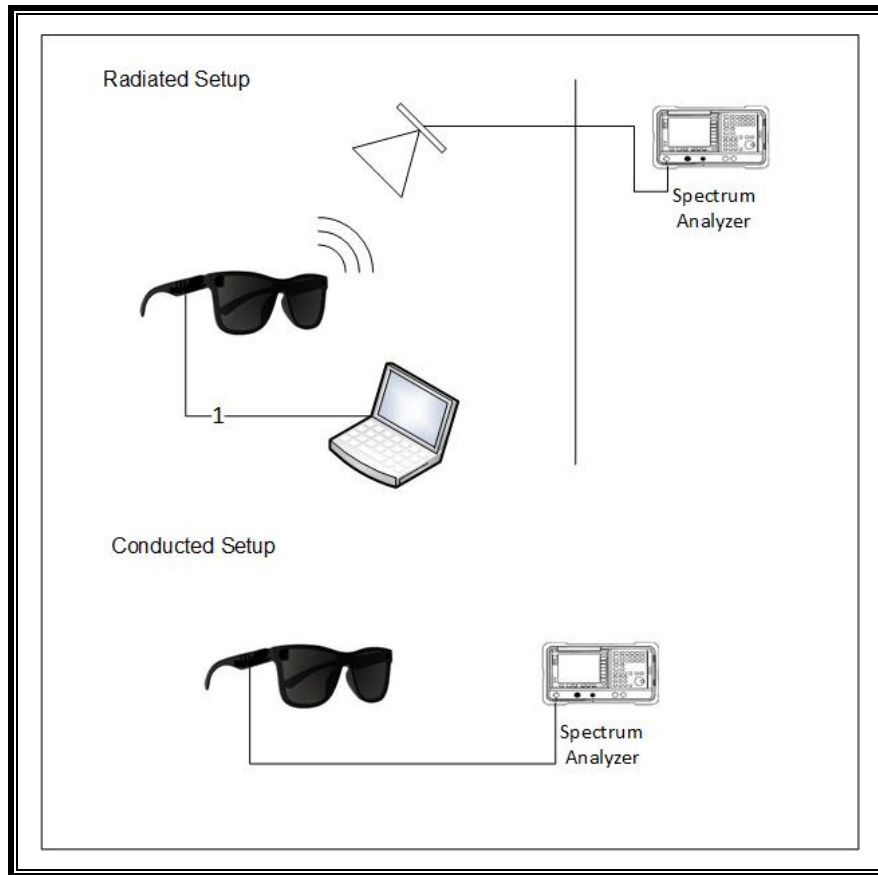

2. SETUP PHOTOS

RF CONDUCTED MEASUREMENT AT ANTENNA PORT

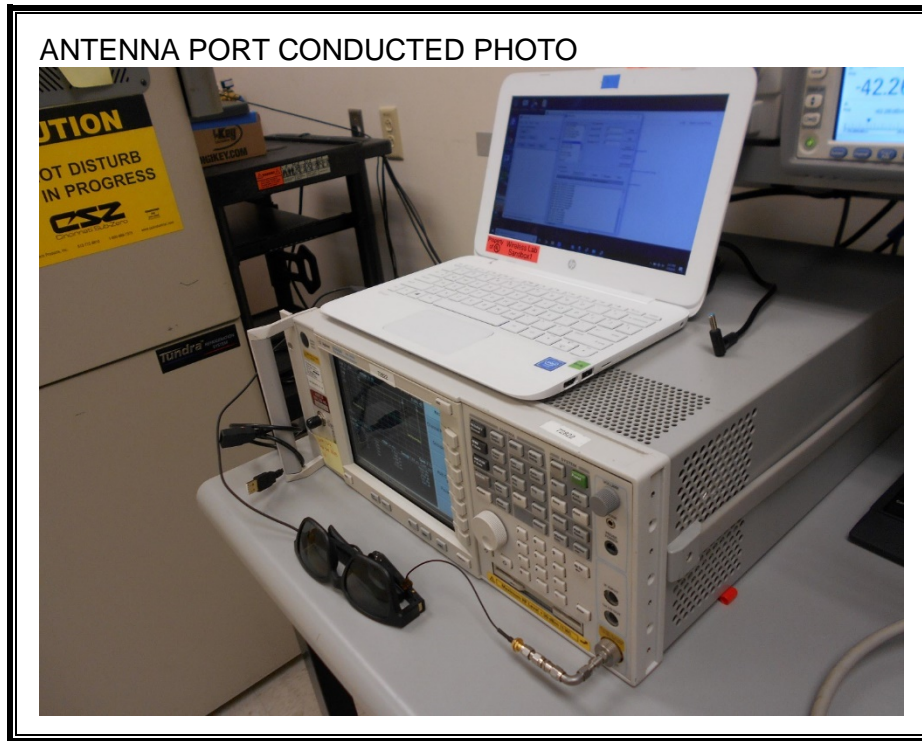

RADIATED SPURIOUS EMISSIONS

RADIATED SPURIOUS PHOTOS (Above 1GHz)

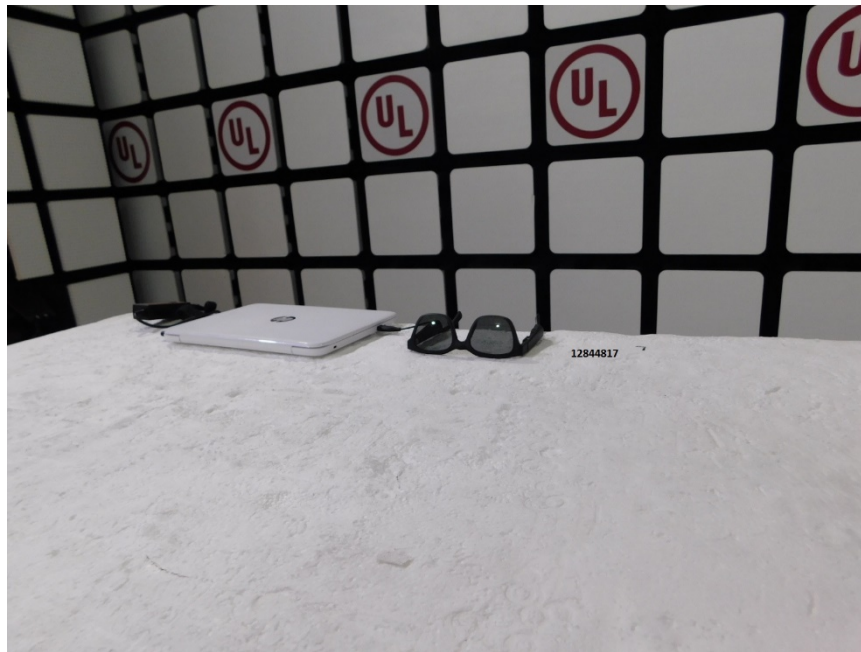
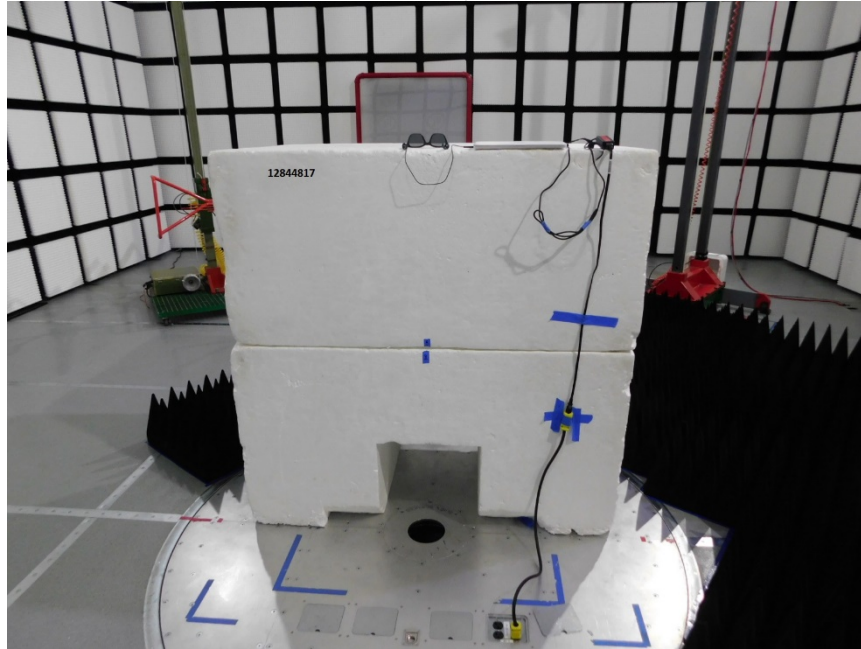

RADIATED SPURIOUS PHOTOS (Below 1GHz)

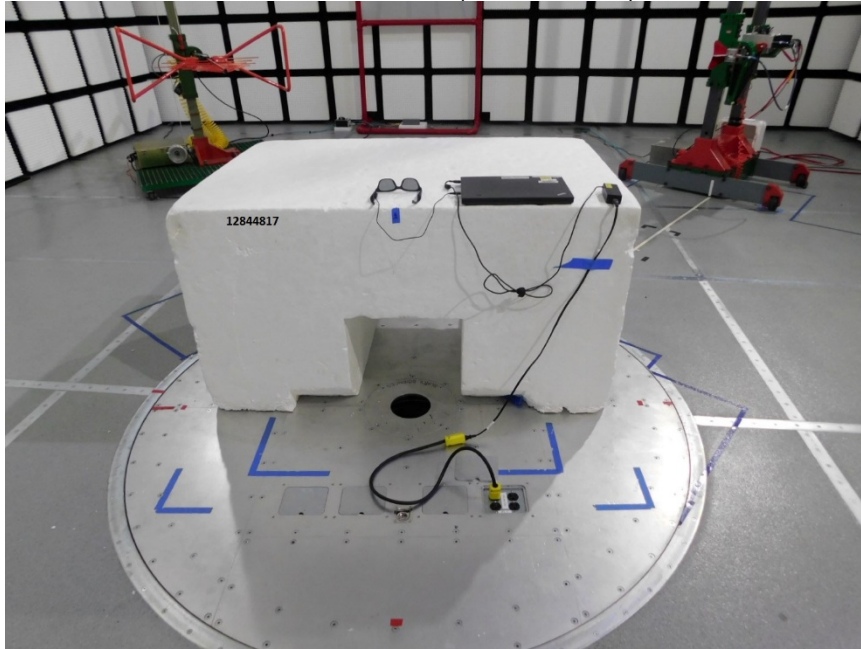

RADIATED SPURIOUS PHOTO (X Orientation)

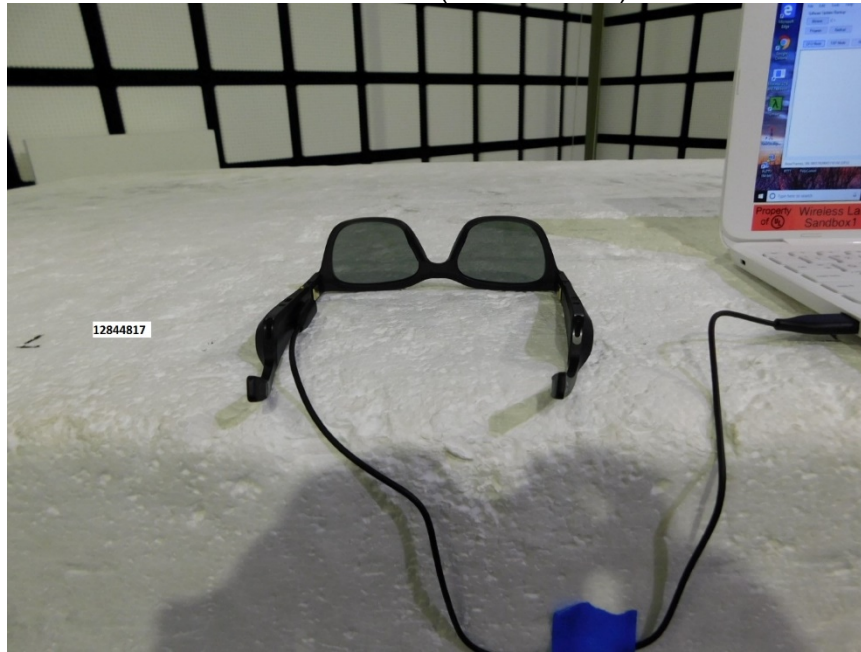

RADIATED SPURIOUS PHOTO (Y Orientation)

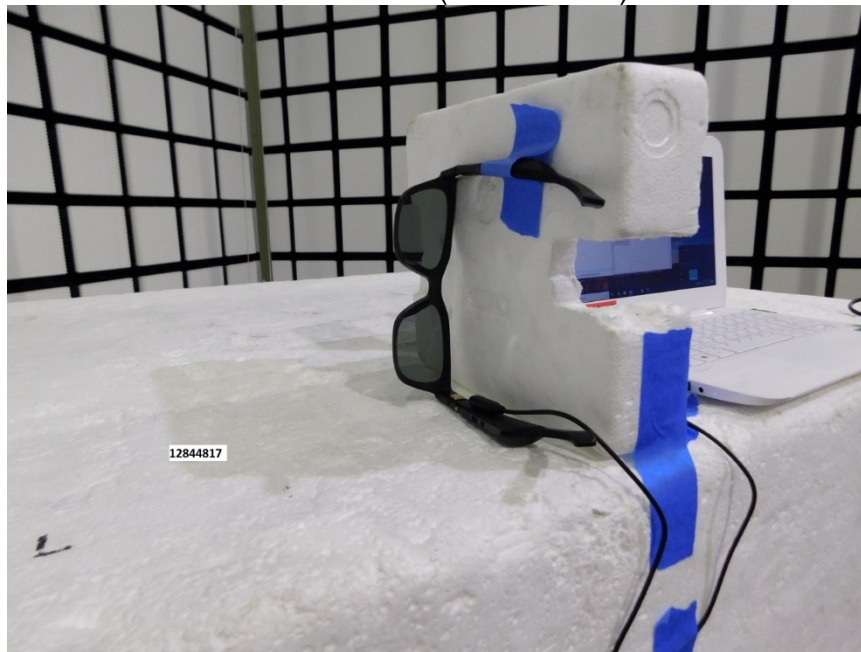



END OF TEST REPORT